



WRAPAROUND

WSE251

SERIES 4FT, 8FT
SENSOR CONTROLLED WRAPAROUND LUMINAIRE



| | |
|------|--|
| JOB | |
| TYPE | |
| DATE | |

DIMENSIONS



CROSS SECTION

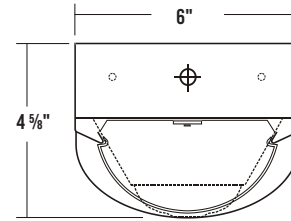

*Sensor mounted in center for 8' fixtures

4' BACKPLATE

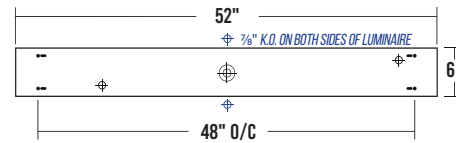

8' BACKPLATE

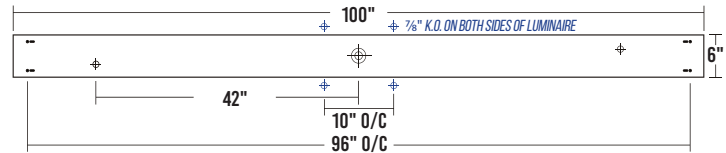

-- V-HOOK HOLE ⊕ 7/8" OFFSET K.O. ⊕ 2" K.O.

SPECIFICATIONS

CONSTRUCTION

- Aluminum housing with riveted end plates
- Side knockouts for 1/2" conduit
- Neoprene gasketing on end caps

FINISH

- Baked white polyester finish
- Painted after fabrication
- Minimum reflectance 90%

OPTICAL

- Snap-on frosted acrylic radial lens

ELECTRICAL

- High efficiency drivers coupled with long-life LEDs
- Service life greater than 50,000 hours (L70)
- Universal voltage 120V through 277V (347V / 480V available)

LISTING

- UL USA and Canada listed / suitable for damp locations

WARRANTY

- 5-Year limited warranty standard. 10-Year limited warranty also available

APPLICATIONS

- Stairwells, Parking Structures, Passageways, Workrooms, Restrooms

FEATURES

- Integrated sensor
- 0-10V dimming driver standard
- Supports California Title 24 compliance
- Suitable for damp locations

OPTIONS CONTACT CUSTOMER SERVICE FOR ADDITIONAL OPTIONS

- Wireless controls
- Emergency battery pack
- Color tunable white (2700K-6500K)
- Custom housing colors
- Customization available upon request



Los Angeles Lighting Mfg. Co.
 Contact Us
 T: 626-454-8300
 F: 626-454-8399
 www.lalighting.com
 10141 Olney Street
 El Monte, CA 91731
 Made in the USA



Due to continued product improvements and enhancements, Los Angeles Lighting Manufacturing Company reserves the right to alter specifications, dimensions, data, and/or materials without notice. Please visit our website to view the most current information.

© 2023 LOS ANGELES LIGHTING MANUFACTURING CO. ALL RIGHTS RESERVED.

Revised: 09/01/23



ORDERING INFORMATION

ADDITIONAL OPTIONS AVAILABLE. VISIT WWW.LALIGHTING.COM/RESOURCES FOR MORE INFORMATION

EXAMPLE: WSE251-4-4L-BPL1.5-DRDM-UNV-1/840

| SERIES | NOMINAL LED LUMENS | NOMINAL LENGTH | ELECTRICAL | SENSOR CONFIGURATION | DRIVER | VOLTAGE | # OF LED ROWS | CRI / CCT |
|---|--|-------------------|--|---|---------------------------------------|-----------------------------|---------------------------|---|
| WSE251 | | | | | DRDM | UNV | 1 | |
| WSE251 • Sensor Controlled Wraparound LED Luminaire | 2 - 2000lm 4 - 4000lm 6 - 6000lm 8 - 8000lm 12 - 12000lm 16 - 16000lm High Efficacy 2HE - 2000lm 4HE - 4000lm 6HE - 6000lm | 4L • 4' | BPL1.5 • 1500 lm emergency battery pack *Leave blank if not specified | MS(xx) Motion Sensor (See below for lens and configuration options) *Leave blank if not specified | DRDM • 0-10V Dimming Driver | UNV • 120V - 277V | 1 • One LED Row | 827 • 80+ CRI / 2700K 835 • 80+ CRI / 3500K 840 • 80+ CRI / 4000K 850 • 80+ CRI / 5000K 865 • 80+ CRI / 6500K 8TW • 80+ CRI Tunable White 2700K-6500K 90 CRI also available. Contact customer service for additional CRI/CCT packages. |
| | 4 - 4000lm 8 - 8000lm 12 - 12000lm 16 - 16000lm 24 - 24000lm High Efficacy 4HE - 4000lm 8HE - 8000lm 12HE - 12000lm | 8L • 8' | Standard options for WSE251 shown above. For additional options, including lumen packages, controls, lenses, switches, finishes, and more, visit www.lalighting.com/resources or contact customer service. | | | | | |

SENSOR CONFIGURATION

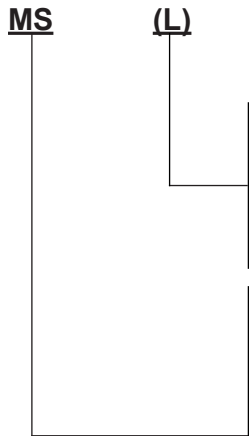

| LENS | | SHAPE | MOUNTING HEIGHT | | COVERAGE |
|------|----------|-------|-----------------|------------|-----------|
| (L) | STANDARD | ROUND | 8 - 20 ft | 2.4 - 6.0m | 2x HEIGHT |
| (H) | HIGH BAY | CONE | 15 - 30 ft | 4.5 - 9.0m | 3x HEIGHT |
| (LW) | WIDE | CONE | 8 - 10 ft | 2.4 - 3.0m | 6x HEIGHT |

- MS - PIR Motion Sensor – On/Off**
 - Turns luminaire on/off in response to motion
- MSSD - PIR Motion Sensor – High/Low**
 - Increases/decreases illumination in response to motion
- MSPC - PIR Motion Sensor with Photocell – On/Off**
 - Holds luminaire OFF when sufficient light is present, regardless of motion
 - When ambient light levels are low, turns light on/off in response to motion
- MSPCSD - PIR Motion Sensor with Photocell – On/Off**
 - Holds luminaire OFF when sufficient ambient light is present, regardless of motion
 - When ambient light levels are low, increases/decreases illumination in response to motion

NOTE:
For additional sensor and wireless controls options, visit www.lalighting.com/resources



Los Angeles Lighting Mfg. Co.
 Contact Us
 T: 626-454-8300 10141 Olney Street
 F: 626-454-8399 El Monte, CA 91731
www.lalighting.com Made in the USA



Due to continued product improvements and enhancements, Los Angeles Lighting Manufacturing Company reserves the right to alter specifications, dimensions, data, and/or materials without notice. Please visit our website to view the most current information.

© 2023 LOS ANGELES LIGHTING MANUFACTURING CO. ALL RIGHTS RESERVED.

Revised: 09/01/23



MADE IN THE USA
BAA Compliant

SYSTEM DATA

ADDITIONAL LUMEN PACKAGES AVAILABLE. CONTACT CUSTOMER SERVICE FOR MORE INFORMATION

| 4' - LED LUMEN PACKAGE | NORMAL AMBIENT TEMPERATURE PRODUCT CODE | DELIVERED LUMENS | SYSTEM WATTS | LUMINAIRE EFFICACY | AMBIENT TEMP. | FLUORESCENT EQUIVALENT | IES FILES |
|------------------------|---|------------------|--------------|--------------------|----------------------------|------------------------|---------------------------|
| 2000 Lumens (Nominal) | WSE251-2-4L-MS(xx)-DRDM-UNV-1/840 | 1849 | 13.4 | 137.9 lm/W | -20°C / 35°C (-4°F / 95°F) | 1-F17T8 | * |
| 4000 Lumens (Nominal) | WSE251-4-4L-MS(xx)-DRDM-UNV-1/840 | 3631 | 26.7 | 136.0 lm/W | -20°C / 35°C (-4°F / 95°F) | 1-F54T5HO, 2-F32T8 | * |
| 6000 Lumens (Nominal) | WSE251-6-4L-MS(xx)-DRDM-UNV-1/840 | 5612 | 43.7 | 128.5 lm/W | -20°C / 35°C (-4°F / 95°F) | 3-F32T8 | LA-T3776b |
| 8000 Lumens (Nominal) | WSE251-8-4L-MS(xx)-DRDM-UNV-1/840 | 7304 | 51.1 | 142.8 lm/W | -20°C / 35°C (-4°F / 95°F) | 2-F54T5HO, 4-F32T8 | * |
| 12000 Lumens (Nominal) | WSE251-12-4L-MS(xx)-DRDM-UNV-1/840 | 10692 | 74.9 | 142.7 lm/W | -20°C / 35°C (-4°F / 95°F) | 3-F54T5HO, 6-F32T8 | * |
| 16000 Lumens (Nominal) | WSE251-16-4L-MS(xx)-DRDM-UNV-1/840 | 14434 | 97.9 | 147.4 lm/W | -20°C / 35°C (-4°F / 95°F) | 4-F54T5HO | * |
| 4' - LED LUMEN PACKAGE | NORMAL AMBIENT TEMPERATURE (HIGH EFFICACY) PRODUCT CODE | DELIVERED LUMENS | SYSTEM WATTS | LUMINAIRE EFFICACY | AMBIENT TEMP. | FLUORESCENT EQUIVALENT | IES FILES |
| 2000 Lumens (Nominal) | WSE251-2HE-4L-MS(xx)-DRDM-UNV-1/840 | 1999 | 13.5 | 147.6 lm/W | -20°C / 35°C (-4°F / 95°F) | 1-F17T8 | * |
| 4000 Lumens (Nominal) | WSE251-4HE-4L-MS(xx)-DRDM-UNV-1/840 | 3554 | 23.5 | 151.6 lm/W | -20°C / 35°C (-4°F / 95°F) | 1-F54T5HO, 2-F32T8 | * |
| 6000 Lumens (Nominal) | WSE251-6HE-4L-MS(xx)-DRDM-UNV-1/840 | 5370 | 36.4 | 147.5 lm/W | -20°C / 35°C (-4°F / 95°F) | 3-F17T8 | * |

| 8' - LED LUMEN PACKAGE | NORMAL AMBIENT TEMPERATURE PRODUCT CODE | DELIVERED LUMENS | SYSTEM WATTS | LUMINAIRE EFFICACY | AMBIENT TEMP. | FLUORESCENT EQUIVALENT | IES FILES |
|------------------------|---|------------------|--------------|--------------------|----------------------------|------------------------|--------------------------|
| 4000 Lumens (Nominal) | WSE251-4-8L-MS(xx)-DRDM-UNV-1/840 | 3491 | 25.8 | 135.5 lm/W | -20°C / 35°C (-4°F / 95°F) | 2-F32T8 | * |
| 8000 Lumens (Nominal) | WSE251-8-8L-MS(xx)-DRDM-UNV-1/840 | 6855 | 52.7 | 130.1 lm/W | -20°C / 35°C (-4°F / 95°F) | 2-F54T5HO, 4-F32T8 | LA-T3713 |
| 12000 Lumens (Nominal) | WSE251-12-8L-MS(xx)-DRDM-UNV-1/840 | 10365 | 81.9 | 126.5 lm/W | -20°C / 35°C (-4°F / 95°F) | 6-F32T8 | * |
| 16000 Lumens (Nominal) | WSE251-16-8L-MS(xx)-DRDM-UNV-1/840 | 13556 | 99.2 | 136.6 lm/W | -20°C / 35°C (-4°F / 95°F) | 4-F54T5HO, 8-F32T8 | * |
| 24000 Lumens (Nominal) | WSE251-24-8L-MS(xx)-DRDM-UNV-1/840 | 20110 | 149.2 | 134.9 lm/W | -20°C / 35°C (-4°F / 95°F) | 6-F54T5HO, 12-F32T8 | * |
| 8' - LED LUMEN PACKAGE | NORMAL AMBIENT TEMPERATURE (HIGH EFFICACY) PRODUCT CODE | DELIVERED LUMENS | SYSTEM WATTS | LUMINAIRE EFFICACY | AMBIENT TEMP. | FLUORESCENT EQUIVALENT | IES FILES |
| 4000 Lumens (Nominal) | WSE251-4HE-8L-MS(xx)-DRDM-UNV-1/840 | 3396 | 22.7 | 149.4 lm/W | -20°C / 35°C (-4°F / 95°F) | 2-F32T8 | * |
| 8000 Lumens (Nominal) | WSE251-8HE-8L-MS(xx)-DRDM-UNV-1/840 | 6710 | 45.3 | 148.2 lm/W | -20°C / 35°C (-4°F / 95°F) | 2-F54T5HO, 4-F32T8 | * |
| 12000 Lumens (Nominal) | WSE251-12HE-8L-MS(xx)-DRDM-UNV-1/840 | 10136 | 71.1 | 142.5 lm/W | -20°C / 35°C (-4°F / 95°F) | 6-F32T8 | * |

NOTE:
System data as of 8/18/23. Subject to change without notice.

System data is based on 120V input voltage. Actual performance may differ as a result of end-user environment and application. This fixture has been tested and listed in accordance with UL Standards. L.A. Lighting certifies that it will operate safely when installed properly, and within an ambient temperature range noted in the system data table.

Additional lumen packages and color temperatures available.



Los Angeles Lighting Mfg. Co.
 Contact Us
 T: 626-454-8300
 F: 626-454-8399
 www.lalighting.com
 10141 Olney Street
 El Monte, CA 91731
 Made in the USA



Due to continued product improvements and enhancements, Los Angeles Lighting Manufacturing Company reserves the right to alter specifications, dimensions, data, and/or materials without notice. Please visit our website to view the most current information.

© 2023 LOS ANGELES LIGHTING MANUFACTURING CO. ALL RIGHTS RESERVED.

Revised: 09/01/23



PHOTOMETRIC DATA

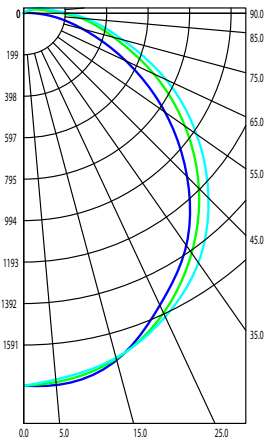

WSE251-6-4L-MS(xx)-DRDM-UNV-1/840
TEST NO. = LA-T3776b
NO. OF LED ROWS = 1
SYSTEM WATT (W) = 43.7
CRI ≥ 80
L70(Hrs.) ≥ 50,000
PHOTOMETRY TYPE = C



| ZONAL LUMEN SUMMARY | | | |
|---------------------|--------|--------|-----------|
| DEGREES | LUMENS | % LAMP | % FIXTURE |
| 0-30 | 1388 | 22 | 25 |
| 0-40 | 2271 | 36 | 41 |
| 0-60 | 4024 | 63 | 72 |
| 0-90 | 5375 | 85 | 96 |
| 90-120 | 225 | 4 | 4 |
| 90-150 | 237 | 4 | 4 |
| 90-180 | 237 | 4 | 4 |
| 0-180 | 5612 | 88 | 100.0 |

| SPACING CRITERION | |
|-------------------|--------|
| ALONG | ACROSS |
| 1.20 | 1.27 |

Luminaire Output = 5612.1 lumens
 Luminaire Efficacy = 128.5 lm/W
 Luminaire Efficiency = 88.2%

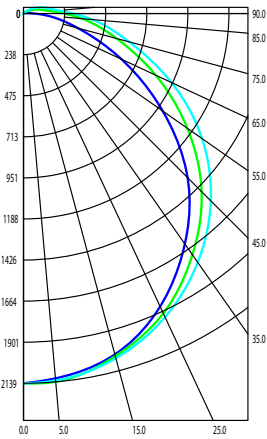

WSE251-8-8L-MS(xx)-DRDM-UNV-1/840
TEST NO. = LA-T3713
NO. OF LED ROWS = 1
SYSTEM WATT (W) = 52.7
CRI ≥ 80
L70(Hrs.) ≥ 50,000
PHOTOMETRY TYPE = C



| ZONAL LUMEN SUMMARY | | | |
|---------------------|--------|--------|-----------|
| DEGREES | LUMENS | % LAMP | % FIXTURE |
| 0-30 | 1669 | 20 | 24 |
| 0-40 | 2736 | 34 | 40 |
| 0-60 | 4880 | 60 | 71 |
| 0-90 | 6543 | 80 | 96 |
| 90-120 | 294 | 4 | 4 |
| 90-150 | 312 | 4 | 5 |
| 90-180 | 312 | 4 | 5 |
| 0-180 | 6855 | 84 | 100.0 |

| SPACING CRITERION | |
|-------------------|--------|
| ALONG | ACROSS |
| 1.21 | 1.29 |

Luminaire Output = 6854. lumens
 Luminaire Efficacy = 130.1 lm/W
 Luminaire Efficiency = 83.9%



Los Angeles Lighting Mfg. Co.
 Contact Us
 T: 626-454-8300
 F: 626-454-8399
 www.lalighting.com
 10141 Olney Street
 El Monte, CA 91731
 Made in the USA



Due to continued product improvements and enhancements, Los Angeles Lighting Manufacturing Company reserves the right to alter specifications, dimensions, data, and/or materials without notice. Please visit our website to view the most current information.

© 2023 LOS ANGELES LIGHTING MANUFACTURING CO. ALL RIGHTS RESERVED.

Revised: 09/01/23



MADE IN THE USA
 BAA Compliant