



# SECURITY

## BCW500 SERIES



# Wet Location Canopy Security Luminaire

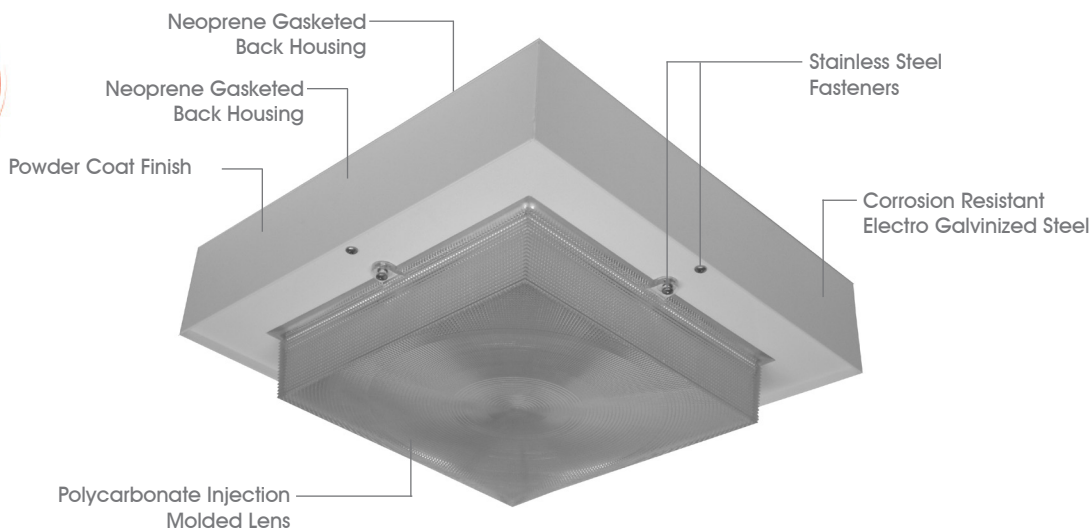

- Wet Location Canopy Security Luminaire
- Side KO's for 1/2" Conduit
- Electro Galvanized Steel Construction
- Welded and Painted After Fabrication
- Polycarbonate Injection Molded Lens
- Neoprene Gasketed Back Housing Standard
- Stainless Steel Fasteners Standard
- Lamp Included
- Suitable for Wet Location
- Available with:
  - Custom Colors
  - Photocell Sensor - On/Off
  - Occupancy Sensor
  - Tamper Proof Screws



Photometric Data and IES Files are Available on [www.lalighting.com](http://www.lalighting.com)



**LOS ANGELES LIGHTING MFG. CO.**

10141 OLNEY ST. / EL MONTE, CA 91731

TEL : 626-454-8300 FAX : 626-454-8399

[www.lalighting.com](http://www.lalighting.com)



# BCW500 SERIES

## CROSS SECTION

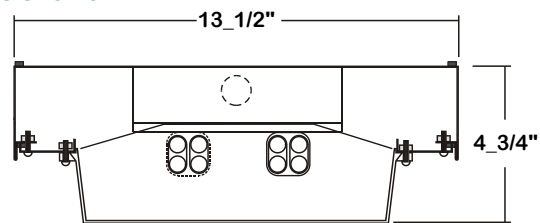

**13w and 26w 2-Lamp Compact Fluorescent Double Twin Tube**

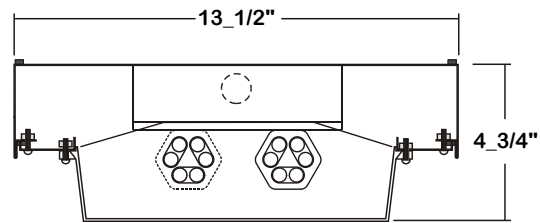

**32w 2-Lamp Compact Fluorescent Triple Twin Tube**

### BACK PLATE

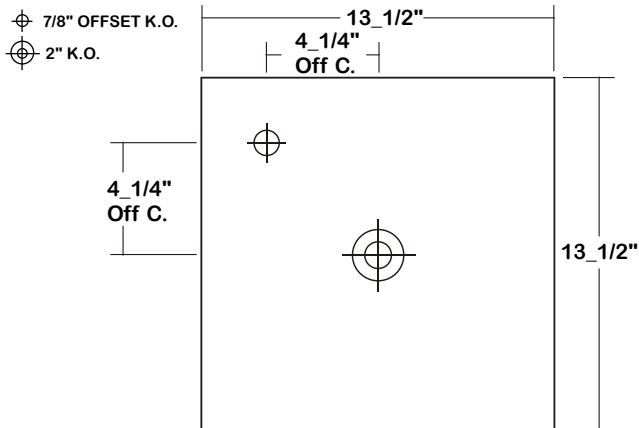

### CATALOG NUMBER

CATALOG NUMBER	LAMP WATTS	LAMP BASE	TOTAL LAMPS*
BCW500-2-1CF-2E13	13	G24q-1	2*
BCW500-2-1CF-2E26	26	G24q-3	2*
BCW500-2-1CF-2E32	32	GX24q-3	2*

Note: \*Lamps Included.

### ORDERING GUIDE

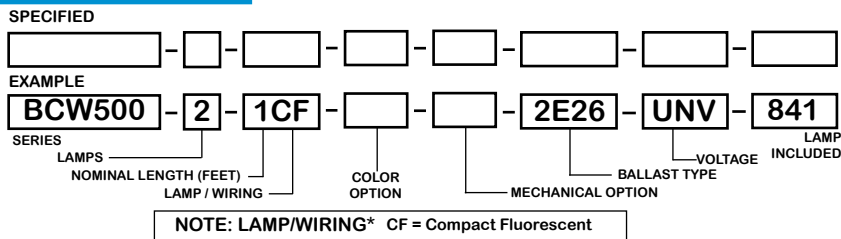

### MOTION SENSOR CONFIGURATION

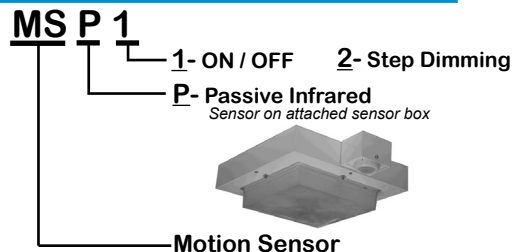

### OPTIONS AND ACCESSORIES

OPTIONS	SUFFIX	OPTIONS	SUFFIX	OPTIONS	SUFFIX
<b>COLOR OPTIONS</b>		<b>ELECTRICAL OPTIONS</b>		<b>BALLAST OPTIONS</b>	
White Standard		Photocell Sensor - On/Off	PCS	Electronic 13W Compact Fluorescent	E13
Black	BLK	Motion Sensor	MS*	Electronic 26W Compact Fluorescent	E26
Bronze	BZ	(*See Sensor Configuration)		Electronic 32W Compact Fluorescent	E32
Note: Other colors available.		Emergency Battery Pack	*		
<b>MECHANICAL OPTIONS</b>					
Tamper Proof Screws	TP				
(Hex Socket With Post)					

\*See appropriate Reference Page

### SPECIFICATIONS

- TYPE** Two lamp surface canopy compact fluorescent security luminaire for use in public spaces where vandalism may be problem, ideal for canopies, pedestrian tunnels, stairwells and parking structures. Two side knockouts for 1/2" conduit, knockout on opposite side of the fixture.
- CONSTRUCTION** 20 ga. electro galvanized steel construction, neoprene gasketed. Aluminum internal components.
- FINISH** Baked white powder coated finish, minimum reflectance 90%, paint after fabrication.
- OPTICS** Polycarbonate injection molded lens.
- PHOTOCELL SENSOR** Wet Location photocell sensor optional, fixed light level at ANSI standard 1.5 footcandle.
- MOTION SENSOR** Passive infrared wet location occupancy sensor optional, coverage 48' diameter from 8' height. Adjustable time delay from 30 seconds to 30 minutes, factory preset at 15 minutes.
- LAMP** Two 4-pin compact fluorescent lamps included.
- WIRING** 120v 60Hz., 277v 60Hz., UNV (universal voltage 120v thru 277v.) or as otherwise specified.
- LABELS** U.L. Listed. Suitable for damp locations.



**PHOTOMETRIC DATA**

BCW500-2-1CF-2E26

TEST NO.=LA-T1563-5  
 LAMP TYPE=CFQ26W-G24Q  
 NO. OF LAMP=2  
 LUMENS PER LAMP=1800  
 WATTS PER LAMP=26  
 BALLAST FACTOR=1  
 PHOTOMETRY TYPE=C

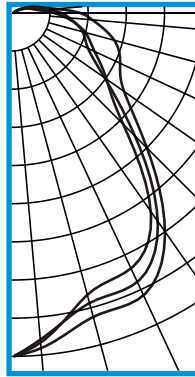
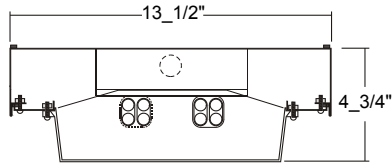

**CANDLEPOWER**

ANGLE	END	45	CROSS
0	878	878	878
5	843	835	859
15	743	766	802
25	718	756	793
35	610	642	674
45	391	433	478
55	288	280	343
65	227	209	301
75	189	182	265
85	133	142	201
90	101	122	169
95	70	89	112
105	42	50	60
115	22	19	29
125	10	5	12
135	1	0	2
145	0	0	0
155	0	0	0
165	0	0	0
175	0	0	0
180	0	0	0

**ZONAL LUMEN SUMMARY**

DEGREES	LUMENS	% LAMP	% FIXTURE
0-30	648	18.0	26.4
0-40	1052	29.2	42.8
0-60	1655	46.0	67.3
0-90	2267	63.0	92.2
90-120	184	5.1	7.5
90-150	192	5.3	7.8
90-180	192	5.3	7.8
0-180	2459	68.3	100.0

Lumen Output = 2459 lumens  
 Luminaire Efficiency = 68.3%

**SPACING CRITERION**

ALONG	ACROSS
1.14	1.23

This space is intentionally left blank.

This space is intentionally left blank.

This space is intentionally left blank.

