



BAYLIGHTER™

EBY100 SERIES High Bay Luminaire



- High Bay Luminaire
- Quarter Turn Rotary Locking Sockets
- Removable Wiring Access Plate
- Stem, Cable or Chain Mountable
- Suitable for Damp Locations
- Available with:
 - Fluorescent, LED and LED T8 (Internally Driven)
 - .040 Aluminum Fixture Housing
 - 95% Enhanced Specular Aluminum Reflectors
 - Sensor
 - Emergency Battery Pack
 - Die Cast Hub for 3/4" Pipe
 - 11ga. Wire Guard



Photometric Data and IES Files are Available on www.lalighting.com



LOS ANGELES LIGHTING MFG. CO.

10141 OLNEY ST. / EL MONTE, CA 91731

TEL : 626-454-8300 FAX : 626-454-8399

www.lalighting.com

PHOTOMETRIC DATA

EBY100-3-4M-SR-E5H

TEST NO.=LA-T0823
 LAMP TYPE=F54T5HO
 NO. OF LAMP=3
 LUMENS PER LAMP=5000
 WATTS PER LAMP=54
 BALLAST FACTOR=1
 PHOTOMETRY TYPE=C

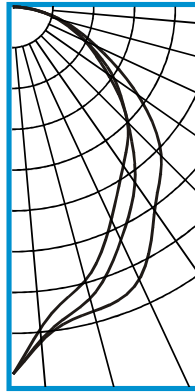
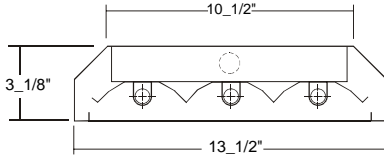

CANDLEPOWER

ANGLE	END	45	CROSS
0	6789	6789	6789
5	6195	6155	5951
15	5820	5563	5220
25	5542	4734	4310
35	4569	3930	3559
45	3870	2993	2984
55	2798	2265	2118
65	1680	1459	1451
75	911	823	889
85	213	262	229
90	9	5	8
95	0	0	0
105	0	0	0
115	0	0	0
125	0	0	0
135	0	0	0
145	0	0	0
155	0	0	0
165	0	0	0
175	0	0	0
180	0	0	0

ZONAL LUMEN SUMMARY

DEGREES	LUMENS	% LAMP	% FIXTURE
0-30	4394	29.3	31.1
0-40	6905	46.0	48.9
0-60	11510	76.7	81.5
0-90	14121	94.1	100.0
90-120	2	0.0	0
90-150	2	0.0	0
90-180	2	0.0	0
0-180	14123	94.2	100.0

Lumen Output = 14123 lumens
 Luminaire Efficiency = 94.2%

SPACING CRITERION

ALONG	ACROSS
1.12	0.87

EBY100-4-4M-SR-E5H

TEST NO.=LA-T1560
 LAMP TYPE=F54T5HO
 NO. OF LAMP=4
 LUMENS PER LAMP=5000
 WATTS PER LAMP=54
 BALLAST FACTOR=1
 PHOTOMETRY TYPE=C

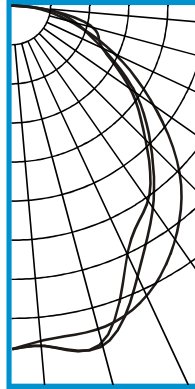
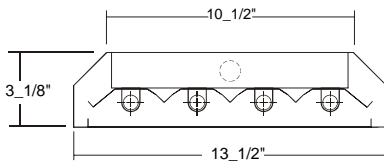

CANDLEPOWER

ANGLE	END	45	CROSS
0	6804	6804	6804
5	6664	6766	6765
15	6630	6972	6902
25	6327	5890	5405
35	5634	4858	4696
45	4689	3873	3724
55	3403	2961	2842
65	2225	1947	1989
75	1161	1300	1646
85	395	545	527
90	27	24	37
95	0	0	0
105	0	0	0
115	0	0	0
125	0	0	0
135	0	0	0
145	0	0	0
155	0	0	0
165	0	0	0
175	0	0	0
180	0	0	0

ZONAL LUMEN SUMMARY

DEGREES	LUMENS	% LAMP	% FIXTURE
0-30	5312	26.6	29.2
0-40	8460	42.3	46.5
0-60	14317	71.6	78.8
0-90	18171	90.9	100.0
90-120	8	0.0	0
90-150	8	0.0	0
90-180	8	0.0	0
0-180	18179	90.9	100.0

Lumen Output = 18179 lumens
 Luminaire Efficiency = 90.9%

SPACING CRITERION

ALONG	ACROSS
1.30	1.11

This space is intentionally left blank.

This space is intentionally left blank.

