



BAYLIGHTER™

HBS100 SERIES

Medium / Low Bay Luminaire



- Medium / Low Bay Open Strip Luminaire
- Quarter Turn Rotary Locking Sockets
- Removable Wiring Access Plate
- Stem, Cable or Chain Mountable
- Suitable for Damp Locations
- Available with:
 - Fluorescent, LED and LED T8 (Internally Driven)
 - 95% Enhanced Specular Aluminum Reflectors
 - Sensor
 - Emergency Battery Pack
 - 11ga. or 14ga. Wire Guard
 - Die Cast Hub for 3/4" Pipe



LOS ANGELES LIGHTING MFG. CO.

10141 OLNEY ST. / EL MONTE, CA 91731

TEL : 626-454-8300 FAX : 626-454-8399

www.lalighting.com

BAYLIGHTER™ - LED T8 (Internally Driven)



HBS100 SERIES - LED T8

CROSS SECTION

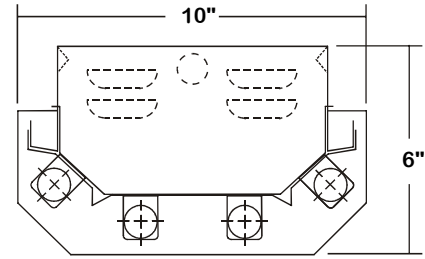

BACK PLATE

- V-HOOK
- 3/16" K.O.
- ◆ 11/16" STEM MTG. K.O.
- ⊕ 7/8" OFFSET K.O.
- ⊕ 2" K.O.
- ⊕ ACCESS PLATE

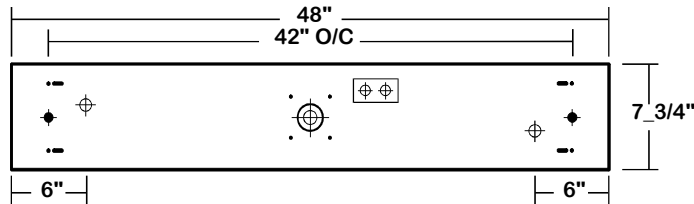

CATALOG NUMBER

	NOMINAL LENGTH	TOTAL MODULES
HBS100-3-4Lx	4'	3
HBS100-4-4Lx	4'	4
HBS100-5-4Lx	4'	5

ORDERING GUIDE

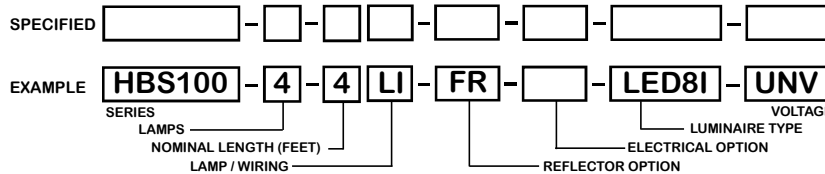

LAMP / WIRING

LI = LED T8 internal driver light tube.
Both ends powered.
Shunted sockets used.



LR = LED T8 internal driver light tube.
Single end powered.
Non-shunted sockets used.



OPTIONS AND ACCESSORIES

REFLECTOR OPTIONS

Flat Reflector, 24 ga. Cold Rolled Steel

SUFFIX

FR

ELECTRICAL OPTIONS

Motion Sensor

SUFFIX

MS

ACCESSORIES

- Wire Guard-11 Ga.
- Wire Guard-14 Ga.
- Fixture Suspension System
- Ceiling Spacer
- 6" Leg Height V-Hook
- Die Cast Hub For 3/4" Pipe

CAT. NO.

WG11-HBS100
WG11-HBS100

*
*
V6
HUB

*See appropriate reference page

SPECIFICATIONS

- TYPE
- CONSTRUCTION
- FINISH
- REFLECTOR
- WIRE GUARDS
- WIRING
- LABELS

Medium or low bay open strip for surface, pendant, or chain mounting for LED T8 internal driver light tube(s)**.
22 gauge cold rolled steel housing with louvered vents on each side for heat removal.
Quarter turn rotary locking lampholders standard. (20 GA. housing available as specified)
Baked white polyester finish, minimum reflectance 86%. (Powder coated finish available.)
24 ga. pre-paint cold rolled steel flat white reflector, minimum reflectance 86%.
Chrome epoxy powder coated.
Operates LED T8 internal driver light tube(s)**.
Suitable for damp locations.

** Lamp(s) by others.



PHOTOMETRIC DATA

HBS100-3-4Lx-FR-LED8x-UNV

TEST NO.=LA-T2281
LAMP TYPE=LED T8 Internally Driven Light Tube*
NO. OF LAMP=3
LUMENS PER LAMP=1700
WATTS PER LAMP=18.5
PHOTOMETRY TYPE=C
 * Test with major manufacturer's LED T8 light tube(s), consult L.A. Lighting for details.

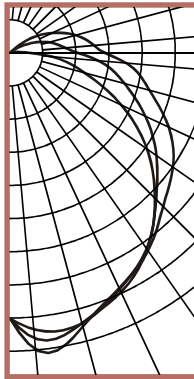
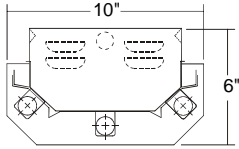

CANDLEPOWER

ANGLE	END	45	CROSS
0	1144	1144	1144
5	1283	1234	1194
15	1215	1201	1202
25	1113	1132	1118
35	1024	1028	1035
45	879	886	930
55	716	766	853
65	523	639	750
75	331	507	619
85	174	378	499
90	81	289	406
95	38	238	361
105	10	175	291
115	0	98	203
125	0	34	113
135	0	2	22
145	0	0	0
155	0	0	0
165	0	0	0
175	0	0	0
180	0	0	0

ZONAL LUMEN SUMMARY

DEGREES	LUMENS	% LAMP	% FIXTURE
0-30	979	19.2	19.2
0-40	1625	31.9	31.9
0-60	3014	59.1	59.1
0-90	4531	88.8	88.9
90-120	523	10.3	10.3
90-150	568	11.1	11.1
90-180	568	11.1	11.1
0-180	5099	100.0	100.0

Lumen Output = 5099 lumens
 Luminaire Efficiency = 100.0%

SPACING CRITERION

ALONG	ACROSS
1.37	1.39

HBS100-4-4Lx-FR-LED8x-UNV

TEST NO.=LA-T2282
LAMP TYPE=LED T8 Internally Driven Light Tube*
NO. OF LAMP=4
LUMENS PER LAMP=1700
WATTS PER LAMP=18.5
PHOTOMETRY TYPE=C
 * Test with major manufacturer's LED T8 light tube(s), consult L.A. Lighting for details.

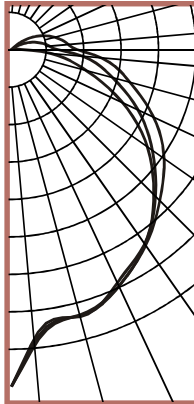
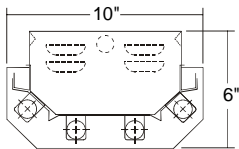

CANDLEPOWER

ANGLE	END	45	CROSS
0	2107	2107	2107
5	1788	1831	1811
15	1723	1710	1718
25	1590	1616	1615
35	1463	1465	1474
45	1257	1273	1314
55	1029	1070	1163
65	754	865	974
75	470	647	759
85	232	437	558
90	87	291	411
95	39	240	358
105	10	173	289
115	0	100	205
125	0	33	113
135	0	3	22
145	0	0	0
155	0	0	0
165	0	0	0
175	0	0	0
180	0	0	0

ZONAL LUMEN SUMMARY

DEGREES	LUMENS	% LAMP	% FIXTURE
0-30	1406	20.7	20.7
0-40	2327	34.2	34.2
0-60	4290	63.1	63.1
0-90	6229	91.6	91.6
90-120	525	7.7	7.7
90-150	570	8.4	8.4
90-180	570	8.4	8.4
0-180	6799	100.0	100.0

Lumen Output = 6799 lumens
 Luminaire Efficiency = 100.0%

SPACING CRITERION

ALONG	ACROSS
1.07	1.09

This space is intentionally left blank.

This space is intentionally left blank.

