



BAYLIGHTER™

HBW100 SERIES



Medium / Low Bay Wraparound Luminaire



- Medium / Low Bay Wraparound Luminaire
- Quarter Turn Rotary Locking Sockets
- Clear Prismatic Acrylic
- Removable Wiring Access Plate
- Stem, Cable or Chain Mountable
- Suitable for Damp Locations
- Available with:
 - Fluorescent, LED and LED T8 (Internally Driven)
 - 95% Enhanced Specular Aluminum Reflectors
 - Emergency Battery Pack
 - Sensor
 - Die Cast Hub for 3/4" Pipe



Photometric Data and IES Files are Available on www.lalighting.com



LOS ANGELES LIGHTING MFG. CO.

10141 OLNEY ST. / EL MONTE, CA 91731

TEL : 626-454-8300 FAX : 626-454-8399

www.lalighting.com

BAYLIGHTER™ - LED T8 (Internally Driven)



HBW100 SERIES - LED T8

CROSS SECTION

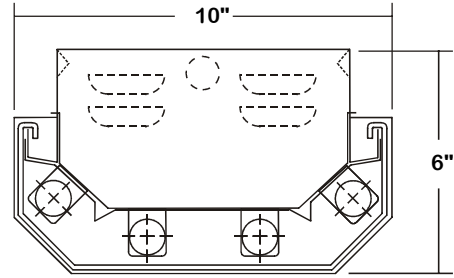

BACK PLATE

- V-HOOK
- 3/16" K.O.
- 11/16" STEM MTG. K.O.
- 7/8" OFFSET K.O.
- 2" K.O.
- ACCESS PLATE

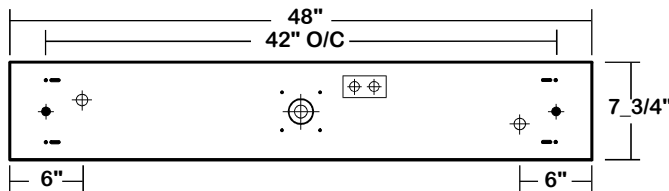

CATALOG NUMBER

	NOMINAL LENGTH	TOTAL MODULES
HBW100-3-4Lx	4'	3
HBW100-4-4Lx	4'	4
HBW100-5-4Lx	4'	5

TS2 - LED Luminaire On/Off Safety Switch



- Easily accessible on exterior of wire way.
- Allows individual fixture to be switched ON/OFF during re-lamping or Maintenance.
- Prevents damage to lamp and electrical shock during lamping and re-lamping.
- Allows safe entry to wire way channel where power connector can be disconnected for maintenance to fixture.

ORDERING GUIDE

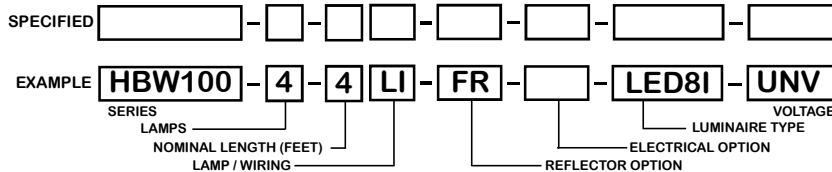

LAMP / WIRING

LI = LED T8 internal driver light tube.
Both ends powered.
Shunted sockets used.



LR = LED T8 internal driver light tube.
Single end powered.
Non-shunted sockets used.



OPTIONS AND ACCESSORIES

REFLECTOR OPTIONS	SUFFIX	ELECTRICAL OPTIONS	SUFFIX	ACCESSORIES	CAT. NO.
Flat Reflector, 24 ga. Cold Rolled Steel	FR	Motion Sensor	MS	Fixture Suspension System	*
				Ceiling Spacer	*
				6" Leg Height V-Hook	V6
				Die Cast Hub For 3/4" Pipe	HUB

*See appropriate reference page

SPECIFICATIONS

- TYPE
- CONSTRUCTION
- FINISH
- REFLECTOR
- OPTICS
- WIRING
- LABELS

Medium or low bay wraparound for surface, pendant, or chain mounting for LED T8 internal driver light tube(s)**.
22 gauge cold rolled steel housing with louvered vents on each side for heat removal.
Quarter turn rotary locking lampholders standard. (20 GA. housing available as specified)
Baked white polyester finish, minimum reflectance 86%. (Powder coated finish available.)
24 ga. pre-paint cold rolled steel flat white reflector, minimum reflectance 86%.
One piece extruded clear prismatic acrylic lens with linear side prisms, 25% DR acrylic formulation for added durability.
Operates LED T8 internal driver light tube(s)**.
Suitable for damp locations.

** Lamp(s) by others.



PHOTOMETRIC DATA

HBW100-3-4Lx-FR-LED8x-UNV

TEST NO.=LA-T2285
 LAMP TYPE=LED T8 Internally Driven Light Tube*
 NO. OF LAMP=3
 LUMENS PER LAMP=1700
 WATTS PER LAMP=18.5
 PHOTOMETRY TYPE=C
 * Test with major manufacturer's LED T8 light tube(s), consult L.A. Lighting for details.

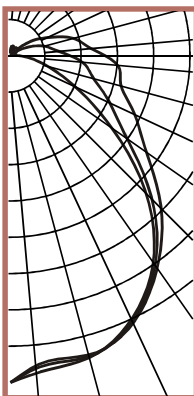
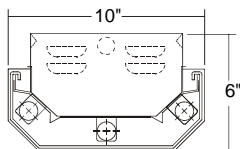

CANDLEPOWER

ANGLE	END	45	CROSS
0	1412	1412	1412
5	1375	1354	1342
15	1347	1344	1337
25	1249	1258	1267
35	1078	1093	1110
45	824	861	920
55	526	611	715
65	301	471	591
75	159	371	495
85	72	311	465
90	40	259	410
95	22	212	351
105	17	156	286
115	23	93	187
125	33	35	113
135	41	10	26
145	43	19	3
155	36	34	26
165	25	44	29
175	15	29	39
180	10	10	10

ZONAL LUMEN SUMMARY

DEGREES	LUMENS	% LAMP	% FIXTURE
0-30	1093	21.4	23.1
0-40	1780	34.9	37.6
0-60	3003	58.9	63.5
0-90	4130	81.0	87.4
90-120	491	9.6	10.4
90-150	569	11.2	12.0
90-180	597	11.7	12.6
0-180	4727	92.7	100.0

Lumen Output = 4727 lumens
 Luminaire Efficiency = 92.7%

SPACING CRITERION

ALONG	ACROSS
1.21	1.24

HBW100-4-4Lx-FR-LED8x-UNV

TEST NO.=LA-T2286
 LAMP TYPE=LED T8 Internally Driven Light Tube*
 NO. OF LAMP=4
 LUMENS PER LAMP=1700
 WATTS PER LAMP=18.5
 PHOTOMETRY TYPE=C
 * Test with major manufacturer's LED T8 light tube(s), consult L.A. Lighting for details.

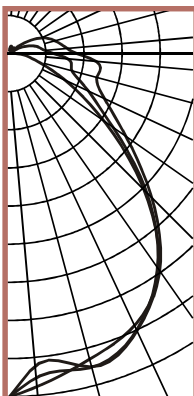
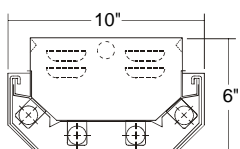

CANDLEPOWER

ANGLE	END	45	CROSS
0	2116	2116	2116
5	2058	2001	1926
15	1946	2000	2000
25	1841	1869	1874
35	1604	1591	1616
45	1159	1187	1231
55	671	765	865
65	362	529	641
75	170	396	557
85	82	358	532
90	38	270	414
95	29	217	356
105	18	172	295
115	24	104	229
125	33	38	124
135	39	13	28
145	45	24	6
155	36	34	23
165	32	45	38
175	21	38	37
180	14	14	14

ZONAL LUMEN SUMMARY

DEGREES	LUMENS	% LAMP	% FIXTURE
0-30	1617	23.8	26.4
0-40	2622	38.6	42.8
0-60	4237	62.3	69.1
0-90	5490	80.7	89.6
90-120	523	7.7	8.5
90-150	609	9.0	9.9
90-180	638	9.4	10.4
0-180	6128	90.1	100.0

Lumen Output = 6128 lumens
 Luminaire Efficiency = 90.1%

SPACING CRITERION

ALONG	ACROSS
1.20	1.21

This space is intentionally left blank.

This space is intentionally left blank.

