



# BAYLIGHTER™

## IBT300 SERIES High Bay Luminaire



with FLUORESCENT LAMPS



with LED T8 LAMPS

- High Bay Luminaire
- Quarter Turn Rotary Locking Sockets
- Removable Wiring Access Plate
- Stem, Cable or Chain Mountable
- Suitable for Damp Locations
- Available with:
  - Fluorescent, LED and LED T8 (Internally Driven)
  - .040 Aluminum Fixture Housing
  - Frame & Lens Assembly (Available in 4' Fixture Only)
  - 95% Enhanced Specular Aluminum Reflectors
  - Sensor
  - Emergency Battery Pack
  - Die Cast Hub for 3/4" Pipe
  - 11 ga. Wire Guard

Photometric Data and IES Files are Available on [www.lalighting.com](http://www.lalighting.com)



**LOS ANGELES LIGHTING MFG. CO.**  
 10141 OLNEY ST. / EL MONTE, CA 91731  
**TEL : 626-454-8300 FAX : 626-454-8399**  
[www.lalighting.com](http://www.lalighting.com)



# IBT300 SERIES

## CROSS SECTION

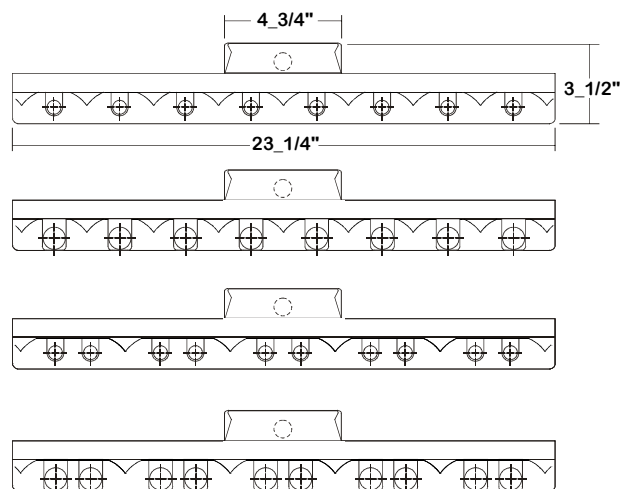

● ALUMINUM REFLECTOR SECURED WITH QUARTER TURN FASTENERS FOR EASE OF MAINTENANCE.

## CATALOG NUMBER

	NOMINAL LENGTH	TOTAL LAMPS
IBT300-8-4M	4'	8
IBT300-10-4M	4'	10
IBT300-8-4R	4'	8
IBT300-10-4R	4'	10

## BACK PLATE

- V-HOOK
- 3/16" K.O.
- ◆ 11/16" STEM MTG. K.O.
- ⊕ ACCESS PLATE
- ⊕ 7/8" OFFSET K.O.
- ⊕ 2" K.O.

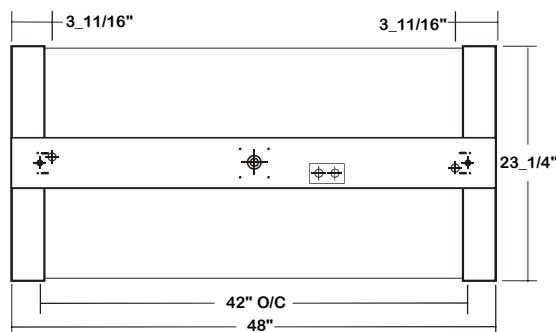

## HUB FOR 3/4" PIPE

Aluminum die cast hub for 3/4" pipe with safety cable set. Each set consists of:

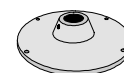

- One Hub .
- 8' cable, one end free and the other end secured within fixture.
- Self-locking device secures the free end to ceiling member.

\*Please see Page REF-5 for mounting detail.

## ORDERING GUIDE

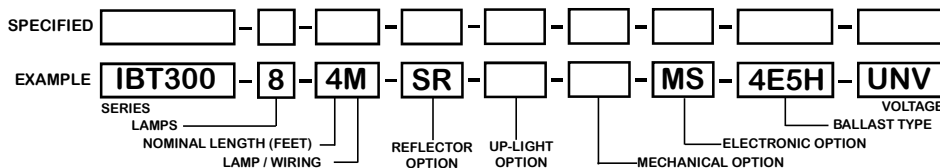

**NOTE: LAMP/WIRING\***  
 M= Miniature Bi-Pin T5  
 R = Medium Bi-Pin T8

## OPTIONS AND ACCESSORIES

● REFLECTOR OPTIONS	SUFFIX	● ELECTRICAL OPTIONS	SUFFIX	● ACCESSORIES	CAT.NO.
Specular Aluminum Reflector (95%)	SR	Emergency Battery Pack	BP*	Wire Guard - 11 Ga.	WG11-IBT300
White Aluminum Reflector (90%)	WR	External Line Fusing (HLR/GLR)	ELF	Fixture Suspension System	*
		Motion Sensor	MS	Ceiling Spacer	*
● UP-LIGHT OPTIONS	SUFFIX	● BALLAST OPTIONS	SUFFIX	4" Leg Height V-Hook	V4
Up-light	U	Electronic T5	E5*		
		Electronic T5HO	E5H		
● MECHANICAL OPTIONS	SUFFIX	Electronic Step Dimming T5HO	ESDM5H		
Die Cast Hub For 3/4" Pipe, For 4' Only	HUB	Electronic T8	E8*		
		Electronic Step Dimming T8	ESDM8*		

\*See Appropriate Reference Page

## SPECIFICATIONS

- TYPE: High bay open light luminaire for stems, cable or chain mounting.
- CONSTRUCTION: 22 gauge cold rolled steel housing. Quarter turn rotary locking lampholders standard. (20 ga. C.R.S. and .040 aluminum housing available as specified)
- FINISH: Baked white polyester finish, minimum reflectance 86%. (Powder coated finish available.)
- REFLECTOR: Specular aluminum reflector standard, 95% reflectance (White aluminum reflector available). Slotted up-light reflector optional.
- WIRING: 120v 60Hz., 277v 60Hz., UNV (universal voltage 120v thru 277v.) or as otherwise specified. Multiple levels of switching available as specified.
- LABELS: Suitable for damp locations.



**PHOTOMETRIC DATA**

**IBT300-8-4M-SR-E5H**

TEST NO.=LA-T1571  
 LAMP TYPE=F54T5HO  
 NO. OF LAMP=8  
 LUMENS PER LAMP=5000  
 WATTS PER LAMP=54  
 BALLAST FACTOR=1  
 PHOTOMETRY TYPE=C

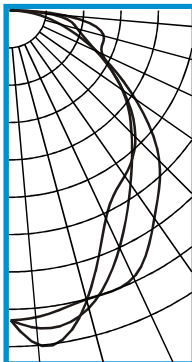
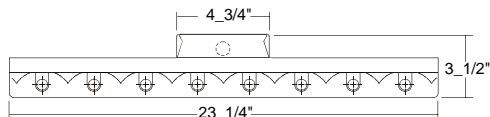

**CANDLEPOWER**

ANGLE	END	45	CROSS
0	13887	13887	13887
5	13793	14296	15066
15	13378	13746	13344
25	13142	11610	10156
35	11251	9376	8973
45	9408	7656	7904
55	6741	6068	6110
65	4179	4174	4514
75	2226	3071	4314
85	721	1781	2335
90	34	269	406
95	3	43	124
105	0	0	1
115	0	0	1
125	0	0	0
135	0	0	0
145	0	0	0
155	0	0	0
165	0	0	0
175	0	0	0
180	0	0	0

**ZONAL LUMEN SUMMARY**

DEGREES	LUMENS	% LAMP	% FIXTURE
0-30	10593	26.5	28.1
0-40	16714	41.8	44.3
0-60	28635	71.6	75.9
0-90	37638	94.1	99.7
90-120	113	0.3	0.3
90-150	113	0.3	0.3
90-180	113	0.3	0.3
0-180	37751	94.4	100.0

Lumen Output = 37751 lumens  
 Luminaire Efficiency = 94.4%

**SPACING CRITERION**

ALONG	ACROSS
1.28	1.03

**IBT300-8-4R-SR-E8**

TEST NO.=LA-T1736  
 LAMP TYPE=FO32T8  
 NO. OF LAMP=8  
 LUMENS PER LAMP=2900  
 WATTS PER LAMP=32  
 BALLAST FACTOR=1  
 PHOTOMETRY TYPE=C

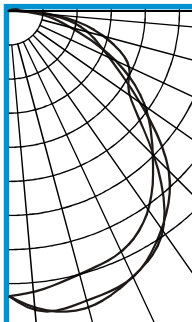
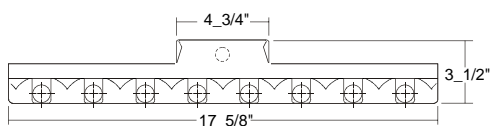

**CANDLEPOWER**

ANGLE	END	45	CROSS
0	6331	6331	6331
5	6262	6663	6607
15	6052	6660	6813
25	5896	6519	6510
35	5389	5908	5954
45	4517	5012	4548
55	3689	3556	3274
65	2612	2461	2943
75	1422	1810	2180
85	581	866	1003
90	66	205	316
95	6	120	213
105	0	45	127
115	0	6	37
125	0	0	0
135	0	0	0
145	0	0	0
155	0	0	0
165	0	0	0
175	0	0	0
180	0	0	0

**ZONAL LUMEN SUMMARY**

DEGREES	LUMENS	% LAMP	% FIXTURE
0-30	5424	23.4	25.4
0-40	9061	39.1	42.4
0-60	15914	68.6	74.5
0-90	21155	91.2	99.0
90-120	218	0.9	1.0
90-150	218	0.9	1.0
90-180	218	0.9	1.0
0-180	21373	92.1	100.0

Lumen Output = 21373 lumens  
 Luminaire Efficiency = 92.1%

**SPACING CRITERION**

ALONG	ACROSS
1.32	1.43

**IBT300-10-4M-SR-E5H**

TEST NO.=LA-T1929  
 LAMP TYPE=F54T5HO  
 NO. OF LAMP=10  
 LUMENS PER LAMP=5000  
 WATTS PER LAMP=54  
 BALLAST FACTOR=1  
 PHOTOMETRY TYPE=C

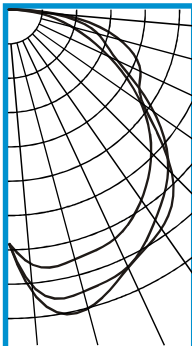
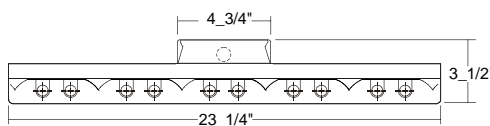

**CANDLEPOWER**

ANGLE	END	45	CROSS
0	11078	11078	11078
5	12103	13181	13523
15	12234	13817	14641
25	11952	13417	13452
35	10964	12119	12634
45	9537	10679	10922
55	7610	8347	7764
65	5211	5655	6881
75	3053	4352	5413
85	1063	1976	2351
90	83	258	397
95	4	44	126
105	1	0	8
115	0	0	0
125	0	0	0
135	0	0	0
145	1	0	0
155	0	0	0
165	2	0	0
175	0	0	0
180	0	0	0

**ZONAL LUMEN SUMMARY**

DEGREES	LUMENS	% LAMP	% FIXTURE
0-30	11137	22.3	24.2
0-40	18649	37.3	40.6
0-60	33938	67.9	73.8
0-90	45859	91.7	99.7
90-120	115	0.2	0.3
90-150	115	0.2	0.3
90-180	115	0.2	0.3
0-180	45975	91.9	100.0

Lumen Output = 45975 lumens  
 Luminaire Efficiency = 91.9%

**SPACING CRITERION**

ALONG	ACROSS
1.49	1.63

**IBT300-10-4R-SR-E8**

TEST NO.=LA-T2231  
 LAMP TYPE=FO32T8  
 NO. OF LAMP=10  
 LUMENS PER LAMP=2900  
 WATTS PER LAMP=32  
 BALLAST FACTOR=1  
 PHOTOMETRY TYPE=C

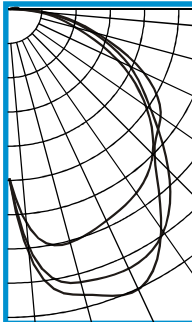
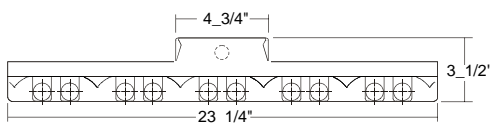

**CANDLEPOWER**

ANGLE	END	45	CROSS
0	4422	4422	4422
5	5696	6336	6568
15	6301	7378	7728
25	6074	7463	8057
35	5831	7054	6921
45	5307	5874	5369
55	4340	4498	4831
65	3110	3457	3848
75	1755	2187	2329
85	700	854	1007
90	57	210	339
95	8	115	242
105	1	55	133
115	1	12	43
125	0	0	4
135	0	0	0
145	0	0	0
155	0	0	0
165	0	0	0
175	0	0	0
180	0	0	0

**ZONAL LUMEN SUMMARY**

DEGREES	LUMENS	% LAMP	% FIXTURE
0-30	5986	20.6	23.7
0-40	10205	35.2	40.4
0-60	18621	64.2	73.6
0-90	25053	86.4	99.1
90-120	235	0.8	0.9
90-150	236	0.8	0.9
90-180	236	0.8	0.9
0-180	25289	87.2	100.0

Lumen Output = 25289 lumens  
 Luminaire Efficiency = 87.2%

**SPACING CRITERION**

ALONG	ACROSS
1.80	1.87

