



METAL SIDED

MDH430/440 SERIES



Metal Sided Surface Mounted Luminaire



- 3X3 / 4X4 Metal Sided Surface Mounted Deep Housing Luminaire
- 20 Gauge Cold Rolled Steel Welded Housing
- Powder Coated Finish / Painted After Fabrication
- 2" Deep Regressed Extruded Aluminum Door Frame
- T-Hinges And Spring Loaded Latches
- One Way Polyurethane Gasketed
- Suitable for Damp Locations
- Available with:
 - Fluorescent, LED and LED T8 (Internally Driven)
 - Variety of Lenses
 - Emergency Battery Pack



Photometric Data and IES Files are Available on www.lalighting.com



LOS ANGELES LIGHTING MFG. CO.

10141 OLNEY ST. / EL MONTE, CA 91731

TEL : 626-454-8300 FAX : 626-454-8399

www.lalighting.com



MDH430/440 SERIES

CROSS SECTION

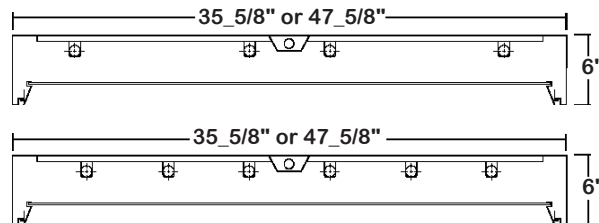

BACK PLATE

- 3/8" K.O. ◆ 11/16" STEM MTG. K.O. ⊕ 7/8" OFFSET K.O. ⊕ 2" K.O.

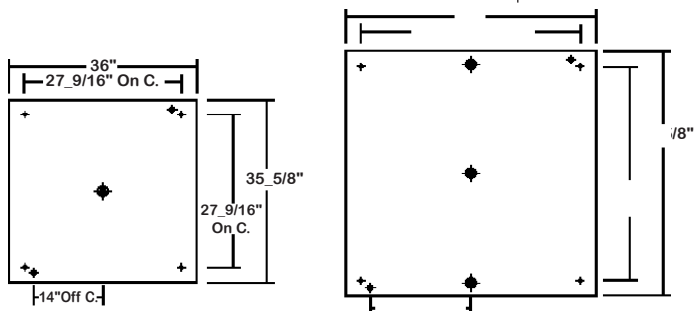

DOOR FRAME INFORMATION

● CROSS SECTION

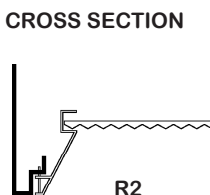

R2 W

FINISHES

- W - White Enamel
- B - Black Enamel
- N - Natural Anodized Aluminum

STYLES

- R2 - 2" Regress

CATALOG NUMBER

	NOMINAL WIDTH X LENGTH	TOTAL LAMPS		NOMINAL WIDTH X LENGTH	TOTAL LAMPS		NOMINAL WIDTH X LENGTH	TOTAL LAMPS
MDH430-4-3M	3' X 3'	4	MDH440-4-4M	4' X 4'	4	MDH440-4-4R	4' X 4'	4
MDH430-6-3M	3' X 3'	6	MDH440-6-4M	4' X 4'	6	MDH440-6-4R	4' X 4'	6
MDH430-4-3R	3' X 3'	4	MDH440-8-4M	4' X 4'	8	MDH440-8-4R	4' X 4'	8
MDH430-6-3R	3' X 3'	6						

Note: * 1_1/2" Ceiling Spacers Are Required When Using T5HO Lamps.

ORDERING GUIDE

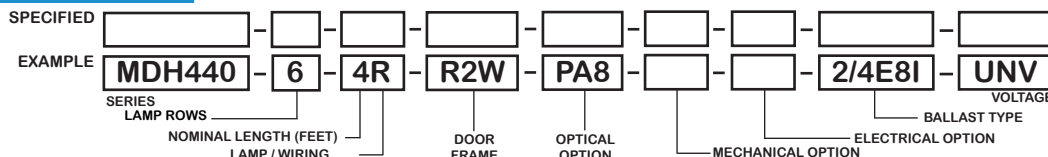

NOTE: LAMP/WIRING*

- M= Miniature Bi-Pin T5
- R = Medium Bi-Pin T8

OPTIONS AND ACCESSORIES

● OPTICAL OPTIONS

- Clear Prismatic Acrylic Nom .187
- Polycarbonate Lenses
- High Impact Acrylic
- Note: Other lens available upon request

SUFFIX

- PA8
- *
- *

● MECHANICAL OPTIONS

- Gasketing
- Emergency Battery Pack
- External Line Fusing (HLR/GLR)

SUFFIX

- GSK*
- BP*
- ELF

● BALLAST OPTIONS*

- Electronic T5
- Electronic T5HO
- Electronic T8 Instant Start
- Electronic T8 Rapid Start
- Electronic T8HO

SUFFIX

- xE5
- xE5H
- xE8I
- xE8R
- xE8H

● ACCESSORIES

- Fixture Suspending System

CAT. NO.

*

*Refer to www.lalighting.com/resources for more information

SPECIFICATIONS

● TYPE

Surface mounted, metal sided deep housing, available in various lengths and widths. Specifically designed to accommodate 2" deep regressed extruded aluminum door frame.

● CONSTRUCTION

20 ga. cold rolled steel welded housing.

● FINISH

Baked white powder coated finish, minimum reflectance 90%, painted after fabrication.

● DOOR FRAME

Heavy wall 2" deep aluminum extrusion. T-hinge, positive spring loaded latch. Two gussets installed in each corner for maximum strength and true miter alignment.

● GASKET

One way polyurethane gasketed standard. More options available.

● OPTICS

Clear prismatic acrylic Nom .187 OA thickness standard. All 4x4 fixtures are supplied with one-piece pattern 12, .187 clear acrylic lenses standard. Extensive variety of lenses, diffusers and louvers available.

● WIRING

120v 60Hz., 277v 60Hz., UNV (universal voltage 120v thru 277v.) or as otherwise specified.

● LABELS

U.L. Listed. Suitable for damp locations.



PHOTOMETRIC DATA

MDH440-6-4R-R2W-PA8-E8

TEST NO.=LA-T0565
 LAMP TYPE=FO32T8
 NO. OF LAMP=6
 LUMENS PER LAMP=2900
 WATTS PER LAMP=32
 BALLAST FACTOR=1
 PHOTOMETRY TYPE=C

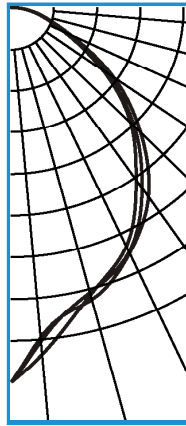
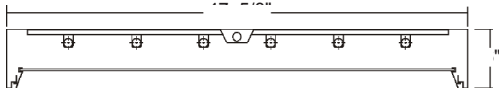

CANDLEPOWER

ANGLE	END	45	CROSS
0	5524	5524	5524
5	5107	5575	5495
15	5480	5357	5484
25	4985	5236	5505
35	4059	4474	4821
45	2681	3022	3232
55	1292	1437	1556
65	494	536	546
75	145	158	175
85	26	29	33
90	1	1	3
95	0	0	0
105	0	0	0
115	0	0	0
125	0	0	0
135	0	0	0
145	0	0	0
155	0	0	0
165	0	0	0
175	0	0	0
180	0	0	0

ZONAL LUMEN SUMMARY

DEGREES	LUMENS	% LAMP	% FIXTURE
0-30	4482	25.8	38.6
0-40	7282	41.8	62.8
0-60	10880	62.5	93.8
0-90	11596	66.6	100.0
90-120	0	0.0	0
90-150	0	0.0	0
90-180	0	0.0	0
0-180	11597	66.6	100.0

Lumen Output = 11597 lumens
 Luminaire Efficiency = 66.6%

SPACING CRITERION

ALONG	ACROSS
1.20	1.35

This space is intentionally left blank.

This space is intentionally left blank.

This space is intentionally left blank.

