

LED T8 - METAL SIDED

MHL320 SERIES

2X2/2X4/2X8 Metal Sided Luminaire



- 2x2, 2x4 & 2x8 Metal Sided Luminaire For LED T8 Light Tube (by Others)
- T-Hinge And Spring Loaded Latch
- Door Frame Screwed At Each Corner
- Welded And Painted After Fabrication
- Available with:
 - Heavy Duty Safety Switch
 - Extensive Variety of Lenses



LOS ANGELES LIGHTING MFG. CO.

10141 OLNEY ST. / EL MONTE, CA 91731

<http://www.lalighting.com>

TEL: 626-454-8300 FAX: 626-454-8399

MHL320-4-4L-PA-LED8

TEST NO.=LA-T1853
 LAMP TYPE=LED T8, 4'
 NO. OF LAMP=4
 LUMENS PER LAMP=1300
 WATTS PER LAMP=15
 BALLAST FACTOR=1
 PHOTOMETRY TYPE=C

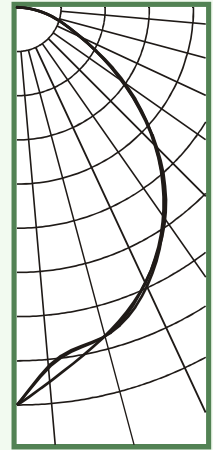

CANDLEPOWER

Angle	End	45	Cross
0	1798	1798	1798
5	1699	1630	1636
15	1538	1539	1540
25	1374	1391	1374
35	1153	1160	1169
45	883	888	895
55	579	594	582
65	314	319	319
75	168	171	165
85	49	49	50
90	5	5	4
95	0	0	0
105	0	0	0
115	0	0	0
125	0	0	0
135	0	0	0
145	0	0	0
155	0	0	0
165	0	0	0
175	0	0	0
180	0	0	0

ZONAL LUMEN SUMMARY

DEGREES	LUMENS	% LAMP	% FIXTURE
0-30	1234	23.7	33.2
0-40	1964	37.8	52.8
0-60	3179	61.1	85.5
0-90	3714	71.4	100.0
90-120	1	0.0	0.0
90-150	1	0.0	0.0
90-180	1	0.0	0.0
0-180	3716	71.5	100.0

Luminaire Efficiency = 71.5%

SPACING CRITERION

ALONG	ACROSS
1.06	1.06

LED T8 - METAL SIDED

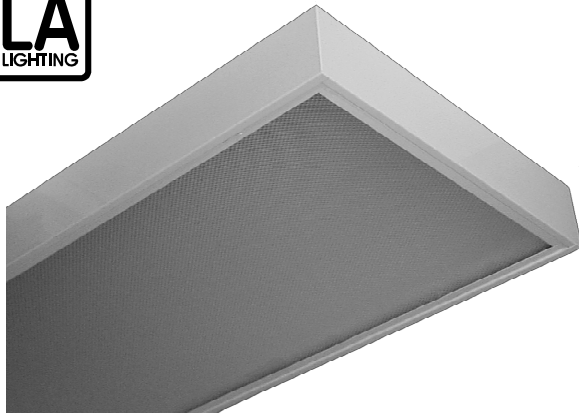

MHL320 SERIES - LED T8

CROSS SECTION

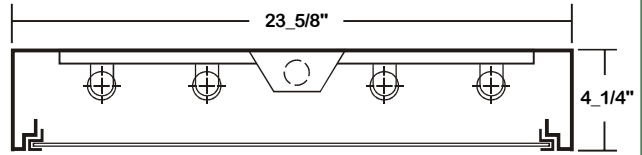

BACK PLATE

- 3/8" K.O.
- ◆ 11/16" STEM MTG. K.O.
- ⊕ 7/8" OFFSET K.O.
- ⊙ 2" K.O.

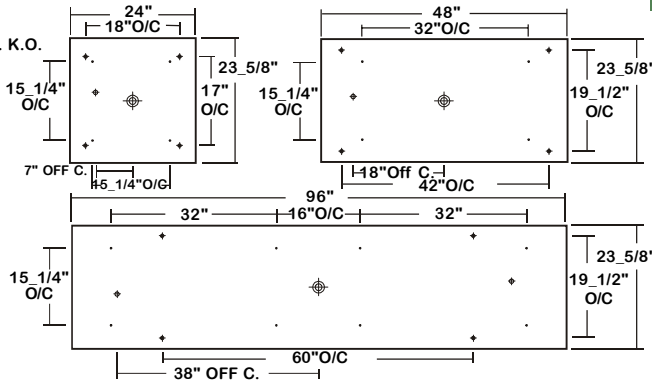

DOOR FRAME INFORMATION

CROSS SECTION

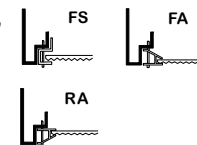

FS W

FINISHES

- W - White Enamel
- B - Black Enamel
- N - Natural Anodized Aluminum

STYLES

- FS - Flat Steel
- FA - Flat Extruded Aluminum
- RA - 5/8" Regressed Extruded Aluminum

CATALOG NUMBER

NOMINAL TOTAL LENGTH LAMPS		NOMINAL TOTAL LENGTH LAMPS		NOMINAL TOTAL LENGTH LAMPS		NOMINAL TOTAL LENGTH LAMPS		NOMINAL TOTAL LENGTH LAMPS	
MHL320-2-2LI	2' 2	MHL320-2-8LIT	8' 4	MHL320-3-4LI	4' 3	MHL320-4-2LI	2' 4	MHL320-4-8LIT	8' 8
MHL320-2-2LR	2' 2	MHL320-2-8LRT	8' 4	MHL320-3-4LR	4' 3	MHL320-4-2LR	2' 4	MHL320-4-8LRT	8' 8
MHL320-2-2LO	2' 2	MHL320-2-8LOT	8' 4	MHL320-3-4LO	4' 3	MHL320-4-2LO	2' 4	MHL320-4-8LOT	8' 8
MHL320-2-4LI	4' 2	MHL320-3-2LI	2' 3	MHL320-3-8LIT	8' 6	MHL320-4-4LI	4' 4		
MHL320-2-4LR	4' 2	MHL320-3-2LR	2' 3	MHL320-3-8LRT	8' 6	MHL320-4-4LR	4' 4		
MHL320-2-4LO	4' 2	MHL320-3-2LO	2' 3	MHL320-3-8LOT	8' 6	MHL320-4-4LO	4' 4		

ORDERING GUIDE

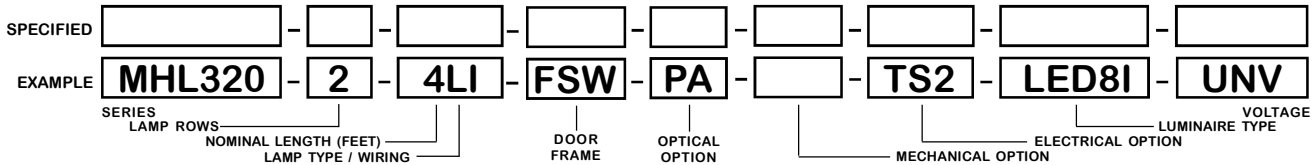

LAMP TYPE

LI = LED T8 internal driver light tube.
Both ends powered.
Shunted sockets used.

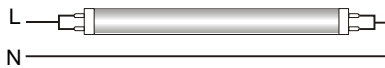

LR = LED T8 internal driver light tube.
Single end powered.
Non-shunted sockets used.



OPTIONS AND ACCESSORIES

- **OPTICAL OPTIONS**
- Parabolic Plastic Louvers
- Polycarbonate Lenses High Impact Acrylic
- Flat Frosted White Acrylic
- Clear Prismatic Acrylic

SUFFIX
*
*
*
FFWA
PA

- **MECHANICAL OPTIONS**
- Gasketing

SUFFIX
GSK

- **ELECTRICAL OPTIONS**
- LED Luminaire ON/OFF Safety Switch

SUFFIX
TS2

- **ACCESSORIES**
- Fixture Suspension System

CAT.NO.
*

*See Appropriate Reference Page

SPECIFICATIONS

- **TYPE**
- **CONSTRUCTION**
- **FINISH**
- **DOOR FRAME**
- **OPTICS**
- **WIRING**
- **LABELS**

Surface mounted, metal sided, modular luminaire for LED T8 light tube (s)** with internal driver. Available in various lengths. **** Lamp(s) by others.**
20 ga. cold rolled steel welded housing.
Baked white powder coated finish, minimum reflectance 90%, painted after fabrication.
20 gauge cold rolled steel or extruded aluminum in various finishes. T-hinge, positive spring loaded latch.
Clear prismatic acrylic standard. Lenses on 2x8 fixtures supplied two-piece unless otherwise specified.
Extensive variety of lenses, diffusers and louvers available.
Operates T8 LED light tube(s)**.
UL standard 1598 - SUB 8750.

