

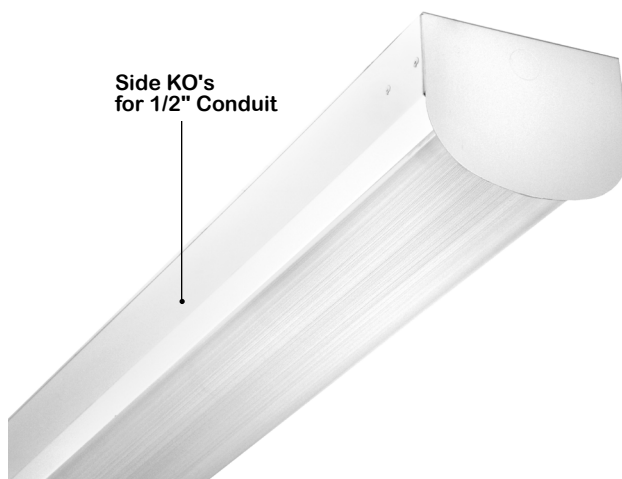

WRAPAROUND

WSE250 SERIES Parking Structure Luminaire



- Parking Structure Luminaire
- Side KO's For 1/2" Conduit
- Aluminum Housing
- Baked White Polyester Finish
- Snap-On Radial Clear Ribbed Acrylic Lens
- Suitable for Damp Locations
- Available with:
 - Fluorescent, LED and LED T8 (Internally Driven)
 - 95% Enhanced Specular Aluminum Reflectors
 - Emergency Battery Pack



Photometric Data and IES Files are Available on www.lalighting.com



LOS ANGELES LIGHTING MFG. CO.
 10141 OLNEY ST. / EL MONTE, CA 91731
TEL : 626-454-8300 FAX : 626-454-8399
www.lalighting.com

WALL BRACKET - Fluorescent

LED Equivalent Products Available on www.lalighting.com



Side KO's for 1/2" Conduit

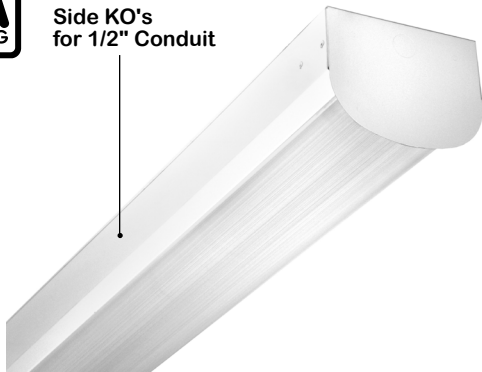

WSE250 SERIES

CROSS SECTION

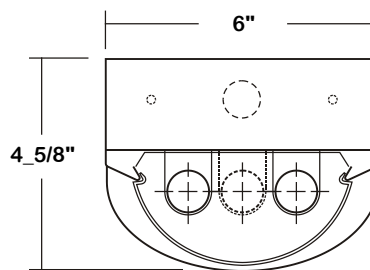

BACK PLATE

- ◆ 11/16" STEM MTG. K.O.
- ⊕ 7/8" OFFSET K.O.
- ⊕ 2" K.O.
- 7/8" K.O. ON SIDE OF HOUSING FOR 1/2" CONDUIT

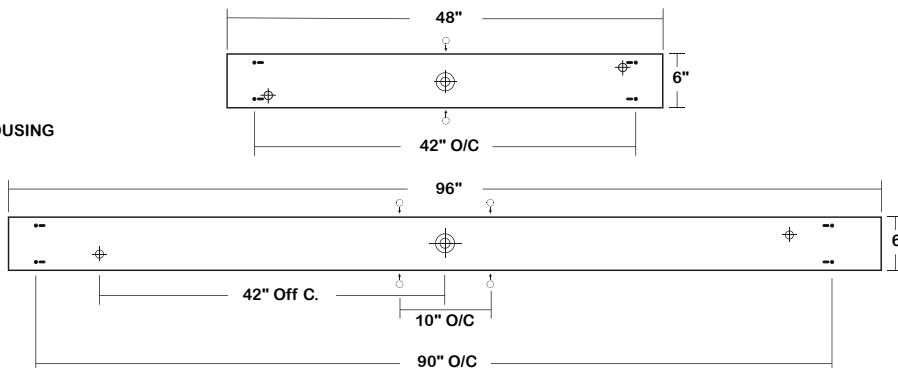

CATALOG NUMBER

	NOMINAL LENGTH	TOTAL LAMPS		NOMINAL LENGTH	TOTAL LAMPS
WSE250-1-4M	4'	1	WSE250-1-4R	4'	1
WSE250-1-8MT	8'	2	WSE250-1-8RT	8'	2
WSE250-2-4M	4'	2	WSE250-2-4R	4'	2
WSE250-2-8MT	8'	4	WSE250-2-8RT	8'	4
WSE250-3-4M	4'	3	WSE250-3-4R	4'	3
WSE250-3-8MT	8'	6	WSE250-3-8RT	8'	6

ORDERING GUIDE

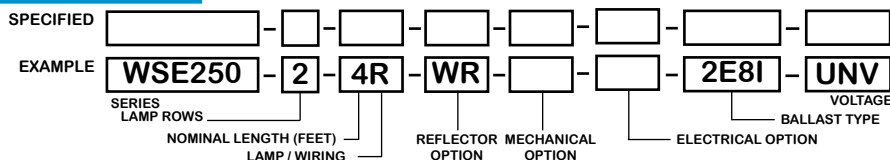

NOTE: LAMP/WIR-
 M= Miniature Bi-Pin T5
 MT= Miniature Bi-Pin T5 Tandem Wiring
 R= Medium Bi-Pin T8
 RT= Medium Bi-Pin T8 Tandem Wiring

OPTIONS AND ACCESSORIES

REFLECTOR OPTIONS

- Specular Aluminum Reflector (95%)
- White Reflector

SUFFIX
 SR
 WR

ELECTRICAL OPTIONS

- Emergency Battery Pack
- External Line Fusing (HLR/GLR)

SUFFIX
 BP*
 ELF

BALLAST OPTIONS*

- Electronic T5
- Electronic T5HO
- Electronic T8 Instant Start
- Electronic T8 Rapid Start
- Electronic T8HO

SUFFIX
 xE5
 xE5H
 xE8I
 xE8R
 xE8H

ACCESSORIES

- Fixture Suspension System

CAT.NO.
 *

*Refer to www.lalighting.com/resources for more information

SPECIFICATIONS

- **TYPE** 1,2 or 3 lamps parking structure luminaire.
- **CONSTRUCTION** Aluminum housing with riveted end plates.
- **FINISH** Baked white polyester finish, minimum reflectance 90%.
- **REFLECTOR** White reflector standard, (95% reflectance specular aluminum reflector available).
- **OPTICS** 4' snap-on radial clear acrylic ribbed lens, end neoprene gasket available. Two lenses per 8' fixture.
- **WIRING** 120v 60Hz., 277v 60Hz., UNV (universal voltage 120v thru 277v.) or as otherwise specified.
- **LABELS** U.L. Listed. Suitable for damp locations.



PHOTOMETRIC DATA

WSE250-2-4R-WR-E8

TEST NO.=LA-T1785
 LAMP TYPE=FO32T8
 NO. OF LAMP=2
 LUMENS PER LAMP=2900
 WATTS PER LAMP=32
 BALLAST FACTOR=1
 PHOTOMETRY TYPE=C

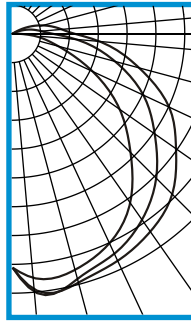
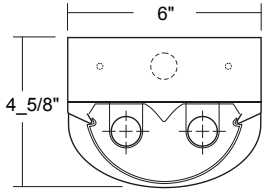

CANDLEPOWER

ANGLE	END	45	CROSS
0	1022	1022	1022
5	1071	1134	1122
15	1066	1107	1124
25	1007	1058	1093
35	897	989	1052
45	728	888	988
55	570	758	872
65	382	629	754
75	204	462	571
85	89	278	380
90	27	175	271
95	12	127	217
105	1	70	141
115	0	18	63
125	0	1	5
135	0	0	0
145	0	0	0
155	0	0	0
165	0	0	0
175	0	0	0
180	0	0	0

ZONAL LUMEN SUMMARY

DEGREES	LUMENS	% LAMP	% FIXTURE
0-30	906	15.6	20.6
0-40	1523	26.3	34.6
0-60	2862	49.3	65.0
0-90	4159	71.7	94.4
90-120	243	4.2	5.5
90-150	245	4.2	5.6
90-180	245	4.2	5.6
0-180	4404	75.9	100.0

Lumen Output = 4404 lumens
 Luminaire Efficiency = 75.9%

SPACING CRITERION

ALONG	ACROSS
1.36	1.55

This space is intentionally left blank.

This space is intentionally left blank.

This space is intentionally left blank.

