



# STRIP LIGHT

LED

## STW 100 (8FT) SERIES (2' AND 3' AND 4' AVAILABLE)

2\_1/4" WIDE LENSED STRIP WRAPAROUND LUMINAIRE

DATE	
JOB	

WWW.LALIGHTING.COM  
626-454-8300

### SURFACE / SUSPENSION MOUNTED LED LUMINAIRE

### DIMENSIONS



\*FRWA Lens Shown

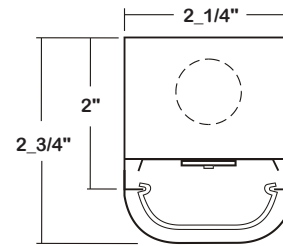

- 3/16" MTG. HOLE
- ◆ 11/16" STEM MTG. K.O.
- ⊕ 7/8" K.O.
- V-HOOK

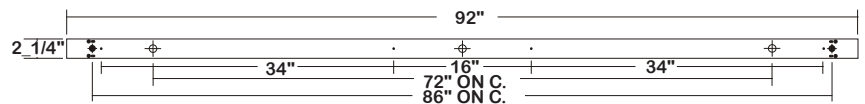

### APPLICATIONS

- Retail, Warehouse, Industrial, Office, Corridor, Stairwell, Parking Structure, Assembly Line, Aisle Lighting, Commercial

### FEATURES

- End plates may be used as channel couplings
- 0-10V dimming driver standard (See *DRIVER OPTIONS* for other dimming types)
- Supports California Title 24 compliance

### OPTIONS

- Full customization available upon request
- Additional lumen packages and color temperatures available
- Controls and sensors available (See *SENSOR OPTIONS* for controls and sensors)
- Wireless control options available (See *SENSOR OPTIONS* for wireless controls)
- Emergency battery pack available (See *BATTERY PACK OPTIONS* for battery pack options)
- Cable suspension systems available (See *ACCESSORIES* for suspension options)
- Chain mount coupling available (See *ACCESSORIES* for details)
- Painted after fabrication available
- Tunable white available (2700K-6500K)

### SPECIFICATIONS

#### CONSTRUCTION

- 22 ga. cold rolled steel housing
- End plates fastened to housing by sheet metal screws to assure rigidity

#### OPTICAL

- Frosted acrylic lens (two per unit)
- Frosted white acrylic lens (two per unit)

#### FINISH

- Baked white polyester finish / minimum reflectance 86%
- End plates - baked white powder coated finish / painted after fabrication

#### ELECTRICAL

- High efficiency drivers coupled with long-life LEDs
- Service life greater than 50,000 hours (L70)
- Universal voltage 120V through 277V (347V / 480V available)
- Power Factor (PF) ≥ 0.9
- Total Harmonic Distortion (THD) ≤ 20%

#### LISTING

- UL USA and Canada listed / suitable for damp locations

#### WARRANTY

- 5-year limited warranty



**Los Angeles Lighting Mfg. Co.**  
 Headquarters  
 10141 Olney Street  
 El Monte, CA 91731  
 Made in the USA

Contact Us  
 T: 626-454-8300  
 F: 626-454-8399  
 www.lalighting.com



Due to continued product improvements and enhancements, Los Angeles Lighting Manufacturing Company reserves the right to alter specifications, dimensions, data, and/or materials without notice. Please visit our website to view the most current information.

**MADE IN THE U.S.A.**

Revised 04-24-19

**WARNING**

**ORDERING INFORMATION**

**EXAMPLE:** STW100-12-8L-FRWA-DRDM-UNV-1/840

SERIES	LED LUMEN PACKAGE	EFFICACY	NOMINAL LENGTH	OPTICAL	MECHANICAL	ELECTRICAL	DRIVER	VOLTAGE	# OF LED ROW	CRI / CCT
STW100			8L				DRDM	UNV	1	
STW100 2_1/4" Wide Lensed Strip Wraparound LED Luminaire	4 Nom. 4000 Lumens 8 Nom. 8000 Lumens 12 Nom. 12000 Lumens 16 Nom. 16000 Lumens  *Additional Lumen Packages Available	(Blank) Standard  HE High Efficacy (Only 4000 / 8000 / 12000 lumens Systems)	8L 8'	FRA Frosted Acrylic  FRWA Frosted White Acrylic	PAF Painted After Fabrication  *Leave Blank if Not Specified	BPLSL1.5 Emergency Battery Pack, Slim Casing, Nom. 1500 lm  See BATTERY PACK OPTIONS for Options  MSxx Motion Sensor  WLC(LED RU) EnOcean Wireless Control  See SENSOR OPTIONS for Options  *Leave Blank if Not Specified  Additional Electrical Options	DRDM 0-10V Dimming Driver  See DRIVER OPTIONS for Options	UNV 120V-277V  See DRIVER OPTIONS for Options	1 One LED Row	830 80+CRI / 3000K Color Temp.  835 80+CRI / 3500K Color Temp.  840 80+CRI / 4000K Color Temp.  850 80+CRI / 5000K Color Temp.  *Additional Color Temp. Available

**SYSTEM DATA**

THESE ARE THE MOST POPULAR LUMEN PACKAGES. PLEASE CONSULT FACTORY FOR ADDITIONAL SYSTEM DATA.

LED LUMEN PACKAGE	NORMAL AMBIENT TEMPERATURE PRODUCT CODE	DELIVERED LUMENS	SYSTEM WATTS	LUMINAIRE EFFICACY	AMBIENT TEMP.	FLUORESCENT / HID EQUIVALENT	IES FILES
4000 Lumens (Nominal)	STW100-4-8L-FRWA-DRDM-UNV-1/840	3252 lm	28.7 W	113.4 lm/W	-20°C / 35°C	2-F32T8	*
8000 Lumens (Nominal)	STW100-8-8L-FRWA-DRDM-UNV-1/840	6496 lm	63.6 W	102.1 lm/W	-20°C / 35°C	4-F32T8, 2-F54T5HO	*
12000 Lumens (Nominal)	STW100-12-8L-FRWA-DRDM-UNV-1/840	9651 lm	100.7 W	95.8 lm/W	-20°C / 35°C	6-F32T8	<a href="#">LA-T3394</a>
16000 Lumens (Nominal)	STW100-16-8L-FRWA-DRDM-UNV-1/840	12772 lm	103.3 W	123.6 lm/W	-20°C / 35°C	8-F32T8, 4-F54T5HO	*

LED LUMEN PACKAGE	NORMAL AMBIENT TEMPERATURE (HIGH EFFICACY) PRODUCT CODE	DELIVERED LUMENS	SYSTEM WATTS	LUMINAIRE EFFICACY	AMBIENT TEMP.	FLUORESCENT EQUIVALENT	IES FILES
4000 Lumens (Nominal)	STW100-4HE-8L-FRWA-DRDM-UNV-1/840	3191 lm	22.5 W	141.7 lm/W	-20°C / 35°C	2-F32T8	*
8000 Lumens (Nominal)	STW100-8HE-8L-FRWA-DRDM-UNV-1/840	6304 lm	46.4 W	135.9 lm/W	-20°C / 35°C	4-F32T8, 2-F54T5HO	*
12000 Lumens (Nominal)	STW100-12HE-8L-FRWA-DRDM-UNV-1/840	9523 lm	73.6 W	129.4 lm/W	-20°C / 35°C	6-F32T8	*

**NOTE:**

System data is based on 120V input voltage. Actual performance may differ as a result of end-user environment and application.

This fixture has been tested and listed in accordance with UL Standards. L.A. Lighting certifies that it will operate safely when installed properly, and within an ambient temperature range noted in the system data table.

Additional lumen packages and color temperatures available.

**PERFORMANCE DATA**

[VIEW PHOTOMETRICS](#)



**Los Angeles Lighting Mfg. Co.**  
Headquarters  
10141 Olney Street  
El Monte, CA 91731  
Made in the USA

Contact Us  
T: 626-454-8300  
F: 626-454-8399  
www.lalighting.com



Due to continued product improvements and enhancements, Los Angeles Lighting Manufacturing Company reserves the right to alter specifications, dimensions, data, and/or materials without notice. Please visit our website to view the most current information.

**MADE IN THE U.S.A.**

Revised 04-24-19

**WARNING**

**SENSOR OPTIONS****DRY AND DAMP LOCATIONS - HIGH / LOW AISLE MOUNTING APPLICATIONS - END MOUNT****MS - Motion Sensor**

- Turns light ON/OFF based on motion detection
- Fixture mounting height 8-45'
- Universal Voltage (120V-277V)
- 480V available

**MSSD - Motion Sensor – Step Dimming**

- Step-dims light to desired preset level (based on motion detection)
- Used in conjunction with 0-10V Ballast/Driver
- Fixture mounting height 8-45'
- Universal Voltage (120V-277V)

**MSPC - Motion Sensor & Photocell**

- Holds lights OFF when sufficient daylight is present regardless of motion detection
- Fixture mounting height 8-45'
- Universal Voltage (120V-277V)

**MSPCD(ADC) - Motion Sensor & PhotoCell Dimming (Auto Dim Control)**

- Variably dims output to desired preset footcandle level through photocell ON/OFF with motion detection
- Used in conjunction with 0-10V Ballast/Driver
- Fixture mounting height 8-45'
- Universal Voltage (120V-277V)

**MSPCD(ANL) - Motion Sensor & Photocell Dimming (Auto Night Light)**

- Variably dims output to desired footcandles through photocell
- Low setting when unoccupied (full on with motion)
- For 24 hour use
- Used in conjunction with 0-10V Ballast/Driver
- Fixture mounting height 8-45'
- Universal Voltage (120V-277V)

**MSPCDR - Motion Sensor & Photocell Dimming (Setup with Remote Control)**

- Field adjustable dimming sensor capabilities:
  - Step Dim (HIGH/LOW output)
  - Auto Dim Control (dim to desired footcandles, ON/OFF with motion)
  - Auto Night Light (dim to desired footcandles, LOW without motion)
- Used in conjunction with 0-10V dimming Ballast /Driver
- Holds lights OFF when sufficient daylight is present regardless of motion detection
- Adjustable ramp up and fade down time
- Fixture mounting height 8-40'
- Universal Voltage (120V-277V)
- Remote setup and adjustment with handheld wireless tool (sold separately)

**PCS - Photocell Sensor**

- Turns light ON/OFF based on light levels
- Fixture mounting height 8-45'
- Universal Voltage (120V-277V)

**PCD - Photocell Dimming**

- Dims output to desired footcandles through photocell
- Used in conjunction with 0-10V Ballast/Driver
- Fixture mounting height 8-45'
- Universal Voltage (120V-277V)

**CONTROLS AND SENSORS****WLC(LED RU) - EnOcean® LED Relay Zone Controller**

- Supports a single LED fixture or multiple daisy chained LED fixtures
- Module installed inside lighting fixture

**ESRPU-W-EO - EnOcean® Rocker Switch – Single – Surface Mount**

- Wireless single rocker switch with mounting plate
- No batteries needed

**EDRPU-W-EO - EnOcean® Rocker Switch – Double – Surface Mount**

- Wireless double rocker switch with mounting plate
- No batteries needed

**S3054-N300 - EnOcean® Navigan NWC 300U – Commissioning Tool**

- Navigan Wireless Commissioner is used to configure EnOcean controllers & sensors
- It can be used to define link tables, change parameters/settings, and to edit & store projects
- Configuration settings can be saved and cloned to enable quick configuration
- Connectivity is through the NWC 300U USB Stick

**EOSWU-W-EO - EnOcean® Occupancy Sensor – Wall Mount**

- Wireless wall mounted occupancy sensor
- Solar powered - no batteries needed (coin battery operated in low light conditions)
- PIR motion sensor with both wide angle (50') and long range (100') options
- Mounting height: 6-8 feet

**EOSCU-W-EO - EnOcean® Occupancy Sensor – Ceiling Mount**

- Wireless ceiling mounted occupancy sensor
- Solar powered - no batteries needed (coin battery operated in low light conditions)
- PIR motion sensor with 360 degree viewing angle lens (34' diameter)
- Mounting height: 7-10 feet

**ELLSU-W-EO - EnOcean® Light Level Sensor – Ceiling Mount**

- Light Level sensor that measures and reports the level of available natural light
- Solar powered - no batteries needed (coin battery operated in low light conditions)
- Enables implementation of daylight harvesting control systems
- Mounting position: At the ceiling, close to ambient light source

**Los Angeles Lighting Mfg. Co.**

Headquarters  
10141 Olney Street  
El Monte, CA 91731  
Made in the USA

Contact Us  
T: 626-454-8300  
F: 626-454-8399  
www.lalighting.com



Due to continued product improvements and enhancements, Los Angeles Lighting Manufacturing Company reserves the right to alter specifications, dimensions, data, and/or materials without notice. Please visit our website to view the most current information.

**MADE IN THE U.S.A.**

Revised 04-24-19

**WARNING**

**DRIVER OPTIONS**

PLEASE CONSULT FACTORY TO SEE IF YOUR SELECTED DRIVER OPTION WORKS WITH THIS FIXTURE.

**DRDM - UNV**

\* Normal Stock Item

**VOLTAGE**

- 120V 120 Volt
- 277V 277 Volt
- UNV\* Universal 120-277 Volt
- 347V 347 Volt
- 480V 480 Volt

**DRIVER TYPE**

- DRDM\* 0-10V Dimming Driver
- DRDM1 0-10V Dimming Driver, 1% Dimming
- DRDM2C 2-Channel 0-10V Dimming Driver (for Color Tunable White)
- DR2W 2-Wire Phase Dimming Driver
- DRDA Digital Addressable DALI Dimming Driver
- DRDA2C Digital Addressable DALI Type8 2-Channel Driver (for Color Tunable White)
- DRDA2.0 Digital Addressable DALI 2.0 Dimming Driver
- DRDA2.02C Digital Addressable DALI 2.0 Type8 2-Channel Driver (for Color Tunable White)
- DRSD Step Dimming Driver
- DR(LTEA2W) Lutron® 2-Wire 1% Dimming Driver (120V Forward Phase only)
- DR(LDE1) Lutron® EcoSystem 1% Soft-On, Fade-to-Black™ Dimming Driver
- DR(LDE5) Lutron® EcoSystem 5% Dimming Driver
- DR(PEQ0) Lutron® EcoSystem 0.1% Soft-On, Fade-to-Black Dimming Driver
- DR(PSQ0) Lutron® T-Series Digital 1% Dimming 2-Channel Driver (for Color Tunable White)

**# OF DRIVERS SPECIFIED**

- (Blank) Not Specified
- # Number of Drivers Specified per Lighting Fixture

**BATTERY PACK OPTIONS**

PLEASE CONSULT FACTORY TO SEE IF YOUR SELECTED BATTERY PACK OPTION WORKS WITH THIS FIXTURE.

**BPL**

**LUMEN PACKAGE**

- 0.7 Nominal 750 Lumens
- 1.5 Nominal 1500 Lumens
- 3.0 Nominal 3000 Lumens

\*Additional lumen packages available

**TYPE**

- (Blank) Normal Ambient Temp. / Standard Operation
- C Cold Environment (-20°C)
- F With Flex for Remote Mounting
- SL Slim Casing
- ST Self Test / Diagnostic

\*Additional options available

**ACCESSORIES**

**V4**

- 4" Leg Height V-Hook
- Two (2) per fixture

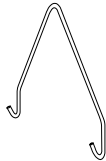

**CMC-STW100**

- Chain mount coupling with Lift-Up tabs for installation of V-Hooks when chain mounted
- Baked white enamel finish

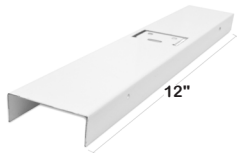

**YTCS10**

- Y-Toggle-End / Cable Suspension System

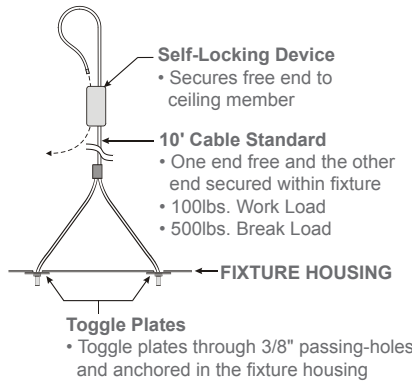

**V4CS10**

- V-Hook / Cable Suspension System
- Cable set with V4 hooks

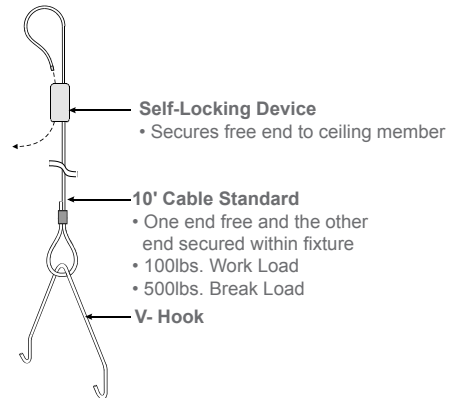

**Los Angeles Lighting Mfg. Co.**  
 Headquarters  
 10141 Olney Street  
 El Monte, CA 91731  
 Made in the USA

Contact Us  
 T: 626-454-8300  
 F: 626-454-8399  
 www.lalighting.com



Due to continued product improvements and enhancements, Los Angeles Lighting Manufacturing Company reserves the right to alter specifications, dimensions, data, and/or materials without notice. Please visit our website to view the most current information.

**MADE IN THE U.S.A.**

Revised 04-24-19

**WARNING**

**PHOTOMETRIC DATA - STW100\_8FT SERIES**

**STW100-8-8L-FRWA-DRDM-UNV-1/840**

TEST NO.=LA-T3403  
 LED TYPE= 48 LED MODULE  
 NO. OF MODULE=4  
 SYSTEM WATT (W)=62.1  
 CRI ≥ 80  
 L70(Hrs.) ≥ 50,000  
 PHOTOMETRY TYPE=C

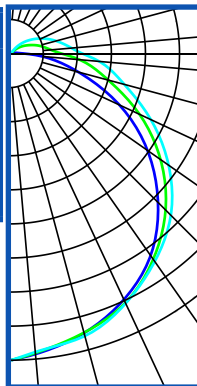
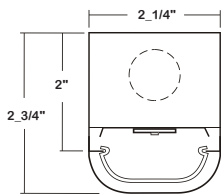

**CANDLEPOWER**

ANGLE	END	45	CROSS
0	1758	1758	1758
5	1726	1720	1714
15	1652	1651	1671
25	1547	1568	1571
35	1400	1427	1444
45	1190	1253	1297
55	949	1042	1099
65	675	806	879
75	390	571	668
85	173	391	505
90	74	288	408
95	38	231	349
105	17	170	272
115	5	114	203
125	0	70	138
135	0	29	79
145	0	6	28
155	0	0	1
165	0	0	0
175	0	0	0
180	0	0	0

**ZONAL LUMEN SUMMARY**

DEGREES	LUMENS	% LAMP	% FIXTURE
0-30	1357	16	21
0-40	2252	27	35
0-60	4146	50	64
0-90	5884	71	91
90-120	521	6	8
90-150	616	7	9
90-180	616	7	9
0-180	6499	79	100

Luminaire Output= 6499.2 lumens  
 Luminaire Efficacy = 104.7 lm/W

**SPACING CRITERION**

ALONG	ACROSS
1.25	1.27

**STW100-16-8L-FRWA-DRDM-UNV-1/840**

TEST NO.=LA-T3404  
 LED TYPE= 48 LED MODULE  
 NO. OF MODULE=4  
 SYSTEM WATT (W)=99.2  
 CRI ≥ 80  
 L70(Hrs.) ≥ 50,000  
 PHOTOMETRY TYPE=C

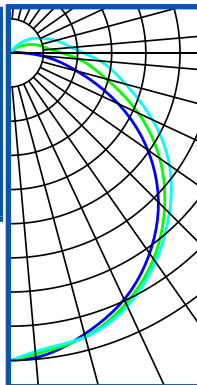
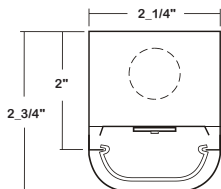

**CANDLEPOWER**

ANGLE	END	45	CROSS
0	3446	3446	3446
5	3425	3386	3355
15	3255	3286	3290
25	3038	3086	3120
35	2727	2804	2842
45	2345	2444	2522
55	1872	2038	2174
65	1324	1575	1751
75	760	1107	1331
85	346	763	1004
90	145	574	820
95	76	451	692
105	35	330	534
115	10	220	387
125	1	136	276
135	0	59	158
145	0	12	55
155	0	0	2
165	0	0	0
175	0	0	0
180	0	0	0

**ZONAL LUMEN SUMMARY**

DEGREES	LUMENS	% LAMP	% FIXTURE
0-30	2680	17	21
0-40	4436	27	35
0-60	8146	50	64
0-90	11561	71	91
90-120	1019	6	8
90-150	1208	7	9
90-180	1208	7	9
0-180	12769	79	100

Luminaire Output= 12768.9 lumens  
 Luminaire Efficacy = 128.7 lm/W

**SPACING CRITERION**

ALONG	ACROSS
1.24	1.29

