

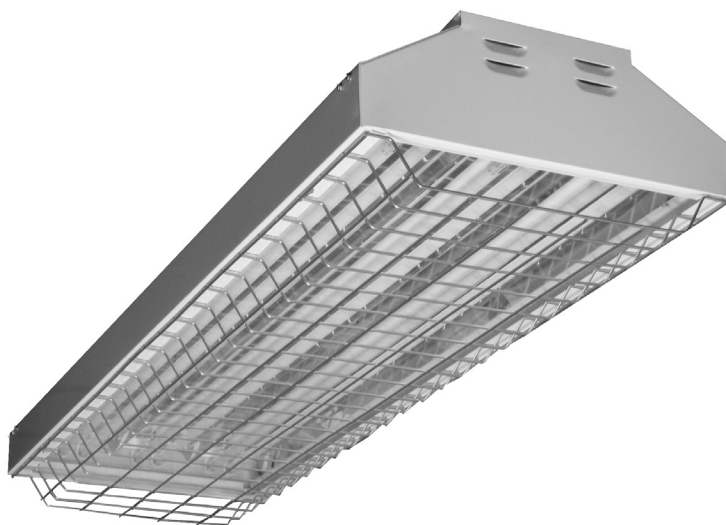

# BAYLIGHTER™

## HBI682 SERIES

### Rugged Gymnasium Luminaire



- Rugged Gymnasium Luminaire
- Wall / Beam / Truss Mount Applications
- Multi-Level Switching
- Heavy Gauge Cold Rolled Steel Welded Construction
- Powder Coated Finish / Painted After Fabrication
- Removable Wiring Access Plate
- Available with:

Fluorescent, LED and LED T8 (Internally Driven)  
 Frame & Lens Assembly With Safety Cables  
 95% Enhanced Specular Aluminum Reflectors  
 11 ga. Wire Guard  
 Sensor  
 Emergency Battery Pack  
 Custom Colors

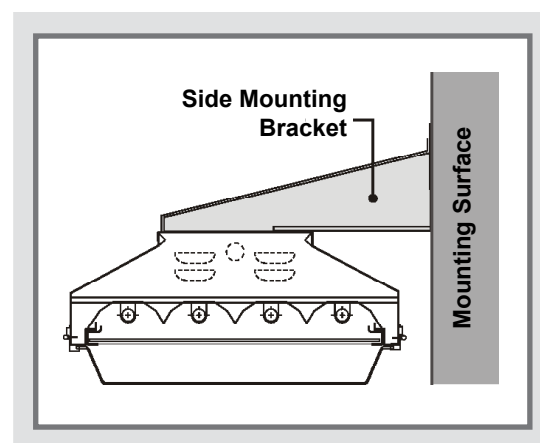

Photometric Data and IES Files are Available on [www.lalighting.com](http://www.lalighting.com)



**LOS ANGELES LIGHTING MFG. CO.**

10141 OLNEY ST. / EL MONTE, CA 91731

TEL : 626-454-8300 FAX : 626-454-8399

[www.lalighting.com](http://www.lalighting.com)

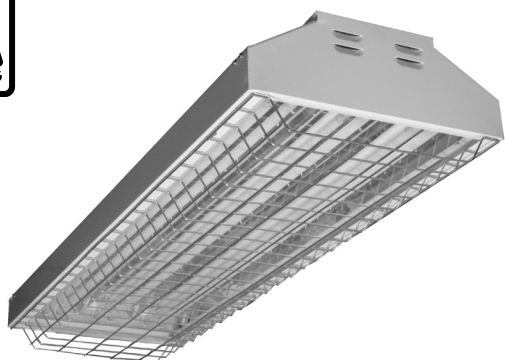

# HBI682 SERIES

## CROSS SECTION

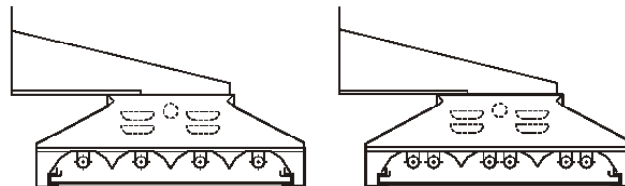
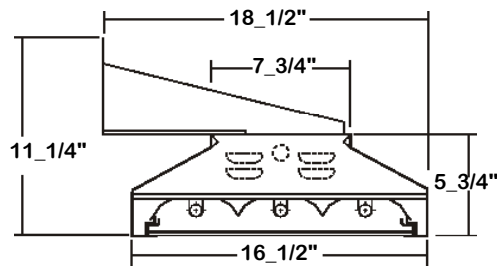

## CATALOG NUMBER

	NOMINAL LENGTH	TOTAL LAMPS
HBI682-3-4M	4'	3
HBI682-4-4M	4'	4
HBI682-6-4M	4'	6
HBI682-3-4R	4'	3
HBI682-4-4R	4'	4
HBI682-6-4R	4'	6

## BACK PLATE

- ⊕ 7/8" OFFSET K.O.
- ⊕ 2" K.O.
- ⊕ ACCESS PLATE

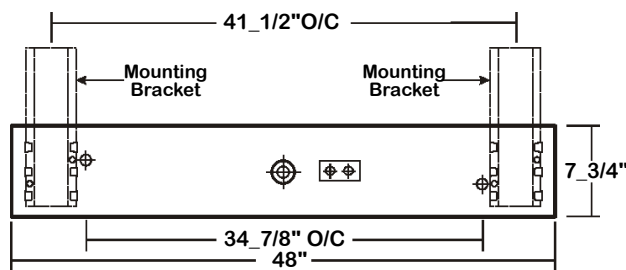

## MOUNTING DETAIL

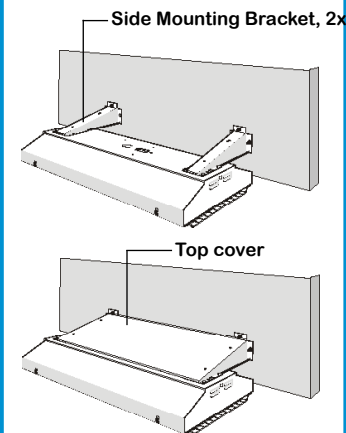

## ORDERING GUIDE

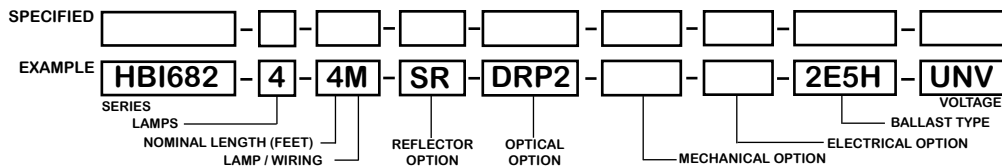

**NOTE: LAMP/WIRING\* M= Miniature Bi-PinT5 R= Medium Bi-Pin T8**

## OPTIONS AND ACCESSORIES

- |   |   |  |  |  |  |
|---|---|--|--|--|--|
| <ul style="list-style-type: none"> <li>● <b>REFLECTOR OPTIONS</b></li> <li>Specular Aluminum Reflector (95%)</li> <li>White Aluminum Reflector (90%)</li> </ul>   | <p>SUFFIX</p> <p>SR</p> <p>WR</p>   | <ul style="list-style-type: none"> <li>● <b>MECHANICAL OPTIONS</b></li> <li>Gasketing</li> </ul>   | <p>SUFFIX</p> <p>GSK*</p>                                | <ul style="list-style-type: none"> <li>● <b>BALLAST OPTIONS</b></li> <li>Electronic Ballasts T8</li> <li>Electronic T8 Step Dimming</li> <li>Electronic Ballast T5</li> <li>Electronic Ballast T5HO</li> <li>Electronic T5HO Step Dimming</li> </ul> | <p>SUFFIX</p> <p>E8*</p> <p>E8SD</p> <p>E5</p> <p>E5H</p> <p>E5HSD</p> |
| <ul style="list-style-type: none"> <li>● <b>OPTICAL OPTIONS</b></li> <li>Clear Acrylic</li> <li>Clear Prismatic Acrylic</li> <li>Clear Polycarbonate .125</li> <li>Clear Prismatic Polycarbonate .125</li> <li>High Impact Clear Prismatic Acrylic .125</li> <li>High Impact Clear Prismatic Acrylic .187</li> <li>* Other Lens Available Upon Request</li> </ul> | <p>SUFFIX</p> <p>CA</p> <p>PA</p> <p>CPC2</p> <p>PPC2</p> <p>DRP2</p> <p>DRP8</p> | <ul style="list-style-type: none"> <li>● <b>ELECTRICAL OPTIONS</b></li> <li>Emergency Battery Pack</li> <li>External Line Fusing (HLR/GLR)</li> <li>Radio Interference Filters</li> <li>Motion Sensor</li> </ul> | <p>SUFFIX</p> <p>BP*</p> <p>ELF</p> <p>RIF</p> <p>MS</p> | <ul style="list-style-type: none"> <li>● <b>ACCESSORIES</b></li> <li>Wire Guard - 11 Ga.</li> </ul>  | <p>CAT.NO.</p> <p>WG11-HBI682</p>                                      |
- \*See appropriate reference page

## SPECIFICATIONS

- **TYPE** Gymnasium luminaire with two mounting brackets for wall, beam and truss mounting applications.
- **CONSTRUCTION** 20 gauge cold rolled steel welded housing. Quarter turn rotary locking lampholders standard.
- **FINISH** Baked white powder coated finish , minimum reflectance 90%. Painted after fabrication.
- **REFLECTOR** Enhanced aluminum reflectors, 95% reflectance. High reflectance white aluminum reflector available.
- **DOOR FRAME** 20 gauge cold rolled steel door frame standard. T-hinges and positive spring loaded latches. Safety cables attached.
- **OPTICS** Clear or prismatic acrylic lens standard. Extensive variety of lenses, diffusers and louvers available.
- **MTG. BRACKET** 18 gauge cold rolled steel side mounting brackets, baked white powder coated finish.
- **WIRE GUARDS** 11ga. chrome epoxy powder coated wire guard optional.
- **WIRING** 120v 60Hz., 277v 60Hz., UNV (universal voltage 120v thru 277v.) or as otherwise specified. Multiple levels of switching available as specified.
- **LABELS** U.L. Listed. Suitable for damp locations.



**PHOTOMETRIC DATA**

**HBI682-4-4M-SR-PA-E5H**

TEST NO.=LA-T0741-2  
 LAMP TYPE=F54T5HO  
 NO. OF LAMP=4  
 LUMENS PER LAMP=5000  
 WATTS PER LAMP=54  
 BALLAST FACTOR=1  
 PHOTOMETRY TYPE=C

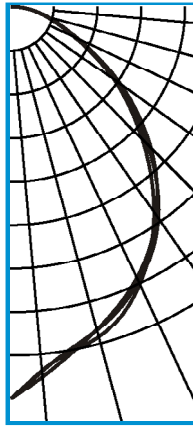
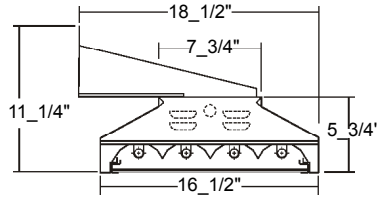

**CANDLEPOWER**

ANGLE	END	45	CROSS
0	6844	6844	6844
5	6468	6368	6354
15	5816	5830	5955
25	5199	5270	5316
35	4407	4470	4335
45	3427	3345	3216
55	2299	2201	2165
65	1254	1206	1200
75	648	630	621
85	188	201	190
90	16	23	21
95	0	0	0
105	0	0	0
115	0	0	0
125	0	0	0
135	0	0	0
145	0	0	0
155	0	0	0
165	0	0	0
175	0	0	0
180	0	0	0

**ZONAL LUMEN SUMMARY**

DEGREES	LUMENS	% LAMP	% FIXTURE
0-30	4710	23.5	33.4
0-40	7486	37.4	53.1
0-60	12056	60.3	85.5
0-90	14098	70.5	100.0
90-120	6	0.0	0
90-150	6	0.0	0
90-180	6	0.0	0
0-180	14104	70.5	100.0

Lumen Output = 14104 lumens  
 Luminaire Efficiency = 70.5%

**SPACING CRITERION**

ALONG	ACROSS
1.05	1.07

**HBI682-6-4M-SR-PA-E5H**

TEST NO.=LA-T0742-2  
 LAMP TYPE=F54T5HO  
 NO. OF LAMP=6  
 LUMENS PER LAMP=5000  
 WATTS PER LAMP=54  
 BALLAST FACTOR=1  
 PHOTOMETRY TYPE=C

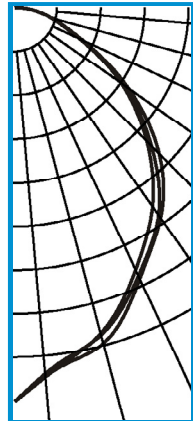
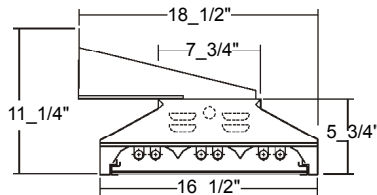

**CANDLEPOWER**

ANGLE	END	45	CROSS
0	9817	9817	9817
5	9194	9136	9218
15	8646	8426	8378
25	7394	7318	7151
35	6338	6242	5978
45	5053	4777	4615
55	3378	3265	3177
65	1780	1786	1718
75	917	911	889
85	282	280	286
90	27	36	32
95	0	0	0
105	0	0	0
115	0	0	0
125	0	0	0
135	0	0	0
145	0	0	0
155	0	0	0
165	0	0	0
175	0	0	0
180	0	0	0

**ZONAL LUMEN SUMMARY**

DEGREES	LUMENS	% LAMP	% FIXTURE
0-30	6657	22.2	33.0
0-40	10552	35.2	52.3
0-60	17208	57.4	85.3
0-90	20162	67.2	100.0
90-120	9	0.0	0
90-150	9	0.0	0
90-180	9	0.0	0
0-180	20171	67.2	100.0

Lumen Output = 20171 lumens  
 Luminaire Efficiency = 67.2%

**SPACING CRITERION**

ALONG	ACROSS
1.05	1.01

