



SURFACE MOUNT MDH410

1" WIDE REGRESSED LENS LUMINAIRE



JOB	
TYPE	
DATE	

Surface / Suspension Mounted



CROSS SECTION

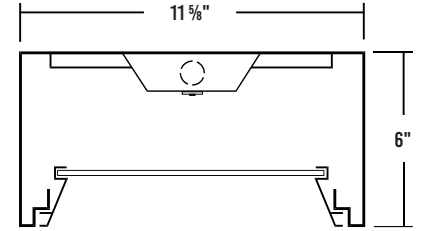

- ⊕ 2" KO
- ⊕ 7/8" Offset KO
- ✦ 11/16" Mounting KO

BACKPLATE

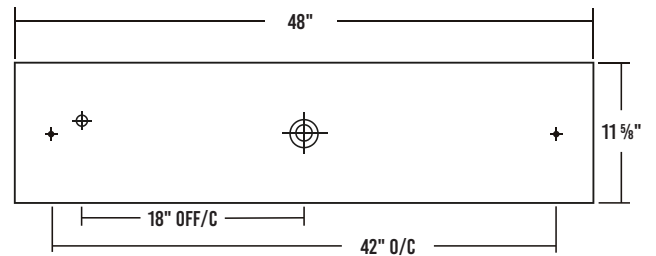

SPECIFICATIONS

Construction

- 20 gauge cold-rolled steel housing
- 2" deep regressed extruded aluminum door frame, secured by T-hinge and spring-loaded latches
- One-way polyurethane gasket
- Two gussets in each corner for strength and miter alignment

Finish

- Baked white powder-coated finish
- Painted after fabrication
- Minimum reflectance 90%

Optical

- Clear prismatic acrylic lens

Electrical

- High-efficiency drivers coupled with long-life LEDs
- Service life greater than 50,000 hours (L70)
- Universal voltage 120V through 277V (347V / 480V available)
- Power Factor (PF) ≥ 0.9
- Total Harmonic Distortion (THD) ≤ 20%

Listing

- UL USA and Canada listed / suitable for wet location

Warranty

- 5-Year limited warranty standard. 10-Year limited warranty also available

APPLICATIONS

- Offices, Schools, Commercial

FEATURES

- 0-10V dimming driver standard
- Supports California Title 24 compliance

OPTIONS

- Range of lumen packages and color temperatures
- Sensors and controls
- Lens options
- Tunable white (2700K – 6500K)
- Emergency battery pack
- Neoprene gasket
- Customization available upon request



Los Angeles Lighting Mfg. Co.
 Contact Us
 T: 626-454-8300 10141 Olney Street
 F: 626-454-8399 El Monte, CA 91731
 www.lalighting.com Made in the USA



Due to continued product improvements and enhancements, Los Angeles Lighting Manufacturing Company reserves the right to alter specifications, dimensions, data, and/or materials without notice. Please visit our website to view the most current information.

© 2024 LOS ANGELES LIGHTING MANUFACTURING CO. ALL RIGHTS RESERVED

Revised: 11/13/24



ORDERING INFORMATION: Additional Options Available. Visit www.lalighting.com/resources for more information

EXAMPLE: MDH410-8-4L-R2W-PA-BPL1.5-DRDM-UNV-1/840										
SERIES	NOMINAL LED LUMENS	NOMINAL LENGTH	DOOR FRAME	OPTICAL	MECHANICAL	ELECTRICAL	DRIVER	VOLTAGE	# OF LED ROWS	CRI / CCT
MDH410		4L							1	
MDH410 • 1' Wide Regressed Lens Luminaire	2 - 2000 lm 4 - 4000 lm 6 - 6000 lm 8 - 8000 lm 12 - 12000 lm High Efficacy 2HE - 2000 lm 4HE - 4000 lm 6HE - 6000 lm 8HE - 8000 lm	4L • 4'	R2W • White Enamel R2B • Black Enamel R2N • Natural Anodized Aluminum	PA • Clear Prismatic Acrylic FFWA • Flat Frosted White Acrylic FPA2 • Frosted Prismatic Acrylic	GSKNx • Neoprene Gasket *Leave blank for standard 1-way polyurethane gasket	BPL1.5 • 1500 lm emergency battery pack WLC(xx) • Wireless Control *Leave blank if not specified	DRDM • 0-10V Dimming Driver	UNV • 120V-277V 120V • 120 Volt 277V • 277 Volt 347V • 347 Volt 480V • 480 Volt	1 • One LED Row	827 • 80+CRI / 2700K 830 • 80+CRI / 3000K 835 • 80+CRI / 3500K 840 • 80+CRI / 4000K 850 • 80+CRI / 5000K 865 • 80+CRI / 6500K 8TW • 80+CRI Tunable White 2700K-6500K 90CRI Also available Contact customer service for additional CRI/CCT packages.
Standard options for MDH410 shown above. For additional options, including lumen packages, controls, lenses, switches, finishes, and more, visit www.lalighting.com/resources or contact customer service.										Contact customer service for additional CRI/CCT packages.

DOOR FRAME

CROSS SECTION

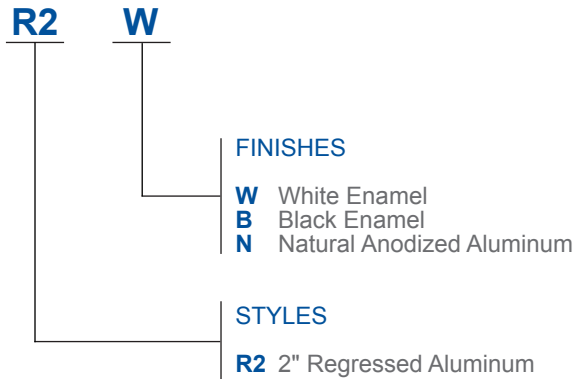
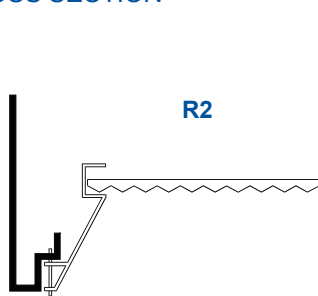

OPTICAL OPTIONS

STANDARD LENSES FOR MDH410

- PA** Clear Prismatic Acrylic, No Thickness Specified, Female Prisms 3/16" Square Base, Pattern 12
- FFWA** Flat Frosted White Acrylic, No Thickness Specified
- FPA2** Frosted Prismatic Acrylic, Nom. 0.125" OA Thickness, Female Prisms 3/16" Square Base, Pattern 12



Los Angeles Lighting Mfg. Co.
 Contact Us
 T: 626-454-8300 10141 Olney Street
 F: 626-454-8399 El Monte, CA 91731
www.lalighting.com Made in the USA



Due to continued product improvements and enhancements, Los Angeles Lighting Manufacturing Company reserves the right to alter specifications, dimensions, data, and/or materials without notice. Please visit our website to view the most current information.

© 2024 LOS ANGELES LIGHTING MANUFACTURING CO. ALL RIGHTS RESERVED

Revised: 11/13/24



NEOPRENE GASKET

If Neoprene gasketing is not specified, standard 1-way polyurethane gasket will be used.

1-WAY

Gasket between housing and door frame.

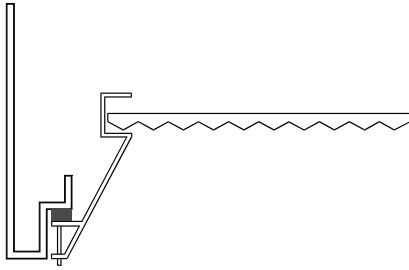

GSKN 1

NEOPRENE GASKET

LOCATION

1 One-Way

MOUNTING HARDWARE CANOPY / CABLE SUSPENSION SYSTEMS

Self-locking, one-step adjustable suspension devices with canopy



433B

- Canopy with cable
- No power cord
- Cable length 48" and 96"
- Max. Weight 196 lbs.

433B-48 W

COLOR

W - White

B - Black

CABLE LENGTH

48 - 48 inches

96 - 96 inches

(other lengths as specified)



444F

- Feed-in canopy with straight cord
- Includes power cord
- Cable length 48" and 96"
- Max. Weight 196 lbs

444F-48W-2C

OF CIRCUITS

2C - Two circuits

LV - 0-10V dimming

Blank - One circuit

COLOR

W - White

B - Black

CABLE LENGTH

48 - 48 inches

96 - 96 inches

(other lengths as specified)

THREADED MOUNTING STEMS

STEM

- 3/8" IPS, nominal OD 5/8"
 - Threaded 1" each end
 - 2 lock nuts provided per stem
 - Standard lengths: 6", 12", 18", 24", 30", 36", 48"
 - Baked white enamel finish
 - To order, specify length required after STEM.
- Example: **STEM12** for 12", **STEM24** for 24", etc.

Other lengths & finishes are available as specified

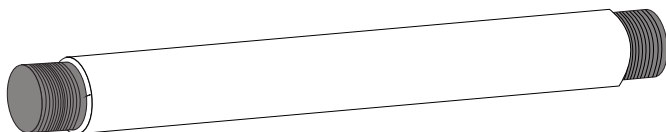

Stem Length Calculation

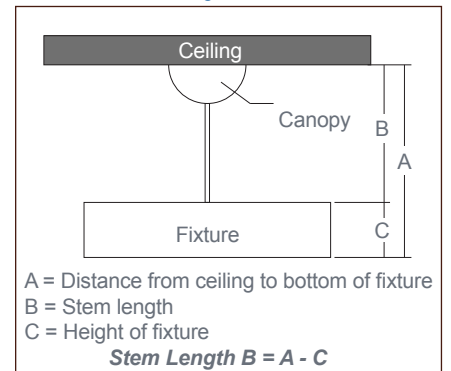

Los Angeles Lighting Mfg. Co.
 Contact Us
 T: 626-454-8300 10141 Olney Street
 F: 626-454-8399 El Monte, CA 91731
 www.lalighting.com Made in the USA



Due to continued product improvements and enhancements, Los Angeles Lighting Manufacturing Company reserves the right to alter specifications, dimensions, data, and/or materials without notice. Please visit our website to view the most current information.

© 2024 LOS ANGELES LIGHTING MANUFACTURING CO. ALL RIGHTS RESERVED

Revised: 11/13/24



SYSTEM DATA: Additional Lumen Packages Available. Contact Customer Service for More Information

Normal Ambient Temperature

4' - LED LUMEN PACKAGE	NORMAL AMBIENT TEMPERATURE PRODUCT CODE	DELIVERED LUMENS	SYSTEM WATTS	LUMINAIRE EFFICACY	AMBIENT TEMP.	FLUORESCENT EQUIVALENT	IES FILES
2000 Lumens (Nominal)	MDH410-2-4L-R2W-PA-DRDM-UNV-1/840	1437	13.4	107.1 lm/W	-20°C / 35°C (-4°F / 95°F)	2-F32T8	*
4000 Lumens (Nominal)	MDH410-4-4L-R2W-PA-DRDM-UNV-1/840	2821	26.7	105.6 lm/W	-20°C / 35°C (-4°F / 95°F)	1-F54T5HO, 2-F32T8	*
6000 Lumens (Nominal)	MDH410-6-4L-R2W-PA-DRDM-UNV-1/840	4392	43.7	100.6 lm/W	-20°C / 35°C (-4°F / 95°F)	2-F32T8	*
8000 Lumens (Nominal)	MDH410-8-4L-R2W-PA-DRDM-UNV-1/840	5717	51.1	111.8 lm/W	-20°C / 35°C (-4°F / 95°F)	2-F54T5HO, 4-F32T8	*
12000 Lumens (Nominal)	MDH410-12-4L-R2W-PA-DRDM-UNV-1/840	8306	74.9	110.9 lm/W	-20°C / 35°C (-4°F / 95°F)	3-F54T5HO, 6-F32T8	*

Normal Ambient Temp High Efficacy

4' - LED LUMEN PACKAGE	NORMAL AMBIENT TEMPERATURE (HIGH EFFICACY) PRODUCT CODE	DELIVERED LUMENS	SYSTEM WATTS	LUMINAIRE EFFICACY	AMBIENT TEMP.	FLUORESCENT EQUIVALENT	IES FILES
2000 Lumens (Nominal)	MDH410-2HE-4L-R2W-PA-DRDM-UNV-1/840	1553	13.5	114.7 lm/W	-20°C / 35°C (-4°F / 95°F)	2-F32T8	*
4000 Lumens (Nominal)	MDH410-4HE-4L-R2W-PA-DRDM-UNV-1/840	2761	23.5	117.7 lm/W	-20°C / 35°C (-4°F / 95°F)	1-F54T5HO, 2-F32T8	*
6000 Lumens (Nominal)	MDH410-6HE-4L-R2W-PA-DRDM-UNV-1/840	4440	38.4	115.6 lm/W	-20°C / 35°C (-4°F / 95°F)	2-F32T8	*
8000 Lumens (Nominal)	MDH410-8HE-4L-R2W-PA-DRDM-UNV-1/840	5717	50.9	112.4 lm/W	-20°C / 35°C (-4°F / 95°F)	2-F54T5HO, 4-F32T8	*

NOTE:
 System data as of 4/17/24.
 Luminaire efficiency: 69.0%
 Subject to change without notice.

System data is based on 120V input voltage. Actual performance may differ as a result of end-user environment and application. This fixture has been tested and listed in accordance with UL Standards. L.A. Lighting certifies that it will operate safely when installed properly, and within an ambient temperature range noted in the system data table.

Additional lumen packages and color temperatures available.



Los Angeles Lighting Mfg. Co.
 Contact Us
 T: 626-454-8300 10141 Olney Street
 F: 626-454-8399 El Monte, CA 91731
 www.lalighting.com Made in the USA



Due to continued product improvements and enhancements, Los Angeles Lighting Manufacturing Company reserves the right to alter specifications, dimensions, data, and/or materials without notice. Please visit our website to view the most current information.

© 2024 LOS ANGELES LIGHTING MANUFACTURING CO. ALL RIGHTS RESERVED

Revised: 11/13/24

