



RECESSED LED

GDC320 (2X4) SERIES (2X2 AVAILABLE)

DIRECT ILLUMINATED CENTER LENSED GRID LUMINAIRE

DATE	
JOB	

WWW.LALIGHTING.COM
626-454-8300

RECESSED MOUNTED LED LUMINAIRE FOR INVERTED T-BAR CEILINGS

DIMENSIONS

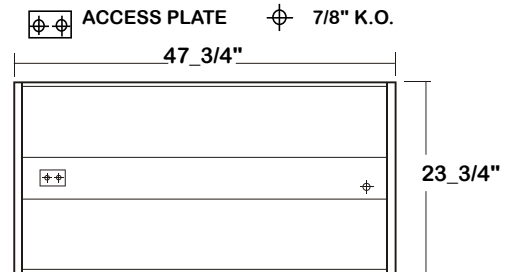
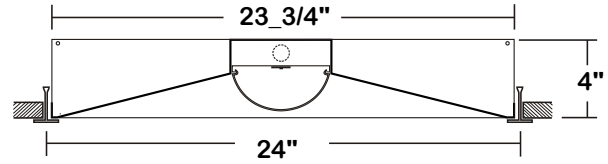
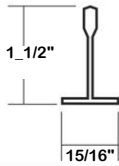

APPLICATIONS

- Commercial, Office, Classroom

FEATURES

- 0-10V dimming driver standard (See *DRIVER OPTIONS* for other dimming types)
- Supports California Title 24 compliance

OPTIONS

- Full customization available upon request
- Additional lumen packages and color temperatures available
- Wireless control options available (See *SENSOR OPTIONS* for wireless controls)
- Emergency battery pack available (See *BATTERY PACK OPTIONS* for battery pack options)

SPECIFICATIONS

CONSTRUCTION

- 22 ga. cold rolled steel housing and reflector

FINISH

- High reflectance low gloss matte white finish

OPTICAL

- Frosted radial lens to maximize lumen output while cutting glare

ELECTRICAL

- High efficiency drivers coupled with long-life LEDs
- Service life tested at 50,000-148,000 hours (L70)
- Universal voltage 120V through 277V (347V / 480V available)
- Power Factor (PF) ≥ 0.9
- Total Harmonic Distortion (THD) $\leq 20\%$

LISTING

- UL USA and Canada listed / suitable for damp locations

WARRANTY

- 5-year limited warranty



Los Angeles Lighting Mfg. Co.
Headquarters
10141 Olney Street
El Monte, CA 91731
Made in the USA

Contact Us
T: 626-454-8300
F: 626-454-8399
www.lalighting.com



Due to continued product improvements and enhancements, Los Angeles Lighting Manufacturing Company reserves the right to alter specifications, dimensions, data, and/or materials without notice. Please visit our website to view the most current information.

MADE IN THE U.S.A.

Revised 10-05-18

ORDERING INFORMATION EXAMPLE: GDC320-4-4L-BPL10-1DRDM-UNV-1/840

SERIES	LED LUMEN PACKAGE	EFFICACY	NOMINAL LENGTH	ELECTRICAL	DRIVER	VOLTAGE	# OF LED ROW	CRI / CCT
GDC320			4L		1DRDM	UNV	1	
GDC320 Direct Illuminated Center Lensed Grid LED Luminaire	2 Nom. 2000 Lumens 4 Nom. 4000 Lumens 6 Nom. 6000 Lumens 8 Nom. 8000 Lumens 10 Nom. 10000 Lumens *Additional Lumen Packages Available	(Blank) Standard HE High Efficacy (Only 2000 / 4000 / 6000 lumens Systems)	4L 2' x 4'	BPL10 Emergency Battery Pack, Constant 10W Nom. 1500 lm <i>See BATTERY PACK OPTIONS for Options</i> WLC(XXXXX) Wireless Control <i>See SENSOR OPTIONS for Options</i> *Leave Blank if Not Specified <i>Additional Electrical Options</i>	1DRDM 0-10V One Dimming Driver <i>See DRIVER OPTIONS for Options</i>	UNV 120V-277V <i>See DRIVER OPTIONS for Options</i>	1 One LED Row	830 80+CRI / 3000K Color Temp. 835 80+CRI / 3500K Color Temp. 840 80+CRI / 4000K Color Temp. 850 80+CRI / 5000K Color Temp. *Additional Color Temp. Available

SYSTEM DATA

THESE ARE THE MOST POPULAR LUMEN PACKAGES. PLEASE CONSULT FACTORY FOR ADDITIONAL SYSTEM DATA.

LED LUMEN PACKAGE	NORMAL AMBIENT TEMPERATURE PRODUCT CODE	DELIVERED LUMENS	SYSTEM WATTS	LUMINAIRE EFFICACY	AMBIENT TEMP.	FLUORESCENT EQUIVALENT	IES FILES
2000 Lumens (Nominal)	GDC320-2-4L-1DRDM-UNV-1/840	2028 lm	15.7 W	129.0 lm/W	-20°C / 35°C	1-F32T8	*
4000 Lumens (Nominal)	3-GDC320-4K-4L-1DRDM-UNV-1/835 *	3423 lm	34.2 W	100 lm/W	-20°C / 35°C	2-F32T8, 1-F54T5HO	*
	3-GDC320-4K-4L-1DRDM-UNV-1/840 *	3430 lm	31.41 W	100 lm/W			*
	GDC320-4-4L-1DRDM-UNV-1/840	3873.6 lm	33.1 W	117.03 lm/W			LA-T2465
	3-GDC320-4K-4L-1DRDM-UNV-1/850 *	3440 lm	34.4 W	100 lm/W			*
6000 Lumens (Nominal)	3-GDC320-6K-4L-1DRDM-UNV-1/835 *	4976 lm	49.94 W	100 lm/W	-20°C / 35°C	3-F32T8	*
	3-GDC320-6K-4L-1DRDM-UNV-1/840 *	5020 lm	50.21 W	100 lm/W			*
	GDC320-6-4L-1DRDM-UNV-1/840	5538 lm	51.1 W	108.38 lm/W			LA-T3290
	3-GDC320-6K-4L-1DRDM-UNV-1/850 *	5066 lm	50.6 W	100 lm/W			*
8000 Lumens (Nominal)	GDC320-8-4L-1DRDM-UNV-1/840	7195 lm	50.7 W	142.0 lm/W	-20°C / 35°C	4-F32T8, 2-F54T5HO	*
10000 Lumens (Nominal)	GDC320-10-4L-1DRDM-UNV-1/840	9221 lm	68.3 W	134.9 lm/W	-20°C / 35°C	5-F32T8	*

LED LUMEN PACKAGE	NORMAL AMBIENT TEMPERATURE (HIGH EFFICACY) PRODUCT CODE	DELIVERED LUMENS	SYSTEM WATTS	LUMINAIRE EFFICACY	AMBIENT TEMP.	FLUORESCENT EQUIVALENT	IES FILES
2000 Lumens (Nominal)	GDC320-2HE-4L-1DRDM-UNV-1/840	1944 lm	12.0 W	162.1 lm/W	-20°C / 35°C	1-F32T8	*
4000 Lumens (Nominal)	GDC320-4HE-4L-1DRDM-UNV-1/840	3705 lm	25.7 W	144.1 lm/W	-20°C / 35°C	2-F32T8, 1-F54T5HO	*
6000 Lumens (Nominal)	GDC320-6HE-4L-1DRDM-UNV-1/840	5496 lm	39.3 W	139.8 lm/W	-20°C / 35°C	3-F32T8	*

NOTE:

System data is based on 120V input voltage. DLC system data* based on DLC testing parameters. Actual performance may differ as a result of end-user environment and application.

This fixture has been tested and listed in accordance with UL Standards. L.A. Lighting certifies that it will operate safely when installed properly, and within an ambient temperature range noted in the system data table.

Additional lumen packages and color temperatures available.

Due to constant updates on this product, please visit the [DLC QPL Website](#) for the most accurate system data and information.



PERFORMANCE DATA

[VIEW LIGHTING FACTS](#)

[VIEW PHOTOMETRICS](#)



Los Angeles Lighting Mfg. Co.
Headquarters
10141 Olney Street
El Monte, CA 91731
Made in the USA

Contact Us
T: 626-454-8300
F: 626-454-8399
www.lalighting.com



Due to continued product improvements and enhancements, Los Angeles Lighting Manufacturing Company reserves the right to alter specifications, dimensions, data, and/or materials without notice. Please visit our website to view the most current information.

MADE IN THE U.S.A.

SENSOR OPTIONS

LUTRON CONTROLS AND SENSORS

WLC(FCJS0) - Lutron® Vive PowPak® 0-10V Wireless Fixture Control

- One per fixture (external mount)
- Controls 1A of load or up to 3 drivers
- Universal Voltage (120V-277V)

WLC(FCJSE) - Lutron® Vive PowPak® EcoSystem Wireless Fixture Control

- One per fixture (external mount)
- Controls 1A of load or up to 3 drivers
- Universal Voltage (120V-277V)

**Must specify Lutron® Vive compatible driver*

WLC(VDO) - Lutron® Wireless Fixture Sensor

- Need Dexal driver
- One per fixture
- Turn light on/off based on motion
- 15 minutes time delay default
- Daylight sensor provide linear response to changes in light level.
- Up to 300 sq.ft major motion coverage and 150 sq.ft. minor motion coverage based on 9' mounting height.
- Work standalone or with Vive wireless control system
- Work with driver has integrated self-powered DALI link or Lutron EcoSystem driver (additional Lutron® digital link interface required)

WLC(VRF) - Lutron® Wireless Fixture Control

- Need Dexal driver
- One per fixture
- Wireless control module
- Work with Vive wireless control system
- Work with driver has integrated self-powered DaLI link or Lutron EcoSystem driver (additional Lutron® digital link interface required)

PJ2-2BRL - Lutron® Pico® 2-Button Wireless Remote

- Works with Wireless Fixture Controls
- Controls ON/OFF and dimming UP/DOWN

FC-SENSOR - Lutron® PowPak® Occupancy/Daylight Sensor

- Turns light ON/OFF based on motion
- Recommended mounting height of 8-12'
- For dry and damp locations
- Universal Voltage (120V-277V)

FC-VSENSOR - Lutron® PowPak® Vacancy/Daylight Sensor

- Turns light OFF when area is vacant
- Recommended mounting height of 8-12'
- For dry and damp locations
- Universal Voltage (120V-277V)



CONTROLS AND SENSORS

WLC(LEDRLU) - EnOcean® LED Relay Zone Controller

- Supports a single LED fixture or multiple daisy chained LED fixtures
- Module installed inside lighting fixture

ESRPU-W-EO - EnOcean® Rocker Switch – Single – Surface Mount

- Wireless single rocker switch with mounting plate
- No batteries needed

EDRPU-W-EO - EnOcean® Rocker Switch – Double – Surface Mount

- Wireless double rocker switch with mounting plate
- No batteries needed

S3054-N300 - EnOcean® Navigan NWC 300U – Commissioning Tool

- Navigan Wireless Commissioner is used to configure EnOcean controllers & sensors
- It can be used to define link tables, change parameters/settings, and to edit & store projects
- Configuration settings can be saved and cloned to enable quick configuration
- Connectivity is through the NWC 300U USB Stick

EOSWU-W-EO - EnOcean® Occupancy Sensor – Wall Mount

- Wireless wall mounted occupancy sensor
- Solar powered - no batteries needed (coin battery operated in low light conditions)
- PIR motion sensor with both wide angle (50') and long range (100') options
- Mounting height: 6-8 feet

EOSCU-W-EO - EnOcean® Occupancy Sensor – Ceiling Mount

- Wireless ceiling mounted occupancy sensor
- Solar powered - no batteries needed (coin battery operated in low light conditions)
- PIR motion sensor with 360 degree viewing angle lens (34' diameter)
- Mounting height: 7-10 feet

ELLSU-W-EO - EnOcean® Light Level Sensor – Ceiling Mount

- Light Level sensor that measures and reports the level of available natural light
- Solar powered - no batteries needed (coin battery operated in low light conditions)
- Enables implementation of daylight harvesting control systems
- Mounting position: At the ceiling, close to ambient light source

DRIVER OPTIONS

PLEASE CONSULT FACTORY TO SEE IF YOUR SELECTED DRIVER OPTION WORKS WITH THIS FIXTURE.

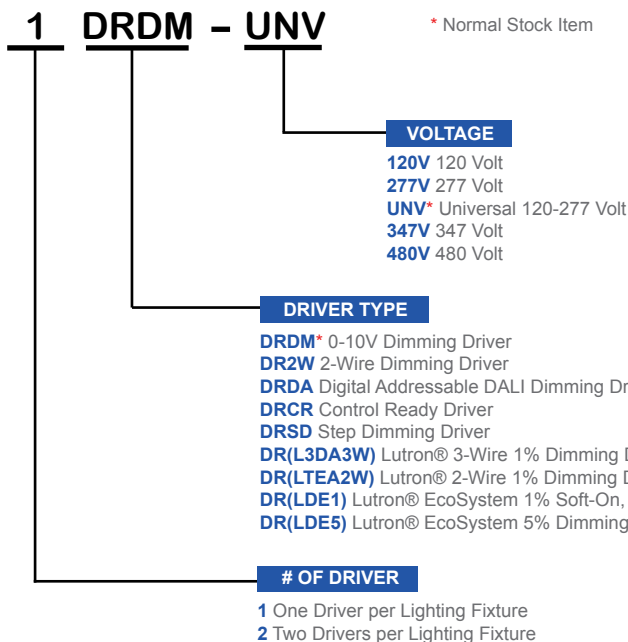

BATTERY PACK OPTIONS

PLEASE CONSULT FACTORY TO SEE IF YOUR SELECTED BATTERY PACK OPTION WORKS WITH THIS FIXTURE.

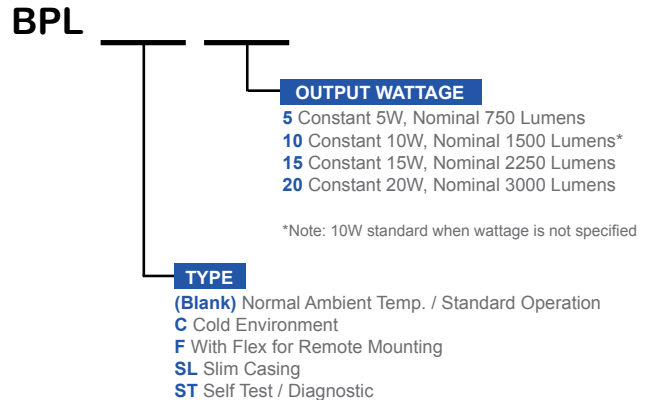

Los Angeles Lighting Mfg. Co.
 Headquarters
 10141 Olney Street
 El Monte, CA 91731
 Made in the USA

Contact Us
 T: 626-454-8300
 F: 626-454-8399
 www.lalighting.com



Due to continued product improvements and enhancements, Los Angeles Lighting Manufacturing Company reserves the right to alter specifications, dimensions, data, and/or materials without notice. Please visit our website to view the most current information.

MADE IN THE U.S.A.

LED lighting facts

3-GDC320-4K-4L-1DRDM-UNV-1/835

- 4000 Lumen System
- L70 performance at 148,000 hours



LA Lighting

LED lighting facts
A Program of the U.S. DOE

Light Output (Lumens)	3423
Watts	34.2
Lumens per Watt (Efficacy)	100

Color Accuracy
Color Rendering Index (CRI) **85**

Light Color
Correlated Color Temperature (CCT) **3558 (Bright White)**



2700K 3000K 4500K 6500K

All results are according to IESNA LM-79-2008: *Approved Method for the Electrical and Photometric Testing of Solid-State Lighting*. The U.S. Department of Energy (DOE) verifies product test data and results.

Visit www.lightingfacts.com for the *Label Reference Guide*.

Registration Number: -ZBHXB4 (11/3/2015)
Model Number: 3-GDC320-4K-4L-1DRDM-UNV-1/835
Type: Luminaire - Troffer/Grid Ceiling

3-GDC320-6K-4L-1DRDM-UNV-1/835

- 6000 Lumen System
- L70 performance at 128,000 hours



LA Lighting

LED lighting facts
A Program of the U.S. DOE

Light Output (Lumens)	4976
Watts	49.94
Lumens per Watt (Efficacy)	100

Color Accuracy
Color Rendering Index (CRI) **85**

Light Color
Correlated Color Temperature (CCT) **3546 (Bright White)**

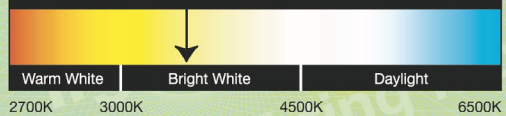

2700K 3000K 4500K 6500K

All results are according to IESNA LM-79-2008: *Approved Method for the Electrical and Photometric Testing of Solid-State Lighting*. The U.S. Department of Energy (DOE) verifies product test data and results.

Visit www.lightingfacts.com for the *Label Reference Guide*.

Registration Number: -8JHTBN (11/3/2015)
Model Number: 3-GDC320-6K-4L-1DRDM-UNV-1/835
Type: Luminaire - Troffer/Grid Ceiling



LOS ANGELES LIGHTING MFG. CO.

10141 OLNEY ST. / EL MONTE, CA 91731

TEL 626-454-8300 | FAX 626-454-8399 |

www.lalighting.com

PHOTOMETRIC DATA - GDC320, 2X4

GDC320-4-4L-1DRDM-UNV-1/840

TEST NO. = LA-T2465
 LED TYPE = 48 LED MODULE
 NO. OF MODULE = 2
 SYSTEM WATT (W) = 33.1
 CRI ≥ 80
 L70(Hrs.) ≥ 50,000
 PHOTOMETRY TYPE = C

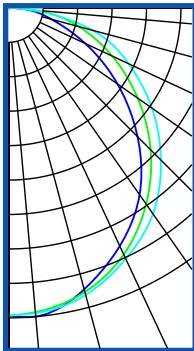
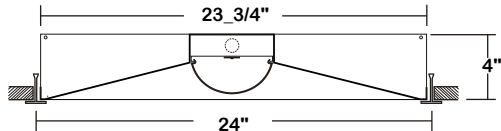

CANDLEPOWER

ANGLE	END	45	90
0	1310	1310	1310
5	1320	1330	1330
15	1274	1285	1281
25	1154	1181	1215
35	998	1045	1094
45	800	878	941
55	580.4	691.7	769.5
65	369.6	502	579.9
75	195.3	319	383.9
85	75	115.7	91.7
90	4.5	2.7	1.2
95	0	0	0
105	0	0	0
115	0	0	0
125	0	0	0
135	0	0	0
145	0	0	0
155	0	0	0
165	0	0	0
175	0	0	0
180	0	0	0

ZONAL LUMEN SUMMARY

DEGREES	LUMENS	% LAMP	% FIXTURE
0-30	1037	24.21	26.78
0-40	1694	39.54	43.73
0-60	2984	69.66	77.04
0-90	3873	90.40	99.98
90-120	0.76	0.02	0.02
90-150	0.76	0.02	0.02
90-180	0.76	0.02	0.02
0-180	3874	90.42	100.0

Luminaire Output= 3873.6 lumens
 Luminaire Efficacy = 117.03 lm/W

SPACING CRITERION

ALONG	ACROSS
1.21	1.30

GDC320-6-4L-1DRDM-UNV-1/840

TEST NO. = LA-T3290
 LED TYPE = 48 LED MODULE
 NO. OF MODULE = 2
 SYSTEM WATT (W) = 51.1
 CRI ≥ 80
 L70(Hrs.) ≥ 50,000
 PHOTOMETRY TYPE = C

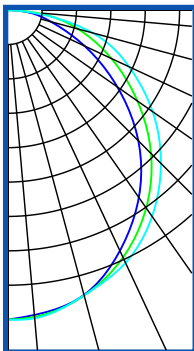
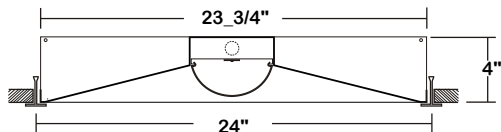

CANDLEPOWER

ANGLE	END	45	90
0	1922	1922	1922
5	1900	1913	1922
15	1832	1835	1833
25	1649	1695	1732
35	1420	1500	1564
45	1148	1259	1346
55	832	984	1099
65	528	711	832
75	278	454	547
85	109	167	131
90	6.3	4.0	1.4
95	0	0	0
105	0	0	0
115	0	0	0
125	0	0	0
135	0	0	0
145	0	0	0
155	0	0	0
165	0	0	0
175	0	0	0
180	0	0	0

ZONAL LUMEN SUMMARY

DEGREES	LUMENS	% LAMP	% FIXTURE
0-30	1486	24.26	26.83
0-40	2425	36.61	43.79
0-60	4270	69.73	77.10
0-90	5537	90.42	99.98
90-120	1.08	0.02	0.02
90-150	1.08	0.02	0.02
90-180	1.08	0.02	0.02
0-180	5538	90.43	100.0

Luminaire Output= 5538 lumens
 Luminaire Efficacy = 108.38 lm/W

SPACING CRITERION

ALONG	ACROSS
1.19	1.27

This Space is intentionally left blank.

This Space is intentionally left blank.

