



# METAL SIDED

## ANG100 SERIES



### Angle Corner Mount Luminaire



- Triangular Shape Luminaire
- Corner / Wall / Ceiling Mountable
- Welded And Painted After Fabrication
- Full Length Piano Hinge and Two Captive Screws
- One Way Polyurethane Gasketed
- Suitable for Damp Locations
- Available with:
  - Fluorescent, LED and LED T8 (Internally Driven)
  - 95% Enhanced Specular Aluminum Reflectors
  - Variety of Lenses
  - Tamper Proof Screws
  - Gasketing
  - Emergency Battery Pack



Photometric Data and IES Files are Available on [www.lalighting.com](http://www.lalighting.com)



**LOS ANGELES LIGHTING MFG. CO.**

10141 OLNEY ST. / EL MONTE, CA 91731

TEL : 626-454-8300 FAX : 626-454-8399

[www.lalighting.com](http://www.lalighting.com)

**METAL SIDED - Fluorescent**

LED Equivalent Products Available on [www.lalighting.com](http://www.lalighting.com)



**ANG100 SERIES**

**CROSS SECTION**

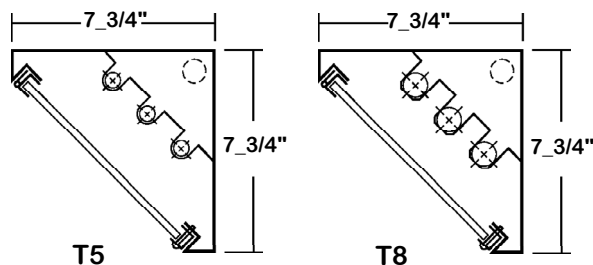

**BACK PLATE**

- 3/8" K.O.
- ⊕ 7/8" K.O.
- ⊕ 2" K.O.

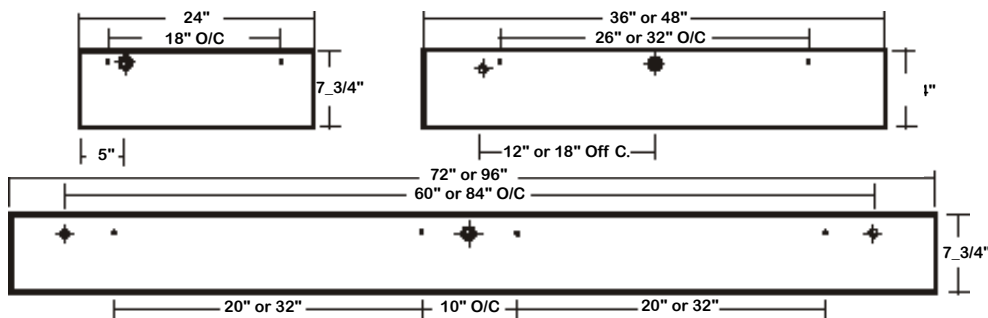

**CATALOG NUMBER**

NOMINAL LENGTH	TOTAL LAMPS	NOMINAL LENGTH	TOTAL LAMPS	NOMINAL LENGTH	TOTAL LAMPS	NOMINAL LENGTH	TOTAL LAMPS	
ANG100-1-2M	2'	1	ANG100-1-4S	4'	1	ANG100-2-2R	2'	2
ANG100-1-3M	3'	1	ANG100-1-6S	6'	1	ANG100-2-3R	3'	2
ANG100-1-4M	4'	1	ANG100-1-8S	8'	1	ANG100-2-4R	4'	2
ANG100-1-6MT	6'	2	ANG100-1-4H	4'	1	ANG100-2-6RT	6'	4
ANG100-1-8MT	8'	2	ANG100-1-6H	6'	1	ANG100-2-8RT	8'	4
ANG100-1-2R	2'	1	ANG100-1-8H	8'	1	ANG100-2-4S	4'	2
ANG100-1-3R	3'	1	ANG100-2-2M	2'	2	ANG100-2-6S	6'	2
ANG100-1-4R	4'	1	ANG100-2-3M	3'	2	ANG100-2-8S	8'	2
ANG100-1-6RT	6'	2	ANG100-2-4M	4'	2	ANG100-2-4H	4'	2
ANG100-1-8RT	8'	2	ANG100-2-6MT	6'	4	ANG100-2-6H	6'	2
			ANG100-2-8MT	8'	4	ANG100-2-8H	8'	2
						ANG100-3-3M	3'	3
						ANG100-3-4M	4'	3
						ANG100-3-6MT	6'	6
						ANG100-3-8MT	8'	6
						ANG100-3-2R	2'	3
						ANG100-3-3R	3'	3
						ANG100-3-4R	4'	3
						ANG100-3-6RT	6'	6
						ANG100-3-8RT	8'	6
						ANG100-3-4S	4'	3
						ANG100-3-6S	6'	3
						ANG100-3-8S	8'	3

**ORDERING GUIDE**

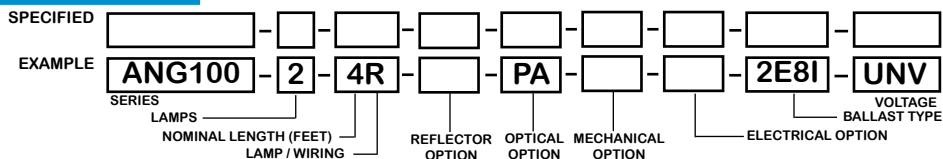

**NOTE: LAMP/WIRING\***

- M=Miniature Bi-Pin T5
- MT=Miniature Bi-Pin T5 Tandem Wiring
- R=Medium Bi-Pin T8
- RT=Medium Bi-Pin T8 Tandem Wiring
- S=Slimline
- H=High Output (800MA)

**OPTIONS AND ACCESSORIES**

<p>● <b>REFLECTOR OPTIONS</b></p> <p>Specular Aluminum Reflector (95%)</p>	SUFFIX	SR	<p>● <b>MECHANICAL OPTIONS</b></p> <p>Tamper Proof Screws Gasketing</p>	SUFFIX	TP GSK*	<p>● <b>BALLAST OPTIONS</b></p> <p>Electronic T5 Electronic T5HO Electronic T8 Instant Start Electronic T8 Rapid Start Electronic T8HO</p>	SUFFIX	E5 E5H E8I E8R E8H
<p>● <b>OPTICAL OPTIONS</b></p> <p>Clear Acrylic Clear Prismatic Acrylic Flat White Acrylic Polycarbonate Lenses High Impact Acrylic * Other Lens Available Upon Request</p>	SUFFIX	CA PA FWA * *	<p>● <b>ELECTRICAL OPTIONS</b></p> <p>Emergency Battery Pack External Line Fusing (HLR/GLR)</p>	SUFFIX	BP* ELF			

\*See appropriate reference page

**SPECIFICATIONS**

- **TYPE** Surface mounted luminaire designed for installation on the wall, ceiling or corner where wall and ceiling meet.
- **CONSTRUCTION** 20 ga. cold rolled steel welded housing.
- **FINISH** Baked white powder coated finish, minimum reflectance 90%, painted after fabrication.
- **DOOR FRAME** 20 gauge cold rolled steel with full length piano hinge and machine screw catch.
- **GASKET** One way polyurethane gasketed standard. More options available.
- **OPTICS** Clear prismatic acrylic standard. Extensive variety of lenses, diffusers and louvers available.
- **WIRING** 120v 60Hz., 277v 60Hz., UNV (universal voltage 120v thru 277v.) or as otherwise specified.
- **LABELS** U.L. Listed. Suitable for damp locations.



**PHOTOMETRIC DATA**

**ANG100-2-4R-PA-E8**

TEST NO.=LA-T0686  
 LAMP TYPE=F032T8  
 NO. OF LAMP=2  
 LUMENS PER LAMP=2900  
 WATTS PER LAMP=32  
 BALLAST FACTOR=1  
 PHOTOMETRY TYPE=C

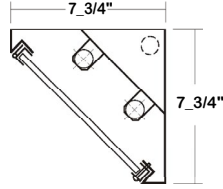
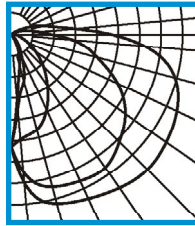
**CANDLEPOWER**

ANGLE	END	45	CROSS	135	180
0	966	966	966	966	966
5	1282	1188	906	643	577
15	1504	1356	846	417	282
25	1558	1391	715	218	136
35	1611	1400	539	116	41
45	1645	1304	389	43	0
55	1615	1190	254	7	0
65	1560	1003	154	0	0
75	1447	759	85	0	0
85	1146	527	49	0	0
90	858	344	23	0	0
95	550	239	11	0	0
105	286	123	1	0	0
115	125	44	0	0	0
125	32	4	0	0	0
135	0	0	0	0	0
145	0	0	0	0	0
155	0	0	0	0	0
165	0	0	0	0	0
175	0	0	0	0	0
180	0	0	0	0	0

**ZONAL LUMEN SUMMARY**

DEGREES	LUMENS	% LAMP	% FIXTURE
0-30	704	12.1	19.5
0-40	1156	19.9	32.1
0-60	2158	37.2	59.9
0-90	3342	57.6	92.7
90-120	259	4.5	7.2
90-130	263	4.5	7.3
90-150	263	4.5	7.3
90-180	263	4.5	7.3
0-180	3606	62.2	100.0

Lumen Output = 3606 lumens  
 Luminaire Efficiency = 62.2%

**SPACING CRITERION**

ALONG	ACROSS
2.24	1.01

**ANG100-3-4R-PA-E8**

TEST NO.=LA-T0687  
 LAMP TYPE=F032T8  
 NO. OF LAMP=3  
 LUMENS PER LAMP=2900  
 WATTS PER LAMP=32  
 BALLAST FACTOR=1  
 PHOTOMETRY TYPE=C

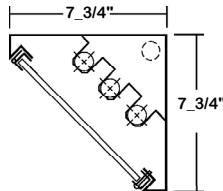
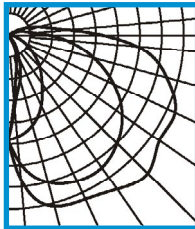
**CANDLEPOWER**

ANGLE	END	45	CROSS	135	180
0	1283	1283	1283	1283	1283
5	1785	1566	1250	889	811
15	2174	1874	1140	564	392
25	2222	1978	951	306	208
35	2310	1985	718	165	54
45	2401	1874	541	56	1
55	2244	1693	360	10	0
65	2240	1419	227	0	0
75	1996	1081	124	0	0
85	1579	709	67	0	0
90	1153	504	40	0	0
95	744	326	13	0	0
105	385	179	1	0	0
115	183	59	0	0	0
125	45	4	0	0	0
135	0	0	0	0	0
145	0	0	0	0	0
155	0	0	0	0	0
165	0	0	0	0	0
175	0	0	0	0	0
180	0	0	0	0	0

**ZONAL LUMEN SUMMARY**

DEGREES	LUMENS	% LAMP	% FIXTURE
0-30	979	11.3	19.3
0-40	1615	18.6	31.9
0-60	3040	34.9	60.0
0-90	4706	54.1	92.8
90-120	358	4.1	7.1
90-130	364	4.2	7.2
90-150	364	4.2	7.2
90-180	364	4.2	7.2
0-180	5070	58.3	100.0

Lumen Output = 5070 lumens  
 Luminaire Efficiency = 58.3%

**SPACING CRITERION**

ALONG	ACROSS
2.33	1.01

This space is intentionally left blank.

This space is intentionally left blank.

