



RECESSED

FHL306 SERIES



6" Width / Premium Grade Trim Flange



- 6" Width / Premium Grade Trim Flange Luminaire
- 20 Gauge Cold Rolled Steel Welded Housing
- Powder Coated Finish / Painted After Fabrication
- One Piece Welded Trim Flange Painted After Fabrication
- 20 Gauge Steel or Extruded Aluminum Door Frame Screwed at Each Corner
- Door Frame Painted After Fabrication
- T-Hinges And Spring Loaded Latches
- One Way Polyurethane Gasketed
- Suitable for Damp Locations
- Available with:
 - Fluorescent, LED and LED T8 (Internally Driven)
 - Variety of Lens Options
 - Emergency Battery Pack



Photometric Data and IES Files are Available on www.lalighting.com



LOS ANGELES LIGHTING MFG. CO.

10141 OLNEY ST. / EL MONTE, CA 91731

TEL : 626-454-8300 FAX : 626-454-8399

www.lalighting.com

RECESSED - Fluorescent

LED Equivalent Products Available on www.lalighting.com



FHL306 SERIES

CROSS SECTION

Ceiling Opening
 X - 6 1/2" x 24 1/2"
 6 1/2" x 48 1/2"
 6 1/2" x 96 1/2"

Overall Width By Length
 Y - 8" x 26"
 8" x 50"
 8" x 98"

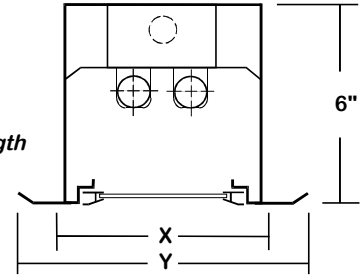

BACK PLATE

- 3/8" K.O.
- ◆ 11/16" STEM MTG. K.O.
- ⊕ 7/8" OFFSET K.O.
- ⊖ 2" K.O.

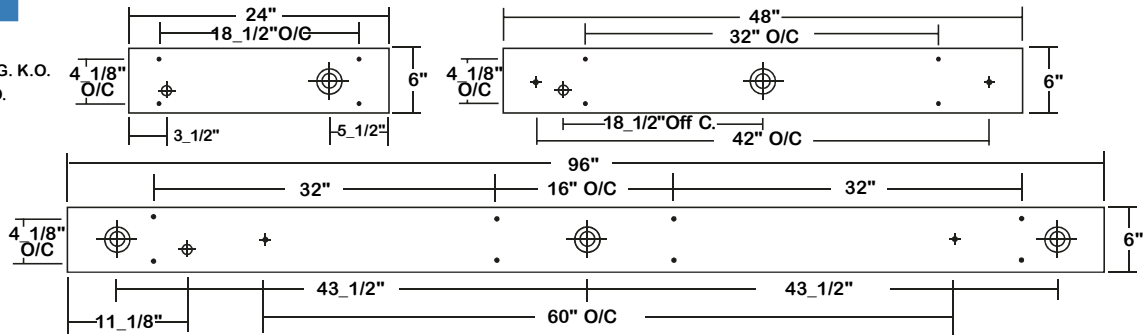

CATALOG NUMBER

	NOMINAL LENGTH	TOTAL LAMPS		NOMINAL LENGTH	TOTAL LAMPS
FHL306-1-2M	2'	1	FHL306-1-2R	2'	1
FHL306-1-4M	4'	1	FHL306-1-4R	4'	1
FHL306-1-8MT	8'	2	FHL306-1-8RT	8'	2
FHL306-2-2M	2'	2	FHL306-2-2R	2'	2
FHL306-2-4M	4'	2	FHL306-2-4R	4'	2
FHL306-2-8MT	8'	4	FHL306-2-8RT	8'	4

DOOR FRAME INFORMATION

• **CROSS SECTION**



FS W

STYLES
 FS - Flat Steel

FINISHES

W - White Enamel
 B - Black Enamel

ORDERING GUIDE

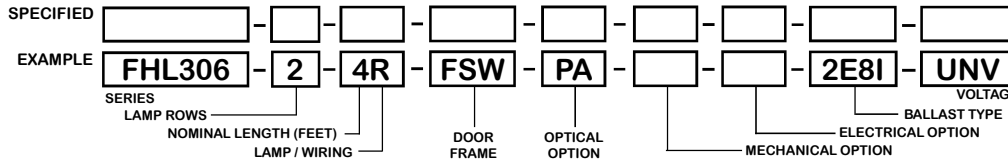

NOTE: LAMP/WIRING*
 M= Miniature Bi-Pin T5
 R = Medium Bi-Pin T8
 MT= Miniature Bi-Pin T5, Tandem Wiring
 RT = Medium Bi-Pin T8, Tandem Wiring

OPTIONS AND ACCESSORIES

• **OPTICAL OPTIONS**

- Clear Acrylic
- Clear Prismatic Acrylic
- Flat Frosted White Acrylic
- Polycarbonate Lenses
- High Impact Acrylic
- * Other Lens Available Upon Request

SUFFIX
 CA
 PA
 FFWA
 *
 *

• **ELECTRICAL OPTIONS**

- Emergency Battery Pack
- External Line Fusing (HLR/GLR)

SUFFIX
 BP*
 ELF

• **BALLAST OPTIONS***

- Electronic T5
- Electronic T5HO
- Electronic T8 Instant Start
- Electronic T8 Rapid Start
- Electronic T8HO

x = Number of Lamps per Ballast

• **ACCESSORIES**

- Hanger Yokes

SUFFIX
 xE5
 xE5H
 xE8I
 xE8R
 xE8H

CAT. NO.
 HS-6_1/2

*Refer to www.lalighting.com/resources for more information

SPECIFICATIONS

- **TYPE** Recessed mounted square sides. Available in various lengths. Adaptable to a wide variety of ceiling styles.
- **CONSTRUCTION** 20 ga. cold rolled steel welded housing.
- **FINISH** Baked white powder coated finish, minimum reflectance 90%, painted after fabrication.
- **DOOR FRAME** 20 gauge cold rolled steel or extruded aluminum in various finishes. T-hinges, positive spring loaded latches.
- **GASKET** One way polyurethane gasketed standard. More options available.
- **OPTICS** Clear prismatic acrylic standard. Extensive variety of lenses, diffusers and louvers available.
- **WIRING** 120v 60Hz., 277v 60Hz., UNV (universal voltage 120v thru 277v.) or as otherwise specified.
- **LABELS** U.L Listed. Suitable for damp locations. Compatible with UL Fire-Rated Ceiling Assemblies.



PHOTOMETRIC DATA

FHL306-2-4R-FSW-PA-E8

TEST NO.=LA-T0438-1
 LAMP TYPE=FO32T8
 NO. OF LAMP=2
 LUMENS PER LAMP=2900
 WATTS PER LAMP=32
 BALLAST FACTOR=1
 PHOTOMETRY TYPE=C

Ceiling Opening

X - 6_ 1/2" X 48_1/2"

Overall Width By Length

Y - 8" X 50"

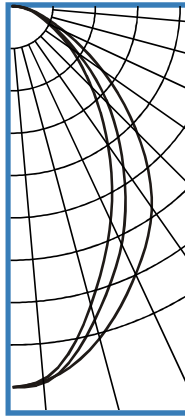
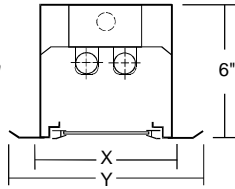

CANDLEPOWER

ANGLE	END	45	CROSS
0	1057	1057	1057
5	1042	1047	1036
15	948	893	850
25	813	719	645
35	673	533	458
45	483	367	304
55	296	213	189
65	148	117	104
75	70	64	58
85	22	18	16
90	2	2	1
95	0	0	0
105	0	0	0
115	0	0	0
125	0	0	0
135	0	0	0
145	0	0	0
155	0	0	0
165	0	0	0
175	0	0	0
180	0	0	0

ZONAL LUMEN SUMMARY

DEGREES	LUMENS	% LAMP	% FIXTURE
0-30	689	11.9	39.7
0-40	1034	17.8	59.5
0-60	1532	26.4	88.2
0-90	1736	29.9	100.0
90-120	0	0.0	0
90-150	0	0.0	0
90-180	0	0.0	0
0-180	1737	29.9	100.0

Lumen Output = 1737 lumens
 Luminaire Efficiency = 29.9%

SPACING CRITERION

ALONG	ACROSS
1.06	0.86

This space is intentionally left blank.

This space is intentionally left blank.

This space is intentionally left blank.

