



RECESSED

FHL310 SERIES



5" Depth / Premium Grade Trim



- 5" Depth / Premium Grade Trim Flange Luminaire
- 22 Gauge Cold Rolled Steel Housing
- One Piece Welded Trim Flange Painted After Fabrication
- 20 Gauge Steel or Extruded Aluminum Door Frame Screwed at Each Corner
- Door Frame Painted After Fabrication
- T-Hinges And Spring Loaded Latches
- One Way Polyurethane Gasketed
- Suitable for Damp Locations
- Available with:
 - Fluorescent, LED and LED T8 (Internally Driven)
 - Variety of Lens Options
 - Tamper Proof Screws
 - Emergency Battery Pack



Photometric Data and IES Files are Available on www.lalighting.com



LOS ANGELES LIGHTING MFG. CO.

10141 OLNEY ST. / EL MONTE, CA 91731

TEL : 626-454-8300 FAX : 626-454-8399

www.lalighting.com

RECESSED - Fluorescent

LED Equivalent Products Available on www.lalighting.com



FHL310 SERIES

CROSS SECTION

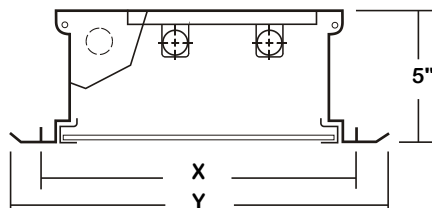

Ceiling Opening
 X - 12 1/2" x 24 1/2"
 12 1/2" x 48 1/2"
 12 1/2" x 96 1/2"
Overall Width By Length
 Y - 14" x 26"
 14" x 50"
 14" x 98"

BACK PLATE

ACCESS PLATE 7/8" K.O. • 3/8" K.O.

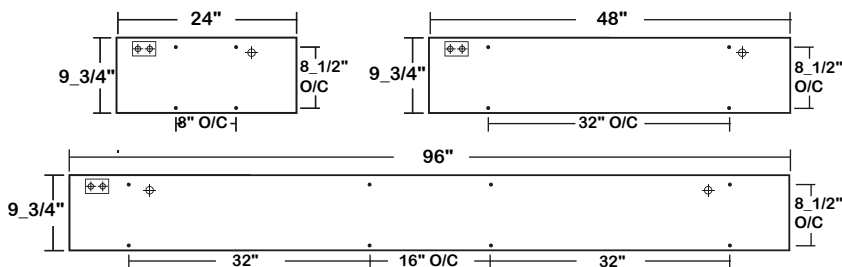

DOOR FRAME INFORMATION

CROSS SECTION

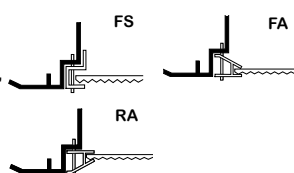

FS W

FINISHES

W - White Enamel
 B - Black Enamel
 N - Natural Anodized Aluminum

STYLES

FS - Flat Steel
 FA - Flat Extruded Aluminum
 RA - 5/8" Regressed Extruded Aluminum
 R2 - 2" Regress
 DF - Aluminum frame for Donn® FineLine® T-Bar

CATALOG NUMBER

NOMINAL LENGTH	TOTAL LAMPS	NOMINAL LENGTH	TOTAL LAMPS	NOMINAL LENGTH	TOTAL LAMPS	NOMINAL LENGTH	TOTAL LAMPS	
FHL310-1-2M	2'	1	FHL310-3-2M	2'	3	FHL310-1-2R	2'	1
FHL310-1-4M	4'	1	FHL310-3-4M	4'	3	FHL310-1-4R	4'	1
FHL310-1-8MT	8'	2	FHL310-3-8MT	8'	6	FHL310-1-8RT	8'	2
FHL310-2-2M	2'	2				FHL310-2-2R	2'	2
FHL310-2-4M	4'	2				FHL310-2-4R	4'	2
FHL310-2-8MT	8'	4				FHL310-2-8RT	8'	4
						FHL310-3-2R	2'	3
						FHL310-3-4R	4'	3
						FHL310-3-8RT	8'	6

ORDERING GUIDE

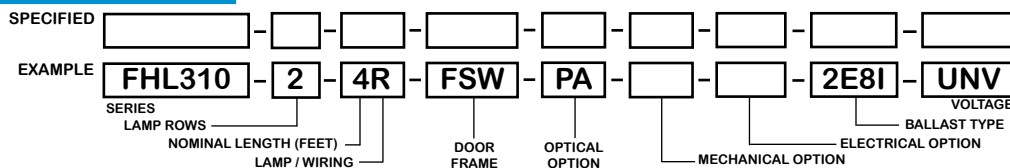

NOTE: LAMP/WIRING*

M = Miniature Bi-Pin T5
 R = Medium Bi-Pin T8
 MT = Miniature Bi-Pin T5, Tandem Wiring
 RT = Medium Bi-Pin T8, Tandem Wiring

OPTIONS AND ACCESSORIES

OPTICAL OPTIONS

Clear Acrylic
 Clear Prismatic Acrylic
 Flat White Acrylic
 Polycarbonate Lenses
 High Impact Acrylic
 Note: Other lens available upon request

SUFFIX

CA
 PA
 FWA
 *
 *

MECHANICAL OPTIONS

Tamper Proof Screws (Hex Socket With Post)
 Gasketing
ELECTRICAL OPTIONS
 Emergency Battery Pack
 External Line Fusing (HLR/GLR)

SUFFIX

TP
GSK*
SUFFIX
 BP*
 ELF
 RIF
 NL*

BALLAST OPTIONS*

Electronic T5
 Electronic T5HO
 Electronic T8 Instant Start
 Electronic T8 Rapid Start
 Electronic T8HO
 x = Number of Lamps per Ballast

SUFFIX

xE5
 xE5H
 xE8I
 xE8R
 xE8H

ACCESSORIES

Hanger Yokes (1X4)
 Swing Out Jack

CAT. NO.

HS-12_1/2
 SOJ

*Refer to www.lalighting.com/resources for more information

SPECIFICATIONS

- TYPE** A versatile recessed mounted flanged luminaire.
- CONSTRUCTION** 22 ga. cold rolled steel housing. (20 ga. housing available as specified)
- FINISH** Baked white polyester finish, minimum reflectance 86%. (Powder coated finish available.)
- DOOR FRAME** 20 gauge cold rolled steel or extruded aluminum in various finishes. T-hinge, positive spring loaded latch.
- GASKET** One way polyurethane gasketed standard. More options available.
- OPTICS** Clear prismatic acrylic standard. Extensive variety of lenses, diffusers and louvers available.
- WIRING** 120v 60Hz., 277v 60Hz., UNV (universal voltage 120v thru 277v.) or as otherwise specified.
- LABELS** U.L. Listed. Suitable for damp locations. Compatible with UL Fire-Rated Ceiling Assemblies.



PHOTOMETRIC DATA

FHL310-2-4R-FSW-PA-E8

TEST NO.=LA-T0357-1
 LAMP TYPE=FO32T8
 NO. OF LAMP=2
 LUMENS PER LAMP=2900
 WATTS PER LAMP=32
 BALLAST FACTOR=1
 PHOTOMETRY TYPE=C

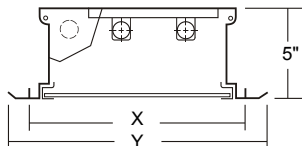

Ceiling Opening X - 12_1/2" X 48_1/2"
 Overall Width By Length Y - 14" X 50"

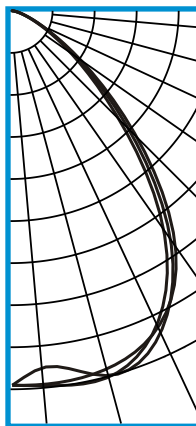

CANDLEPOWER

ANGLE	END	45	CROSS
0	1687	1687	1687
5	1689	1613	1695
15	1668	1701	1705
25	1566	1591	1551
35	1279	1239	1184
45	779	726	664
55	360	332	306
65	124	124	113
75	34	35	34
85	5	5	5
90	0	0	0
95	0	0	0
105	0	0	0
115	0	0	0
125	0	0	0
135	0	0	0
145	0	0	0
155	0	0	0
165	0	0	0
175	0	0	0
180	0	0	0

ZONAL LUMEN SUMMARY

DEGREES	LUMENS	% LAMP	% FIXTURE
0-30	1367	23.6	43.2
0-40	2143	36.9	67.8
0-60	3001	51.7	94.9
0-90	3162	54.5	100.0
90-120	0	0.0	0
90-150	0	0.0	0
90-180	0	0.0	0
0-180	3162	54.5	100.0

Lumen Output = 3162 lumens
 Luminaire Efficiency = 54.5%

SPACING CRITERION

ALONG	ACROSS
1.24	1.19

This space is intentionally left blank.

This space is intentionally left blank.

This space is intentionally left blank.

