

LED T8 - RECESSED

GHL310 SERIES

5" Depth/Premium Grade T-Bar Luminaire



- 5" Depth/Premium Grade T-Bar Luminaire For LED T8 Internal Driver Light Tube (by Others)
 - 22 Gauge Cold Rolled Steel Housing
 - 20 Gauge Steel or Extruded Aluminum Door Frame Screwed At Each Corner
 - Door Frame Painted After Fabrication
 - T-Hinge And Spring Loaded Latch
 - Screwed-On End Caps
- Available with:
 Heavy Duty Safety Switch
 Extensive Variety of Lenses



LOS ANGELES LIGHTING MFG. CO.

10141 OLNEY ST. / EL MONTE, CA 91731

<http://www.lalighting.com>

TEL : 626-454-8300 FAX : 626-454-8399

GHL310-3-4L-PA-LED8

TEST NO.=LA-T1872
 LAMP TYPE=LED T8, 4'
 NO. OF LAMP=3
 LUMENS PER LAMP=1300
 WATTS PER LAMP=15
 BALLASTFACTOR=1
 PHOTOMETRY TYPE=C

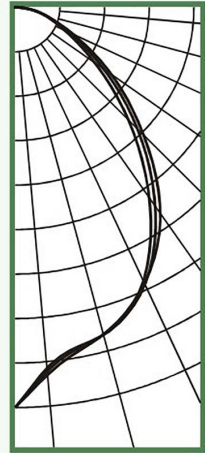

CANDLEPOWER

Angle	End	45	Cross
0	1352	1352	1352
5	1223	1233	1246
15	1146	1145	1145
25	1020	1032	1028
35	786	821	851
45	539	582	610
55	326	364	395
65	184	194	213
75	100	103	107
85	29	31	31
90	1	1	2
95	0	0	0
105	0	0	0
115	0	0	0
125	0	0	0
135	0	0	0
145	0	0	0
155	0	0	0
165	0	0	0
175	0	0	0
180	0	0	0

ZONAL LUMEN SUMMARY

DEGREES	LUMENS	% LAMP	% FIXTURE
0-30	919	23.6	36.2
0-40	1434	36.8	56.5
0-60	2207	56.6	87.0
0-90	2536	65.0	100.0
90-120	0	0.0	0.0
90-150	0	0.0	0.0
90-180	0	0.0	0.0
0-180	2537	65.0	100.0

Luminaire Efficiency = 65.0%

SPACING CRITERION

ALONG	ACROSS
1.03	1.05

LED T8 - RECESSED



GHL310 SERIES - LED T8

CROSS SECTION

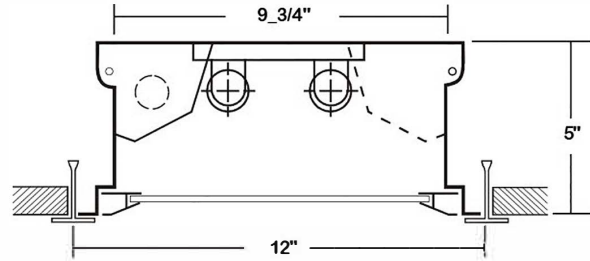

BACK PLATE

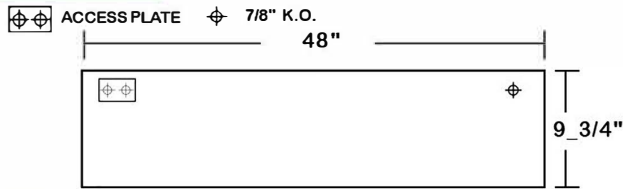

SAFETY SWITCH



- TS2- LED Luminaire On/Off Safety Switch**
- Easily accessible on exterior of wire way.
 - Allows individual fixture to be switched ON/OFF during re-lamping or Maintenance.
 - Prevents damage to lamp and electrical shock during lamping and re-lamping.
 - Allows safe entry to wire way channel where power connector can be disconnected for maintenance to fixture.

CATALOG NUMBER

	NOMINAL LENGTH	TOTAL LAMPS
GHL310-1-4LI	4'	1
GHL310-1-4LR	4'	1
GHL310-2-4LI	4'	2
GHL310-2-4LR	4'	2
GHL310-3-4LI	4'	3
GHL310-3-4LR	4'	3

DOOR FRAME INFORMATION

• **CROSS SECTION**

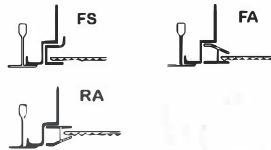

FS W

STYLES

- FS - Flat Steel
- FA - Flat Extruded Aluminum
- RA - 5/8" Regressed Extruded Aluminum

FINISHES

- W - White Enamel
- B - Black Enamel
- N - Natural Anodized Aluminum

ORDERING GUIDE

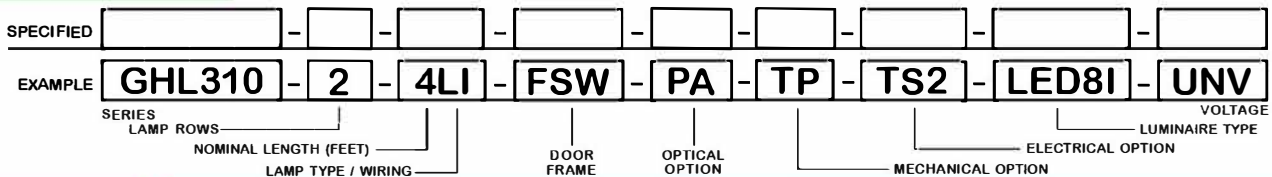

LAMP TYPE

LI = LED T8 internal driver light tube.
Both ends powered.
Shunted sockets used.



LR = LED T8 internal driver light tube.
Single end powered.
Non-shunted sockets used.



OPTIONS AND ACCESSORIES

- **OPTICAL OPTIONS**
Parabolic Plastic Louvers *
Polycarbonate Lenses *
High Impact Acrylic *
Flat Frosted White Acrylic **
Clear Prismatic Acrylic **

SUFFIX
*
*
*
**
**
FFWA
PA

- **MECHANICAL OPTIONS**
Gasketing

SUFFIX
GSK

- **ELECTRICAL OPTIONS**
LED Luminaire ON/OFF Safety Switch

SUFFIX
TS2

*See Appropriate Reference Page

SPECIFICATIONS

** Lamp(s) by others.

- **TYPE**
- **CONSTRUCTION**
- **FINISH**
- **DOOR FRAME**
- **OPTICS**
- **WIRING**
- **LABELS**

A versatile recessed luminaire for LED T8 internal driver light tube (s)**. For inverted Tee-Bar installations. 22 ga. cold rolled steel housing. (20 ga. housing available as specified)
Baked white polyester finish, minimum reflectance 86%. (Powder coated finish available.)
20 gauge cold rolled steel or extruded aluminum in various finishes. T-hinge, positive spring loaded latch.
Clear prismatic acrylic standard. Extensive variety of lenses, diffusers and louvers available.
Operates LED T8 internal driver light tube(s)**.
U.L. Listed. Suitable for damp locations.

