



RECESSED

GHL320 SERIES



2X4, 5" Depth / Premium Grade T-Bar



- 2X4, 5" Depth / Premium Grade T-Bar Luminaire
- 22 Gauge Cold Rolled Steel Housing
- Screwed-On End Caps
- 20 Gauge Steel or Extruded Aluminum Door Frame Screwed at Each Corner
- Door Frame Painted After Fabrication
- One Way Polyurethane Gasketed
- T-Hinges And Spring Loaded Latches
- One Way Polyurethane Gasketed
- Suitable for Damp Locations
- Available with:

Fluorescent, LED and LED T8 (Internally Driven)

Variety of Lens Options

Tamper Proof Screws

Emergency Battery Pack



Photometric Data and IES Files are Available on www.lalighting.com



LOS ANGELES LIGHTING MFG. CO.

10141 OLNEY ST. / EL MONTE, CA 91731

TEL : 626-454-8300 FAX : 626-454-8399

www.lalighting.com

RECESSED - Fluorescent

LED Equivalent Products Available on www.lalighting.com



**GHL320 SERIES
2x4**

CROSS SECTION

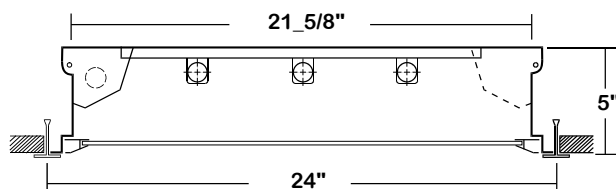

BACK PLATE

ACCESS PLATE 7/8" K.O.

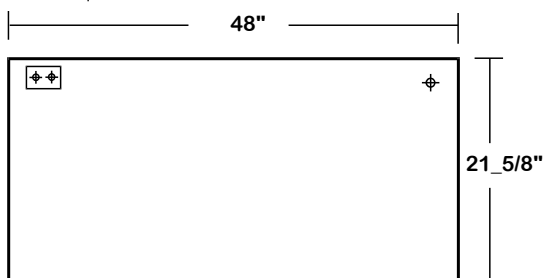

DOOR FRAME INFORMATION

CROSS SECTION

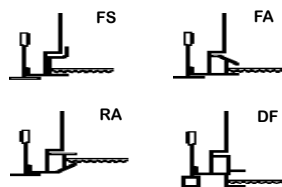

FS W

FINISHES

W - White Enamel
B - Black Enamel
N - Natural Anodized Aluminum

STYLES

FS - Flat Steel
FA - Flat Extruded Aluminum
RA - 5/8" Regressed Extruded Aluminum R2 - 2" Regress
DF - Aluminum frame For Donn Fine Line® T-Bar

CATALOG NUMBER

	NOMINAL WIDTH X LENGTH	TOTAL LAMPS		NOMINAL WIDTH X LENGTH	TOTAL LAMPS
GHL320-2-4M	2' X 4'	2	GHL320-2-4R	2' X 4'	2
GHL320-3-4M	2' X 4'	3	GHL320-3-4R	2' X 4'	3
GHL320-4-4M	2' X 4'	4	GHL320-4-4R	2' X 4'	4
GHL320-5-4M	2' X 4'	5	GHL320-5-4R	2' X 4'	5
GHL320-6-4M	2' X 4'	6	GHL320-6-4R	2' X 4'	6

ORDERING GUIDE

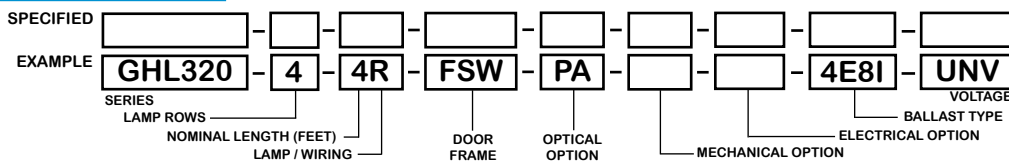

NOTE: LAMP/WIRING*
M = Miniature Bi-Pin T5
R = Medium Bi-Pin T8

OPTIONS AND ACCESSORIES

OPTICAL OPTIONS

Clear Acrylic
Clear Prismatic Acrylic
Flat White Acrylic
Polycarbonate Lenses
High Impact Acrylic
Note: Other lens available upon request

SUFFIX

CA
PA
FWA
*
*

MECHANICAL OPTIONS

Tamper Proof Screws (Hex Socket With Post)
Gasketing
Emergency Battery Pack
External Line Fusing (HLR/GLR)

SUFFIX

TP
GSK*
SUFFIX
BP*
ELF

BALLAST OPTIONS*

Electronic T5
Electronic T5HO
Electronic T8 Instant Start
Electronic T8 Rapid Start
Electronic T8HO
x = Number of Lamps per Ballast

SUFFIX

xE5
xE5H
xE8I
xE8R
xE8H

*Refer to www.lalighting.com/resources for more information

SPECIFICATIONS

- TYPE** A versatile recessed luminaire. For mounting in inverted Tee-Bar installations.
- CONSTRUCTION** 22 ga. cold rolled steel housing. (20 ga. housing available as specified)
- FINISH** Baked white polyester finish, minimum reflectance 86%. (Powder coated finish available.)
- DOOR FRAME** 20 gauge cold rolled steel or extruded aluminum in various finishes. T-hinge, positive spring loaded latch.
- GASKET** One way polyurethane gasketed standard. More options available.
- OPTICS** Clear prismatic acrylic standard. Extensive variety of lenses, diffusers and louvers available.
- WIRING** 120v 60Hz., 277v 60Hz., UNV (universal voltage 120v thru 277v.) or as otherwise specified.
- LABELS** U.L. Listed. Suitable for damp locations. Compatible with UL Fire-Rated Ceiling Assemblies.



PHOTOMETRIC DATA

GHL320-4-4R-FSW-PA-E8

TEST NO.=LA-T0263
 LAMP TYPE=FO32T8
 NO. OF LAMP=4
 LUMENS PER LAMP=2900
 WATTS PER LAMP=32
 BALLAST FACTOR=1
 PHOTOMETRY TYPE=C

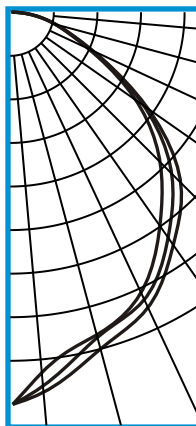
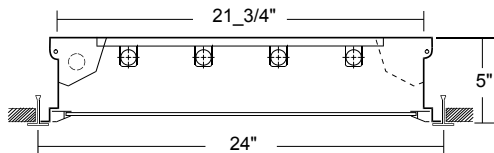

CANDLEPOWER

ANGLE	END	45	CROSS
0	3301	3301	3301
5	3025	3144	3201
15	2800	2819	2920
25	2582	2651	2724
35	2164	2287	2365
45	1748	1887	1994
55	1244	1326	1367
65	672	713	703
75	352	360	352
85	103	107	106
90	6	6	12
95	0	0	0
105	0	0	0
115	0	0	0
125	0	0	0
135	0	0	0
145	0	0	0
155	0	0	0
165	0	0	0
175	0	0	0
180	0	0	0

ZONAL LUMEN SUMMARY

DEGREES	LUMENS	% LAMP	% FIXTURE
0-30	2332	20.1	30.9
0-40	3762	32.4	49.8
0-60	6397	55.2	84.6
0-90	7557	65.1	100.0
90-120	2	0.0	0
90-150	2	0.0	0
90-180	2	0.0	0
0-180	7559	65.2	100.0

Lumen Output = 7559 lumens
 Luminaire Efficiency = 65.2%

SPACING CRITERION

ALONG	ACROSS
1.08	1.15

This space is intentionally left blank.

This space is intentionally left blank.

This space is intentionally left blank.

