



RECESSED

GIC120 SERIES



Direct / Indirect T-Bar Luminaire



- Center Basket Direct / Indirect Recessed Mounted T-Bar Luminaire
- Center Perforated Light Shields with Polyethylene Trims
- Easy Access To Electrical Components
- Removable Wiring Access Plate
- High Reflectance, Low Gloss Matte White Finish
- Suitable for Damp Locations
- Available with:
 - Fluorescent, LED and LED T8 (Internally Driven)
 - Curve Contour Acrylic Lens
 - Emergency Battery Pack



Photometric Data and IES Files are Available on www.lalighting.com



LOS ANGELES LIGHTING MFG. CO.

10141 OLNEY ST. / EL MONTE, CA 91731

TEL : 626-454-8300 FAX : 626-454-8399

www.lalighting.com

RECESSED - Fluorescent



**GIC120 SERIES - LED
Center Basket 2x2 & 2x4**

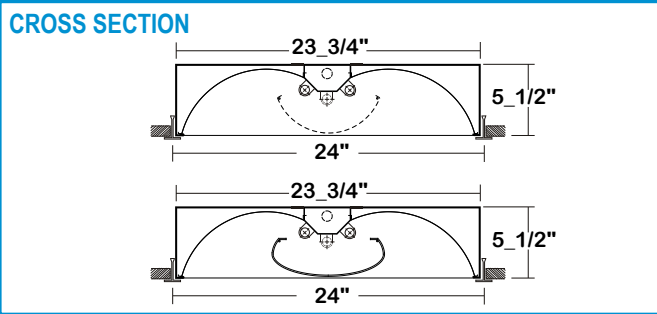

BACK PLATE

- ACCESS PLATE
- 7/8" K.O.

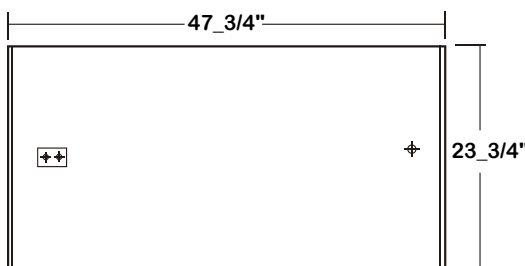
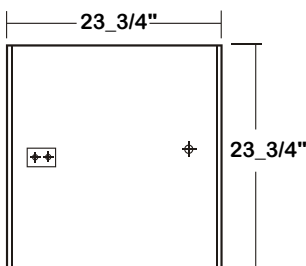

CATALOG NUMBER

	NOMINAL WIDTH X LENGTH	TOTAL LAMPS		NOMINAL WIDTH X LENGTH	TOTAL LAMPS
GIC120-1-2M	2' X 2'	1	GIC120-1-4M	2' X 4'	1
GIC120-2-2M	2' X 2'	2	GIC120-2-4M	2' X 4'	2
GIC120-3-2M	2' X 2'	3	GIC120-3-4M	2' X 4'	3
GIC120-1-2R	2' X 2'	1	GIC120-1-4R	2' X 4'	1
GIC120-2-2R	2' X 2'	2	GIC120-2-4R	2' X 4'	2
GIC120-3-2R	2' X 2'	3	GIC120-3-4R	2' X 4'	3

ORDERING GUIDE

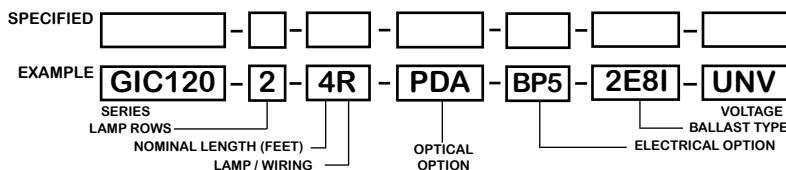

NOTE: LAMP/WIRING*
 M= Miniature Bi-Pin T5
 R = Medium Bi-Pin T8

OPTIONS AND ACCESSORIES

OPTICAL OPTIONS

- Perforated Shield / White Acrylic
- Curve Contour Acrylic Lens / Linear Pattern

SUFFIX
PDA
C/LP

ELECTRICAL OPTIONS

- Emergency Battery Pack
- External Line Fusing (HLR/GLR)

SUFFIX
BP5
ELF

BALLAST OPTIONS*

- Electronic T5
- Electronic T5HO
- Electronic T8 Instant Start
- Electronic T8 Rapid Start
- Electronic T8HO
- Electronic Dimming T8 Rapid Start (0-10V)

SUFFIX

- xE5
- xE5H
- xE8I
- xE8R
- xE8H
- xEDM8R(0-10V)

*Refer to www.lalighting.com/resources for more information

x = Number of Lamps per Ballast

SPECIFICATIONS

- TYPE
- CONSTRUCTION
- FINISH
- OPTIC
- REFLECTOR
- WIRING
- LABELS

Direct / indirect recessed mounted luminaires for inverted T-bar ceilings.
 22 ga. cold rolled steel housing. (20 ga. housing available as specified)
 Baked white polyester finish housing. (Powder coated finish available.)
 Perforated center-mount metal light shield with polyethylene protecting trims, snap out for easy re-lamping and maintenance. Curve contour acrylic lens available.
 Cold rolled steel reflectors, high reflectance, low gloss matte white finish.
 120v 60Hz., 277v 60Hz., UNV (universal voltage 120v thru 277v.) or as otherwise specified.
 U.L. Listed. Suitable for damp locations. Compatible with UL Fire-Rated Ceiling Assemblies.



PHOTOMETRIC DATA

GIC120-2-4R-PDA-E8

TEST NO.=LA-T1703
 LAMP TYPE=FO32T8
 NO. OF LAMP=2
 LUMENS PER LAMP=2900
 WATTS PER LAMP=32
 BALLAST FACTOR=1
 PHOTOMETRY TYPE=C

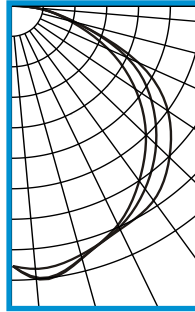
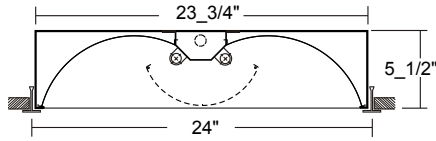

CANDLEPOWER

ANGLE	END	45	CROSS
0	1084	1084	1084
5	1058	1108	1120
15	1057	1071	1067
25	994	1021	1031
35	873	927	970
45	741	810	873
55	601	681	755
65	440	526	558
75	269	275	249
85	102	88	84
90	6	5	5
95	0	0	0
105	0	0	0
115	0	0	0
125	0	0	0
135	0	0	0
145	0	0	0
155	0	0	0
165	0	0	0
175	0	0	0
180	0	0	0

ZONAL LUMEN SUMMARY

DEGREES	LUMENS	% LAMP	% FIXTURE
0-30	878	15.1	24.6
0-40	1458	25.1	40.9
0-60	2695	46.5	75.6
0-90	3561	61.4	0
90-120	1	0	0
90-150	1	0	0
90-180	1	0	0
0-180	3562	61.4	100.0

Lumen Output = 4979 lumens
 Luminaire Efficiency = 61.4%

SPACING CRITERION

ALONG	ACROSS
1.27	1.38

GIC120-3-4R-PDA-E8

TEST NO.=LA-T1570
 LAMP TYPE=FO32T8
 NO. OF LAMP=3
 LUMENS PER LAMP=2900
 WATTS PER LAMP=32
 BALLAST FACTOR=1
 PHOTOMETRY TYPE=C

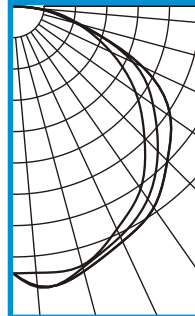
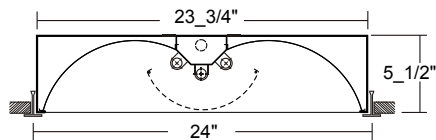

CANDLEPOWER

ANGLE	END	45	CROSS
0	1346	1346	1346
5	1348	1421	1415
15	1352	1364	1383
25	1240	1281	1308
35	1123	1186	1239
45	938	1033	1101
55	756	862	969
65	546	671	723
75	342	354	332
85	134	118	121
90	7	8	8
95	0	0	0
105	0	0	0
115	0	0	0
125	0	0	0
135	0	0	0
145	0	0	0
155	0	0	0
165	0	0	0
175	0	0	0
180	0	0	0

ZONAL LUMEN SUMMARY

DEGREES	LUMENS	% LAMP	% FIXTURE
0-30	1112	12.8	24.5
0-40	1855	21.6	40.8
0-60	3424	39.4	75.4
0-90	4540	52.2	100.0
90-120	2	0	0
90-150	2	0	0
90-180	2	0	0
0-180	4542	52.2	100.0

Lumen Output = 4542 lumens
 Luminaire Efficiency = 52.2%

SPACING CRITERION

ALONG	ACROSS
1.30	1.41

