



OPEN COMMERCIAL

STR100 SERIES



One-Light Strip Luminaire



- One-Light Strip Luminaire
- 22 Ga. Cold Rolled Steel Housing
- Baked White Polyester Finish
- Screw-On End Caps
- End Plates May be Used as Channel Couplings
- Cover Secured by Two Quarter Turn Fasteners
- Suitable for Damp Locations
- Available with:
 - Fluorescent, LED and LED T8 (Internally Driven)
 - Asymmetrical or Symmetrical Reflectors
 - Emergency Battery Pack
 - Switch
 - 14 ga. Wire Guard



Photometric Data and IES Files are Available on www.lalighting.com



LOS ANGELES LIGHTING MFG. CO.

10141 OLNEY ST. / EL MONTE, CA 91731

TEL : 626-454-8300 FAX : 626-454-8399

www.lalighting.com

OPEN COMMERCIAL - LED T8 (Internally Driven)



STR100 SERIES - LED T8

CROSS SECTION

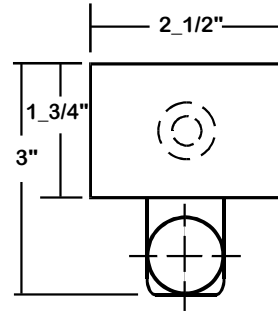

BACK PLATE

- V-HOOK
- 3/16" MTG. HOLE
- 7/8" K.O.

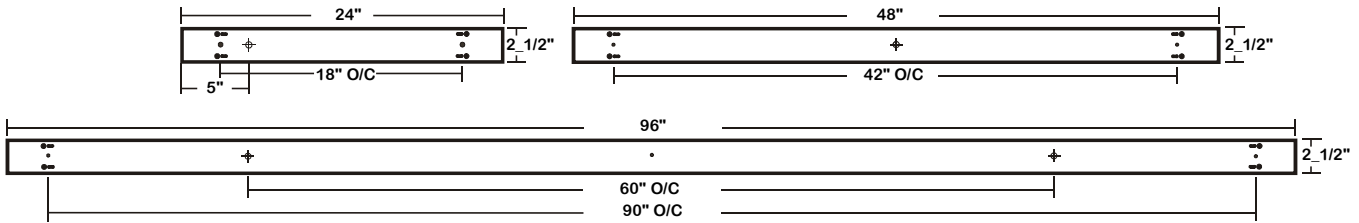

CATALOG NUMBER

| CATALOG NUMBER | NOMINAL LENGTH | TOTAL MODULES |
|----------------|----------------|---------------|
| STR100-1-2Lx | 2' | 1 |
| STR100-1-4Lx | 4' | 1 |
| STR100-1-8LxT | 8' | 2 |

REFLECTOR INFORMATION

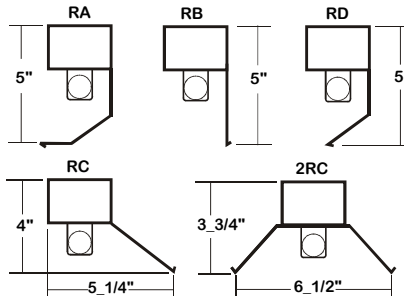

SR RA

STYLE

- RA - 3-Bend asymmetrical Reflector
- RB - 90° 1-Bend asymmetrical Reflector
- RC - 45° 1-Bend asymmetrical Reflector
- RD - 2-Bend asymmetrical Reflector
- 2RC - 45° symmetrical Reflector

MATERIAL

Leave blank for white steel
SR - Specular aluminum (95%)

ORDERING GUIDE

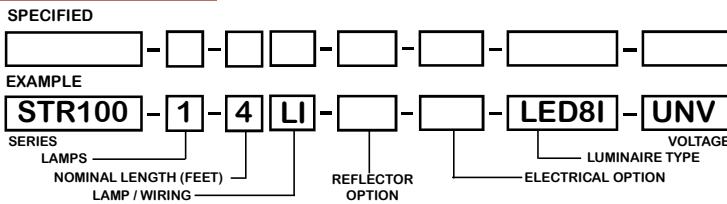

OPTIONS AND ACCESSORIES

ELECTRICAL OPTIONS

LED Luminaire ON/OFF Safety Switch

SUFFIX
TS2

ACCESSORIES

- Wire Guard - 14 Ga.
- 4" Leg Height V-Hook
- Fixture Suspension System

CAT. NO.
WG14-STR100
V4
*

*See Appropriate Reference Page

LAMP / WIRING

LI = LED T8 internal driver light tube.
Both ends powered.
Shunted sockets used.



LR = LED T8 internal driver light tube.
Single end powered.
Non-shunted sockets used.



SPECIFICATIONS

- **TYPE** Open lamp one-light channel.
- **CONSTRUCTION** 22 ga. cold rolled steel housing. (20 ga. housing available as specified.) End plates are fastened to housing by sheet metal screws to assure rigidity. End plates may be used as channel couplings.
- **FINISH** Baked white polyester finish standard, minimum reflectance 86%. (Powder coated finish available)
- **WIRE GUARD** Chrome epoxy powder coated.
- **WIRING** Operate LED T8 internally driven light tube(s)**.
- **LABELS** Suitable for damp locations.

** Lamp(s) by others.

