



WRAPAROUND LED

WSE200 SERIES

HIGH IMPACT SECURITY WRAPAROUND LUMINAIRE

ORDERING INFO SYSTEM DATA DRIVER SENSORS PHOTOMETRIC

INTERACTIVE BUTTONS

JOB	
TYPE	
DATE	

WWW.LALIGHTING.COM
626-454-8300

STEM / SUSPENSION MOUNTED LED LUMINAIRE

DIMENSIONS

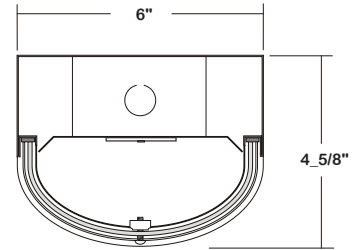

- ✦ 11/16" STEM MTG. K.O.
- ⊕ 7/8" OFFSET K.O.
- ⊕ 2" K.O.
- 7/8" K.O. ON SIDE OF HOUSING FOR 1/2" CONDUIT

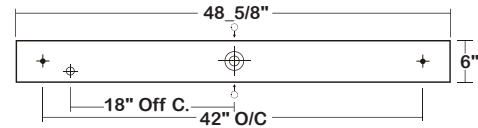

APPLICATIONS

Workrooms, Commercial, Parking Structure, Corridor

FEATURES

- Stem / suspension mounted LED luminaire
- 0-10V dimming driver standard
- Supports California Title 24 compliance

OPTIONS

- Wet location available
- Wireless control options available
- Emergency battery pack available
- 45-degree mounting bracket available
- Full customization available upon request
- Additional lumen packages and color temperatures available

SPECIFICATIONS

CONSTRUCTION

- 22 ga. die formed cold rolled steel housing with 18ga. end plates, spot welded seams and corners
- Full neoprene gasket
- Phillips head screws / tamper proof screws available

FINISH

- Baked white powder coated finish / painted after fabrication / minimum reflectance 90%

ELECTRICAL

- High efficiency drivers coupled with long-life LEDs
- Service life tested at 50,000 hours (L70)
- Universal voltage 120V through 277V (347V / 480V available)
- Power Factor (PF) ≥ 0.9
- Total Harmonic Distortion (THD) ≤ 20%
- LED light engine is pre-wired with a quick connector for easy connection

LISTING

- UL USA and Canada classified / suitable for damp locations

WARRANTY

- 5-year limited warranty, 10-year limited warranty available



Los Angeles Lighting Mfg. Co.
Headquarters Contact Us
10141 Olney Street T: 626-454-8300
El Monte, CA 91731 F: 626-454-8399
Made in the USA www.lalighting.com



BAA Compliant



Due to continued product improvements and enhancements, Los Angeles Lighting Manufacturing Company reserves the right to alter specifications, dimensions, data, and/or materials without notice. Please visit our website to view the most current information.



MADE IN THE U.S.A.

Revised 08/27/20

WARNING

RETROFIT SERIES	LED LUMEN PACKAGE	NOMINAL LENGTH	EFFICACY	MECHANICAL	ELECTRICAL	DRIVER	VOLTAGE	# OF LED ROW	CRI / CCT
WSE200						DRDM	UNV	1	
WSE200 High Impact Security Wraparound LED Luminaire	2 Nom. 2000 Lumens 4 Nom. 4000 Lumens 6 Nom. 6000 Lumens 8 Nom. 8000 Lumens *Additional Lumen Packages Available	4L 4'	(Blank) Standard HE High Efficacy (Only 2000 / 4000 / 6000 lumens Systems)	TP Tamper Proof Screws (Hex Socket w/Post) PH Phillips Head Screws WL Wet Location (Electro Galvanized Steel Housing)	BPL 1.5 Emergency Battery Pack, Nom. 1500 lm WLC(LED RU) EnOcean Wireless Control MSxx Motion Sensor *Leave Blank if Not Specified	DRDM 0-10V Dimming Driver	UNV 120V-277V	1 One LED Row	830 80+CRI/3000k Color Temp. 835 80+CRI/3500k Color Temp. 840 80+CRI/4000k Color Temp. 850 80+CRI/5000k Color Temp. 8TW Tunable White 827 to 865 *Additional Color Temp. Available

MECHANICAL OPTIONS | ELECTRICAL OPTIONS | DRIVERS OPTIONS | SENSOR OPTIONS

INTERACTIVE BUTTONS

SYSTEM DATA

THESE ARE THE MOST POPULAR LUMEN PACKAGES. PLEASE CONSULT FACTORY FOR ADDITIONAL SYSTEM DATA.

LED LUMEN PACKAGE	NORMAL AMBIENT TEMPERATURE PRODUCT CODE	DELIVERED LUMENS	SYSTEM WATTS	LUMINAIRE EFFICACY	AMBIENT TEMP.	FLUORESCENT EQUIVALENT	IES FILES
2000 Lumens (Nominal)	WSE200-2-4L-DRDM-UNV-1/840	2027 lm	16.9 W	119.7 lm/W	-20°C / 35°C	2-F17T8	*
4000 Lumens (Nominal)	WSE200-4-4L-DRDM-UNV-1/840	3871 lm	33.1 W	116.9 lm/W	-20°C / 35°C	2-F32T8	LA-T3104
6000 Lumens (Nominal)	WSE200-6-4L-DRDM-UNV-1/80	5529 lm	51.1 W	108.2 lm/W	-20°C / 35°C	3-F32T8	LA-T3105
8000 Lumens (Nominal)	WSE200-8-4L-DRDM-UNV-1/840	7483 lm	52.3 W	143.0 lm/W	-20°C / 35°C	4-F32T8	T2873-1
LED LUMEN PACKAGE	NORMAL AMBIENT TEMPERATURE (HIGH EFFICACY) PRODUCT CODE	DELIVERED LUMENS	SYSTEM WATTS	LUMINAIRE EFFICACY	AMBIENT TEMP.	FLUORESCENT EQUIVALENT	IES FILES
2000 Lumens (Nominal)	WSE200-2HE-4L-DRDM-UNV-1/840	2033 lm	13.5 W	150.4 lm/W	-20°C / 35°C	2-F17T8, 1-F24T5HO	*
4000 Lumens (Nominal)	WSE200-4HE-4L-DRDM-UNV-1/840	3614 lm	24.9W	144.9 lm/W	-20°C / 35°C	4-F27T8, 2-F24T5HO	*
6000 Lumens (Nominal)	WSE200-6HE-4L-DRDM-UNV-1/840	5460 lm	39.0 W	140.1 lm/W	-20°C / 35°C	6-F17T8, 3-F24T5HO	*

NOTE:
System data above is based on 120V input voltage.
Actual performance may differ as a result of end-user environment and application.
This fixture has been tested and listed in accordance with UL Standards. L.A. Lighting certifies that it will operate safely when installed properly, and within an ambient temperature range from -20°C to 40°C.

Additional lumen packages and color temperatures available.

Due to constant updates on this product, please visit the [DLC QPL Website](#) for the most accurate system data and information.



DLC part numbers:
3-WSE200-4K-4L-xxxxx-xxxx-1DRDM-UNV-1/840
3-WSE200-4K-4L-xxxxx-xxxx-1DRDM-UNV-1/850
3-WSE200-6K-4L-xxxxx-xxxx-1DRDM-UNV-1/840
3-WSE200-6K-4L-xxxxx-xxxx-1DRDM-UNV-1/850
3-WSE200-8K-4L-xxxxx-xxxx-1DRDM-UNV-1/840
3-WSE200-8K-4L-xxxxx-xxxx-1DRDM-UNV-1/850



Los Angeles Lighting Mfg. Co.
Headquarters Contact Us
10141 Olney Street T: 626-454-8300
El Monte, CA 91731 F: 626-454-8399
Made in the USA www.lalighting.com



BAA Compliant



Due to continued product improvements and enhancements, Los Angeles Lighting Manufacturing Company reserves the right to alter specifications, dimensions, data, and/or materials without notice. Please visit our website to view the most current information.



MADE IN THE U.S.A.
Revised 08/27/20
WARNING

DRIVER OPTIONS

BATTERY PACK OPTIONS

BACK TO TOP

PLEASE CONSULT FACTORY TO SEE IF YOUR SELECTED DRIVER OPTION WORKS WITH THIS FIXTURE.

PLEASE CONSULT FACTORY TO SEE IF YOUR SELECTED BATTERY PACK OPTION WORKS WITH THIS FIXTURE.

LED EMERGENCY BATTERY PACKS
(Operate for 90 minutes unless otherwise specified)

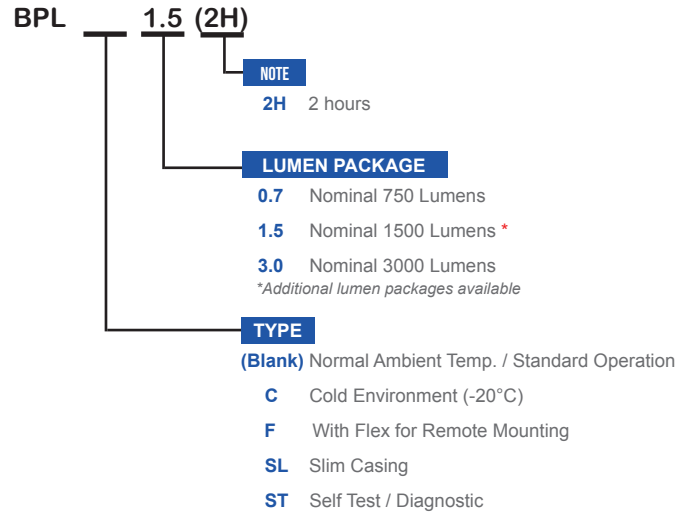
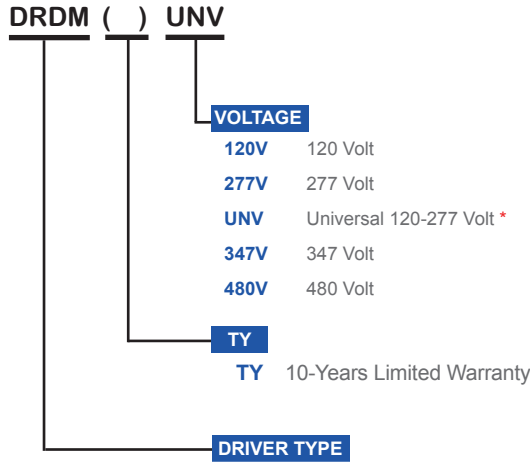

- DRDM** 0-10V Dimming Driver *
- DRDM1** 0-10V Dimming Driver, 1% Dimming
- DRDM2C** 2-Channel 0-10V Dimming Driver (for Color Tunable White)
- DR2W** 2-Wire Phase Dimming Driver
- DRDA** Digital Addressable DALI Dimming Driver
- DRDA2C** Digit Digital Addressable DALI Type8 2-Channel Driver (for Color Tunable White)
- DRDA2.0** Digital Addressable DALI 2.0 Dimming Driver
- DRDA2.02C** Digital Addressable DALI 2.0 Type8 2-Channel Driver (for Color Tunable White)
- DRSD** Step Dimming Driver
- DR(LTEA2W)** Lutron® 2-Wire 1% Dimming Driver (120V Forward Phase only)
- DR(LDE1)** Lutron® EcoSystem 1% Soft-On, Fade-to-Black™ Dimming Driver
- DR(LDE5)** Lutron® EcoSystem 5% Dimming Driver
- DR(PEQ0E)** Lutron® EcoSystem 0.1% Soft-On, Fade-to-Black Dimming Driver
- DR(PSQ020)** Lutron® T-Series Digital 1% Dimming 2-Channel Driver (for Color Tunable White)
- DRCR** Control Ready Driver
- DRCR(DXL)** Osram Dexal Driver
- DRCR(SR)** Philips Sensor Ready Driver

* Normal Stock Item

ACCESSORIES

- 433B**
- Blank Canopy with Cable
 - No Power Cord
 - Cable Length 48" and 96"
 - Max. Weight 196 lbs. Per Set

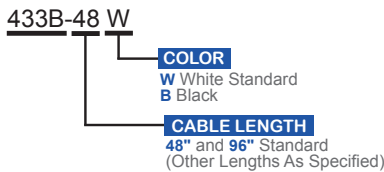

- 444F**
- Feed-In Canopy with Straight Cord
 - Includes Power Cord
 - Cable Length 48" and 96"
 - Max. Weight 196 lbs. Per Set

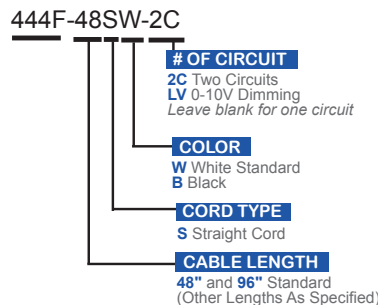

- 45MB**
- 45-Degree Mounting Bracket
 - Designed for mounting lighting fixtures at 45° angle
 - Ideal for wall or ceiling mount applications
 - 18 ga. electro galvanized steel
 - Baked white powder coated finish

Note: Must drill own holes for 45-Degree Mounting Bracket.

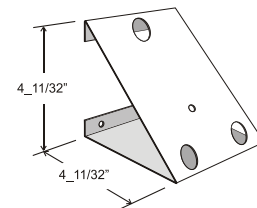

Los Angeles Lighting Mfg. Co.
Headquarters Contact Us
10141 Olney Street T: 626-454-8300
El Monte, CA 91731 F: 626-454-8399
Made in the USA www.lalighting.com



BAA Compliant



Due to continued product improvements and enhancements, Los Angeles Lighting Manufacturing Company reserves the right to alter specifications, dimensions, data, and/or materials without notice. Please visit our website to view the most current information.



MADE IN THE U.S.A.

Revised 08/27/20

WARNING

WIRELESS MOTION SENSOR OPTIONS**CONTROLS AND SENSORS****WLC(LED RU) - EnOcean® LED Relay Zone Controller**

- Supports a single LED fixture or multiple daisy chained LED fixtures
- Module installed inside lighting fixture

ESRPU-W-EO - EnOcean® Rocker Switch – Single – Surface Mount

- Wireless single rocker switch with mounting plate
- No batteries needed

EDRPU-W-EO - EnOcean® Rocker Switch – Double – Surface Mount

- Wireless double rocker switch with mounting plate
- No batteries needed

S3054-N300 - EnOcean® Navigan NWC 300U – Commissioning Tool

- Navigan Wireless Commissioner is used to configure EnOcean controllers & sensors
- It can be used to define link tables, change parameters/settings, and to edit & store projects
- Configuration settings can be saved and cloned to enable quick configuration
- Connectivity is through the NWC 300U USB Stick

EOSWU-W-EO - EnOcean® Occupancy Sensor – Wall Mount

- Wireless wall mounted occupancy sensor
- Solar powered - no batteries needed (coin battery operated in low light conditions)
- PIR motion sensor with both wide angle (50') and long range (100') options
- Mounting height: 6-8 feet

EOSCU-W-EO - EnOcean® Occupancy Sensor – Ceiling Mount

- Wireless ceiling mounted occupancy sensor
- Solar powered - no batteries needed (coin battery operated in low light conditions)
- PIR motion sensor with 360 degree viewing angle lens (34' diameter)
- Mounting height: 7-10 feet

ELLSU-W-EO - EnOcean® Light Level Sensor – Ceiling Mount

- Light Level sensor that measures and reports the level of available natural light
- Solar powered - no batteries needed (coin battery operated in low light conditions)
- Enables implementation of daylight harvesting control systems
- Mounting position: At the ceiling, close to ambient light source

HIGH FREQUENCY MOTION SENSORS**MSH - Motion Sensor High Frequency (Microwave)**

- Super high frequency motion sensor (also known as microwave sensor) which detects movement when installed behind low density fixture materials, such as polycarbonate, acrylic and glass diffusers
- Turns light ON/OFF based on motion detection
- Fixture mounting height ~30ft

MSHSD - Motion Sensor High Frequency (Microwave)

- Step-dims output with motion detection
- Used in conjunction with 0-10V Ballast/Driver
- Turns light ON/OFF based on motion detection



Los Angeles Lighting Mfg. Co.
 Headquarters Contact Us
 10141 Olney Street T: 626-454-8300
 El Monte, CA 91731 F: 626-454-8399
 Made in the USA www.lalighting.com



BAA Compliant



Due to continued product improvements and enhancements, Los Angeles Lighting Manufacturing Company reserves the right to alter specifications, dimensions, data, and/or materials without notice. Please visit our website to view the most current information.



MADE IN THE U.S.A.

Revised 08/27/20

WARNING

PHOTOMETRIC DATA - WSE200

WSE200-8-4L-DRDM-UNV-1/840

TEST NO. = LA-T2873-1
 LED TYPE = 32 LED MODULE
 NO. OF MODULE = 2
 SYSTEM WATT (W) = 65.27 W
 CRI ≥ 80
 L70(Hrs.) ≥ 50,000
 PHOTOMETRY TYPE = C

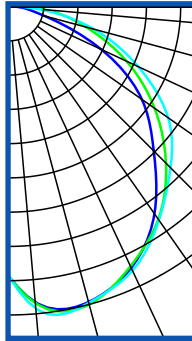
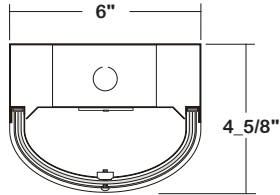

CANDLEPOWER

ANGLE	END	45	CROSS
0	2316	2316	2316
5	2312	2305	2304
15	2194	2133	2231
25	1964	2039	2109
35	1642	1808	1937
45	1268	1532	1715
55	893	1223	1449
65	556	909	1156
75	268	618	871
85	49	379	613
90	0	288	502
95	0	218	403
105	0	132	252
115	0	81	155
125	0	51	97
135	0	30	61
145	0	14	35
155	0	4	13
165	0	0	0
175	0	0	0
180	0	0	0

ZONAL LUMEN SUMMARY

DEGREES	LUMENS	% FIXTURE
0-40	2904	38.4
0-60	5140	67.9
0-90	7041	93.0
90-180	529	7.0
0-180	7588	100.0

Luminaire Output= 7588 lumens
 Luminaire Efficacy = 116.3 LPW

SPACING CRITERION

ALONG	ACROSS
1.17	1.17

This Space is intentionally left blank.

This Space is intentionally left blank.

This Space is intentionally left blank.

