



STRIP LIGHT

STRO50

SERIES 2FT, 3FT, 4FT, 8FT
© 1 1/4" WIDE OPEN STRIP CHANNEL LED LUMINAIRE



JOB	
TYPE	
DATE	

WWW.LALIGHTING.COM TEL: 626-454-8300

SURFACE/SUSPENDED/WALL MOUNTED LED LUMINAIRE

DIMENSIONS



- 3/16" MOUNTING HOLE
- 7/8" K.O.

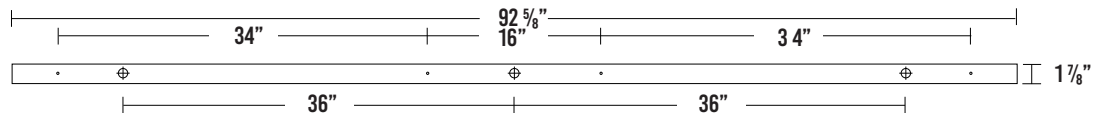
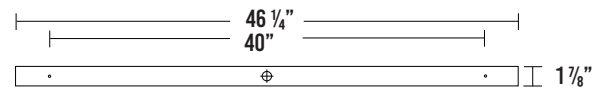
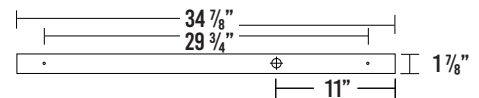
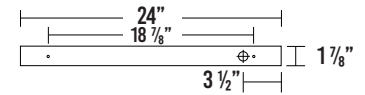
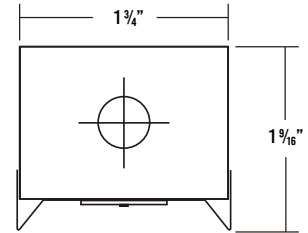

SPECIFICATIONS

CONSTRUCTION

- 22 gauge cold-rolled steel housing
- End plates fastened to housing by sheet metal screws to assure rigidity

FINISH

- Baked white polyester finish
- Minimum reflectance 86

ELECTRICAL

- High efficiency drivers coupled with long-life LED
- Service life tested at 50,000 hours (L70)
- Universal voltage 120V~277V (347V/480V available)
- Power Factor (PF) ≥ 0.9
- Total Harmonic Distortion (THD) ≤ 20%

LISTING

- UL USA and Canada listed
- Suitable for dry locations

WARRANTY

- 5-year limited warranty, 10-year limited warranty available

APPLICATIONS

- Warehouse, Commercial, Industrial

FEATURES

- 0-10V Dimming driver standard
- End plates may be used as channel couplings for continuous row mounting (surface mounted applications only)
- Supports California Title 24 compliance

OPTIONS CONTACT CUSTOMER SERVICE FOR ADDITIONAL OPTIONS

- Controls
- 24 gauge cold-rolled steel reflector
- Custom housing colors
- Plug-in branch wiring connector system
- Cord & Plug
- Emergency battery pack
- Tunable white (2700K - 6500K)
- Customization available upon request

CUSTOM COLORS

BLK - Matte Black

CS - Camaro Silver

BZ - Statuary Bronze



Variety of RAL colors available upon request.



Los Angeles Lighting Mfg. Co.
Contact Us
T: 626-454-8300 10141 Olney Street
F: 626-454-8399 El Monte, CA 91731
www.lalighting.com Made in the USA



Due to continued product improvements and enhancements, Los Angeles Lighting Manufacturing Company reserves the right to alter specifications, dimensions, data, and/or materials without notice. Please visit our website to view the most current information.

© 2022 LOS ANGELES LIGHTING MANUFACTURING CO. ALL RIGHTS RESERVED.

Revised: 01/05/2023



MADE IN THE USA
BAA/BABA Compliant

ORDERING INFORMATION

ADDITIONAL OPTIONS AVAILABLE. VISIT WWW.LALIGHTING.COM/RESOURCES FOR MORE INFORMATION

EXAMPLE: STR050-4-4L-BPLSL1.5-DRDM-UNV-1/840

SERIES	NOMINAL LED LUMENS	NOMINAL LENGTH	REFLECTOR	CONTROLS	ELECTRICAL	DRIVER	VOLTAGE	# OF LED ROWS	CRI / CCT	
STR050								1		
STR050 • 1 3/4" Wide Open Strip Luminaire	1 - 1000lm 2 - 2000lm 3 - 3000lm 4 - 4000lm	2L • 2'	RA • 3-Bend Asymmetrical RB • 90° 1-Bend Asymmetrical RC • 45° 1-Bend Asymmetrical	WLC(LED RU)¹ • Wireless Control MS¹ • Motion Sensor *Leave blank if not specific	BPLSL1.5² • Emergency Battery Pack Slim Casing 1500 lm PIW(xx) • Plug-in Branch Wiring Connector • One or Two Circuit • Low Voltage Dimming C(xx) • Cord 18 gauge 3-wire • Plug Options • NEMA Plug Type • Length of Cord • Location on the fixture *Leave blank if not specific	DRDM • 0-10V Dimming Driver DRSD • Step Dimming Driver DR2W • 2-Wire Phase Dimming Driver • Requires Specific Voltage Callout	UNV • 120V-277V 120V • 120 Volt 277V • 277 Volt 347V • 347 Volt 480V • 480 Volt	1 • 1 LED Row	830 • 80+CRI / 3000K 835 • 80+CRI / 3500K 840 • 80+CRI / 4000K 850 • 80+CRI / 5000K 8TW • 80+CRI Tunable White 2700K-6500K <i>Contact customer service for additional CRI / CCT packages, including 90CRI</i>	
	High Efficac 1HE - 1000lm 2HE - 2000lm 3HE - 3000lm	3L • 3'	RD • 2-Bend Asymmetrical 2RC • 45° Symmetrical *Leave blank if not specific							
	1.5 - 1500lm 3 - 3000lm 4.5 - 4500lm	4L • 4'								
	2 - 2000lm 4 - 4000lm 6 - 6000lm 8 - 8000lm 10 - 10000lm High Efficac 2HE - 2000lm 4HE - 4000lm 6HE - 6000lm	8L • 8'								
4 - 4000lm 8 - 8000lm 12 - 12000lm 16 - 16000lm 20 - 20000lm High Efficac 4HE - 4000lm 8HE - 8000lm 12HE - 12000lm										

Standard options for STR050 shown above. For additional options, including lumen packages, controls, lenses, switches, finishes, and more, visit www.lalighting.com/resources or contact customer service.

¹ Must be end-mounted externally.
² Emergency battery not available for 2' length.

PHOTOMETRIC DATA

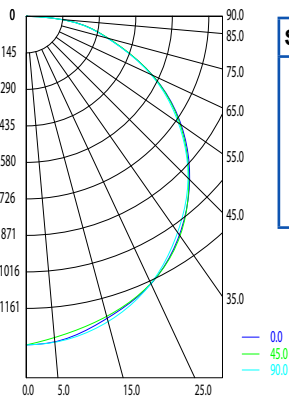

<p>STR050-4-4L-DRDM-UNV-1/840</p> <p>TEST NO. = LA-T3840b LED TYPE = 56 LED MODULE NO. OF MODULE = 1 SYSTEM WATT (W) = 26.7 CRI ≥ 80 L70(Hrs.) ≥ 50,000 PHOTOMETRY TYPE = C</p>

ZONAL LUMEN SUMMARY			
DEGREES	LUMENS	% LAMP	% FIXTURE
0-30	1017	24.91	24.91
0-40	1683	41.21	41.21
0-60	3060	74.90	74.90
0-90	4083	99.93	99.93
90-120	2.46	0.06	0.06
90-150	2.46	0.06	0.06
90-180	2.46	0.06	0.06
0-180	4085	99.99	100.00

SPACING CRITERION	
ALONG	ACROSS
1.27	1.40

Luminaire Output = 4085 lm
Luminaire Efficacy = 152.9 lm/W
Luminaire Efficiency = 99.99%

REFLECTORS

RA **STYLE**
RA - 3-bend asymmetrical reflecto
RB - 90° 1-bend asymmetrical reflector
RC - 45° 1-bend asymmetrical reflector
RD - 2-bend asymmetrical reflecto
2RC - 45° symmetrical reflector

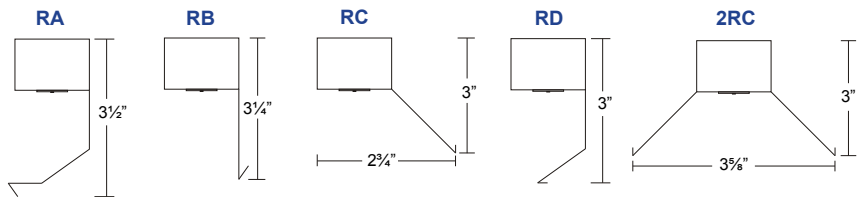

Los Angeles Lighting Mfg. Co.
Contact Us
T: 626-454-8300 10141 Olney Street
F: 626-454-8399 El Monte, CA 91731
www.lalighting.com Made in the USA



Due to continued product improvements and enhancements, Los Angeles Lighting Manufacturing Company reserves the right to alter specifications, dimensions, data, and/or materials without notice. Please visit our website to view the most current information.

© 2022 LOS ANGELES LIGHTING MANUFACTURING CO. ALL RIGHTS RESERVED.

Revised: 01/05/2023



SYSTEM DATA

ADDITIONAL LUMEN PACKAGES AVAILABLE. CONTACT CUSTOMER SERVICE FOR MORE INFORMATION

2' - LED LUMEN PACKAGE	NORMAL AMBIENT TEMPERATURE PRODUCT CODE	DELIVERED LUMENS	SYSTEM WATTS	LUMINAIRE EFFICACY	AMBIENT TEMP.	FLUORESCENT EQUIVALENT	IES FILES
1000 Lumens (Nominal)	STR050-1-2L-DRDM-UNV-1/840	1273	7.3	174.8 lm/W	-20°C / 35°C (-4°F / 95°F)	1-F17T8	*
2000 Lumens (Nominal)	STR050-2-2L-DRDM-UNV-1/840	2091	12.4	169.0 lm/W	-20°C / 35°C (-4°F / 95°F)	2-F17T8 1-F24T5HO	LA-T3838b
3000 Lumens (Nominal)	STR050-3-2L-DRDM-UNV-1/840	3283	20.3	161.7 lm/W	-20°C / 35°C (-4°F / 95°F)	3-F17T8	*
4000 Lumens (Nominal)	STR050-4-2L-DRDM-UNV-1/840	4054	25.8	157.3 lm/W	-20°C / 35°C (-4°F / 95°F)	4-F17T8 2-F24T5HO	*

2' - LED LUMEN PACKAGE	NORMAL AMBIENT TEMPERATURE (HIGH EFFICACY) PRODUCT CODE	DELIVERED LUMENS	SYSTEM WATTS	LUMINAIRE EFFICACY	AMBIENT TEMP.	FLUORESCENT EQUIVALENT	IES FILES
1000 Lumens (Nominal)	STR050-1HE-2L-DRDM-UNV-1/840	1293	7.2	180.0 lm/W	-20°C / 35°C (-4°F / 95°F)	1-F17T8	*
2000 Lumens (Nominal)	STR050-2HE-2L-DRDM-UNV-1/840	2131	12.1	176.3 lm/W	-20°C / 35°C (-4°F / 95°F)	2-F17T8 1-F24T5HO	*
3000 Lumens (Nominal)	STR050-3HE-2L-DRDM-UNV-1/840	3368	19.6	171.7 lm/W	-20°C / 35°C (-4°F / 95°F)	3-F17T8	*

3' - LED LUMEN PACKAGE	NORMAL AMBIENT TEMPERATURE PRODUCT CODE	DELIVERED LUMENS	SYSTEM WATTS	LUMINAIRE EFFICACY	AMBIENT TEMP.	FLUORESCENT EQUIVALENT	IES FILES
1500 Lumens (Nominal)	STR050-1.5-3L-DRDM-UNV-1/840	1702	9.7	175.7 lm/W	-20°C / 35°C (-4°F / 95°F)	1-F25T8	*
3000 Lumens (Nominal)	STR050-3-3L-DRDM-UNV-1/840	3339	19.8	168.3 lm/W	-20°C / 35°C (-4°F / 95°F)	1-F39T5HO 2-F25T8	LA-T3839b
4500 Lumens (Nominal)	STR050-4.5-3L-DRDM-UNV-1/840	4534	27.8	163.2 lm/W	-20°C / 35°C (-4°F / 95°F)	3-F25T8	*

4' - LED LUMEN PACKAGE	NORMAL AMBIENT TEMPERATURE PRODUCT CODE	DELIVERED LUMENS	SYSTEM WATTS	LUMINAIRE EFFICACY	AMBIENT TEMP.	FLUORESCENT EQUIVALENT	IES FILES
2000 Lumens (Nominal)	STR050-2-4L-DRDM-UNV-1/840	2132	12.1	176.4 lm/W	-20°C / 35°C (-4°F / 95°F)	1-F32T8	*
4000 Lumens (Nominal)	STR050-4-4L-DRDM-UNV-1/840	4185	24.7	169.1 lm/W	-20°C / 35°C (-4°F / 95°F)	2-F32T8 1-F54T5HO	LA-T3840b
6000 Lumens (Nominal)	STR050-6-4L-DRDM-UNV-1/840	6177	37.9	163.1 lm/W	-20°C / 35°C (-4°F / 95°F)	3-F32T8	*
8000 Lumens (Nominal)	STR050-8-4L-DRDM-UNV-1/840	8111	51.5	157.4 lm/W	-20°C / 35°C (-4°F / 95°F)	4-F32T8 2-F54T5HO	*
10000 Lumens (Nominal)	STR050-10-4L-DRDM-UNV-1/840	10376	62.6	165.8 lm/W	-20°C / 35°C (-4°F / 95°F)	4-F32T8	*

4' - LED LUMEN PACKAGE	NORMAL AMBIENT TEMPERATURE (HIGH EFFICACY) PRODUCT CODE	DELIVERED LUMENS	SYSTEM WATTS	LUMINAIRE EFFICACY	AMBIENT TEMP.	FLUORESCENT EQUIVALENT	IES FILES
2000 Lumens (Nominal)	STR050-2HE-4L-DRDM-UNV-1/840	2167	11.9	181.4 lm/W	-20°C / 35°C (-4°F / 95°F)	1-F32T8	*
4000 Lumens (Nominal)	STR050-4HE-4L-DRDM-UNV-1/840	4264	24.2	176.4 lm/W	-20°C / 35°C (-4°F / 95°F)	2-F32T8 1-F54T5HO	*
6000 Lumens (Nominal)	STR050-6HE-4L-DRDM-UNV-1/840	6330	36.7	172.6 lm/W	-20°C / 35°C (-4°F / 95°F)	3-F32T8	*



Los Angeles Lighting Mfg. Co.
 Contact Us
 T: 626-454-8300
 F: 626-454-8399
 www.lalighting.com

10141 Olney Street
 El Monte, CA 91731
 Made in the USA



Due to continued product improvements and enhancements, Los Angeles Lighting Manufacturing Company reserves the right to alter specifications, dimensions, data, and/or materials without notice. Please visit our website to view the most current information.

© 2022 LOS ANGELES LIGHTING MANUFACTURING CO. ALL RIGHTS RESERVED.

Revised: 01/05/2023



MADE IN THE USA
 BAA/BABA Compliant

SYSTEM DATA

ADDITIONAL LUMEN PACKAGES AVAILABLE. CONTACT CUSTOMER SERVICE FOR MORE INFORMATION

8' - LED LUMEN PACKAGE	NORMAL AMBIENT TEMPERATURE PRODUCT CODE	DELIVERED LUMENS	SYSTEM WATTS	LUMINAIRE EFFICACY	AMBIENT TEMP.	FLUORESCENT EQUIVALENT	IES FILES
4000 Lumens (Nominal)	STR050-4-8L-DRDM-UNV-1/840	4264	24.2	176.4 lm/W	-20°C / 35°C (-4°F / 95°F)	2-F32T8	*
8000 Lumens (Nominal)	STR050-8-8L-DRDM-UNV-1/840	8368	49.5	169.1 lm/W	-20°C / 35°C (-4°F / 95°F)	4-F32T8 2-F54T5HO	LA-T3841b
12000 Lumens (Nominal)	STR050-12-8L-DRDM-UNV-1/840	12355	75.8	163.1 lm/W	-20°C / 35°C (-4°F / 95°F)	6-F32T8 2-F96T8HO	*
16000 Lumens (Nominal)	STR050-16-8L-DRDM-UNV-1/840	16222	103.1	157.4 lm/W	-20°C / 35°C (-4°F / 95°F)	8-F32T8 4-F54T5HO	*
20000 Lumens (Nominal)	STR050-20-8L-DRDM-UNV-1/840	20352	122.4	166.3 lm/W	-20°C / 35°C (-4°F / 95°F)	-	*

8' - LED LUMEN PACKAGE	NORMAL AMBIENT TEMPERATURE (HIGH EFFICACY) PRODUCT CODE	DELIVERED LUMENS	SYSTEM WATTS	LUMINAIRE EFFICACY	AMBIENT TEMP.	FLUORESCENT EQUIVALENT	IES FILES
4000 Lumens (Nominal)	STR050-4HE-8L-DRDM-UNV-1/840	4333	23.9	181.4 lm/W	-20°C / 35°C (-4°F / 95°F)	2-F32T8	*
8000 Lumens (Nominal)	STR050-8HE-8L-DRDM-UNV-1/840	8109	45.8	177.0 lm/W	-20°C / 35°C (-4°F / 95°F)	4-F32T8 2-F54T5HO	*
12000 Lumens (Nominal)	STR050-12HE-8L-DRDM-UNV-1/840	12250	70.8	173.1 lm/W	-20°C / 35°C (-4°F / 95°F)	6-F32T8 2-F96T8HO	*

NOTE:

System data as of 7/1/25 (K-Boards).

Luminaire efficiency: 2ft: 99.9%, 3ft: 99.9% 4ft: 99.9% 8ft: 99.9%

Subject to change without notice.

System data is based on 120V input voltage. Actual performance may differ as a result of end-user environment and application. This fixture has been tested and listed in accordance with UL Standards. L.A. Lighting certifies that it will operate safely when installed properly, and within an ambient temperature range noted in the system data table.

Additional lumen packages and color temperatures available.



Los Angeles Lighting Mfg. Co.

Contact Us
 T: 626-454-8300
 F: 626-454-8399
 www.lalighting.com

10141 Olney Street
 El Monte, CA 91731
 Made in the USA



Due to continued product improvements and enhancements, Los Angeles Lighting Manufacturing Company reserves the right to alter specifications, dimensions, data, and/or materials without notice. Please visit our website to view the most current information.

© 2022 LOS ANGELES LIGHTING MANUFACTURING CO. ALL RIGHTS RESERVED.

Revised: 01/05/2023



MADE IN THE USA
 BAA/BABA Compliant

DRIVER OPTIONS

DRDM () () UNV

VOLTAGE

- UNV Universal 120-277V (For DR2W Driver Type) **Standard Stock Item*
- 120V 120 Volt (For DR2W Driver Type)
- 277V 277 Volt (For DR2W Driver Type)
- 347V 347 Volt
- 480V 480 Volt

SPECIFIC DRIVER

- XXX Manufacturer's Name/Part Number
- Blank Not Specified

WARRANTY

- Blank 5-Year Limited Warranty - Standard
- TY 10-Year Limited Warranty

DRIVER TYPE

- DRDM 0-10V Dimming Driver **Standard Stock Item*
- DRDM1 0-10V Dimming Driver, 1% Dimming
- DRDM2C 2-Channel 0-10V Dimming Driver (for Color Tunable White)
- DR2W 2-Wire Phase Dimming Driver (TRIAC, Mark 10) Please Specify Voltage in Voltage Field
- DRDA Digital Addressable DALI Dimming Driver
- DRDA2C Digital Addressable DALI Type 8, 2-Channel Driver (for Color Tunable White)
- DRSD Step Dimming Driver
- DR(LTEA2W) Lutron® 2-Wire, 1% Dimming Driver (120V Forward Phase only)
- DR(LDE1) Lutron® EcoSystem 1% Soft-On, Fade-to-Black
- DR(PEQ0E) Lutron® EcoSystem 0.1% Soft-On, Fade-to-Black Dimming Driver
- DR(PSQ020) Lutron® T-Series Digital 1% Dimming 2-Channel Driver (for Color Tunable White)
- DRCR(DXL) Osram Dexas Driver
- DRCR(SR) Signify Sensor Ready Driver
- DRCR(XXX) Control Ready Driver (Specify Driver Manufacturer)

BATTERY PACK OPTIONS

BPL 1.5 (2H)

LED EMERGENCY BATTERY PACKS

Minimum 90-minute operation unless otherwise noted

OTHER SPECIFICATION (Manufacturer, Run Time, etc.)

- 2H 2 Hours

LUMEN PACKAGE

- 0.7 Nominal 750 Lumens
- 1.5 Nominal 1500 Lumens **Standard Stock Item*
- 3.0 Nominal 3000 Lumens
- 4.0 Nominal 4000 Lumens
(Additional lumen packages available)

TYPE

- (Blank) Normal Ambient Temp. / Standard Operation
- C Cold Environment (-20°C)
- F Flex Cable for Remote Mounting
- SL Slim Casing
- ST Self Test / Diagnostic



Los Angeles Lighting Mfg. Co.
 Contact Us
 T: 626-454-8300 10141 Olney Street
 F: 626-454-8399 El Monte, CA 91731
 www.lalighting.com Made in the USA



Due to continued product improvements and enhancements, Los Angeles Lighting Manufacturing Company reserves the right to alter specifications, dimensions, data, and/or materials without notice. Please visit our website to view the most current information.

© 2022 LOS ANGELES LIGHTING MANUFACTURING CO. ALL RIGHTS RESERVED.

Revised: 01/05/2023



MADE IN THE USA
BAA/BABA Compliant

ELECTRICAL

PLUG-IN BRANCH WIRING CONNECTOR SYSTEM

- For wiring through fixture channel in single or multiple circuits
- Low-voltage for dimming available
- 12 gauge wire
- Quick connect plugs for easy installation
- Contact customer service for additional options

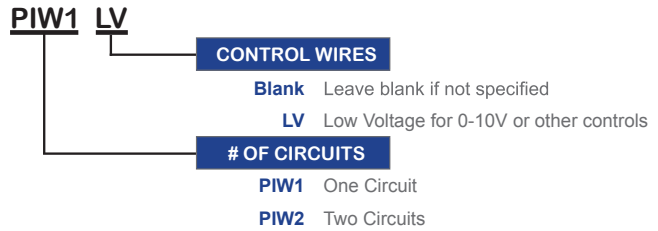

CORD & PLUG

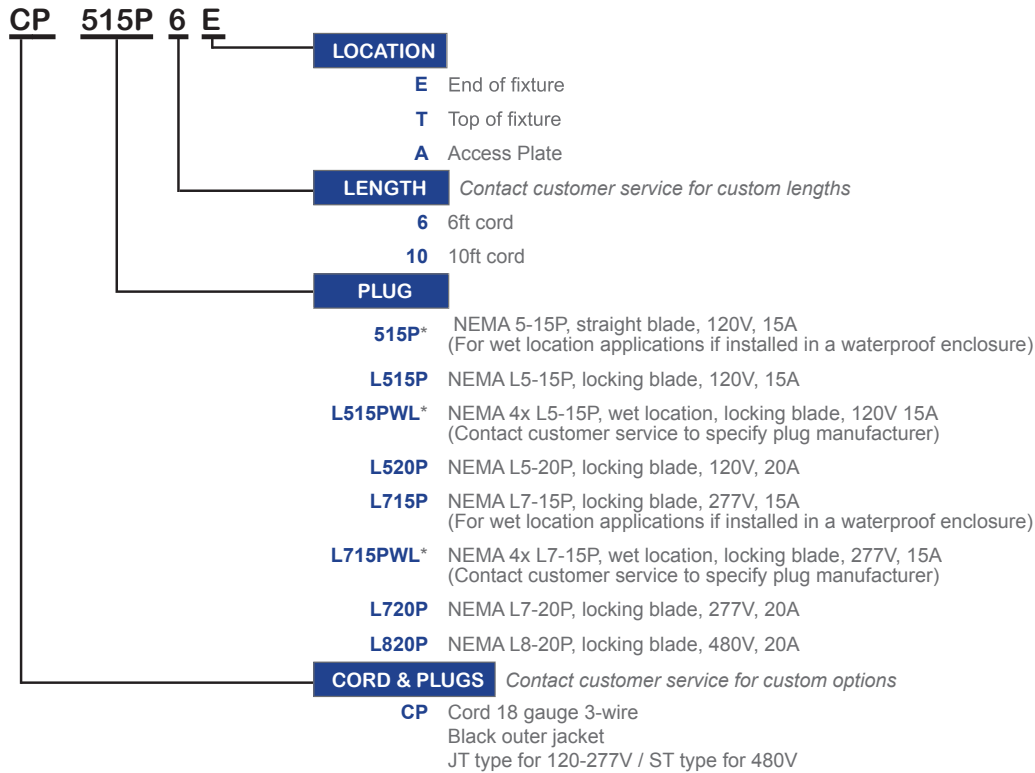

**Consult local building codes for specific wet location installation requirements*



Los Angeles Lighting Mfg. Co.
 Contact Us
 T: 626-454-8300 10141 Olney Street
 F: 626-454-8399 El Monte, CA 91731
 www.lalighting.com Made in the USA



Due to continued product improvements and enhancements, Los Angeles Lighting Manufacturing Company reserves the right to alter specifications, dimensions, data, and/or materials without notice. Please visit our website to view the most current information.

© 2022 LOS ANGELES LIGHTING MANUFACTURING CO. ALL RIGHTS RESERVED.

Revised: 01/05/2023



MADE IN THE USA
BAA/BABA Compliant