



STRIP LIGHT

LED

STW 100 (2FT)

SERIES (3' AND 4' AND 8' AVAILABLE)
2_1/4" WIDE LENSED STRIP WRAPAROUND LUMINAIRE

DATE	
JOB	

WWW.LALIGHTING.COM
626-454-8300

SURFACE / SUSPENSION MOUNTED LED LUMINAIRE

DIMENSIONS

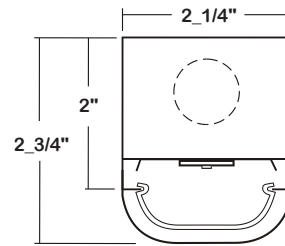

- 3/16" MTG. HOLE
- ◆ 11/16" STEM MTG. K.O.
- ⊕ 7/8" K.O.
- V-HOOK

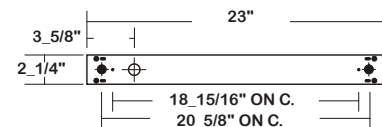

APPLICATIONS

- Retail, Warehouse, Industrial, Office, Corridor, Stairwell, Parking Structure, Assembly Line, Aisle Lighting, Commercial

FEATURES

- End plates may be used as channel couplings
- 0-10V dimming driver standard (See *DRIVER OPTIONS* for other dimming types)
- Supports California Title 24 compliance

OPTIONS

- Full customization available upon request
- Additional lumen packages and color temperatures available
- Controls and sensors available (See *SENSOR OPTIONS* for controls and sensors)
- Wireless control options available (See *SENSOR OPTIONS* for wireless controls)
- Cable suspension systems available (See *ACCESSORIES* for suspension options)
- Painted after fabrication available
- Tunable white available (2700K-6500K)

SPECIFICATIONS

CONSTRUCTION

- 22 ga. cold rolled steel housing
- End plates fastened to housing by sheet metal screws to assure rigidity

OPTICAL

- Frosted acrylic lens
- Frosted white acrylic lens

FINISH

- Baked white polyester finish / minimum reflectance 86%
- End plates - baked white powder coated finish / painted after fabrication

ELECTRICAL

- High efficiency drivers coupled with long-life LEDs
- Service life greater than 50,000 hours (L70)
- Universal voltage 120V through 277V (347V / 480V available)
- Power Factor (PF) ≥ 0.9
- Total Harmonic Distortion (THD) ≤ 20%

LISTING

- UL USA and Canada listed / suitable for damp locations

WARRANTY

- 5-year limited warranty



Los Angeles Lighting Mfg. Co.
Headquarters
10141 Olney Street
El Monte, CA 91731
Made in the USA

Contact Us
T: 626-454-8300
F: 626-454-8399
www.lalighting.com



Due to continued product improvements and enhancements, Los Angeles Lighting Manufacturing Company reserves the right to alter specifications, dimensions, data, and/or materials without notice. Please visit our website to view the most current information.

MADE IN THE U.S.A.

Revised 06-19-19

WARNING

ORDERING INFORMATION

EXAMPLE: STW100-4-2L-FRWA-DRDM-UNV-1/840

SERIES	LED LUMEN PACKAGE	EFFICACY	NOMINAL LENGTH	OPTICAL	MECHANICAL	ELECTRICAL	DRIVER	VOLTAGE	# OF LED ROW	CRI / CCT
STW100			2L				DRDM	UNV	1	
STW100 2_1/4" Wide Lensed Strip Wraparound LED Luminaire	1 Nom. 1000 Lumens 2 Nom. 2000 Lumens 3 Nom. 3000 Lumens 4 Nom. 4000 Lumens *Additional Lumen Packages Available	(Blank) Standard HE High Efficacy	2L 2'	FRA Frosted Acrylic FRWA Frosted White Acrylic	PAF Painted After Fabrication *Leave Blank if Not Specified	MSxx Motion Sensor WLC(LED RU) EnOcean Wireless Control See SENSOR OPTIONS for Options *Leave Blank if Not Specified Additional Electrical Options	DRDM 0-10V Dimming Driver See DRIVER OPTIONS for Options	UNV 120V-277V See DRIVER OPTIONS for Options	1 One LED Row	830 80+CRI / 3000K Color Temp. 835 80+CRI / 3500K Color Temp. 840 80+CRI / 4000K Color Temp. 850 80+CRI / 5000K Color Temp. *Additional Color Temp. Available

SYSTEM DATA

THESE ARE THE MOST POPULAR LUMEN PACKAGES. PLEASE CONSULT FACTORY FOR ADDITIONAL SYSTEM DATA.

LED LUMEN PACKAGE	NORMAL AMBIENT TEMPERATURE PRODUCT CODE	DELIVERED LUMENS	SYSTEM WATTS	LUMINAIRE EFFICACY	AMBIENT TEMP.	FLUORESCENT / HID EQUIVALENT	IES FILES
1000 Lumens (Nominal)	STW100-1-2L-FRWA-DRDM-UNV-1/840	820 lm	9.5 W	86.3 lm/W	-20°C / 35°C	1-F17T8	LA-T2738
2000 Lumens (Nominal)	STW100-2-2L-FRWA-DRDM-UNV-1/840	1553 lm	18.5 W	83.9 lm/W	-20°C / 35°C	2-F17T8, 1-F24T5HO	LA-T2739
3000 Lumens (Nominal)	STW100-3-2L-FRWA-DRDM-UNV-1/840	2320 lm	27.9 W	83.2 lm/W	-20°C / 35°C	3-F17T8	LA-T2740
4000 Lumens (Nominal)	STW100-4-2L-FRWA-DRDM-UNV-1/840	3075 lm	35.9 W	85.7 lm/W	-20°C / 35°C	4-F17T8, 2-F24T5HO	LA-T2814

NOTE:

System data is based on 120V input voltage. Actual performance may differ as a result of end-user environment and application.

This fixture has been tested and listed in accordance with UL Standards. L.A. Lighting certifies that it will operate safely when installed properly, and within an ambient temperature range noted in the system data table.

Additional lumen packages and color temperatures available.

PERFORMANCE DATA

[VIEW PHOTOMETRICS](#)



Los Angeles Lighting Mfg. Co.
 Headquarters
 10141 Olney Street
 El Monte, CA 91731
 Made in the USA

Contact Us
 T: 626-454-8300
 F: 626-454-8399
 www.lalighting.com



Due to continued product improvements and enhancements, Los Angeles Lighting Manufacturing Company reserves the right to alter specifications, dimensions, data, and/or materials without notice. Please visit our website to view the most current information.

MADE IN THE U.S.A.

Revised 06-19-19

WARNING

SENSOR OPTIONS**DRY AND DAMP LOCATIONS - HIGH / LOW AISLE MOUNTING APPLICATIONS - END MOUNT****MS - Motion Sensor**

- Turns light ON/OFF based on motion detection
- Fixture mounting height 8-45'
- Universal Voltage (120V-277V)
- 480V available

MSSD - Motion Sensor – Step Dimming

- Step-dims light to desired preset level (based on motion detection)
- Used in conjunction with 0-10V Ballast/Driver
- Fixture mounting height 8-45'
- Universal Voltage (120V-277V)

MSPC - Motion Sensor & Photocell

- Holds lights OFF when sufficient daylight is present regardless of motion detection
- Fixture mounting height 8-45'
- Universal Voltage (120V-277V)

MSPCD(ADC) - Motion Sensor & PhotoCell Dimming (Auto Dim Control)

- Variably dims output to desired preset footcandle level through photocell ON/OFF with motion detection
- Used in conjunction with 0-10V Ballast/Driver
- Fixture mounting height 8-45'
- Universal Voltage (120V-277V)

MSPCD(ANL) - Motion Sensor & Photocell Dimming (Auto Night Light)

- Variably dims output to desired footcandles through photocell
- Low setting when unoccupied (full on with motion)
- For 24 hour use
- Used in conjunction with 0-10V Ballast/Driver
- Fixture mounting height 8-45'
- Universal Voltage (120V-277V)

MSPCDR - Motion Sensor & Photocell Dimming (Setup with Remote Control)

- Field adjustable dimming sensor capabilities:
 - Step Dim (HIGH/LOW output)
 - Auto Dim Control (dim to desired footcandles, ON/OFF with motion)
 - Auto Night Light (dim to desired footcandles, LOW without motion)
- Used in conjunction with 0-10V dimming Ballast /Driver
- Holds lights OFF when sufficient daylight is present regardless of motion detection
- Adjustable ramp up and fade down time
- Fixture mounting height 8-40'
- Universal Voltage (120V-277V)
- Remote setup and adjustment with handheld wireless tool (sold separately)

PCS - Photocell Sensor

- Turns light ON/OFF based on light levels
- Fixture mounting height 8-45'
- Universal Voltage (120V-277V)

PCD - Photocell Dimming

- Dims output to desired footcandles through photocell
- Used in conjunction with 0-10V Ballast/Driver
- Fixture mounting height 8-45'
- Universal Voltage (120V-277V)

**CONTROLS AND SENSORS****WLC(LED RU) - EnOcean® LED Relay Zone Controller**

- Supports a single LED fixture or multiple daisy chained LED fixtures
- Module installed inside lighting fixture

ESRPU-W-EO - EnOcean® Rocker Switch – Single – Surface Mount

- Wireless single rocker switch with mounting plate
- No batteries needed

EDRPU-W-EO - EnOcean® Rocker Switch – Double – Surface Mount

- Wireless double rocker switch with mounting plate
- No batteries needed

S3054-N300 - EnOcean® Navigan NWC 300U – Commissioning Tool

- Navigan Wireless Commissioner is used to configure EnOcean controllers & sensors
- It can be used to define link tables, change parameters/settings, and to edit & store projects
- Configuration settings can be saved and cloned to enable quick configuration
- Connectivity is through the NWC 300U USB Stick

EOSWU-W-EO - EnOcean® Occupancy Sensor – Wall Mount

- Wireless wall mounted occupancy sensor
- Solar powered - no batteries needed (coin battery operated in low light conditions)
- PIR motion sensor with both wide angle (50') and long range (100') options
- Mounting height: 6-8 feet

EOSCU-W-EO - EnOcean® Occupancy Sensor – Ceiling Mount

- Wireless ceiling mounted occupancy sensor
- Solar powered - no batteries needed (coin battery operated in low light conditions)
- PIR motion sensor with 360 degree viewing angle lens (34' diameter)
- Mounting height: 7-10 feet

ELLSU-W-EO - EnOcean® Light Level Sensor – Ceiling Mount

- Light Level sensor that measures and reports the level of available natural light
- Solar powered - no batteries needed (coin battery operated in low light conditions)
- Enables implementation of daylight harvesting control systems
- Mounting position: At the ceiling, close to ambient light source

**Los Angeles Lighting Mfg. Co.**

Headquarters
10141 Olney Street
El Monte, CA 91731
Made in the USA

Contact Us
T: 626-454-8300
F: 626-454-8399
www.lalighting.com



Due to continued product improvements and enhancements, Los Angeles Lighting Manufacturing Company reserves the right to alter specifications, dimensions, data, and/or materials without notice. Please visit our website to view the most current information.

MADE IN THE U.S.A.

Revised 06-19-19

WARNING

DRIVER OPTIONS

PLEASE CONSULT FACTORY TO SEE IF YOUR SELECTED DRIVER OPTION WORKS WITH THIS FIXTURE.

DRDM - UNV

* Normal Stock Item

VOLTAGE

- 120V 120 Volt
- 277V 277 Volt
- UNV* Universal 120-277 Volt
- 347V 347 Volt
- 480V 480 Volt

DRIVER TYPE

- DRDM* 0-10V Dimming Driver
- DRDM1 0-10V Dimming Driver, 1% Dimming
- DRDM2C 2-Channel 0-10V Dimming Driver (for Color Tunable White)
- DR2W 2-Wire Phase Dimming Driver
- DRDA Digital Addressable DALI Dimming Driver
- DRDA2C Digital Addressable DALI Type8 2-Channel Driver (for Color Tunable White)
- DRDA2.0 Digital Addressable DALI 2.0 Dimming Driver
- DRDA2.02C Digital Addressable DALI 2.0 Type8 2-Channel Driver (for Color Tunable White)
- DRSD Step Dimming Driver
- DR(LTEA2W) Lutron® 2-Wire 1% Dimming Driver (120V Forward Phase only)
- DR(LDE1) Lutron® EcoSystem 1% Soft-On, Fade-to-Black™ Dimming Driver
- DR(LDE5) Lutron® EcoSystem 5% Dimming Driver
- DR(PEQ0) Lutron® EcoSystem 0.1% Soft-On, Fade-to-Black Dimming Driver
- DR(PSQ0) Lutron® T-Series Digital 1% Dimming 2-Channel Driver (for Color Tunable White)

OF DRIVERS SPECIFIED

- (Blank) Not Specified
- # Number of Drivers Specified per Lighting Fixture

ACCESSORIES

V4

- 4" Leg Height V-Hook
- Two (2) per fixture

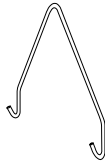

YTCS10

- Y-Toggle-End / Cable Suspension System

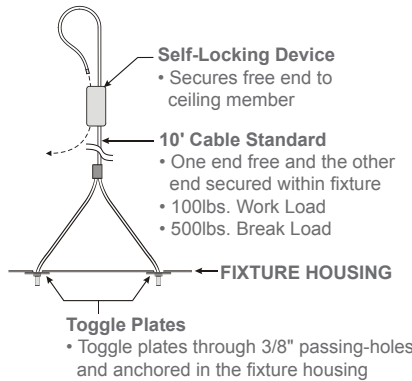

V4CS10

- V-Hook / Cable Suspension System
- Cable set with V4 hooks

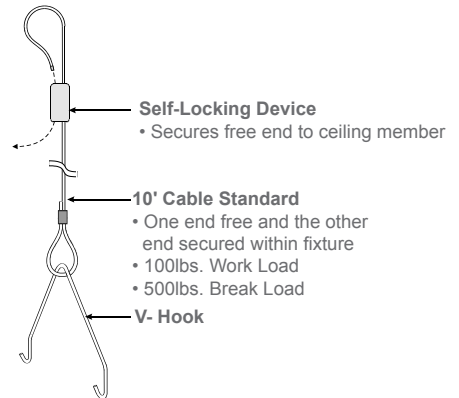

Los Angeles Lighting Mfg. Co.
 Headquarters
 10141 Olney Street
 El Monte, CA 91731
 Made in the USA

Contact Us
 T: 626-454-8300
 F: 626-454-8399
 www.lalighting.com



Due to continued product improvements and enhancements, Los Angeles Lighting Manufacturing Company reserves the right to alter specifications, dimensions, data, and/or materials without notice. Please visit our website to view the most current information.

MADE IN THE U.S.A.

Revised 06-19-19

WARNING

PHOTOMETRIC DATA - STW100 SERIES

STW100-1-2L-1DRDM(ULT)-UNV-1/840(SAM)

TEST NO.=LA-T2738
 LED TYPE= 24 LED MODULE
 NO. OF MODULE=1
 SYSTEM WATT (W)=9.5
 CRI ≥ 80
 L70(Hrs.) ≥ 100,000
 PHOTOMETRY TYPE=C

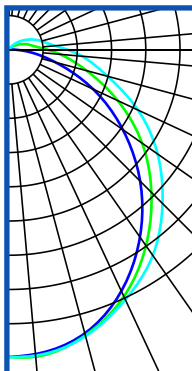
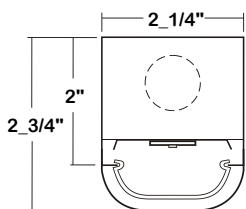

CANDLEPOWER			
ANGLE	END	45	CROSS
0	248	248	248
5	246	249	248
15	237	238	239
25	215	220	222
35	184	193	203
45	150	163	175
55	112	131	147
65	75	97	115
75	39	65	82
85	15	42	59
90	6	31	48
95	3	24	37
105	1	16	27
115	0	11	20
125	0	6	13
135	0	3	7
145	0	0	2
155	0	0	0
165	0	0	0
175	0	0	0
180	0	0	0

ZONAL LUMEN SUMMARY			
DEGREES	LUMENS	% LAMP	% FIXTURE
0-30	193	17.9	23.5
0-40	314	29.2	38.3
0-60	557	51.7	67.9
0-90	759	70.5	92.5
90-120	53	4.9	6.4
90-150	61	5.7	7.5
90-180	61	5.7	7.5
0-180	820	76.1	100.0

Luminaire Output= 820 lumens
 Luminaire Efficacy= 86.3 LPW

SPACING CRITERION	
ALONG	ACROSS
1.19	1.27

STW100-2-2L-1DRDM(ULT)-UNV-1/840(SAM)

TEST NO.=LA-T2739
 LED TYPE= 32 LED MODULE
 NO. OF MODULE=1
 SYSTEM WATT (W)=18.5
 CRI ≥ 80
 L70(Hrs.) ≥ 100,000
 PHOTOMETRY TYPE=C

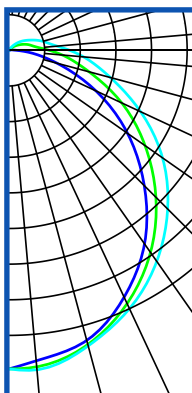
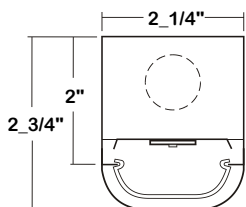

CANDLEPOWER			
ANGLE	END	45	CROSS
0	473	473	473
5	462	472	476
15	446	452	454
25	404	415	423
35	351	366	382
45	284	308	333
55	215	247	278
65	142	185	216
75	74	123	156
85	27	80	111
90	11	60	90
95	6	45	72
105	3	31	52
115	1	21	36
125	0	12	24
135	0	5	13
145	0	1	5
155	0	0	0
165	0	0	0
175	0	0	0
180	0	0	0

ZONAL LUMEN SUMMARY			
DEGREES	LUMENS	% LAMP	% FIXTURE
0-30	364	17.9	23.5
0-40	595	29.1	38.3
0-60	1055	51.7	67.9
0-90	1437	70.4	92.5
90-120	100	4.9	6.4
90-150	116	5.7	7.5
90-180	116	5.7	7.5
0-180	1553	76.1	100.0

Luminaire Output= 1553 lumens
 Luminaire Efficacy = 83.9 LPW

SPACING CRITERION	
ALONG	ACROSS
1.23	1.26

STW100-3-2L-1DRDM(ULT)-UNV-1/840(SAM)

TEST NO.=LA-T2740
 LED TYPE= 48 LED MODULE
 NO. OF MODULE=1
 SYSTEM WATT (W)=27.9
 CRI ≥ 80
 L70(Hrs.) ≥ 100,000
 PHOTOMETRY TYPE=C

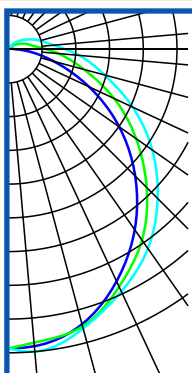
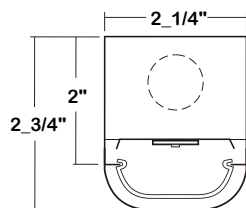

CANDLEPOWER			
ANGLE	END	45	CROSS
0	705	705	705
5	703	695	716
15	671	677	682
25	604	618	630
35	520	550	574
45	423	461	498
55	319	368	414
65	210	275	323
75	111	184	235
85	41	119	168
90	16	89	134
95	9	67	108
105	4	47	77
115	1	30	54
125	0	17	36
135	0	7	20
145	0	1	7
155	0	0	0
165	0	0	0
175	0	0	0
180	0	0	0

ZONAL LUMEN SUMMARY			
DEGREES	LUMENS	% LAMP	% FIXTURE
0-30	545	17.9	23.5
0-40	889	29.2	38.3
0-60	1576	51.7	67.9
0-90	2148	70.4	92.5
90-120	149	4.9	6.4
90-150	173	5.7	7.5
90-180	173	5.7	7.5
0-180	2320	76.1	100.0

Luminaire Output= 2320 lumens
 Luminaire Efficacy = 83.2 LPW

SPACING CRITERION	
ALONG	ACROSS
1.18	1.27

STW100-4-2L-1DRDM(ULT)-UNV-1/840(SAM)

TEST NO.=LA-T2814
 LED TYPE= 72 LED MODULE
 NO. OF MODULE=1
 SYSTEM WATT (W)=35.9
 CRI ≥ 80
 L70(Hrs.) ≥ 100,000
 PHOTOMETRY TYPE=C

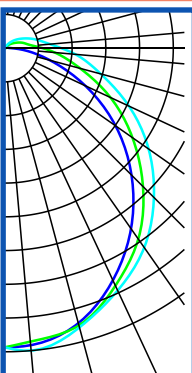
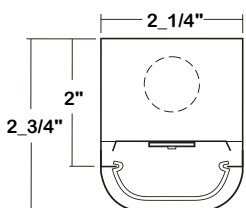

CANDLEPOWER			
ANGLE	END	45	CROSS
0	936	936	936
5	926	929	934
15	893	895	889
25	802	820	832
35	695	728	753
45	561	612	660
55	424	489	547
65	280	364	429
75	147	244	313
85	55	157	222
90	22	119	177
95	12	89	143
115	1	40	72
125	0	23	48
135	0	10	27
145	0	2	9
155	0	0	0
165	0	0	0
175	0	0	0
180	0	0	0

ZONAL LUMEN SUMMARY			
DEGREES	LUMENS	% LAMP	% FIXTURE
0-30	721	17.7	23.4
0-40	1176	29.0	38.2
0-60	2087	51.4	67.8
0-90	2845	70.1	92.5
90-120	198	4.8	6.4
90-150	230	5.6	7.4
90-180	230	5.6	7.4
0-180	3075	75.8	100.0

Luminaire Output= 3075 lumens
 Luminaire Efficacy = 85.7 LPW

SPACING CRITERION	
ALONG	ACROSS
1.19	1.26

