



# STRIP LIGHT

LED

## STW 100 (4FT) SERIES (2' AND 3' AND 8' AVAILABLE)

2\_1/4" WIDE LENSED STRIP WRAPAROUND LUMINAIRE

DATE	
JOB	

WWW.LALIGHTING.COM  
626-454-8300

### SURFACE / SUSPENSION MOUNTED LED LUMINAIRE

### DIMENSIONS



\*FRWA Lens Shown

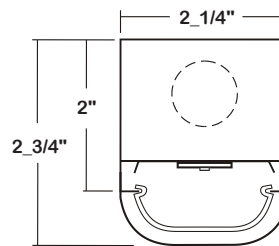

- 3/16" MTG. HOLE
- 11/16" STEM MTG. K.O.
- 7/8" K.O.
- V-HOOK

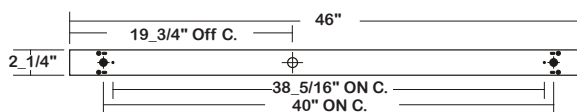

### APPLICATIONS

- Retail, Warehouse, Industrial, Office, Corridor, Stairwell, Parking Structure, Assembly Line, Aisle Lighting, Commercial

### FEATURES

- End plates may be used as channel couplings
- 0-10V dimming driver standard (See *DRIVER OPTIONS* for other dimming types)
- Supports California Title 24 compliance

### OPTIONS

- Full customization available upon request
- Additional lumen packages and color temperatures available
- Controls and sensors available (See *SENSOR OPTIONS* for controls and sensors)
- Wireless control options available (See *SENSOR OPTIONS* for wireless controls)
- Emergency battery pack available (See *BATTERY PACK OPTIONS* for battery pack options)
- Cable suspension systems available (See *ACCESSORIES* for suspension options)
- Chain mount coupling available (See *ACCESSORIES* for details)
- Painted after fabrication available
- Tunable white available (2700K-6500K)

### SPECIFICATIONS

#### CONSTRUCTION

- 22 ga. cold rolled steel housing
- End plates fastened to housing by sheet metal screws to assure rigidity

#### OPTICAL

- Frosted acrylic lens
- Frosted white acrylic lens

#### FINISH

- Baked white polyester finish / minimum reflectance 86%
- End plates - baked white powder coated finish / painted after fabrication

#### ELECTRICAL

- High efficiency drivers coupled with long-life LEDs
- Service life tested at 215,000 hours (L70), 60,000 hours (L90)
- Universal voltage 120V through 277V (347V / 480V available)
- Power Factor (PF) ≥ 0.9
- Total Harmonic Distortion (THD) ≤ 20%

#### LISTING

- UL USA and Canada listed / suitable for damp locations

#### WARRANTY

- 5-year limited warranty



**Los Angeles Lighting Mfg. Co.**  
 Headquarters  
 10141 Olney Street  
 El Monte, CA 91731  
 Made in the USA

Contact Us  
 T: 626-454-8300  
 F: 626-454-8399  
 www.lalighting.com



Due to continued product improvements and enhancements, Los Angeles Lighting Manufacturing Company reserves the right to alter specifications, dimensions, data, and/or materials without notice. Please visit our website to view the most current information.

**MADE IN THE U.S.A.**

Revised 04-24-19

**WARNING**

ORDERING INFORMATION

EXAMPLE: STW100-6-4L-FRWA-DRDM-UNV-1/840

SERIES	LED LUMEN PACKAGE	EFFICACY	NOMINAL LENGTH	OPTICAL	MECHANICAL	ELECTRICAL	DRIVER	VOLTAGE	# OF LED ROW	CRI / CCT
STW100			4L				DRDM	UNV	1	
STW100 2_1/4" Wide Lensed Strip Wraparound LED Luminaire	2 Nom. 2000 Lumens 4 Nom. 4000 Lumens 5 Nom. 5000 Lumens 6 Nom. 6000 Lumens 8 Nom. 8000 Lumens  *Additional Lumen Packages Available	(Blank) Standard  HE High Efficacy (Only 2000 /4000 /5000 / 6000 lumens Systems)	4L 4'	FRA Frosted Acrylic  FRWA Frosted White Acrylic	PAF Painted After Fabrication  *Leave Blank if Not Specified	BPLSL1.5 Emergency Battery Pack, Slim Casing, Nom. 1500 lm  See BATTERY PACK OPTIONS for Options  MSxx Motion Sensor  WLC(LED RU) EnOcean Wireless Control  See SENSOR OPTIONS for Options  *Leave Blank if Not Specified  Additional Electrical Options	DRDM 0-10V Dimming Driver  See DRIVER OPTIONS for Options	UNV 120V-277V  See DRIVER OPTIONS for Options	1 One LED Row	830 80+CRI / 3000K Color Temp.  835 80+CRI / 3500K Color Temp.  840 80+CRI / 4000K Color Temp.  850 80+CRI / 5000K Color Temp.  *Additional Color Temp. Available

SYSTEM DATA

THESE ARE THE MOST POPULAR LUMEN PACKAGES. PLEASE CONSULT FACTORY FOR ADDITIONAL SYSTEM DATA.

LED LUMEN PACKAGE	NORMAL AMBIENT TEMPERATURE PRODUCT CODE	DELIVERED LUMENS	SYSTEM WATTS	LUMINAIRE EFFICACY	AMBIENT TEMP.	FLUORESCENT / HID EQUIVALENT	IES FILES
2000 Lumens (Nominal)	STW100-2-4L-FRWA-DRDM-UNV-1/835	1424 lm	17.2 W	82.9 lm/W	-20°C / 35°C	1-F32T8	<a href="#">LA-T2803</a>
	STW100-2-4L-FRWA-DRDM-UNV-1/840	1976 lm	16 W	123.5 lm/W			<a href="#">LA-T2733</a>
	STW100-2-4L-FRWA-DRDM-UNV-1/850	1633 lm	17.4 W	94.0 lm/W			<a href="#">LA-T2805</a>
4000 Lumens (Nominal)	STW100-4-4L-FRWA-DRDM-UNV-1/830	3223 lm	33.3 W	96.8 lm/W	-20°C / 35°C	2-F32T8, 1-F54T5HO	*
	STW100-4-4L-FRWA-DRDM-UNV-1/835	2866 lm	34.6 W	83.0 lm/W			<a href="#">LA-T2806</a>
	STW100-4-4L-FRWA-DRDM-UNV-1/840	3004 lm	34.2 W	87.8 lm/W			<a href="#">LA-T2807</a>
	STW100-4-4L-FRWA-DRDM-UNV-1/850	3293 lm	35.4 W	93.1 lm/W			<a href="#">LA-T2808</a>
6000 Lumens (Nominal)	STW100-6-4L-FRWA-DRDM-UNV-1/840	4648 lm	52.5 W	88.5 lm/W	-20°C / 35°C	3-F32T8	<a href="#">LA-T2680</a>
8000 Lumens (Nominal)	STW100-8-4L-FRWA-DRDM-UNV-1/835	6020 lm	66.4 W	90.7 lm/W	-20°C / 35°C	4-F32T8, 2-F54T5HO, 175 W (MH)	<a href="#">LA-T2850</a>
	STW100-8-4L-FRWA-DRDM-UNV-1/840	6213 lm	66.4 W	93.6 lm/W			<a href="#">LA-T2815</a>

LED LUMEN PACKAGE	NORMAL AMBIENT TEMPERATURE (HIGH EFFICACY) PRODUCT CODE	DELIVERED LUMENS	SYSTEM WATTS	LUMINAIRE EFFICACY	AMBIENT TEMP.	FLUORESCENT EQUIVALENT	IES FILES
2000 Lumens (Nominal)	STW100-2HE-4L-FRWA-DRDM-UNV-1/835 **	1774 lm	14.0 W	126.5 lm/W	-20°C / 35°C	1-F32T8	*
	STW100-2HE-4L-FRWA-DRDM-UNV-1/840 **	1853 lm	14.1 W	131.9 lm/W			*
4000 Lumens (Nominal)	STW100-4HE-4L-FRWA-DRDM-UNV-1/835 **	3501 lm	26.5 W	132.2 lm/W	-20°C / 35°C	2-F32T8, 1-F54T5HO	*
	STW100-4HE-4L-FRWA-DRDM-UNV-1/840 **	3620 lm	26.3 W	137.7 lm/W			*
5000 Lumens (Nominal)	STW100-5HE-4L-FRWA-DRDM-UNV-1/840	4199lm	32.7 W	128.4 lm/W	-20°C / 35°C	2-F32T8	<a href="#">LA-T3077</a>
6000 Lumens (Nominal)	STW100-6HE-4L-FRA-DRDM-UNV-1/840	5414 lm	39.5 W	137.0 lm/W	-20°C / 35°C	3-F32T8	*
	STW100-6HE-4L-FRWA-DRDM-UNV-1/840	5010 lm	39.5 W	126.7 lm/W			*

NOTE: System data is based on 120V input voltage. DLC system data\*\* based on DLC testing parameters. Actual performance may differ as a result of end-user environment and application.

This fixture has been tested and listed in accordance with UL Standards. L.A. Lighting certifies that it will operate safely when installed properly, and within an ambient temperature range noted in the system data table.

Additional lumen packages and color temperatures available.

Due to constant updates on this product, please visit the [DLC QPL Website](#) for the most accurate system data and information.



PERFORMANCE DATA

VIEW LIGHTING FACTS

VIEW PHOTOMETRICS



**Los Angeles Lighting Mfg. Co.**  
 Headquarters  
 10141 Olney Street  
 El Monte, CA 91731  
 Made in the USA  
 Contact Us  
 T: 626-454-8300  
 F: 626-454-8399  
 www.lalighting.com



Due to continued product improvements and enhancements, Los Angeles Lighting Manufacturing Company reserves the right to alter specifications, dimensions, data, and/or materials without notice. Please visit our website to view the most current information.

MADE IN THE U.S.A.

Revised 04-24-19

**WARNING**

**SENSOR OPTIONS****DRY AND DAMP LOCATIONS - HIGH / LOW AISLE MOUNTING APPLICATIONS - END MOUNT****MS - Motion Sensor**

- Turns light ON/OFF based on motion detection
- Fixture mounting height 8-45'
- Universal Voltage (120V-277V)
- 480V available

**MSSD - Motion Sensor – Step Dimming**

- Step-dims light to desired preset level (based on motion detection)
- Used in conjunction with 0-10V Ballast/Driver
- Fixture mounting height 8-45'
- Universal Voltage (120V-277V)

**MSPC - Motion Sensor & Photocell**

- Holds lights OFF when sufficient daylight is present regardless of motion detection
- Fixture mounting height 8-45'
- Universal Voltage (120V-277V)

**MSPCD(ADC) - Motion Sensor & PhotoCell Dimming (Auto Dim Control)**

- Variably dims output to desired preset footcandle level through photocell ON/OFF with motion detection
- Used in conjunction with 0-10V Ballast/Driver
- Fixture mounting height 8-45'
- Universal Voltage (120V-277V)

**MSPCD(ANL) - Motion Sensor & Photocell Dimming (Auto Night Light)**

- Variably dims output to desired footcandles through photocell
- Low setting when unoccupied (full on with motion)
- For 24 hour use
- Used in conjunction with 0-10V Ballast/Driver
- Fixture mounting height 8-45'
- Universal Voltage (120V-277V)

**MSPCDR - Motion Sensor & Photocell Dimming (Setup with Remote Control)**

- Field adjustable dimming sensor capabilities:
  - Step Dim (HIGH/LOW output)
  - Auto Dim Control (dim to desired footcandles, ON/OFF with motion)
  - Auto Night Light (dim to desired footcandles, LOW without motion)
- Used in conjunction with 0-10V dimming Ballast /Driver
- Holds lights OFF when sufficient daylight is present regardless of motion detection
- Adjustable ramp up and fade down time
- Fixture mounting height 8-40'
- Universal Voltage (120V-277V)
- Remote setup and adjustment with handheld wireless tool (sold separately)

**PCS - Photocell Sensor**

- Turns light ON/OFF based on light levels
- Fixture mounting height 8-45'
- Universal Voltage (120V-277V)

**PCD - Photocell Dimming**

- Dims output to desired footcandles through photocell
- Used in conjunction with 0-10V Ballast/Driver
- Fixture mounting height 8-45'
- Universal Voltage (120V-277V)

**CONTROLS AND SENSORS****WLC(LED RU) - EnOcean® LED Relay Zone Controller**

- Supports a single LED fixture or multiple daisy chained LED fixtures
- Module installed inside lighting fixture

**ESRPU-W-EO - EnOcean® Rocker Switch – Single – Surface Mount**

- Wireless single rocker switch with mounting plate
- No batteries needed

**EDRPU-W-EO - EnOcean® Rocker Switch – Double – Surface Mount**

- Wireless double rocker switch with mounting plate
- No batteries needed

**S3054-N300 - EnOcean® Navigan NWC 300U – Commissioning Tool**

- Navigan Wireless Commissioner is used to configure EnOcean controllers & sensors
- It can be used to define link tables, change parameters/settings, and to edit & store projects
- Configuration settings can be saved and cloned to enable quick configuration
- Connectivity is through the NWC 300U USB Stick

**EOSWU-W-EO - EnOcean® Occupancy Sensor – Wall Mount**

- Wireless wall mounted occupancy sensor
- Solar powered - no batteries needed (coin battery operated in low light conditions)
- PIR motion sensor with both wide angle (50') and long range (100') options
- Mounting height: 6-8 feet

**EOSCU-W-EO - EnOcean® Occupancy Sensor – Ceiling Mount**

- Wireless ceiling mounted occupancy sensor
- Solar powered - no batteries needed (coin battery operated in low light conditions)
- PIR motion sensor with 360 degree viewing angle lens (34' diameter)
- Mounting height: 7-10 feet

**ELLSU-W-EO - EnOcean® Light Level Sensor – Ceiling Mount**

- Light Level sensor that measures and reports the level of available natural light
- Solar powered - no batteries needed (coin battery operated in low light conditions)
- Enables implementation of daylight harvesting control systems
- Mounting position: At the ceiling, close to ambient light source

**Los Angeles Lighting Mfg. Co.**

Headquarters  
10141 Olney Street  
El Monte, CA 91731  
Made in the USA

Contact Us  
T: 626-454-8300  
F: 626-454-8399  
www.lalighting.com



Due to continued product improvements and enhancements, Los Angeles Lighting Manufacturing Company reserves the right to alter specifications, dimensions, data, and/or materials without notice. Please visit our website to view the most current information.

**MADE IN THE U.S.A.**

Revised 04-24-19

**WARNING**

**DRIVER OPTIONS**

PLEASE CONSULT FACTORY TO SEE IF YOUR SELECTED DRIVER OPTION WORKS WITH THIS FIXTURE.

**DRDM - UNV**

\* Normal Stock Item

**VOLTAGE**

- 120V 120 Volt
- 277V 277 Volt
- UNV\* Universal 120-277 Volt
- 347V 347 Volt
- 480V 480 Volt

**DRIVER TYPE**

- DRDM\* 0-10V Dimming Driver
- DRDM1 0-10V Dimming Driver, 1% Dimming
- DRDM2C 2-Channel 0-10V Dimming Driver (for Color Tunable White)
- DR2W 2-Wire Phase Dimming Driver
- DRDA Digital Addressable DALI Dimming Driver
- DRDA2C Digital Addressable DALI Type8 2-Channel Driver (for Color Tunable White)
- DRDA2.0 Digital Addressable DALI 2.0 Dimming Driver
- DRDA2.02C Digital Addressable DALI 2.0 Type8 2-Channel Driver (for Color Tunable White)
- DRSD Step Dimming Driver
- DR(LTEA2W) Lutron® 2-Wire 1% Dimming Driver (120V Forward Phase only)
- DR(LDE1) Lutron® EcoSystem 1% Soft-On, Fade-to-Black™ Dimming Driver
- DR(LDE5) Lutron® EcoSystem 5% Dimming Driver
- DR(PEQ0) Lutron® EcoSystem 0.1% Soft-On, Fade-to-Black Dimming Driver
- DR(PSQ0) Lutron® T-Series Digital 1% Dimming 2-Channel Driver (for Color Tunable White)

**# OF DRIVERS SPECIFIED**

- (Blank) Not Specified
- # Number of Drivers Specified per Lighting Fixture

**BATTERY PACK OPTIONS**

PLEASE CONSULT FACTORY TO SEE IF YOUR SELECTED BATTERY PACK OPTION WORKS WITH THIS FIXTURE.

**BPL**

**LUMEN PACKAGE**

- 0.7 Nominal 750 Lumens
- 1.5 Nominal 1500 Lumens
- 3.0 Nominal 3000 Lumens

\*Additional lumen packages available

**TYPE**

- (Blank) Normal Ambient Temp. / Standard Operation
- C Cold Environment (-20°C)
- F With Flex for Remote Mounting
- SL Slim Casing
- ST Self Test / Diagnostic

\*Additional options available

**ACCESSORIES**

**V4**

- 4" Leg Height V-Hook
- Two (2) per fixture

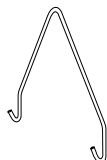

**CMC-STW100**

- Chain mount coupling with Lift-Up tabs for installation of V-Hooks when chain mounted
- Baked white enamel finish



**YTCS10**

- Y-Toggle-End / Cable Suspension System

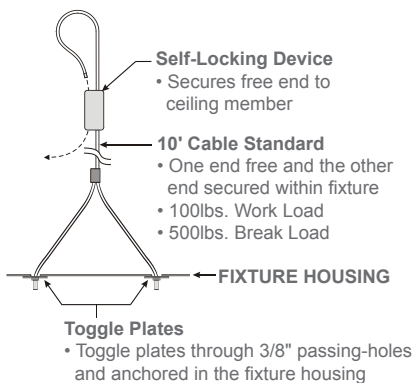

**V4CS10**

- V-Hook / Cable Suspension System
- Cable set with V4 hooks

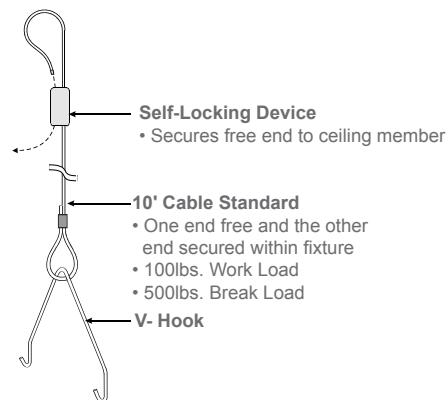

**Los Angeles Lighting Mfg. Co.**  
 Headquarters  
 10141 Olney Street  
 El Monte, CA 91731  
 Made in the USA

Contact Us  
 T: 626-454-8300  
 F: 626-454-8399  
 www.lalighting.com



Due to continued product improvements and enhancements, Los Angeles Lighting Manufacturing Company reserves the right to alter specifications, dimensions, data, and/or materials without notice. Please visit our website to view the most current information.

**MADE IN THE U.S.A.**

Revised 04-24-19

**WARNING**



## LED lighting facts

### STW100-2HE-4L-FRWA-1DRDM-UNV-1/835

- 2000 Lumen System
- L70 performance at 215,000 hours
- L90 performance at 60,000 hours

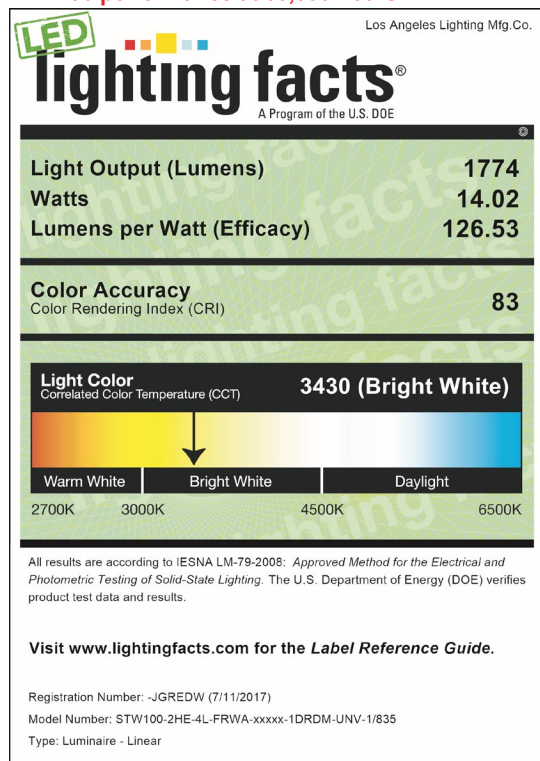

### STW100-2HE-4L-FRWA-1DRDM-UNV-1/840

- 2000 Lumen System
- L70 performance at 215,000 hours
- L90 performance at 60,000 hours

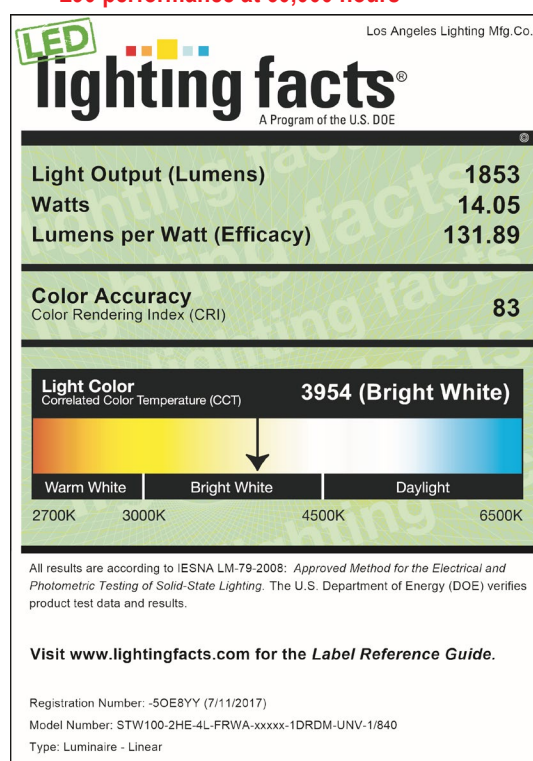

### STW100-4HE-4L-FRWA-1DRDM-UNV-1/835

- 4000 Lumen System
- L70 performance at 215,000 hours
- L90 performance at 60,000 hours

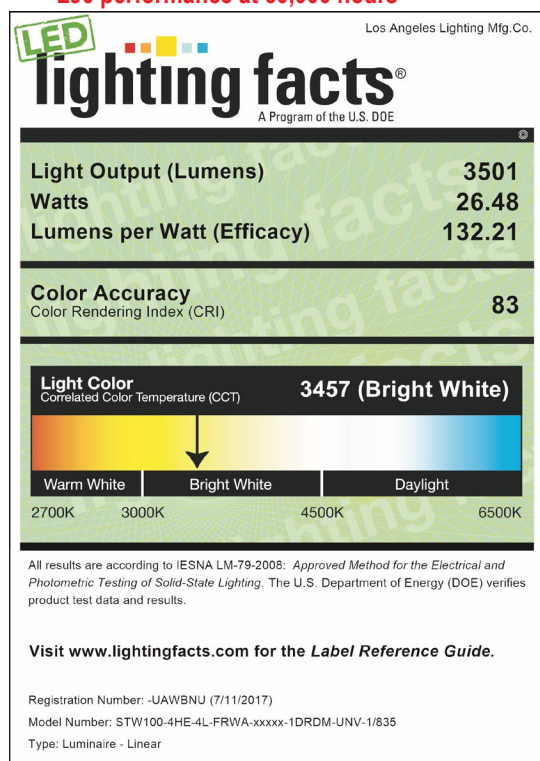

### STW100-4HE-4L-FRWA-1DRDM-UNV-1/840

- 4000 Lumen System
- L70 performance at 215,000 hours
- L90 performance at 60,000 hours

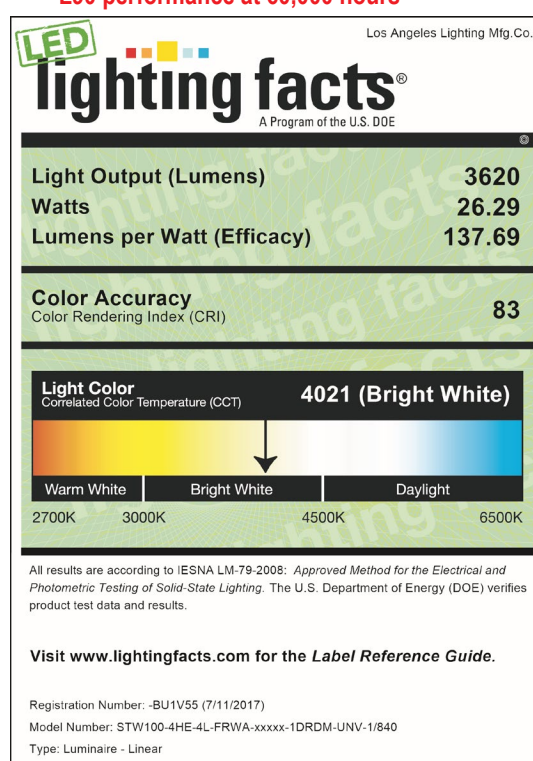

## LED lighting facts

### STW100-4HE-4L-FRWA-1DRSDM-UNV-1/835

- 4000 Lumen System
- L70 performance at 215,000 hours
- L90 performance at 60,000 hours



LED lighting facts<sup>®</sup>  
A Program of the U.S. DOE  
Los Angeles Lighting Mfg. Co.

Light Output (Lumens)	3501
Watts	26.48
Lumens per Watt (Efficacy)	132.21

Color Accuracy Color Rendering Index (CRI)	83
---	----

Light Color  
Correlated Color Temperature (CCT) **3457 (Bright White)**

2700K   3000K   4500K   6500K

Warm White   Bright White   Daylight

All results are according to IESNA LM-79-2008: *Approved Method for the Electrical and Photometric Testing of Solid-State Lighting*. The U.S. Department of Energy (DOE) verifies product test data and results.

Visit [www.lightingfacts.com](http://www.lightingfacts.com) for the *Label Reference Guide*.

Registration Number: -PHI5PB (7/11/2017)  
Model Number: STW100-4HE-4L-FRWA-xxxx-1DRSDM-UNV-1/835  
Type: Luminaire - Linear

### STW100-4HE-4L-FRWA-1DRSDM-UNV-1/840

- 4000 Lumen System
- L70 performance at 215,000 hours
- L90 performance at 60,000 hours



LED lighting facts<sup>®</sup>  
A Program of the U.S. DOE  
Los Angeles Lighting Mfg. Co.

Light Output (Lumens)	3620
Watts	26.29
Lumens per Watt (Efficacy)	137.69

Color Accuracy Color Rendering Index (CRI)	83
---	----

Light Color  
Correlated Color Temperature (CCT) **4021 (Bright White)**

2700K   3000K   4500K   6500K

Warm White   Bright White   Daylight

All results are according to IESNA LM-79-2008: *Approved Method for the Electrical and Photometric Testing of Solid-State Lighting*. The U.S. Department of Energy (DOE) verifies product test data and results.

Visit [www.lightingfacts.com](http://www.lightingfacts.com) for the *Label Reference Guide*.

Registration Number: -DJWQZ (7/11/2017)  
Model Number: STW100-4HE-4L-FRWA-xxxx-1DRSDM-UNV-1/840  
Type: Luminaire - Linear



**LOS ANGELES LIGHTING MFG. CO.**

10141 OLNEY ST. / EL MONTE, CA 91731  
TEL 626-454-8300 | FAX 626-454-8399 |

[www.lalighting.com](http://www.lalighting.com)

**PHOTOMETRIC DATA - STW100 SERIES**

**STW100-2-4L-1DRDM-UNV-1/835**

TEST NO.= LA-T2803  
 LED TYPE= 24 LED MODULE  
 NO. OF MODULE=2  
 SYSTEM WATT (W)=17.18  
 CRI ≥ 80  
 L70(Hrs.) = 193,000  
 PHOTOMETRY TYPE=C

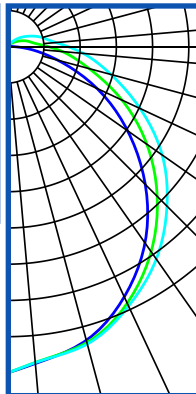
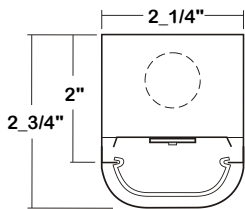

**CANDLEPOWER**

ANGLE	END	45	CROSS
0	407	405	405
5	405	403	404
15	390	389	392
25	361	363	371
35	320	327	341
45	268	285	303
55	211	236	259
65	148	184	211
75	84	131	161
85	26	81	111
90	1	59	89
95	1	52	81
105	1	39	66
115	1	29	51
125	1	14	38
135	1	1	17
145	1	1	1
155	1	1	1
165	2	1	1
175	2	2	1
180	2	2	1

**ZONAL LUMEN SUMMARY**

DEGREES	LUMENS	% FIXTURE
0-30	316.9	21.3
0-40	523.3	35.1
0-60	954.8	64.1
0-90	1353	90.9
90-180	136.2	9.1
0-180	1424	100.0

Luminaire Output= 1424 lumens  
 Luminaire Efficacy = 82.89 LPW

**SPACING CRITERION**

ALONG	ACROSS
-	-

**STW100-2-4L-1DRDM-UNV-1/840**

TEST NO.= LA-T2733  
 LED TYPE= 24 LED MODULE  
 NO. OF MODULE=2  
 SYSTEM WATT (W)=16.97  
 CRI ≥ 80  
 L70(Hrs.) = 193,000  
 PHOTOMETRY TYPE=C

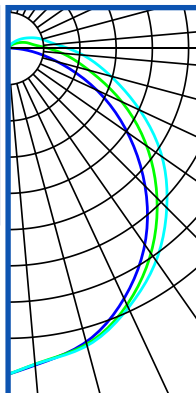
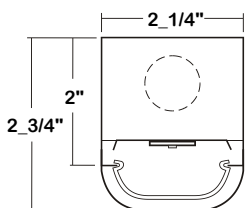

**CANDLEPOWER**

ANGLE	END	45	CROSS
0	487	487	487
5	482	478	477
15	458	462	462
25	420	425	433
35	361	377	392
45	294	317	340
55	222	256	284
65	148	190	221
75	78	127	161
85	29	82	114
90	12	62	91
95	6	47	73
105	3	32	53
115	1	21	37
125	0	12	25
135	0	5	13
145	0	1	5
155	0	0	0
165	0	0	0
175	0	0	0
180	0	0	0

**ZONAL LUMEN SUMMARY**

DEGREES	LUMENS	% LAMP	% FIXTURE
0-30	373	18.0	23.3
0-40	610	29.4	38.2
0-60	1084	52.2	67.8
0-90	1478	71.2	92.5
90-120	102	4.9	6.4
90-150	118	5.7	7.4
90-180	118	5.7	7.4
0-180	1597	76.9	100.0

Luminaire Output= 1597 lumens  
 Luminaire Efficacy = 94.11 LPW

**SPACING CRITERION**

ALONG	ACROSS
1.19	1.26

**STW100-2-4L-1DRDM-UNV-1/850**

TEST NO.= LA-T2805  
 LED TYPE= 24 LED MODULE  
 NO. OF MODULE=2  
 SYSTEM WATT (W)=17.38  
 CRI ≥ 80  
 L70(Hrs.) = 193,000  
 PHOTOMETRY TYPE=C

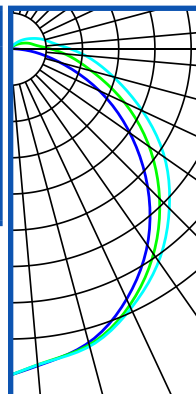
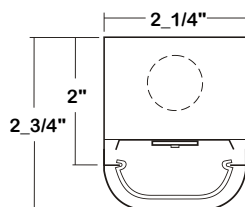

**CANDLEPOWER**

ANGLE	END	45	CROSS
0	492	492	492
5	495	495	499
15	467	471	475
25	428	434	441
35	370	385	398
45	300	325	348
55	227	260	289
65	153	194	224
75	79	130	164
85	30	84	117
90	12	62	94
95	6	48	75
105	3	33	54
115	1	21	39
125	0	12	25
135	0	5	14
145	0	1	5
155	0	0	0
165	0	0	0
175	0	0	0
180	0	0	0

**ZONAL LUMEN SUMMARY**

DEGREES	LUMENS	% LAMP	% FIXTURE
0-30	381	18.0	23.3
0-40	623	29.3	38.1
0-60	1107	52.1	67.8
0-90	1510	71.1	92.5
90-120	105	4.9	6.4
90-150	121	5.7	7.4
90-180	121	5.7	7.4
0-180	1633	76.9	100.0

Luminaire Output= 1633 lumens  
 Luminaire Efficacy = 93.96 LPW

**SPACING CRITERION**

ALONG	ACROSS
1.20	1.26

**STW100-4-4L-1DRDM-UNV-1/835**

TEST NO.= LA-T2806  
 LED TYPE= 32 LED MODULE  
 NO. OF MODULE=2  
 SYSTEM WATT (W)=34.55  
 CRI ≥ 80  
 L70(Hrs.) = 193,000  
 PHOTOMETRY TYPE=C

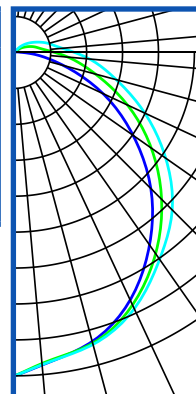
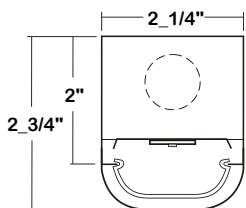

**CANDLEPOWER**

ANGLE	END	45	CROSS
0	867	867	867
5	866	858	862
15	827	818	825
25	751	749	765
35	649	657	688
45	524	556	602
55	395	448	505
65	268	340	455
75	149	236	300
85	47	146	204
90	3	106	161
95	1	90	142
105	1	64	108
115	0	42	79
125	0	18	53
135	0	8	22
145	0	2	7
155	0	0	2
165	0	0	0
175	0	0	0
180	0	0	0

**ZONAL LUMEN SUMMARY**

DEGREES	LUMENS	% FIXTURE
0-30	662	23.1
0-40	1079	37.6
0-60	1915	66.8
0-90	2646	25.5
90-180	220	7.7
0-180	2866	100.0

Luminaire Output= 2866 lumens  
 Luminaire Efficacy = 82.95 LPW

**SPACING CRITERION**

ALONG	ACROSS
-	-



**LOS ANGELES LIGHTING MFG. CO.**

10141 OLNEY ST. / EL MONTE, CA 91731  
 TEL 626-454-8300 | FAX 626-454-8399 |

[www.lalighting.com](http://www.lalighting.com)