



# BAYLIGHTER®

## HBI609 SERIES

# Rugged Gymnasium Luminaire



- Rugged Gymnasium High Impact / Vandal Resistant Luminaire
- Multi-Level Switching
- Heavy Gauge Cold Rolled Steel Welded Construction
- Powder Coated Finish / Painted After Fabrication
- Full Length Piano Hinge and Captive Screws
- Removable Wiring Access Plate
- Stem, Cable or Chain Mountable
- Available with:

Fluorescent, LED and LED T8 (Internally Driven)

11ga. Wire Guard

95% Enhanced Specular Aluminum Reflectors

Sensor

Emergency Battery Pack

Pendant Mtg. Hub / Adapter

Custom Colors

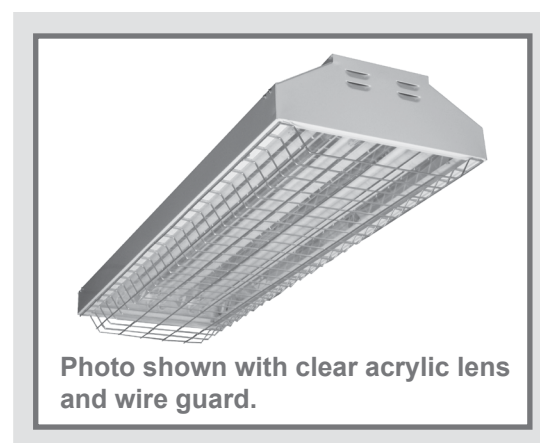

Photometric Data and IES Files are Available on [www.lalighting.com](http://www.lalighting.com)



**LOS ANGELES LIGHTING MFG. CO.**

10141 OLNEY ST. / EL MONTE, CA 91731

TEL : 626-454-8300 FAX : 626-454-8399

[www.lalighting.com](http://www.lalighting.com)



# HBI609 UP-LIGHT

## CROSS SECTION

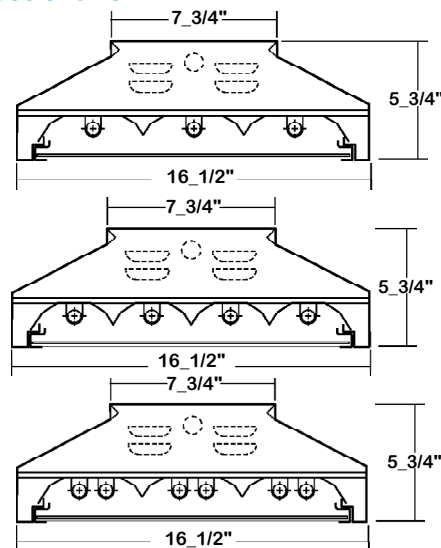

## BACK PLATE

- 3/16" K.O.    ♦ 11/16" STEM MTG. K.O.    ⊕ ⊕ ACCESS PLATE
- V-HOOK    ⊕ 7/8" OFFSET K.O.    ⊕ 2" K.O.

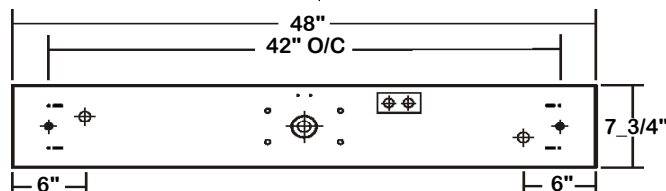

## CATALOG NUMBER

	NOMINAL LENGTH	TOTAL LAMPS		NOMINAL LENGTH	TOTAL LAMPS
HBI609-3-4M	4'	3	HBI609-3-4R	4'	3
HBI609-4-4M	4'	4	HBI609-4-4R	4'	4
HBI609-6-4M	4'	6	HBI609-6-4R	4'	6

## DOOR FRAME INFORMATION

### ● CROSS SECTION

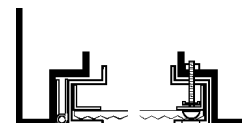

### ● EXPLANATION

1. Continuous Piano Hinge.
2. Two Captive Screws.
3. Inner Frame Lens Retainer Rail.

## ORDERING GUIDE

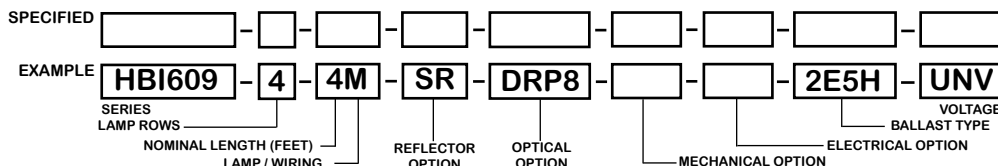

**NOTE: LAMP/WIRING\***  
 M= Miniature Bi-Pin T5  
 R= Medium Bi-Pin T8

## OPTIONS AND ACCESSORIES

### ● REFLECTOR OPTIONS

- Specular Aluminum Reflector (95%)    SUFFIX SR
- White Reflector    SUFFIX WR

### ● OPTICAL OPTIONS

- Clear Polycarbonate .125    SUFFIX CPC2
- Clear Prismatic Polycarbonate .125    SUFFIX PPC2
- High Impact Clear Prismatic Acrylic .125    SUFFIX DRP2
- High Impact Clear Prismatic Acrylic .187    SUFFIX DRP8
- \* Other Lens Available Upon Request

### ● MECHANICAL OPTIONS

- Gasketing    SUFFIX GSK\*
- Tamper Proof Screws (Hex Socket with Post)    SUFFIX TP

### ● ELECTRICAL OPTIONS

- Emergency Battery Pack    SUFFIX BP\*
- External Line Fusing (HLR/GLR)    SUFFIX ELF
- Motion Sensor    SUFFIX MS

### ● BALLAST OPTIONS\*

- Electronic T5    SUFFIX xE5
  - Electronic T5HO    SUFFIX xE5H
  - Electronic T8 Instant Start    SUFFIX xE8I
  - Electronic T8 Rapid Start    SUFFIX xE8R
  - Electronic T8HO    SUFFIX xE8H
- x = Number of Lamps per Ballast

### ● ACCESSORIES

- Wire Guard - 11 Ga.    CAT.NO. WG11-HBI609
- Fixture Suspension System    \*
- Ceiling Spacer    \*
- 6" Leg Height V-Hook    SUFFIX V6
- Die Cast Hub For 3/4" Pipe    HUB

\*Refer to [www.lalighting.com/resources](http://www.lalighting.com/resources) for more information

## SPECIFICATIONS

- **TYPE**    Medium or high bay gymnasium area luminaire for surface, pendant, or chain mounting. Must be spaced a minimum of 1 1/2" from ceiling when surface mounted. Design for use in high impact / vandal resistant applications.
- **CONSTRUCTION**    22 gauge cold rolled steel welded housing. Quarter turn rotary locking lamp-holders standard.
- **FINISH**    (20 GA. housing available as specified) Baked white powder coated finish, minimum reflectance 90%. Painted after fabrication.
- **REFLECTOR**    Enhanced aluminum reflectors, 95% reflectance. White reflector available.
- **DOOR FRAME**    20 gauge cold rolled steel door frame, continuous piano hinge and 2 captive screws. Inner frame lens retainer rail.
- **OPTICS**    Available with various high impact or polycarbonate lenses.
- **WIRE GUARDS**    Chrome epoxy powder coated.
- **WIRING**    120v 60Hz., 277v 60Hz., UNV (universal voltage 120v thru 277v.) or as otherwise specified. Multiple levels of switching available as specified.
- **LABELS**    U.L. Listed. Suitable for damp locations.



**PHOTOMETRIC DATA**

**HBI609-4-4R-SR-CPC2-E8**

TEST NO.=LA-T1232  
 LAMP TYPE=F032T8  
 NO. OF LAMP=4  
 LUMENS PER LAMP=2900  
 WATTS PER LAMP=32  
 BALLAST FACTOR=1  
 PHOTOMETRY TYPE=C

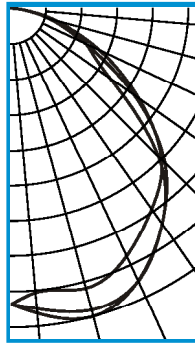
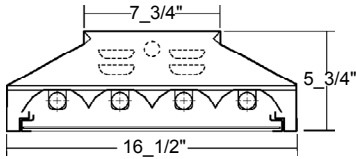
**CANDLEPOWER**

ANGLE	END	45	CROSS
0	3200	3200	3200
5	3084	3261	3311
15	3134	3375	3446
25	2951	3250	3247
35	2642	2836	2836
45	2289	2338	2236
55	1669	1608	1287
65	1038	868	887
75	447	419	494
85	65	78	59
90	0	1	1
95	0	0	0
105	0	0	0
115	0	0	0
125	0	0	0
135	0	0	0
145	0	0	0
155	0	0	0
165	0	0	0
175	0	0	0
180	0	0	0

**ZONAL LUMEN SUMMARY**

DEGREES	LUMENS	% LAMP	% FIXTURE
0-30	2722	23.5	30.0
0-40	4473	38.6	49.3
0-60	7639	65.9	84.2
0-90	9075	78.2	100.0
90-120	0	0.0	0
90-150	0	0.0	0
90-180	0	0.0	0
0-180	9075	78.2	100.0

Lumen Output = 9075 lumens  
 Luminaire Efficiency = 78.2%

**SPACING CRITERION**

ALONG	ACROSS
1.29	1.37

**HBI609-6-4R-SR-CPC2-E8**

TEST NO.=LA-T1010  
 LAMP TYPE=F032T8  
 NO. OF LAMP=6  
 LUMENS PER LAMP=2900  
 WATTS PER LAMP=32  
 BALLAST FACTOR=1  
 PHOTOMETRY TYPE=C

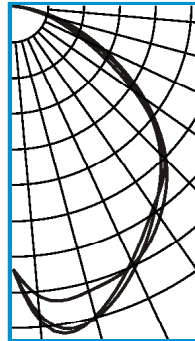
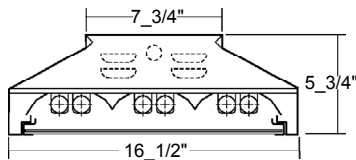
**CANDLEPOWER**

ANGLE	END	45	CROSS
0	3856	3856	3856
5	4255	4549	4633
15	4316	4719	4693
25	4168	4226	4117
35	3756	3629	3587
45	3167	3052	3134
55	2334	2271	2164
65	1435	1327	1132
75	673	501	511
85	100	64	57
90	0	0	0
95	0	0	0
105	0	0	0
115	0	0	0
125	0	0	0
135	0	0	0
145	0	0	0
155	0	0	0
165	0	0	0
175	0	0	0
180	0	0	0

**ZONAL LUMEN SUMMARY**

DEGREES	LUMENS	% LAMP	% FIXTURE
0-30	3669	21.1	29.8
0-40	5962	34.3	48.4
0-60	10392	59.7	84.3
0-90	12323	70.8	100.0
90-120	0	0.0	0
90-150	0	0.0	0
90-180	0	0.0	0
0-180	12323	70.8	100.0

Lumen Output = 12323 lumens  
 Luminaire Efficiency = 70.8%

**SPACING CRITERION**

ALONG	ACROSS
1.46	1.42

**HBI609-4-4M-SR-CPC2-E5H**

TEST NO.=LA-T0740  
 LAMP TYPE=F54T5HO  
 NO. OF LAMP=4  
 LUMENS PER LAMP=5000  
 WATTS PER LAMP=54  
 BALLAST FACTOR=1  
 PHOTOMETRY TYPE=C

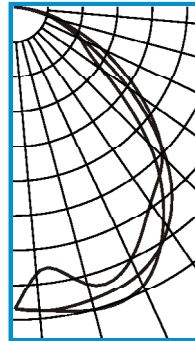
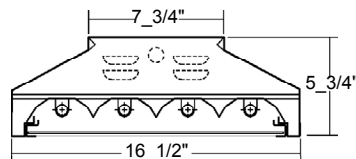
**CANDLEPOWER**

ANGLE	END	45	CROSS
0	6065	6065	6065
5	5338	6126	6115
15	5774	6077	6288
25	5556	5910	6144
35	4756	5367	5196
45	4173	4275	3753
55	3045	2721	2066
65	1852	1444	1432
75	757	735	918
85	109	142	157
90	2	1	2
95	0	0	0
105	0	0	0
115	0	0	0
125	0	0	0
135	0	0	0
145	0	0	0
155	0	0	0
165	0	0	0
175	0	0	0
180	0	0	0

**ZONAL LUMEN SUMMARY**

DEGREES	LUMENS	% LAMP	% FIXTURE
0-30	5004	25.0	30.7
0-40	8253	41.3	50.7
0-60	13810	69.0	84.8
0-90	16286	81.4	100.0
90-120	0	0.0	0
90-150	0	0.0	0
90-180	0	0.0	0
0-180	16286	81.4	100.0

Lumen Output = 16286 lumens  
 Luminaire Efficiency = 81.4%

**SPACING CRITERION**

ALONG	ACROSS
1.25	1.34

**HBI609-6-4M-SR-CPC2-E5H**

TEST NO.=LA-T0737  
 LAMP TYPE=F54T5HO  
 NO. OF LAMP=6  
 LUMENS PER LAMP=5000  
 WATTS PER LAMP=54  
 BALLAST FACTOR=1  
 PHOTOMETRY TYPE=C

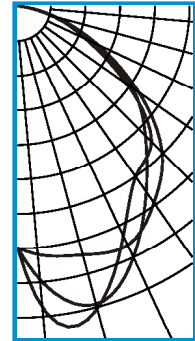
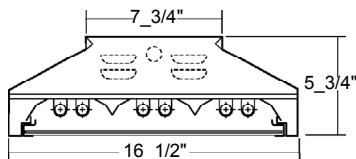
**CANDLEPOWER**

ANGLE	END	45	CROSS
0	7425	7425	7425
5	7667	8486	9361
15	7908	9466	9572
25	8072	8455	7708
35	7319	6887	6343
45	6261	5536	5811
55	4493	4268	4048
65	2649	2502	2262
75	1153	1032	1124
85	186	171	144
90	1	1	1
95	0	0	0
105	0	0	0
115	0	0	0
125	0	0	0
135	0	0	0
145	0	0	0
155	0	0	0
165	0	0	0
175	0	0	0
180	0	0	0

**ZONAL LUMEN SUMMARY**

DEGREES	LUMENS	% LAMP	% FIXTURE
0-30	7168	23.9	30.5
0-40	11477	38.3	48.8
0-60	19788	66.0	84.1
0-90	23535	78.4	100.0
90-120	0	0.0	0
90-150	0	0.0	0
90-180	0	0.0	0
0-180	23535	78.4	100.0

Lumen Output = 23535 lumens  
 Luminaire Efficiency = 78.4%

**SPACING CRITERION**

ALONG	ACROSS
1.47	1.34

