



SURFACE MOUNT LED

MIC 120 (2X2) SERIES (2X4 AVAILABLE)

INDIRECT / DIRECT ILLUMINATED CENTER BASKET LUMINAIRE

DATE	
JOB	

WWW.LALIGHTING.COM
626-454-8300

SURFACE MOUNTED LED LUMINAIRE

DIMENSIONS

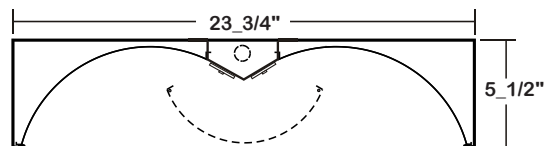

- 3/8" K.O.
- ◆ 11/16" STEM MTG. K.O.
- ⊕ 7/8" OFFSET K.O.
- ⊗ 2" K.O.

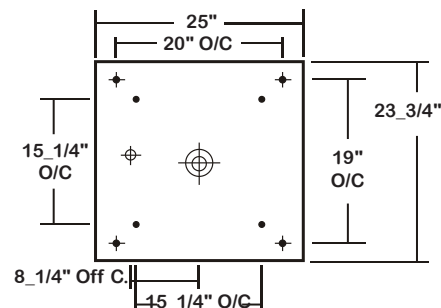

APPLICATIONS

- Commercial, Office, Classroom

FEATURES

- 0-10V dimming driver standard (See DRIVER OPTIONS for other dimming types)
- Supports California Title 24 compliance

OPTIONS

- Full customization available upon request
- Additional lumen packages and color temperatures available
- Wireless control options available (See SENSOR OPTIONS for wireless controls)
- Frosted acrylic / linear pattern available
- Custom colors available (See CUSTOM COLORS for standard and custom options)
- Emergency battery pack available (See BATTERY PACK OPTIONS for battery pack options)
- Tunable white available (2700K-6500K)

SPECIFICATIONS

CONSTRUCTION

- 20 ga. cold rolled steel housing

FINISH

- Baked white powder coated finish / painted after fabrication / minimum reflectance 90%
- Reflectors: high reflectance low gloss matte white finish

OPTICAL

- Perforated center-mount steel basket with white acrylic overlay with polyethylene protective trim

ELECTRICAL

- High efficiency drivers coupled with long-life LEDs
- Service life greater than 50,000 hours (L70)
- Universal voltage 120V through 277V (347V / 480V available)
- Power Factor (PF) ≥ 0.9
- Total Harmonic Distortion (THD) ≤ 20%

LISTING

- UL USA and Canada listed / suitable for damp locations

WARRANTY

- 5-year limited warranty



Los Angeles Lighting Mfg. Co.
Headquarters
10141 Olney Street
El Monte, CA 91731
Made in the USA

Contact Us
T: 626-454-8300
F: 626-454-8399
www.lalighting.com



Due to continued product improvements and enhancements, Los Angeles Lighting Manufacturing Company reserves the right to alter specifications, dimensions, data, and/or materials without notice. Please visit our website to view the most current information.

MADE IN THE U.S.A.

Revised 08-13-19

WARNING

ORDERING INFORMATION

EXAMPLE: MIC120-4-2L-PDA-BPL1.5-DRDM-UNV-2/840

SERIES	LED LUMEN PACKAGE	EFFICACY	NOMINAL LENGTH	COLOR	OPTICAL	ELECTRICAL	DRIVER	VOLTAGE	# OF LED ROW	CRI / CCT
MIC120			2L				DRDM	UNV	2	
MIC120 Indirect / Direct Illuminated Center Basket LED Luminaire	2 Nom. 2000 Lumens 3 Nom. 3000 Lumens 4 Nom. 4000 Lumens 6 Nom. 6000 Lumens *Additional Lumen Packages Available	(Blank) Standard HE High Efficacy	2L 2X2	BLK Matte Black CS Camaro Silver BZ Statuary Bronze *Leave Blank for White Standard <i>See <u>CUSTOM COLORS</u> for <u>Options</u></i>	PDA Perforated Steel Basket with White Acrylic Overlay with Polyethylene Protective Trim F/LP Frosted Acrylic / Linear Pattern	BPL1.5 Emergency Battery Pack, Nom. 1500 Im <i>See <u>BATTERY PACK OPTIONS</u> for <u>Options</u></i> WLC(LED RU) EnOcean Wireless Control <i>See <u>SENSOR OPTIONS</u> for <u>Options</u></i> *Leave Blank if Not Specified <i>Additional Electrical Options</i>	DRDM 0-10V Dimming Driver <i>See <u>DRIVER OPTIONS</u> for <u>Options</u></i>	UNV 120V-277V <i>See <u>DRIVER OPTIONS</u> for <u>Options</u></i>	2 Two LED Rows	830 80+CRI / 3000K Color Temp. 835 80+CRI / 3500K Color Temp. 840 80+CRI / 4000K Color Temp. 850 80+CRI / 5000K Color Temp. *Additional Color Temp. Available

SYSTEM DATA

THESE ARE THE MOST POPULAR LUMEN PACKAGES. PLEASE CONSULT FACTORY FOR ADDITIONAL SYSTEM DATA.

LED LUMEN PACKAGE	NORMAL AMBIENT TEMPERATURE PRODUCT CODE	DELIVERED LUMENS	SYSTEM WATTS	LUMINAIRE EFFICACY	AMBIENT TEMP.	FLUORESCENT / HID / CFL EQUIVALENT	IES FILES
2000 Lumens (Nominal)	MIC120-2-2L-PDA-DRDM-UNV-2/840	1445 lm	15.7 W	91.9 lm/W	-20°C / 35°C	2-F17T8, 1-F24T5HO, 1-BX40	*
3000 Lumens (Nominal)	MIC120-3-2L-PDA-DRDM-UNV-2/840	2119 lm	24.3 W	87.1 lm/W	-20°C / 35°C	3-F17T8, 1-BX55	*
4000 Lumens (Nominal)	MIC120-4-2L-PDA-DRDM-UNV-2/840	3069 lm	31.3 W	98.2 lm/W	-20°C / 35°C	4-F17T8, 2-F24T5HO, 2-BX40	LA-T3360-3
6000 Lumens (Nominal)	MIC120-6-2L-PDA-DRDM-UNV-2/840	3946 lm	52.3 W	75.4 lm/W	-20°C / 35°C	6-F17T8, 2-BX55	*

LED LUMEN PACKAGE	NORMAL AMBIENT TEMPERATURE (HIGH EFFICACY) PRODUCT CODE	DELIVERED LUMENS	SYSTEM WATTS	LUMINAIRE EFFICACY	AMBIENT TEMP.	FLUORESCENT EQUIVALENT	IES FILES
2000 Lumens (Nominal)	MIC120-2HE-2L-PDA-DRDM-UNV-2/840	1450 lm	12.6 W	115.4 lm/W	-20°C / 35°C	2-F17T8, 1-F24T5HO, 1-BX40	*
3000 Lumens (Nominal)	MIC120-3HE-2L-PDA-DRDM-UNV-2/840	2022 lm	17.8 W	113.4 lm/W	-20°C / 35°C	3-F17T8, 1-BX55	*
4000 Lumens (Nominal)	MIC120-4HE-2L-PDA-DRDM-UNV-2/840	2577 lm	23.2 W	111.1 lm/W	-20°C / 35°C	4-F17T8, 2-F24T5HO, 2-BX40	*
6000 Lumens (Nominal)	MIC120-6HE-2L-PDA-DRDM-UNV-2/840	3893 lm	36.8 W	105.8 lm/W	-20°C / 35°C	6-F17T8, 2-BX55	*

NOTE:
System data is based on 120V input voltage. Actual performance may differ as a result of end-user environment and application.

This fixture has been tested and listed in accordance with UL Standards. L.A. Lighting certifies that it will operate safely when installed properly, and within an ambient temperature range noted in the system data table.

Additional lumen packages and color temperatures available.

PERFORMANCE DATA

[VIEW PHOTOMETRICS](#)



Los Angeles Lighting Mfg. Co.
Headquarters
10141 Olney Street
El Monte, CA 91731
Made in the USA

Contact Us
T: 626-454-8300
F: 626-454-8399
www.lalighting.com



Due to continued product improvements and enhancements, Los Angeles Lighting Manufacturing Company reserves the right to alter specifications, dimensions, data, and/or materials without notice. Please visit our website to view the most current information.

MADE IN THE U.S.A.

Revised 08-13-19

WARNING

SENSOR OPTIONS



CONTROLS AND SENSORS

WLC(LED RU) - EnOcean® LED Relay Zone Controller

- Supports a single LED fixture or multiple daisy chained LED fixtures
- Module installed inside lighting fixture

ESRPU-W-EO - EnOcean® Rocker Switch – Single – Surface Mount

- Wireless single rocker switch with mounting plate
- No batteries needed

EDRPU-W-EO - EnOcean® Rocker Switch – Double – Surface Mount

- Wireless double rocker switch with mounting plate
- No batteries needed

S3054-N300 - EnOcean® Navigan NWC 300U – Commissioning Tool

- Navigan Wireless Commissioner is used to configure EnOcean controllers & sensors
- It can be used to define link tables, change parameters/settings, and to edit & store projects
- Configuration settings can be saved and cloned to enable quick configuration
- Connectivity is through the NWC 300U USB Stick

EOSWU-W-EO - EnOcean® Occupancy Sensor – Wall Mount

- Wireless wall mounted occupancy sensor
- Solar powered - no batteries needed (coin battery operated in low light conditions)
- PIR motion sensor with both wide angle (50') and long range (100') options
- Mounting height: 6-8 feet

EOSCU-W-EO - EnOcean® Occupancy Sensor – Ceiling Mount

- Wireless ceiling mounted occupancy sensor
- Solar powered - no batteries needed (coin battery operated in low light conditions)
- PIR motion sensor with 360 degree viewing angle lens (34' diameter)
- Mounting height: 7-10 feet

ELLSU-W-EO - EnOcean® Light Level Sensor – Ceiling Mount

- Light Level sensor that measures and reports the level of available natural light
- Solar powered - no batteries needed (coin battery operated in low light conditions)
- Enables implementation of daylight harvesting control systems
- Mounting position: At the ceiling, close to ambient light source

DRIVER OPTIONS

PLEASE CONSULT FACTORY TO SEE IF YOUR SELECTED DRIVER OPTION WORKS WITH THIS FIXTURE.

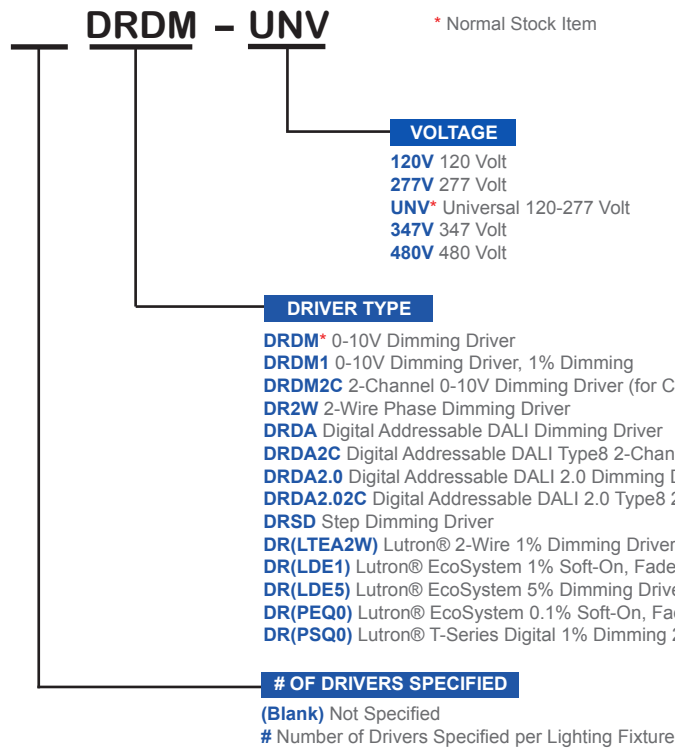

BATTERY PACK OPTIONS

PLEASE CONSULT FACTORY TO SEE IF YOUR SELECTED BATTERY PACK OPTION WORKS WITH THIS FIXTURE.

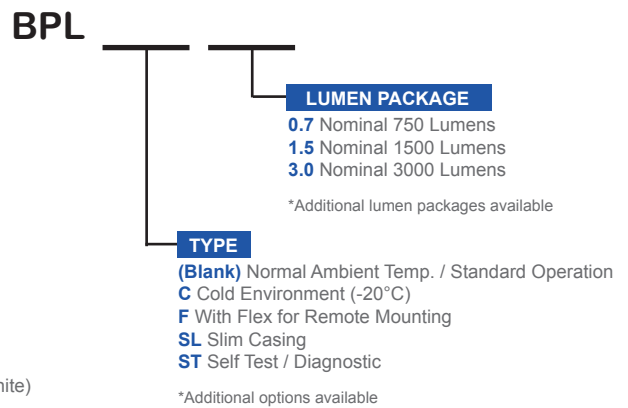

CUSTOM COLORS

- BLK - Matte Black**
- CS - Camaro Silver**
- BZ - Statuary Bronze**

Variety of RAL colors & Axalta/DuPont colors available upon request.



Los Angeles Lighting Mfg. Co.
 Headquarters
 10141 Olney Street
 El Monte, CA 91731
 Made in the USA

Contact Us
 T: 626-454-8300
 F: 626-454-8399
 www.lalighting.com



Due to continued product improvements and enhancements, Los Angeles Lighting Manufacturing Company reserves the right to alter specifications, dimensions, data, and/or materials without notice. Please visit our website to view the most current information.

MADE IN THE U.S.A.

Revised 08-13-19

WARNING

PHOTOMETRIC DATA - MIC120 SERIES (2FT)

MIC120-4-2L-PDA-1DRDM-UNV-2/840

TEST NO.=LA-T3360-3
 LED TYPE= 48 LED MODULE
 NO. OF MODULE=2
 SYSTEM WATT (W)=33.1
 CRI ≥ 80
 L70(Hrs.) ≥ 50,000
 PHOTOMETRY TYPE=C

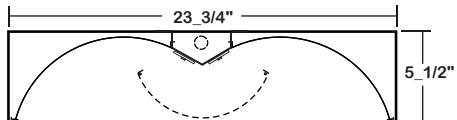
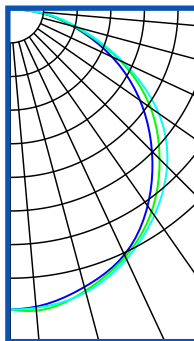

CANDLEPOWER

ANGLE	END	45	CROSS
0	930	930	930
5	925	937	929
15	891	903	908
25	839	846	854
35	743	765	780
45	622	656	688
55	492	532	563
65	349	378	388
75	201	207	219
85	72	75	80
90	4	5	5
95	0	0	0
105	0	0	0
115	0	0	0
125	0	0	0
135	0	0	0
145	0	0	0
155	0	0	0
165	0	0	0
175	0	0	0
180	0	0	0

ZONAL LUMEN SUMMARY

DEGREES	LUMENS	% LAMP	% FIXTURE
0-30	736	17	26
0-40	1215	28	43
0-60	2198	51	77
0-90	2852	67	100
90-120	0.0	0.0	0.0
90-150	0.0	0.0	0.0
90-180	0.0	0.0	0.0
0-180	2853	67	100

Luminaire Output= 2853.1 lumens
 Luminaire Efficacy = 86.2 lm/W
 Luminaire Efficiency = 66.6%

SPACING CRITERION

ALONG	ACROSS
1.26	1.30

