



WRAPAROUND

WSE200 (3FT) SERIES (4' AND 8' AVAILABLE)

HIGH IMPACT SECURITY WRAPAROUND LUMINAIRE



DATE	
JOB	

WWW.LALIGHTING.COM
626-454-8300

APPLICATIONS

COMMERCIAL, PARKING STRUCTURE,
CLASSROOM, CORRIDOR, CANOPY



SPECIFICATIONS

FEATURES

- Stem / suspension mounted LED luminaire (Aircraft Cable Mounting System available)
- 0-10V dimming driver standard (other dimming types available)
- Controls and sensors available
- Wireless control options (Lutron, EnOcean, ZigBee, etc.)
- Supports California Title 24 compliance
- Suitable for damp locations
- Additional lumen packages and color temperatures available
- Full customization available upon request

CONSTRUCTION

- 22 ga. cold rolled steel housing with 18 ga. end plates
- Spot welded seams and corners
- Full neoprene gasket
- Phillips head screws / tamper proof screws available
- Wet location available
- 45-degree mounting bracket available

OPTICAL

- 25% "DR" high impact linear pattern frosted acrylic lens
- Lens secured by steel lens retainers and 2 stainless steel knurled head thumb screws

ELECTRICAL

- High efficiency drivers coupled with long-life LEDs
- Service life greater than 50,000 hours (L70)
- Universal voltage 120V through 277V (347V / 480V available)
- Emergency battery pack available

FINISH

- Baked white powder coated finish
- Minimum reflectance 90%
- Welded and painted after fabrication
- Custom colors available

CUSTOM COLORS

BLK - Matte Black

CS - Camaro Silver

BZ - Statuary Bronze

Variety of RAL colors & Axalta/DuPont colors available upon request.

CERTIFICATIONS



DIMENSIONS

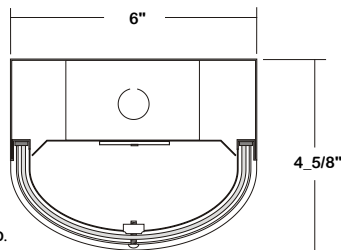

- 11/16" STEM MTG. K.O.
- 7/8" OFFSET K.O.
- 2" K.O.
- 7/8" K.O. ON SIDE OF HOUSING FOR 1/2" CONDUIT

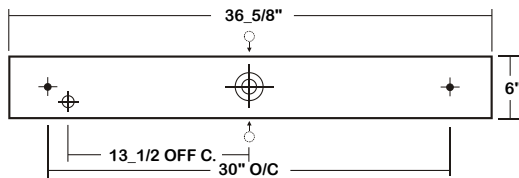

ORDERING INFORMATION

EXAMPLE: WSE200-3-3L-BPL-1DRDM-UNV-1/840

SERIES	LED LUMEN PACKAGE	NOMINAL LENGTH	MECHANICAL	ELECTRICAL	DRIVER	VOLTAGE	# OF LED ROW	CRI / CCT
WSE200		3L				UNV	1	
WSE200 High Impact Security Wraparound LED Luminaire	3 Nom. 3000 Lumens <i>*Additional Lumen Packages Available</i>	3L 3'	TP Tamper Proof Screws (Hex Socket w/Post) PH Phillips Head Screws WL Wet Location (Electro Galvanized Steel Housing) <i>*Leave Blank for Standard Knurled Head Screws Additional Mechanical Options</i>	BPL Emergency Battery Pack MSxx Motion Sensor (End-Mount) SDxx Step Dimming Control <i>*Leave Blank if Not Specified Additional Motion Sensor Options Additional Electrical Options</i>	1DRDM 0-10V One Dimming Driver <i>Additional Driver Options</i>	UNV 120V-277V <i>*Additional Voltages Available</i>	1 One LED Row	835 80+CRI / 3500K Color Temp. 840 80+CRI / 4000K Color Temp. 850 80+CRI / 5000K Color Temp. <i>*Additional Color Temp. Available</i>



Los Angeles Lighting Mfg. Co.

Headquarters
10141 Olney Street
El Monte, CA 91731
Made in the USA

Contact Us
T: 626-454-8300
F: 626-454-8399
www.lalighting.com

Due to continued product improvements and enhancements, Los Angeles Lighting Manufacturing Company reserves the right to alter specifications, dimensions, data, and/or materials without notice. Please visit our website to view the most current information.

Revised 07-24-17

SYSTEM DATA

NOMINAL SIZE	LED LUMEN PACKAGE	CRI / CCT	DELIVERED LUMENS	SYSTEM WATTS	LUMINAIRE EFFICACY	FLUORESCENT EQUIVALENT	IES FILES
3'	3000 lm	835	2836 lm	26.1 W	108.6 lm/W	2-F25T8, 1-F39T5HO	*
		840	2933 lm	26.1 W	112.3 lm/W		*

NOTE:

System data above is based on 120V input voltage.

Actual performance may differ as a result of end-user environment and application.

This fixture has been tested and listed in accordance with UL Standards. L.A. Lighting certifies that it will operate safely when installed properly, and within an ambient temperature range from -20°C to 40°C.

Additional lumen packages and color temperatures available.

ACCESSORIES

433B

- Blank Canopy with Cable
- No Power Cord
- Cable Length 48" and 96"
- Max. Weight 196 lbs. Per Set



433B-48 W

COLOR

- W White Standard
- B Black

CABLE LENGTH

- 48" and 96" Standard
- (Other Lengths As Specified)

444F

- Feed-In Canopy with Straight Cord
- Includes Power Cord
- Cable Length 48" and 96"
- Max. Weight 196 lbs. Per Set



444F-48SW-2C

OF CIRCUIT

- 2C Two Circuits
- LV 0-10V Dimming
- Leave blank for one circuit

COLOR

- W White Standard
- B Black

CORD TYPE

- S Straight Cord

CABLE LENGTH

- 48" and 96" Standard
- (Other Lengths As Specified)

45MB

- 45-Degree Mounting Bracket
- Designed for mounting lighting fixtures at 45° angle
- Ideal for wall or ceiling mount applications
- 18 ga. electro galvanized steel
- Baked white powder coated finish

Note: Must drill own holes for 45-Degree Mounting Bracket.

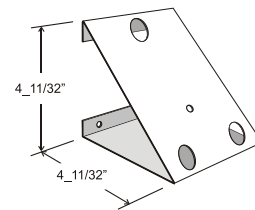

Los Angeles Lighting Mfg. Co.

Headquarters
10141 Olney Street
El Monte, CA 91731
Made in the USA

Contact Us
T: 626-454-8300
F: 626-454-8399
www.lalighting.com

Due to continued product improvements and enhancements, Los Angeles Lighting Manufacturing Company reserves the right to alter specifications, dimensions, data, and/or materials without notice. Please visit our website to view the most current information.