



SURFACE MOUNT LED

MHL306 (8FT) SERIES (2' AND 4' AVAILABLE)

6" WIDE HINGE AND LATCH DOOR FRAME LUMINAIRE

DATE	
JOB	

WWW.LALIGHTING.COM
626-454-8300

SURFACE MOUNTED LED LUMINAIRE

DIMENSIONS

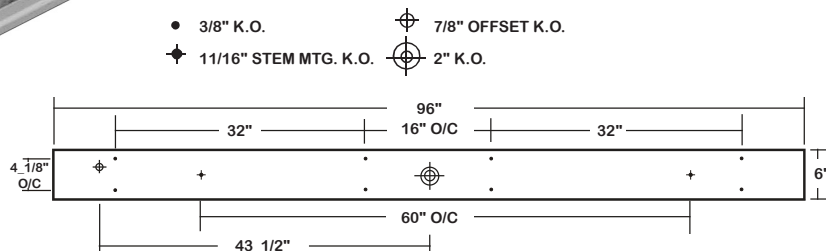
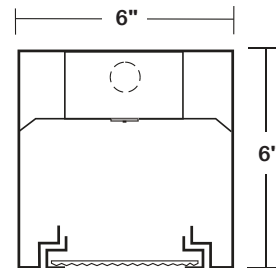

APPLICATIONS

- Commercial

FEATURES

- 0-10V dimming driver standard (See *DRIVER OPTIONS* for other dimming types)
- Supports California Title 24 compliance

OPTIONS

- Full customization available upon request
- Additional lumen packages and color temperatures available
- Wireless control options available (See *SENSOR OPTIONS* for wireless controls)
- Variety of lenses available (See *OPTICAL OPTIONS* for lenses)
- Custom colors available (See *CUSTOM COLORS* For standard and custom options)
- Emergency battery pack available (See *BATTERY PACK OPTIONS* for battery pack options)
- Tamper proof screws available
- Tunable white available (2700K-6500K)

SPECIFICATIONS

CONSTRUCTION

- 20 ga. cold rolled steel welded housing
- 20 ga. cold rolled steel door frame secured by T-hinges and positive spring loaded latches
- One way polyurethane gasket (See *GASKET* for gasket options)

FINISH

- Baked white powder coated finish / painted after fabrication / minimum reflectance 90%

OPTICAL

- Clear prismatic acrylic lens

ELECTRICAL

- High efficiency drivers coupled with long-life LEDs
- Service life greater than 50,000 hours (L70)
- Universal voltage 120V through 277V (347V / 480V available)
- Power Factor (PF) ≥ 0.9
- Total Harmonic Distortion (THD) $\leq 20\%$

LISTING

- UL USA and Canada listed / suitable for damp locations

WARRANTY

- 5-year limited warranty



Los Angeles Lighting Mfg. Co.
Headquarters
10141 Olney Street
El Monte, CA 91731
Made in the USA

Contact Us
T: 626-454-8300
F: 626-454-8399
www.lalighting.com



Due to continued product improvements and enhancements, Los Angeles Lighting Manufacturing Company reserves the right to alter specifications, dimensions, data, and/or materials without notice. Please visit our website to view the most current information.

MADE IN THE U.S.A.

Revised 08-02-19

WARNING

ORDERING INFORMATION

EXAMPLE: MHL306-4-8L-FSW-PA-TP-BPL1.5-DRDM-UNV-1/840

SERIES	LED LUMEN PACKAGE	EFFICACY	NOMINAL LENGTH	COLOR	DOOR FRAME	OPTICAL	MECHANICAL	ELECTRICAL	DRIVER	VOLTAGE	# OF LED ROW	CRI / CCT
MHL306			8L						DRDM	UNV	1	
MHL306 6" Wide Hinge and Latch Door Frame LED Luminaire	4 Nom. 4000 Lumens 8 Nom. 8000 Lumens 12 Nom. 12000 Lumens 16 Nom. 16000 Lumens *Additional Lumen Packages Available	(Blank) Standard HE High Efficacy (Only 4000 / 8000 / 12000 lumens Systems)	8L 8'	(Blank) Standard White BLK Matte Black CS Camaro Silver BZ Statuary Bronze <u>See CUSTOM COLORS for Options</u> *Additional Colors Available Upon Request	FSW Flat Steel White Enamel <u>See DOOR FRAME for Options</u>	PA Clear Prismatic Acrylic PA2 Clear Prismatic Acrylic 0.125 FPA2 Frosted Prismatic Acrylic 0.125 FFA Frosted Flat Acrylic <u>See OPTICAL OPTIONS for Options</u>	TP Tamper Proof Screws (Hex Socket with Post) GSKNx Neoprene Gasket <u>See GASKET for Options</u> *Leave Blank if Not Specified <u>Additional Mechanical Options</u>	BPL1.5 Emergency Battery Pack, Nom. 1500 lm <u>See BATTERY PACK OPTIONS for Options</u> WLC(LED RU) EnOcean Wireless Control <u>See SENSOR OPTIONS for Options</u> *Leave Blank if Not Specified <u>Additional Electrical Options</u>	DRDM 0-10V Dimming Driver <u>See DRIVER OPTIONS for Options</u>	UNV 120V-277V <u>See DRIVER OPTIONS for Options</u>	1 One LED Row	830 80+CRI / 3000K Color Temp. 835 80+CRI / 3500K Color Temp. 840 80+CRI / 4000K Color Temp. 850 80+CRI / 5000K Color Temp.

SYSTEM DATA

THESE ARE THE MOST POPULAR LUMEN PACKAGES. PLEASE CONSULT FACTORY FOR ADDITIONAL SYSTEM DATA.

LED LUMEN PACKAGE	NORMAL AMBIENT TEMPERATURE PRODUCT CODE	DELIVERED LUMENS	SYSTEM WATTS	LUMINAIRE EFFICACY	AMBIENT TEMP.	FLUORESCENT EQUIVALENT	IES FILES
4000 Lumens (Nominal)	MHL306-4-8L-FSW-PA-DRDM-UNV-1/840	1939 lm	28.7 W	67.6 lm/W	-20°C / 35°C	2-F32T8	*
8000 Lumens (Nominal)	MHL306-8-8L-FSW-PA-DRDM-UNV-1/840	3873 lm	62.1 W	62.3 lm/W	-20°C / 35°C	4-F32T8, 2-F54T5HO	LA-T3342
12000 Lumens (Nominal)	MHL306-12-8L-FSW-PA-DRDM-UNV-1/840	5754 lm	104.6 W	55.0 lm/W	-20°C / 35°C	6-F32T8	*
16000 Lumens (Nominal)	MHL306-16-8L-FSW-PA-DRDM-UNV-1/840	7517 lm	101.7 W	73.9 lm/W	-20°C / 35°C	8-F32T8, 4-F54T5HO	*

LED LUMEN PACKAGE	NORMAL AMBIENT TEMPERATURE (HIGH EFFICACY) PRODUCT CODE	DELIVERED LUMENS	SYSTEM WATTS	LUMINAIRE EFFICACY	AMBIENT TEMP.	FLUORESCENT EQUIVALENT	IES FILES
4000 Lumens (Nominal)	MHL306-4HE-8L-FSW-PA-DRDM-UNV-1/840	2031 lm	24.1 W	84.3 lm/W	-20°C / 35°C	2-F32T8, 1-F54T5HO	*
8000 Lumens (Nominal)	MHL306-8HE-8L-FSW-PA-DRDM-UNV-1/840	3998 lm	49.6 W	80.6 lm/W	-20°C / 35°C	4-F32T8, 2-F54T5HO	*
12000 Lumens (Nominal)	MHL306-12HE-8L-FSW-PA-DRDM-UNV-1/840	5827 lm	75.8 W	76.9 lm/W	-20°C / 35°C	6-F32T8	*

NOTE:
System data is based on 120V input voltage. Actual performance may differ as a result of end-user environment and application.

This fixture has been tested and listed in accordance with UL Standards. L.A. Lighting certifies that it will operate safely when installed properly, and within an ambient temperature range noted in the system data table.

Additional lumen packages and color temperatures available.

PERFORMANCE DATA

[VIEW PHOTOMETRICS](#)



Los Angeles Lighting Mfg. Co.
Headquarters
10141 Olney Street
El Monte, CA 91731
Made in the USA

Contact Us
T: 626-454-8300
F: 626-454-8399
www.lalighting.com



Due to continued product improvements and enhancements, Los Angeles Lighting Manufacturing Company reserves the right to alter specifications, dimensions, data, and/or materials without notice. Please visit our website to view the most current information.

MADE IN THE U.S.A.

Revised 08-02-19

WARNING

SENSOR OPTIONS



CONTROLS AND SENSORS

WLC(LED RU) - EnOcean® LED Relay Zone Controller

- Supports a single LED fixture or multiple daisy chained LED fixtures
- Module installed inside lighting fixture

ESRPU-W-EO - EnOcean® Rocker Switch – Single – Surface Mount

- Wireless single rocker switch with mounting plate
- No batteries needed

EDRPU-W-EO - EnOcean® Rocker Switch – Double – Surface Mount

- Wireless double rocker switch with mounting plate
- No batteries needed

S3054-N300 - EnOcean® Navigan NWC 300U – Commissioning Tool

- Navigan Wireless Commissioner is used to configure EnOcean controllers & sensors
- It can be used to define link tables, change parameters/settings, and to edit & store projects
- Configuration settings can be saved and cloned to enable quick configuration
- Connectivity is through the NWC 300U USB Stick

EOSWU-W-EO - EnOcean® Occupancy Sensor – Wall Mount

- Wireless wall mounted occupancy sensor
- Solar powered - no batteries needed (coin battery operated in low light conditions)
- PIR motion sensor with both wide angle (50') and long range (100') options
- Mounting height: 6-8 feet

EOSCU-W-EO - EnOcean® Occupancy Sensor – Ceiling Mount

- Wireless ceiling mounted occupancy sensor
- Solar powered - no batteries needed (coin battery operated in low light conditions)
- PIR motion sensor with 360 degree viewing angle lens (34' diameter)
- Mounting height: 7-10 feet

ELLSU-W-EO - EnOcean® Light Level Sensor – Ceiling Mount

- Light Level sensor that measures and reports the level of available natural light
- Solar powered - no batteries needed (coin battery operated in low light conditions)
- Enables implementation of daylight harvesting control systems
- Mounting position: At the ceiling, close to ambient light source

DRIVER OPTIONS

PLEASE CONSULT FACTORY TO SEE IF YOUR SELECTED DRIVER OPTION WORKS WITH THIS FIXTURE.

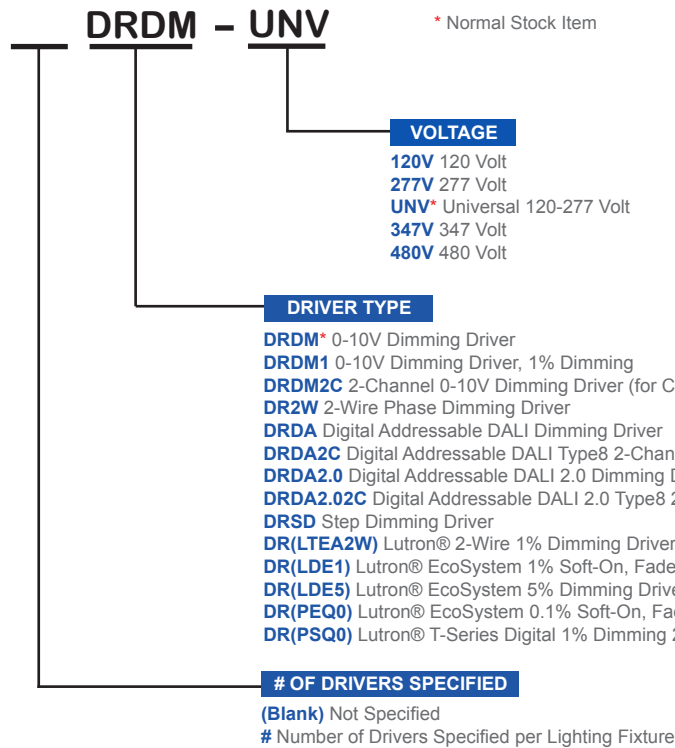

BATTERY PACK OPTIONS

PLEASE CONSULT FACTORY TO SEE IF YOUR SELECTED BATTERY PACK OPTION WORKS WITH THIS FIXTURE.

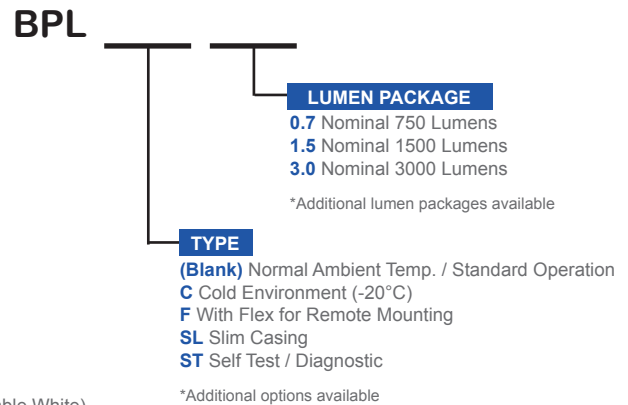

Los Angeles Lighting Mfg. Co.
 Headquarters
 10141 Olney Street
 El Monte, CA 91731
 Made in the USA

Contact Us
 T: 626-454-8300
 F: 626-454-8399
 www.lalighting.com



Due to continued product improvements and enhancements, Los Angeles Lighting Manufacturing Company reserves the right to alter specifications, dimensions, data, and/or materials without notice. Please visit our website to view the most current information.

MADE IN THE U.S.A.

Revised 08-02-19

WARNING

OPTICAL OPTIONS

STANDARD LENSES FOR MHL306

PA	Clear Prismatic Acrylic, No Thickness Specified, Female Prisms 3/16 Square Base
PA2	Clear Prismatic Acrylic, Nom. 0.125 OA Thickness, Female Prisms 3/16 Square Base
FPA2	Frosted Prismatic Acrylic, Nom. 0.125 OA Thickness, Female Prisms 3/16 Square Base
FFA	Flat Frosted Acrylic

DOOR FRAME

CROSS SECTION

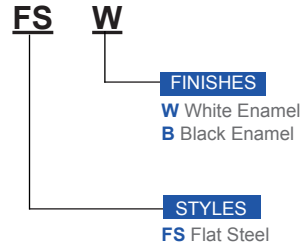
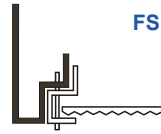

GASKET

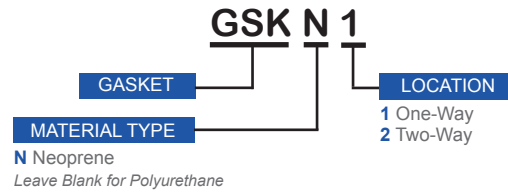

CUSTOM COLORS

- BLK - Matte Black**
- CS - Camaro Silver**
- BZ - Statuary Bronze**

Variety of [RAL colors](#) & [Axalta/DuPont colors](#) available upon request.



Los Angeles Lighting Mfg. Co.
 Headquarters
 10141 Olney Street
 El Monte, CA 91731
 Made in the USA

Contact Us
 T: 626-454-8300
 F: 626-454-8399
 www.lalighting.com



Due to continued product improvements and enhancements, Los Angeles Lighting Manufacturing Company reserves the right to alter specifications, dimensions, data, and/or materials without notice. Please visit our website to view the most current information.

MADE IN THE U.S.A.

Revised 08-02-19

WARNING

PHOTOMETRIC DATA - MHL306 SERIES - 8'

MHL306-8-8L-FSW-PA-1DRDM-UNV-1/840

TEST NO. = LA-T3342
 LED TYPE = 48 LED MODULE
 NO. OF MODULE = 4
 SYSTEM WATT (W) = 62.1 W
 CRI ≥ 80
 L70(Hrs.) ≥ 50,000
 PHOTOMETRY TYPE = C

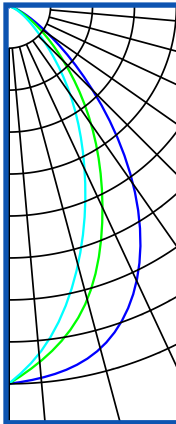
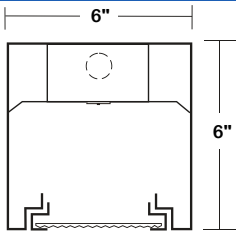

CANDLEPOWER

ANGLE	END	45	CROSS
0	3356	3356	3356
5	3316	3173	3101
15	3149	2699	2379
25	2693	1974	1596
35	1928	1277	951
45	434	310	200
55	144	111	79
65	40.2	29.4	25.6
75	5.7	2.9	2.2
85	0.3	0.1	0.1
90	0	0	0
95	0	0	0
105	0	0	0
115	0	0	0
125	0	0	0
135	0	0	0
145	0	0	0
155	0	0	0
165	0	0	0
175	0	0	0
180	0	0	0

ZONAL LUMEN SUMMARY

DEGREES	LUMENS	% LAMP	% FIXTURE
0-30	2033	24.7	52.5
0-40	2886	35.0	74.5
0-60	3728	45.2	96.2
0-90	3873	47.0	100.0
90-120	0	0.0	0.0
90-150	0	0.0	0.0
90-180	0	0.0	0.0
0-180	3873	47.0	100.0

Luminaire Output = 3873.4 lumens
 Luminaire Efficacy = 62.3 lm/W

SPACING CRITERION

ALONG	ACROSS
1.06	0.71

