



WRAPAROUND

WSE200 (2FT) SERIES (3' AND 4' AND 8' AVAILABLE)

HIGH IMPACT SECURITY WRAPAROUND LUMINAIRE



DATE	
JOB	

WWW.LALIGHTING.COM
626-454-8300

APPLICATIONS

COMMERCIAL, PARKING STRUCTURE,
CLASSROOM, CORRIDOR, CANOPY



DIMENSIONS

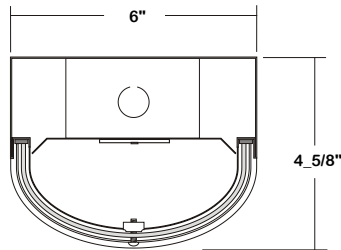

- ⊕ 7/8" OFFSET K.O.
- ⊕ 2" K.O.
- 7/8" K.O. ON SIDE OF HOUSING FOR 1/2" CONDUIT

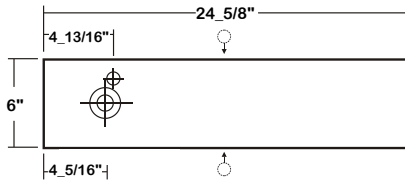

SPECIFICATIONS

FEATURES

- Stem / suspension mounted LED luminaire (Aircraft Cable Mounting System available)
- 0-10V dimming driver standard (other dimming types available)
- Controls and sensors available
- Wireless control options (Lutron, EnOcean, ZigBee, etc.)
- Supports California Title 24 compliance
- Suitable for damp locations
- Additional lumen packages and color temperatures available
- Full customization available upon request

CONSTRUCTION

- 22 ga. cold rolled steel housing with 18 ga. end plates
- Spot welded seams and corners
- Full neoprene gasket
- Phillips head screws / tamper proof screws available
- Wet location available
- 45-degree mounting bracket available

OPTICAL

- 25% "DR" high impact linear pattern frosted acrylic lens
- Lens secured by steel lens retainers and 2 stainless steel knurled head thumb screws

ELECTRICAL

- High efficiency drivers coupled with long-life LEDs
- Service life greater than 50,000 hours (L70)
- Universal voltage 120V through 277V (347V / 480V available)
- Emergency battery pack available

FINISH

- Baked white powder coated finish
- Minimum reflectance 90%
- Welded and painted after fabrication
- Custom colors available

CUSTOM COLORS

BLK - Matte Black

CS - Camaro Silver

BZ - Statuary Bronze

Variety of RAL colors & Axalta/DuPont colors available upon request.

CERTIFICATIONS



ORDERING INFORMATION

EXAMPLE: WSE200-2-2L-TP-BPL10-1DRDM-UNV-1/840

SERIES	LED LUMEN PACKAGE	EFFICACY	NOMINAL LENGTH	MECHANICAL	ELECTRICAL	DRIVER	VOLTAGE	# OF LED ROW	CRI / CCT
WSE200			2L			1DRDM	UNV	1	
WSE200 High Impact Security Wraparound LED Luminaire	2 Nom. 2000 Lumens 3 Nom. 3000 Lumens 4 Nom. 4000 Lumens <i>*Additional Lumen Packages Available</i>	(Blank) Standard HE High Efficacy (Only 2000 / 3000 lumens Systems)	2L 2'	TP Tamper Proof Screws (Hex Socket w/Post) PH Phillips Head Screws WL Wet Location (Electro Galvanized Steel Housing) <i>*Leave Blank for Standard Knurled Head Screws Additional Mechanical Options</i>	BPL10 Emergency Battery Pack, Constant 10W Nom. 15000 lm MSxx Motion Sensor <i>Additional Motion Sensor Options Additional Electrical Options</i>	1DRDM 0-10V One Dimming Driver <i>Additional Driver Options</i>	UNV 120V-277V <i>*Additional Voltages Available</i>	1 One LED Row	835 80+CRI / 3500K Color Temp. 840 80+CRI / 4000K Color Temp. 850 80+CRI / 5000K Color Temp. <i>*Additional Color Temp. Available</i>



Los Angeles Lighting Mfg. Co.

Headquarters
10141 Olney Street
El Monte, CA 91731
Made in the USA

Contact Us
T: 626-454-8300
F: 626-454-8399
www.lalighting.com

Due to continued product improvements and enhancements, Los Angeles Lighting Manufacturing Company reserves the right to alter specifications, dimensions, data, and/or materials without notice. Please visit our website to view the most current information.

Revised 12-12-17

SYSTEM DATA

NOMINAL SIZE	LED LUMEN PACKAGE	CRI / CCT	DELIVERED LUMENS	SYSTEM WATTS	LUMINAIRE EFFICACY	FLUORESCENT EQUIVALENT	IES FILES
2'	2000 lm	840	1904 lm	16.9 W	112.9 lm/W	2-F17T8, 1-F24T5HO	LA-T3175
	2000HE lm	840	1882 lm	13.0 W	145.2 lm/W	2-F17T8, 1-F24T5HO	*
	3000 lm	840	2722 lm	26.5 W	102.8 lm/W	3-F17T8	*
	3000HE lm	840	2793 lm	19.8 W	140.9 lm/W	3-F17T8	*
	4000 lm	840	3676 lm	26.9 W	136.7 lm/W	4-F17T8, 2-F24T5HO	*

NOTE:

System data above is based on 120V input voltage.

Actual performance may differ as a result of end-user environment and application.

This fixture has been tested and listed in accordance with UL Standards. L.A. Lighting certifies that it will operate safely when installed properly, and within an ambient temperature range from -20°C to 35.

Additional lumen packages and color temperatures available.

ACCESSORIES

433B

- Blank Canopy with Cable
- No Power Cord
- Cable Length 48" and 96"
- Max. Weight 196 lbs. Per Set



433B-48 W

COLOR

- W** White Standard
- B** Black

CABLE LENGTH

- 48"** and **96"** Standard
- (Other Lengths As Specified)

444F

- Feed-In Canopy with Straight Cord
- Includes Power Cord
- Cable Length 48" and 96"
- Max. Weight 196 lbs. Per Set



444F-48SW-2C

OF CIRCUIT

- 2C** Two Circuits
- LV** 0-10V Dimming
- Leave blank for one circuit

COLOR

- W** White Standard
- B** Black

CORD TYPE

- S** Straight Cord

CABLE LENGTH

- 48"** and **96"** Standard
- (Other Lengths As Specified)

45MB

- 45-degree mounting bracket designed for mounting lighting fixtures at 45° angle
- Ideal for wall or ceiling mount applications
- 18 ga. electro galvanized steel
- Baked white powder coated finish

Note: Must drill own holes for 45-Degree Mounting Bracket.

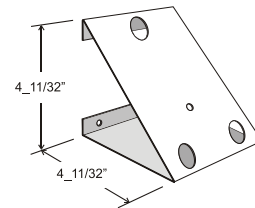

PERFORMANCE DATA

[VIEW PHOTOMETRICS](#)



Los Angeles Lighting Mfg. Co.

Headquarters
10141 Olney Street
El Monte, CA 91731
Made in the USA

Contact Us
T: 626-454-8300
F: 626-454-8399
www.lalighting.com

Due to continued product improvements and enhancements, Los Angeles Lighting Manufacturing Company reserves the right to alter specifications, dimensions, data, and/or materials without notice. Please visit our website to view the most current information.

PHOTOMETRIC DATA - WSE200 SERIES

WSE200-2-2L-1DRDM-UNV-1/840

TEST NO.=LA-T3175
 LED TYPE=48 LED MODULE
 NO. OF MODULE=1
 SYSTEM WATT (W)=16.9
 CRI ≥ 80
 L70(Hrs.) ≥ 50,000
 PHOTOMETRY TYPE=C

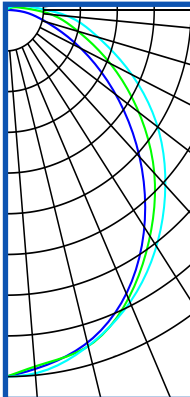
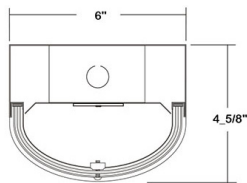

CANDLEPOWER

ANGLE	END	45	CROSS
0	642	642	642
5	631	627	639
15	603	609	609
25	548	557	564
35	464	483	505
45	363	404	434
55	257	312	356
65	158	221	267
75	79	143	183
85	33	87	118
90	12	56	79
95	4	37	54
115	1	10	17
125	0	5	10
135	0	3	6
145	0	1	3
155	0	0	1
165	0	0	0
175	0	0	0
180	0	0	0

ZONAL LUMEN SUMMARY

DEGREES	LUMENS	% LAMP	% FIXTURE
0-30	490	22.9	25.7
0-40	794	37.1	41.7
0-60	1383	64.5	72.6
0-90	1825	85.2	95.8
90-120	71.0	3.3	3.7
90-150	78.7	3.6	4.1
90-180	78.8	3.6	4.1
0-180	1904	88.9	100.00

Luminaire Output= 1904 lumens
 Luminaire Efficacy = 112.6 lm/W

SPACING CRITERION

ALONG	ACROSS
1.18	1.24

