



ARCHITECTURAL

ANG050 (8FT)

SERIES (2' AND 4' AVAILABLE)
ARCHITECTURAL MINIATURE ANGLED LUMINAIRE



DATE	
JOB	

WWW.LALIGHTING.COM
626-454-8300

SURFACE / CORNER / WALL / CEILING MOUNTED LED LUMINAIRE

DIMENSIONS

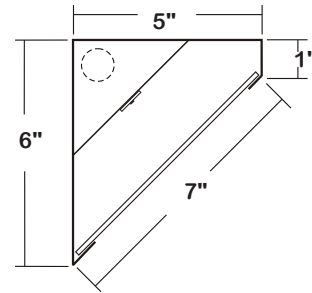

- 3/16" MTG. K.O.
- 7/8" K.O.

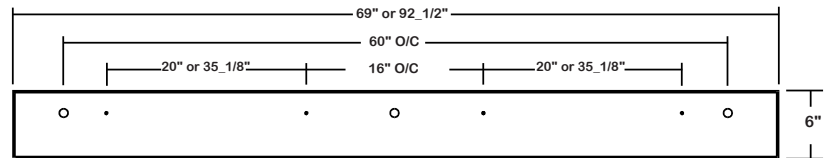

APPLICATIONS

- Architectural, Retail, Corridor, Dormitory, Extended Care Facilities, Commercial

FEATURES

- 0-10V dimming driver standard (See DRIVER OPTIONS for other dimming types)
- Supports California Title 24 compliance

OPTIONS

- Full customization available upon request
- Additional lumen packages and color temperatures available
- Controls and sensors available (consult factory for sensor options)
- Wireless control options available (See SENSOR OPTIONS for wireless controls)
- Custom colors available (See CUSTOM COLORS For standard and custom options)
- Variety of lenses available (See OPTICAL OPTIONS for lens options)
- Emergency battery pack available (See BATTERY PACK OPTIONS for battery pack options)
- Tunable white available (2700K-6500K)

SPECIFICATIONS

CONSTRUCTION

- 20 ga. cold rolled steel welded housing
- Frameless lift-and-shift lens

FINISH

- Baked white powder coated finish / welded and painted after fabrication / minimum reflectance 90%

OPTICAL

- Frosted flat acrylic lens (2 per fixture)

ELECTRICAL

- High efficiency drivers coupled with long-life LEDs
- Service life tested at 50,000 hours (L70)
- Universal voltage 120V through 277V (347V / 480V available)
- Power Factor (PF) ≥ 0.9
- Total Harmonic Distortion (THD) $\leq 20\%$

LISTING

- UL USA and Canada listed / suitable for damp locations

WARRANTY

- 5-year limited warranty



Los Angeles Lighting Mfg. Co.
Headquarters
10141 Olney Street
El Monte, CA 91731
Made in the USA

Contact Us
T: 626-454-8300
F: 626-454-8399
www.lalighting.com



Due to continued product improvements and enhancements, Los Angeles Lighting Manufacturing Company reserves the right to alter specifications, dimensions, data, and/or materials without notice. Please visit our website to view the most current information.

MADE IN THE U.S.A.

Revised 06-27-19

WARNING

ORDERING INFORMATION

EXAMPLE: ANG050-16-8L-FFA-BPL1.5-DRDM-UNV-1/840

SERIES	LED LUMEN PACKAGE	EFFICACY	NOMINAL LENGTH	OPTICAL	ELECTRICAL	DRIVER	VOLTAGE	# OF LED ROW	CRI / CCT
ANG050			8L			DRDM	UNV	1	
ANG050 Architectural Miniature Angled LED Luminaire	4 Nom. 4000 Lumens 8 Nom. 8000 Lumens 12 Nom. 12000 Lumens 16 Nom. 16000 Lumens *Additional Lumen Packages Available	(Blank) Standard HE High Efficacy (Only 8000 / 12000 lumens Systems)	8L 8'	FFA Frosted Flat Acrylic FPA Frosted Prismatic Acrylic PA Clear Prismatic Acrylic <i>See OPTICAL OPTIONS for Options</i>	BPL1.5 Emergency Battery Pack, Nom. 1500 lm <i>See BATTERY PACK OPTIONS for Options</i> WLC(LED RU) EnOcean Wireless Control <i>See SENSOR OPTIONS for Options</i> *Leave Blank if Not Specified <i>Additional Electrical Options</i>	DRDM 0-10V Dimming Driver <i>See DRIVER OPTIONS for Options</i>	UNV 120V-277V <i>See DRIVER OPTIONS for Options</i>	1 One LED Row	830 80+CRI / 3000K Color Temp. 835 80+CRI / 3500K Color Temp. 840 80+CRI / 4000K Color Temp. 850 80+CRI / 5000K Color Temp. *Additional Color Temp. Available

SYSTEM DATA

THESE ARE THE MOST POPULAR LUMEN PACKAGES. PLEASE CONSULT FACTORY FOR ADDITIONAL SYSTEM DATA.

LED LUMEN PACKAGE	NORMAL AMBIENT TEMPERATURE PRODUCT CODE	DELIVERED LUMENS	SYSTEM WATTS	LUMINAIRE EFFICACY	AMBIENT TEMP.	FLUORESCENT / HID EQUIVALENT	IES FILES
8000 Lumens (Nominal)	ANG050-8-8L-PA-DRDM-UNV-1/840	6457 lm	59.2 W	109.1 lm/W	-20°C / 35°C	2-F32T8, 1-F54T5HO	*
12000 Lumens (Nominal)	ANG050-12-8L-PA-DRDM-UNV-1/840	9991 lm	102.2 W	97.7 lm/W	-20°C / 35°C	3-F32T8	*
16000 Lumens (Nominal)	ANG050-16-8L-PA-DRDM-UNV-1/840	13221 lm	99.2 W	133.3 lm/W	-20°C / 35°C	4-F32T8, 2-F54T5HO, 175 W (MH)	LA-T3440

LED LUMEN PACKAGE	NORMAL AMBIENT TEMPERATURE (HIGH EFFICACY) PRODUCT CODE	DELIVERED LUMENS	SYSTEM WATTS	LUMINAIRE EFFICACY	AMBIENT TEMP.	FLUORESCENT EQUIVALENT	IES FILES
8000 Lumens (Nominal)	ANG050-8-8L-PA-DRDM-UNV-1/840	6526 lm	45.3 W	144.0 lm/W	-20°C / 35°C	2-F32T8, 1-F54T5HO	*
12000 Lumens (Nominal)	ANG050-12-8L-PA-DRDM-UNV-1/840	9858 lm	71.9 W	137.1 lm/W	-20°C / 35°C	3-F32T8	*

NOTE:

System data is based on 120V input voltage. Actual performance may differ as a result of end-user environment and application.

This fixture has been tested and listed in accordance with UL Standards. L.A. Lighting certifies that it will operate safely when installed properly, and within an ambient temperature range noted in the system data table.

Additional lumen packages and color temperatures available.

PERFORMANCE DATA

[VIEW PHOTOMETRICS](#)



Los Angeles Lighting Mfg. Co.
Headquarters
10141 Olney Street
El Monte, CA 91731
Made in the USA

Contact Us
T: 626-454-8300
F: 626-454-8399
www.lalighting.com



Due to continued product improvements and enhancements, Los Angeles Lighting Manufacturing Company reserves the right to alter specifications, dimensions, data, and/or materials without notice. Please visit our website to view the most current information.

MADE IN THE U.S.A.

Revised 06-27-19

WARNING

SENSOR OPTIONS



CONTROLS AND SENSORS

- WLC(LED RU)** - EnOcean® LED Relay Zone Controller
 - Supports a single LED fixture or multiple daisy chained LED fixtures
 - Module installed inside lighting fixture
- ESRPU-W-EO** - EnOcean® Rocker Switch – Single – Surface Mount
 - Wireless single rocker switch with mounting plate
 - No batteries needed
- EDRPU-W-EO** - EnOcean® Rocker Switch – Double – Surface Mount
 - Wireless double rocker switch with mounting plate
 - No batteries needed
- S3054-N300** - EnOcean® Navigan NWC 300U – Commissioning Tool
 - Navigan Wireless Commissioner is used to configure EnOcean controllers & sensors
 - It can be used to define link tables, change parameters/settings, and to edit & store projects
 - Configuration settings can be saved and cloned to enable quick configuration
 - Connectivity is through the NWC 300U USB Stick

- EOSWU-W-EO** - EnOcean® Occupancy Sensor – Wall Mount
 - Wireless wall mounted occupancy sensor
 - Solar powered - no batteries needed (coin battery operated in low light conditions)
 - PIR motion sensor with both wide angle (50') and long range (100') options
 - Mounting height: 6-8 feet
- EOSCU-W-EO** - EnOcean® Occupancy Sensor – Ceiling Mount
 - Wireless ceiling mounted occupancy sensor
 - Solar powered - no batteries needed (coin battery operated in low light conditions)
 - PIR motion sensor with 360 degree viewing angle lens (34' diameter)
 - Mounting height: 7-10 feet
- ELLSU-W-EO** - EnOcean® Light Level Sensor – Ceiling Mount
 - Light Level sensor that measures and reports the level of available natural light
 - Solar powered - no batteries needed (coin battery operated in low light conditions)
 - Enables implementation of daylight harvesting control systems
 - Mounting position: At the ceiling, close to ambient light source

DRIVER OPTIONS

PLEASE CONSULT FACTORY TO SEE IF YOUR SELECTED DRIVER OPTION WORKS WITH THIS FIXTURE.

DRDM - UNV

* Normal Stock Item

VOLTAGE

- 120V 120 Volt
- 277V 277 Volt
- UNV* Universal 120-277 Volt
- 347V 347 Volt
- 480V 480 Volt

DRIVER TYPE

- DRDM* 0-10V Dimming Driver
- DRDM1 0-10V Dimming Driver, 1% Dimming
- DRDM2C 2-Channel 0-10V Dimming Driver (for Color Tunable White)
- DR2W 2-Wire Phase Dimming Driver
- DRDA Digital Addressable DALI Dimming Driver
- DRDA2C Digital Addressable DALI Type8 2-Channel Driver (for Color Tunable White)
- DRDA2.0 Digital Addressable DALI 2.0 Dimming Driver
- DRDA2.02C Digital Addressable DALI 2.0 Type8 2-Channel Driver (for Color Tunable White)
- DRSD Step Dimming Driver
- DR(LTEA2W) Lutron® 2-Wire 1% Dimming Driver (120V Forward Phase only)
- DR(LDE1) Lutron® EcoSystem 1% Soft-On, Fade-to-Black™ Dimming Driver
- DR(LDE5) Lutron® EcoSystem 5% Dimming Driver
- DR(PEQ0) Lutron® EcoSystem 0.1% Soft-On, Fade-to-Black Dimming Driver
- DR(PSQ0) Lutron® T-Series Digital 1% Dimming 2-Channel Driver (for Color Tunable White)

OF DRIVERS SPECIFIED

(Blank) Not Specified
Number of Drivers Specified per Lighting Fixture

BATTERY PACK OPTIONS

PLEASE CONSULT FACTORY TO SEE IF YOUR SELECTED BATTERY PACK OPTION WORKS WITH THIS FIXTURE.

BPL

LUMEN PACKAGE

- 0.7 Nominal 750 Lumens
- 1.5 Nominal 1500 Lumens
- 3.0 Nominal 3000 Lumens

*Additional lumen packages available

TYPE

- (Blank) Normal Ambient Temp. / Standard Operation
- C Cold Environment (-20°C)
- F With Flex for Remote Mounting
- SL Slim Casing
- ST Self Test / Diagnostic

*Additional options available



Los Angeles Lighting Mfg. Co.
Headquarters
10141 Olney Street
El Monte, CA 91731
Made in the USA

Contact Us
T: 626-454-8300
F: 626-454-8399
www.lalighting.com



Due to continued product improvements and enhancements, Los Angeles Lighting Manufacturing Company reserves the right to alter specifications, dimensions, data, and/or materials without notice. Please visit our website to view the most current information.

MADE IN THE U.S.A.

Revised 06-27-19

WARNING

OPTICAL OPTIONS

STANDARD LENSES FOR ANG050

FFA	Frosted Flat Acrylic, No Thickness Specified
FPA	Frosted Prismatic Acrylic, No Thickness Specified, Female Prisms 3/16 Square Base
PA	Clear Prismatic Acrylic, No Thickness Specified, Female Prisms 3/16 Square Base

[CLICK HERE FOR FULL OPTICAL OPTIONS LIST](#)

CUSTOM COLORS

- BLK - Matte Black
- CS - Camaro Silver
- BZ - Statuary Bronze

Variety of [RAL colors](#) & [Axalta/DuPont colors](#) available upon request.



Los Angeles Lighting Mfg. Co.
 Headquarters
 10141 Olney Street
 El Monte, CA 91731
 Made in the USA

Contact Us
 T: 626-454-8300
 F: 626-454-8399
www.lalighting.com



Due to continued product improvements and enhancements, Los Angeles Lighting Manufacturing Company reserves the right to alter specifications, dimensions, data, and/or materials without notice. Please visit our website to view the most current information.

MADE IN THE U.S.A.

Revised 06-27-19

WARNING

PHOTOMETRIC DATA - ANG050_8FT SERIES

ANG050-16-8L-PA-DRDM-UNV-1/840

TEST NO.=LA-T3440
 LED TYPE=40 LED MODULE
 NO. OF MODULE=4
 SYSTEM WATT (W)=99.2
 CRI ≥ 80
 L70(Hrs.) ≥ 50,000
 PHOTOMETRY TYPE=C

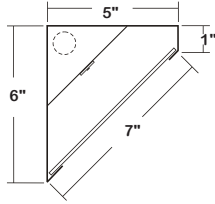
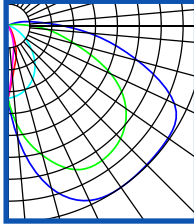

CANDLEPOWER

ANGLE	END	45	90	135	CROSS
0	2658	2658	2658	2658	2658
5	4115	3589	2608	1905	1657
15	6163	4911	2438	1165	822
25	7061	5812	2144	552	271
35	7227	6020	1730	226	63
45	7198	5841	1266	66	2
55	7169	5283	745	10	0
65	6736	4172	383	1	0
75	4938	2553	161	0	0
85	2996	1434	64	0	0
90	2039	894	27	0	0
95	1319	517	9	0	0
115	606	214	1	0	0
125	198	57	0	0	0
135	40	5	0	0	0
145	1	0	0	0	0
155	0	0	0	0	0
165	0	0	0	0	0
175	0	0	0	0	0
180	0	0	0	0	0

ZONAL LUMEN SUMMARY

DEGREES	LUMENS	% LAMP	% FIXTURE
0-30	2521	16	19
0-40	4346	27	33
0-60	8583	53	65
0-90	12665	78	96
90-120	551	3	4
90-150	557	3	4
90-180	557	3	4
0-180	13221	82	100

Luminaire Output= 13221.2 lumens
 Luminaire Efficacy = 133.3 lm/W
 Luminaire Efficiency = 81.57%

SPACING CRITERION

ALONG	ACROSS
2.86	1.10

