



# RECESSED LED

## GDD320 (2X4) SERIES (2X2 AVAILABLE)

DIRECT ILLUMINATED DUAL LENSED GRID LUMINAIRE



DATE	
JOB	

WWW.LALIGHTING.COM  
626-454-8300

### RECESSED MOUNTED LED LUMINAIRE FOR INVERTED T-BAR CEILINGS

### DIMENSIONS

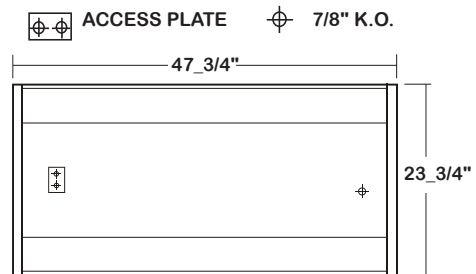
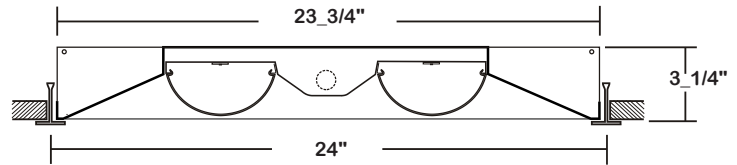
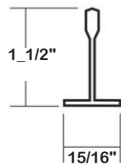

### APPLICATIONS

- Commercial, Office, Classroom

### FEATURES

- 0-10V dimming driver standard (See *DRIVER OPTIONS* for other dimming types)
- Supports California Title 24 compliance

### OPTIONS

- Full customization available upon request
- Additional lumen packages and color temperatures available
- Controls and sensors available (See *SENSOR OPTIONS* for controls and sensors)
- Wireless control options available (See *SENSOR OPTIONS* for wireless controls)
- Emergency battery pack available (See *BATTERY PACK OPTIONS* for battery pack options)
- Tunable white available (2700K-6500K)

### SPECIFICATIONS

#### CONSTRUCTION

- 22 ga. cold rolled steel housing and reflector

#### FINISH

- High reflectance low gloss matte white finish

#### OPTICAL

- 2x frosted radial lenses to maximize lumen output while cutting glare

#### ELECTRICAL

- High efficiency drivers coupled with long-life LEDs
- Service life greater than 50,000 hours (L70)
- Universal voltage 120V through 277V (347V / 480V available)
- Power Factor (PF)  $\geq 0.9$
- Total Harmonic Distortion (THD)  $\leq 20\%$

#### LISTING

- UL USA and Canada listed / suitable for damp locations

#### WARRANTY

- 5-year limited warranty



**Los Angeles Lighting Mfg. Co.**  
Headquarters  
10141 Olney Street  
El Monte, CA 91731  
Made in the USA

Contact Us  
T: 626-454-8300  
F: 626-454-8399  
www.lalighting.com



Due to continued product improvements and enhancements, Los Angeles Lighting Manufacturing Company reserves the right to alter specifications, dimensions, data, and/or materials without notice. Please visit our website to view the most current information.

**MADE IN THE U.S.A.**

Revised 02-08-19

**WARNING**

ORDERING INFORMATION

EXAMPLE: GDD320-4-4L-BPL10-DRDM-UNV-2/840

SERIES	LED LUMEN PACKAGE	EFFICACY	NOMINAL LENGTH	ELECTRICAL	DRIVER	VOLTAGE	# OF LED ROW	CRI / CCT
<b>GDD320</b>			<b>4L</b>		<b>DRDM</b>	<b>UNV</b>	<b>2</b>	
<b>GDD320</b> Direct Illuminated Dual Lensed Grid LED Luminaire	4 Nom. 4000 Lumens 6 Nom. 6000 Lumens 8 Nom. 8000 Lumens 12 Nom. 12000 Lumens  *Additional Lumen Packages Available	(Blank) Standard  <b>HE</b> High Efficacy	<b>4L</b> 2' x 4'	<b>BPL10</b> Emergency Battery Pack, Constant 10W Nom. 1500 lm  <u>See BATTERY PACK OPTIONS for Options</u>  <b>MSxx</b> Motion Sensor Infrared  <b>WLC(xxxxx)</b> Wireless Control  <u>See SENSOR OPTIONS for Options</u>  *Leave Blank if Not Specified  <u>Additional Electrical Options</u>	<b>DRDM</b> 0-10V Dimming Driver  <u>See DRIVER OPTIONS for Options</u>	<b>UNV</b> 120V-277V  <u>See DRIVER OPTIONS for Options</u>	<b>2</b> Two LED Rows	<b>830</b> 80+CRI / 3000K Color Temp.  <b>835</b> 80+CRI / 3500K Color Temp.  <b>840</b> 80+CRI / 4000K Color Temp.  <b>850</b> 80+CRI / 5000K Color Temp.  *Additional Color Temp. Available

SYSTEM DATA

THESE ARE THE MOST POPULAR LUMEN PACKAGES. PLEASE CONSULT FACTORY FOR ADDITIONAL SYSTEM DATA.

LED LUMEN PACKAGE	NORMAL AMBIENT TEMPERATURE PRODUCT CODE	DELIVERED LUMENS	SYSTEM WATTS	LUMINAIRE EFFICACY	AMBIENT TEMP.	FLUORESCENT / HID EQUIVALENT	IES FILES
4000 Lumens (Nominal)	GDD320-4-4L-DRDM-UNV-2/840	3387 lm	28.5 W	118.8 lm/W	-20°C / 35°C	2-F32T8, 1-F54T5HO	<a href="#">LA-T3381</a>
6000 Lumens (Nominal)	GDD320-6-4L-DRDM-UNV-2/840	5119 lm	45.7 W	112.0 lm/W	-20°C / 35°C	3-F32T8	*
8000 Lumens (Nominal)	GDD320-8-4L-DRDM-UNV-2/840	6767 lm	63.6 W	106.4 lm/W	-20°C / 35°C	4-F32T8, 2-F54T5HO	*
12000 Lumens (Nominal)	GDD320-12-4L-DRDM-UNV-2/840	10056 lm	104.6 W	96.1 lm/W	-20°C / 35°C	6-F32T8, 3-F54T5HO, 250 W (MH)	*

LED LUMEN PACKAGE	NORMAL AMBIENT TEMPERATURE (HIGH EFFICACY) PRODUCT CODE	DELIVERED LUMENS	SYSTEM WATTS	LUMINAIRE EFFICACY	AMBIENT TEMP.	FLUORESCENT / HID EQUIVALENT	IES FILES
4000 Lumens (Nominal)	GDD320-4HE-4L-DRDM-UNV-2/840	3324 lm	22.5 W	147.6 lm/W	-20°C / 35°C	2-F32T8, 1-F54T5HO	*
6000 Lumens (Nominal)	GDD320-6HE-4L-DRDM-UNV-2/840	5510 lm	38.3 W	143.8 lm/W	-20°C / 35°C	3-F32T8	*
8000 Lumens (Nominal)	GDD320-8HE-4L-DRDM-UNV-2/840	6567 lm	46.4 W	141.6 lm/W	-20°C / 35°C	4-F32T8, 2-F54T5HO	*
12000 Lumens (Nominal)	GDD320-12HE-4L-DRDM-UNV-2/840	9922 lm	73.6 W	134.8 lm/W	-20°C / 35°C	6-F32T8, 3-F54T5HO, 250 W (MH)	*

**NOTE:**  
System data is based on 120V input voltage. Actual performance may differ as a result of end-user environment and application.

This fixture has been tested and listed in accordance with UL Standards. L.A. Lighting certifies that it will operate safely when installed properly, and within an ambient temperature range noted in the system data table.

Additional lumen packages and color temperatures available.

PERFORMANCE DATA

[VIEW PHOTOMETRICS](#)



**Los Angeles Lighting Mfg. Co.**  
Headquarters  
10141 Olney Street  
El Monte, CA 91731  
Made in the USA

Contact Us  
T: 626-454-8300  
F: 626-454-8399  
www.lalighting.com



Due to continued product improvements and enhancements, Los Angeles Lighting Manufacturing Company reserves the right to alter specifications, dimensions, data, and/or materials without notice. Please visit our website to view the most current information.

**MADE IN THE U.S.A.**

Revised 02-08-19  
**WARNING**

**SENSOR OPTIONS**

**INFRARED MOTION SENSOR**

**MS (LOWE)**

	LENS	SHAPE	MOUNTING HEIGHT		COVERAGE
(LOWE)	Extra Wide	Cone	8~10 ft	2.4~3.0m	6X Height
(HI)	High Bay	Cone	15~30 ft	4.5~9.0m	3X Height
(LOW)	Standard	Round	8~20 ft	2.4~6.0m	2X Height
(AIL)	Aisle Way	Arch	8~40 ft	2.4~12.0m	3X Height

- MS** Turns light ON/OFF based on motion detection
- MSPC** Holds lights OFF when sufficient daylight is present regardless of motion detection
- MSPCD** Variably Dims output to desired footcandles through photocell. Low setting when unoccupied. Full on with motion.

**LUTRON. CONTROLS AND SENSORS**

**WLC(FCJS0) - Lutron® Vive PowPak® 0-10V Wireless Fixture Control**

- One per fixture (external mount)
- Controls 1A of load or up to 3 drivers
- Universal Voltage (120V-277V)

**WLC(FCJSE) - Lutron® Vive PowPak® EcoSystem Wireless Fixture Control**

- One per fixture (external mount)
- Controls 1A of load or up to 3 drivers
- Universal Voltage (120V-277V)
- \*Must specify Lutron® Vive compatible driver*

**WLC(VDO) - Lutron® Wireless Fixture Sensor**

- Need Dexal driver
- One per fixture
- Turn light on/off based on motion
- 15 minutes time delay default
- Daylight sensor provide linear response to changes in light level.
- Up to 300 sq.ft major motion coverage and 150 sq.ft. minor motion coverage based on 9' mounting height.
- Work standalone or with Vive wireless control system
- Work with driver has integrated self-powered DALI link or Lutron EcoSystem driver (additional Lutron® digital link interface required)

**WLC(VRF) - Lutron® Wireless Fixture Control**

- Need Dexal driver
- One per fixture
- Wireless control module
- Work with Vive wireless control system
- Work with driver has integrated self-powered DaLI link or Lutron EcoSystem driver (additional Lutron® digital link interface required)

**PJ2-2BRL - Lutron® Pico® 2-Button Wireless Remote**

- Works with Wireless Fixture Controls
- Controls ON/OFF and dimming UP/DOWN

**FC-SENSOR - Lutron® PowPak® Occupancy/Daylight Sensor**

- Turns light ON/OFF based on motion
- Recommended mounting height of 8-12'
- For dry and damp locations
- Universal Voltage (120V-277V)

**FC-VSENSOR - Lutron® PowPak® Vacancy/Daylight Sensor**

- Turns light OFF when area is vacant
- Recommended mounting height of 8-12'
- For dry and damp locations
- Universal Voltage (120V-277V)



**CONTROLS AND SENSORS**

**WLC(LED RU) - EnOcean® LED Relay Zone Controller**

- Supports a single LED fixture or multiple daisy chained LED fixtures
- Module installed inside lighting fixture

**ESRPU-W-EO - EnOcean® Rocker Switch – Single – Surface Mount**

- Wireless single rocker switch with mounting plate
- No batteries needed

**EDRPU-W-EO - EnOcean® Rocker Switch – Double – Surface Mount**

- Wireless double rocker switch with mounting plate
- No batteries needed

**S3054-N300 - EnOcean® Navigan NWC 300U – Commissioning Tool**

- Navigan Wireless Commissioner is used to configure EnOcean controllers & sensors
- It can be used to define link tables, change parameters/settings, and to edit & store projects
- Configuration settings can be saved and cloned to enable quick configuration
- Connectivity is through the NWC 300U USB Stick

**EOSWU-W-EO - EnOcean® Occupancy Sensor – Wall Mount**

- Wireless wall mounted occupancy sensor
- Solar powered - no batteries needed (coin battery operated in low light conditions)
- PIR motion sensor with both wide angle (50') and long range (100') options
- Mounting height: 6-8 feet

**EOSCU-W-EO - EnOcean® Occupancy Sensor – Ceiling Mount**

- Wireless ceiling mounted occupancy sensor
- Solar powered - no batteries needed (coin battery operated in low light conditions)
- PIR motion sensor with 360 degree viewing angle lens (34' diameter)
- Mounting height: 7-10 feet

**ELLSU-W-EO - EnOcean® Light Level Sensor – Ceiling Mount**

- Light Level sensor that measures and reports the level of available natural light
- Solar powered - no batteries needed (coin battery operated in low light conditions)
- Enables implementation of daylight harvesting control systems
- Mounting position: At the ceiling, close to ambient light source



**Los Angeles Lighting Mfg. Co.**  
 Headquarters  
 10141 Olney Street  
 El Monte, CA 91731  
 Made in the USA

Contact Us  
 T: 626-454-8300  
 F: 626-454-8399  
 www.lalighting.com



Due to continued product improvements and enhancements, Los Angeles Lighting Manufacturing Company reserves the right to alter specifications, dimensions, data, and/or materials without notice. Please visit our website to view the most current information.

**MADE IN THE U.S.A.**

Revised 02-08-19

**WARNING**

**DRIVER OPTIONS**

PLEASE CONSULT FACTORY TO SEE IF YOUR SELECTED DRIVER OPTION WORKS WITH THIS FIXTURE.

**DRDM – UNV**

\* Normal Stock Item

**VOLTAGE**

- 120V** 120 Volt
- 277V** 277 Volt
- UNV\*** Universal 120-277 Volt
- 347V** 347 Volt
- 480V** 480 Volt

**DRIVER TYPE**

- DRDM\*** 0-10V Dimming Driver
- DRDM1** 0-10V Dimming Driver, 1% Dimming
- DRDM2C** 2-Channel 0-10V Dimming Driver (for Color Tunable White)
- DR2W** 2-Wire Phase Dimming Driver
- DRDA** Digital Addressable DALI Dimming Driver
- DRDA2C** Digital Addressable DALI Type8 2-Channel Driver (for Color Tunable White)
- DRDA2.0** Digital Addressable DALI 2.0 Dimming Driver
- DRDA2.02C** Digital Addressable DALI 2.0 Type8 2-Channel Driver (for Color Tunable White)
- DRSD** Step Dimming Driver
- DR(LTEA2W)** Lutron® 2-Wire 1% Dimming Driver (120V Forward Phase only)
- DR(LDE1)** Lutron® EcoSystem 1% Soft-On, Fade-to-Black™ Dimming Driver
- DR(LDE5)** Lutron® EcoSystem 5% Dimming Driver
- DR(PEQ0)** Lutron® EcoSystem 0.1% Soft-On, Fade-to-Black Dimming Driver
- DR(PSQ0)** Lutron® T-Series Digital 1% Dimming 2-Channel Driver (for Color Tunable White)

**# OF DRIVERS SPECIFIED**

- (Blank)** Not Specified
- #** Number of Drivers Specified per Lighting Fixture

**BATTERY PACK OPTIONS**

PLEASE CONSULT FACTORY TO SEE IF YOUR SELECTED BATTERY PACK OPTION WORKS WITH THIS FIXTURE.

**BPL**

**OUTPUT WATTAGE**

- 5** Constant 5W, Nominal 750 Lumens
- 10** Constant 10W, Nominal 1500 Lumens\*
- 15** Constant 15W, Nominal 2250 Lumens
- 20** Constant 20W, Nominal 3000 Lumens

\*Note: 10W standard when wattage is not specified

**TYPE**

- (Blank)** Normal Ambient Temp. / Standard Operation
- C** Cold Environment
- F** With Flex for Remote Mounting
- SL** Slim Casing
- ST** Self Test / Diagnostic



**Los Angeles Lighting Mfg. Co.**  
 Headquarters  
 10141 Olney Street  
 El Monte, CA 91731  
 Made in the USA

Contact Us  
 T: 626-454-8300  
 F: 626-454-8399  
 www.lalighting.com



Due to continued product improvements and enhancements, Los Angeles Lighting Manufacturing Company reserves the right to alter specifications, dimensions, data, and/or materials without notice. Please visit our website to view the most current information.

**MADE IN THE U.S.A.**

Revised 02-08-19

**WARNING**

**PHOTOMETRIC DATA - GDD320 SERIES - 4FT**

**GDD320-4-4L-1DRDM-UNV-2/840**

TEST NO. = LA-T3381  
 LED TYPE = 48 LED MODULE  
 NO. OF MODULE = 4  
 SYSTEM WATT (W) = 28.5  
 CRI ≥ 80  
 L70(Hrs.) ≥ 50,000  
 PHOTOMETRY TYPE = C

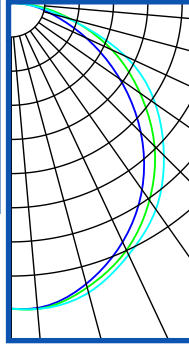

**CANDLEPOWER**

ANGLE	END	45	CROSS
0	1197	1197	1197
5	1199	1203	1203
15	1139	1153	1174
25	1032	1068	1088
35	893	943	987
45	718	793	845
55	520	616	688
65	326	436	494
75	165	240	226
85	60	75	54
90	4	3	2
95	0	0	0
105	0	0	0
115	0	0	0
125	0	0	0
135	0	0	0
145	0	0	0
155	0	0	0
165	0	0	0
175	0	0	0
180	0	0	0

**ZONAL LUMEN SUMMARY**

DEGREES	LUMENS	% LAMP	% FIXTURE
0-30	935	23	28
0-40	1526	37	45
0-60	2683	65	79
0-90	3388	82	100
90-120	1	0	0
90-150	1	0	0
90-180	1	0	0
0-180	3389	82	100

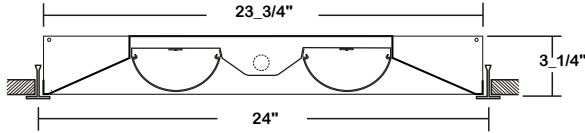

Luminaire Output = 3388.8 lm  
 Luminaire Efficacy = 118.9 lm/W

**SPACING CRITERION**

ALONG	ACROSS
1.19	1.29

This Space is intentionally left blank.

This Space is intentionally left blank.

This Space is intentionally left blank.

