



WET LOCATION

GWL310 (1X4) SERIES

WET LOCATION GRID LUMINAIRE

LED

DATE

JOB

WWW.LALIGHTING.COM
626-454-8300

RECESSED MOUNTED WET LOCATION LED LUMINAIRE FOR 1" OR 1_1/2" WIDE INVERTED T-BAR CEILINGS

DIMENSIONS

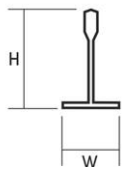

T-BAR SIZING

| WIDTH | HEIGHT |
|--------|--------|
| 15/16" | 1_1/2" |
| 1_1/2" | 1_1/2" |
| 1_1/2" | 2" |

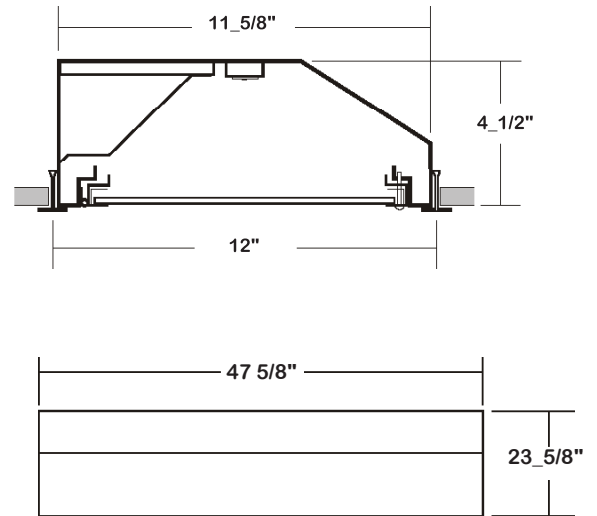

APPLICATIONS

- Wet Location, Covered Ceiling, Commercial

FEATURES

- Wet location (UL listed with sprinkler test)
- 0-10V dimming driver standard (See *DRIVER OPTIONS* for other dimming types)
- Supports California Title 24 compliance

OPTIONS

- Full customization available upon request
- Additional lumen packages and color temperatures available
- Wireless control options available (See *SENSOR OPTIONS* for wireless controls)
- Variety of lenses available (See *OPTICAL OPTIONS* for lenses)
- Emergency battery pack available (See *BATTERY PACK OPTIONS* for battery pack options)
- Antimicrobial finished housing and door frame available
- Tamper proof screws available
- Tunable white available (2700K-6500K)

SPECIFICATIONS

CONSTRUCTION

- 22 ga. electro-galvanized steel welded housing
- All parts fitted and sealed, no unused holes or knockouts
- 20 ga. electro-galvanized steel door frame secured by full length piano hinge and 2 captive screws
- Door frame and lens sealed with closed cell neoprene gasket

FINISH

- Baked white powder coated finish / welded and painted after fabrication / minimum reflectance 90%

OPTICAL

- Inverted clear prismatic acrylic lens (nominal 0.125) standard

ELECTRICAL

- High efficiency drivers coupled with long-life LEDs
- Service life greater than 50,000 hours (L70)
- Universal voltage 120V through 277V (347V / 480V available)
- Power Factor (PF) ≥ 0.9
- Total Harmonic Distortion (THD) $\leq 20\%$

LISTING

- UL USA and Canada listed / suitable for wet locations / UL listed with sprinkler test

WARRANTY

- 5-year limited warranty



Los Angeles Lighting Mfg. Co.

Contact Us
T: 626-454-8300
F: 626-454-8399
www.lalighting.com

10141 Olney Street
El Monte, CA 91731
Made in the USA



Due to continued product improvements and enhancements, Los Angeles Lighting Manufacturing Company reserves the right to alter specifications, dimensions, data, and/or materials without notice. Please visit our website to view the most current information.

© 2022 LOS ANGELES LIGHTING MANUFACTURING CO. ALL RIGHTS RESERVED.

Revised: 07/11/19



ORDERING INFORMATION

EXAMPLE: GWL310-4-4L-FSW-PA2-DRDM-UNV-1/840

| SERIES | LED LUMEN PACKAGE | EFFICACY | NOMINAL LENGTH | FINISH | DOOR FRAME | OPTICAL | MECHANICAL | ELECTRICAL | DRIVER | VOLTAGE | # OF LED ROW | CRI / CCT |
|--|---|---|----------------------|---|---|--|--|---|---|---|----------------------------|--|
| GWL310 | | | 4L | | | | | | DRDM | UNV | 1 | |
| GWL310 Wet Location Grid LED Luminaire | 2 Nom. 2000 Lumens 4 Nom. 4000 Lumens 6 Nom. 6000 Lumens 8 Nom. 8000 Lumens *Additional Lumen Packages Available | (Blank) Standard HE High Efficacy (Only 2000 / 4000 / 6000 lumens Systems) | 4L 1' x 4' | AMF Antimicrobial Finished Housing and Door Frame *Leave Blank if Not Specified | FSW Flat Steel White Enamel Door Frame See DOOR FRAME for Options | PA2 Clear Prismatic Acrylic 0.125 Nominal DRP8 High Impact Clear Prismatic Acrylic 0.187 Nominal FPA2 Frosted Prismatic Acrylic 0.125 Nominal See OPTICAL OPTIONS for Options | TP Tamper Proof Screws (Hex Socket with Post) *Leave Blank if Not Specified <i>Additional Mechanical Options</i> | BPL1.5 Emergency Battery Pack, Nom. 1500 lm See BATTERY PACK OPTIONS for Options WLC(LEDPU) EnOcean Wireless Control See SENSOR OPTIONS for Options *Leave Blank if Not Specified <i>Additional Electrical Options</i> | DRDM 0-10V Dimming Driver See DRIVER OPTIONS for Options | UNV 120V-277V See DRIVER OPTIONS for Options | 1 One LED Row | 830 80+CRI / 3000K Color Temp. 835 80+CRI / 3500K Color Temp. 840 80+CRI / 4000K Color Temp. 850 80+CRI / 5000K Color Temp. *Additional Color Temp. Available |

SYSTEM DATA

THESE ARE THE MOST POPULAR LUMEN PACKAGES. PLEASE CONSULT FACTORY FOR ADDITIONAL SYSTEM DATA.

| LED LUMEN PACKAGE | NORMAL AMBIENT TEMPERATURE PRODUCT CODE | DELIVERED LUMENS | SYSTEM WATTS | LUMINAIRE EFFICACY | AMBIENT TEMP. | FLUORESCENT EQUIVALENT | IES FILES |
|-----------------------|---|------------------|--------------|--------------------|---------------|------------------------|------------|
| 2000 Lumens (Nominal) | GWL310-2-4L-FSW-PA2-DRDM-UNV-1/840 | 1580 lm | 15.7 W | 100.5 lm/W | -20°C / 35°C | 1-F32T8 | * |
| 4000 Lumens (Nominal) | GWL310-4-4L-FSW-PA2-DRDM-UNV-1/840 | 3018 lm | 33.1 W | 91.1 lm/W | -20°C / 35°C | 2-F32T8, 1-F54T5HO | LA-T3192-6 |
| 6000 Lumens (Nominal) | GWL310-6-4L-FSW-PA2-DRDM-UNV-1/840 | 4314 lm | 52.3 W | 82.4 lm/W | -20°C / 35°C | 3-F32T8 | * |
| 8000 Lumens (Nominal) | GWL310-8-4L-FSW-PA2-DRDM-UNV-1/840 | 5826 lm | 53.8 W | 108.3 lm/W | -20°C / 35°C | 4-F32T8, 2-F54T5HO | * |

| LED LUMEN PACKAGE | NORMAL AMBIENT TEMPERATURE (HIGH EFFICACY) PRODUCT CODE | DELIVERED LUMENS | SYSTEM WATTS | LUMINAIRE EFFICACY | AMBIENT TEMP. | FLUORESCENT EQUIVALENT | IES FILES |
|-----------------------|---|------------------|--------------|--------------------|---------------|------------------------|-----------|
| 2000 Lumens (Nominal) | GWL310-2HE-4L-FSW-PA2-DRDM-UNV-1/840 | 1498 lm | 12.7 W | 118.0 lm/W | -20°C / 35°C | 1-F32T8 | * |
| 4000 Lumens (Nominal) | GWL310-4HE-4L-FSW-PA2-DRDM-UNV-1/840 | 2983 lm | 25.9 W | 115.1 lm/W | -20°C / 35°C | 2-F32T8, 1-F54T5HO | * |
| 6000 Lumens (Nominal) | GWL310-6HE-4L-FSW-PA2-DRDM-UNV-1/840 | 4425 lm | 39.6 W | 111.7 lm/W | -20°C / 35°C | 3-F32T8 | * |

NOTE:

System data is based on 120V input voltage. Actual performance may differ as a result of end-user environment and application.

This fixture has been tested and listed in accordance with UL Standards. L.A. Lighting certifies that it will operate safely when installed properly, and within an ambient temperature range noted in the system data table.

Additional lumen packages and color temperatures available.

PERFORMANCE DATA

VIEW PHOTOMETRICS



Los Angeles Lighting Mfg. Co.

Contact Us

T: 626-454-8300

F: 626-454-8399

www.lalighting.com

10141 Olney Street

El Monte, CA 91731

Made in the USA



Due to continued product improvements and enhancements, Los Angeles Lighting Manufacturing Company reserves the right to alter specifications, dimensions, data, and/or materials without notice.
Please visit our website to view the most current information.

© 2022 LOS ANGELES LIGHTING MANUFACTURING CO. ALL RIGHTS RESERVED.

Revised: 07/11/19

MADE IN THE USA
BAA Compliant

SENSOR OPTIONS**CONTROLS AND SENSORS****WLC(LED RU) - EnOcean® LED Relay Zone Controller**

- Supports a single LED fixture or multiple daisy chained LED fixtures
- Module installed inside lighting fixture

ESRPU-W-EO - EnOcean® Rocker Switch – Single – Surface Mount

- Wireless single rocker switch with mounting plate
- No batteries needed

EDRPU-W-EO - EnOcean® Rocker Switch – Double – Surface Mount

- Wireless double rocker switch with mounting plate
- No batteries needed

S3054-N300 - EnOcean® Navigan NWC 300U – Commissioning Tool

- Navigan Wireless Commissioner is used to configure EnOcean controllers & sensors
- It can be used to define link tables, change parameters/settings, and to edit & store projects
- Configuration settings can be saved and cloned to enable quick configuration
- Connectivity is through the NWC 300U USB Stick

EOSWU-W-EO - EnOcean® Occupancy Sensor – Wall Mount

- Wireless wall mounted occupancy sensor
- Solar powered - no batteries needed (coin battery operated in low light conditions)
- PIR motion sensor with both wide angle (50') and long range (100') options
- Mounting height: 6-8 feet

EOSCU-W-EO - EnOcean® Occupancy Sensor – Ceiling Mount

- Wireless ceiling mounted occupancy sensor
- Solar powered - no batteries needed (coin battery operated in low light conditions)
- PIR motion sensor with 360 degree viewing angle lens (34' diameter)
- Mounting height: 7-10 feet

ELLSU-W-EO - EnOcean® Light Level Sensor – Ceiling Mount

- Light Level sensor that measures and reports the level of available natural light
- Solar powered - no batteries needed (coin battery operated in low light conditions)
- Enables implementation of daylight harvesting control systems
- Mounting position: At the ceiling, close to ambient light source

DRIVER OPTIONS

PLEASE CONSULT FACTORY TO SEE IF YOUR SELECTED DRIVER OPTION WORKS WITH THIS FIXTURE.

DRDM – UNV

* Normal Stock Item

VOLTAGE

120V 120 Volt
277V 277 Volt
UNV* Universal 120-277 Volt
347V 347 Volt
480V 480 Volt

DRIVER TYPE

DRDM* 0-10V Dimming Driver
DRDM1 0-10V Dimming Driver, 1% Dimming
DRDM2C 2-Channel 0-10V Dimming Driver (for Color Tunable White)
DR2W 2-Wire Phase Dimming Driver
DRDA Digital Addressable DALI Dimming Driver
DRDA2C Digital Addressable DALI Type8 2-Channel Driver (for Color Tunable White)
DRDA2.0 Digital Addressable DALI 2.0 Dimming Driver
DRDA2.02C Digital Addressable DALI 2.0 Type8 2-Channel Driver (for Color Tunable White)
DRSD Step Dimming Driver
DR(LTEA2W) Lutron® 2-Wire 1% Dimming Driver (120V Forward Phase only)
DR(LDE1) Lutron® EcoSystem 1% Soft-On, Fade-to-Black™ Dimming Driver
DR(LDE5) Lutron® EcoSystem 5% Dimming Driver
DR(PEQ0) Lutron® EcoSystem 0.1% Soft-On, Fade-to-Black Dimming Driver
DR(PSQ0) Lutron® T-Series Digital 1% Dimming 2-Channel Driver (for Color Tunable White)

OF DRIVERS SPECIFIED

(Blank) Not Specified
Number of Drivers Specified per Lighting Fixture

BATTERY PACK OPTIONS

PLEASE CONSULT FACTORY TO SEE IF YOUR SELECTED BATTERY PACK OPTION WORKS WITH THIS FIXTURE.

BPL**LUMEN PACKAGE**

0.7 Nominal 750 Lumens
1.5 Nominal 1500 Lumens
3.0 Nominal 3000 Lumens

*Additional lumen packages available

TYPE

(Blank) Normal Ambient Temp. / Standard Operation
C Cold Environment (-20°C)
F With Flex for Remote Mounting
SL Slim Casing
ST Self Test / Diagnostic

*Additional options available



Los Angeles Lighting Mfg. Co.

Contact Us
 T: 626-454-8300 10141 Olney Street
 F: 626-454-8399 El Monte, CA 91731
 www.lalighting.com Made in the USA



Due to continued product improvements and enhancements, Los Angeles Lighting Manufacturing Company reserves the right to alter specifications, dimensions, data, and/or materials without notice. Please visit our website to view the most current information.

© 2022 LOS ANGELES LIGHTING MANUFACTURING CO. ALL RIGHTS RESERVED.

Revised: 07/11/19



MADE IN THE USA
 BAA Compliant

OPTICAL OPTIONS

STANDARD LENSES FOR GWL310

| | |
|------|--|
| PA2 | Clear Prismatic Acrylic, Nom. 0.125 OA Thickness, Female Prisms 3/16 Square Base |
| DRP8 | High Impact Clear Prismatic Acrylic, Nom. 0.187 OA Thickness, Female Prisms 3/16 Square Base |
| FPA2 | Frosted Prismatic Acrylic, Nom. 0.125 OA Thickness |

[CLICK HERE FOR FULL OPTICAL OPTIONS LIST](#)

DOOR FRAME

CROSS SECTION

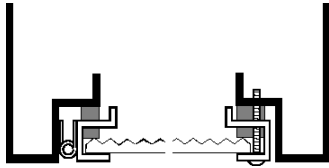

FEATURES

- Full Length Piano Hinge
- Inverted Lens
- Two 10-24 Captive Machine Screws
- Sealed with Closed Cell Neoprene Gasket

FS W

FINISHES

- W White Enamel
- B Black Enamel

STYLES

- FS Flat Steel



Los Angeles Lighting Mfg. Co.
Contact Us
T: 626-454-8300 10141 Olney Street
F: 626-454-8399 El Monte, CA 91731
www.lalighting.com Made in the USA



Due to continued product improvements and enhancements, Los Angeles Lighting Manufacturing Company reserves the right to alter specifications, dimensions, data, and/or materials without notice. Please visit our website to view the most current information.

© 2022 LOS ANGELES LIGHTING MANUFACTURING CO. ALL RIGHTS RESERVED.

Revised: 07/11/19



PHOTOMETRIC DATA - GWL310 SERIES

GWL310-4-4L-FSW-PA2-DRDM-UNV-1/840

TEST NO.=LA-T3192-6
LED TYPE=48 LED MODULE
NO. OF MODULE=2
SYSTEM WATT (W)=33.1
CRI ≥ 80
L70(Hrs.) ≥ 50,000
PHOTOMETRY TYPE=C

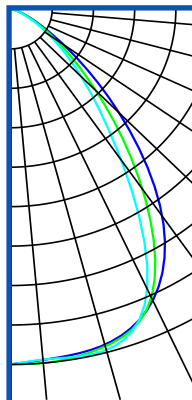
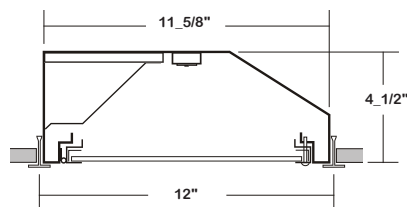

CANDLEPOWER

| ANGLE | END | 45 | CROSS |
|-------|------|------|-------|
| 0 | 1835 | 1835 | 1835 |
| 5 | 1819 | 1836 | 1817 |
| 15 | 1795 | 1803 | 1824 |
| 25 | 1661 | 1644 | 1595 |
| 35 | 1305 | 1134 | 950 |
| 45 | 756 | 595 | 492 |
| 55 | 317 | 267 | 231 |
| 65 | 109 | 98 | 85 |
| 75 | 36 | 32 | 24 |
| 85 | 16 | 7 | 2 |
| 90 | 4 | 2 | 0 |
| 95 | 3 | 2 | 0 |
| 115 | 3 | 2 | 0 |
| 125 | 3 | 1 | 0 |
| 135 | 3 | 1 | 0 |
| 145 | 1 | 0 | 0 |
| 155 | 0 | 0 | 0 |
| 165 | 0 | 0 | 0 |
| 175 | 0 | 0 | 0 |
| 180 | 0 | 0 | 0 |

ZONAL LUMEN SUMMARY

| DEGREES | LUMENS | % LAMP | % FIXTURE |
|---------|--------|--------|-----------|
| 0-30 | 1444 | 33.7 | 47.8 |
| 0-40 | 2154 | 50.2 | 71.4 |
| 0-60 | 2870 | 67.0 | 95.1 |
| 0-90 | 3007 | 70.2 | 99.6 |
| 90-120 | 6.3 | 0.1 | 0.2 |
| 90-150 | 9.3 | 0.2 | 0.3 |
| 90-180 | 9.7 | 0.2 | 0.3 |
| 0-180 | 3018 | 70.4 | 100.00 |

Luminaire Output= 3018 lumens

Luminaire Efficacy = 91.1 lm/W

Luminaire Efficiency = 70.4%

SPACING CRITERION

| ALONG | ACROSS |
|-------|--------|
| 1.19 | 1.09 |



LOS ANGELES LIGHTING MFG. CO.

10141 OLNEY ST. / EL MONTE, CA 91731

TEL 626-454-8300 | FAX 626-454-8399 |

www.lalighting.com