



ARCHITECTURAL

SAW 100 (2FT)

SERIES (4' AND 8' AVAILABLE)
STATIONARY ASYMMETRICAL STRIP LUMINAIRE

LED

DATE	
JOB	

WWW.LALIGHTING.COM
626-454-8300

SURFACE / CEILING / WALL MOUNTED LED LUMINAIRE

DIMENSIONS

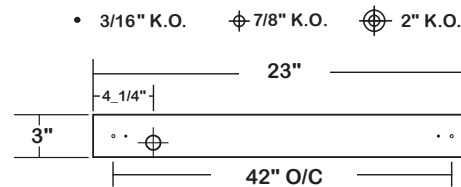
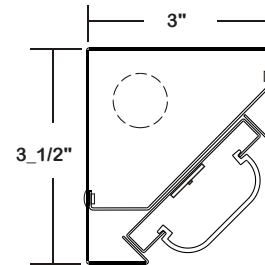

APPLICATIONS

- Architectural, Office, Retail, Museum, Bowling Alley, Commercial

FEATURES

- 0-10V dimming driver standard (See *DRIVER OPTIONS* for other dimming types)
- Supports California Title 24 compliance

OPTIONS

- Full customization available upon request
- Additional lumen packages and color temperatures available
- Wireless control options available (See *SENSOR OPTIONS* for wireless controls)
- Custom colors available (See *CUSTOM COLORS* for color options)
- Tunable white available (2700K-6500K)

SPECIFICATIONS

CONSTRUCTION

- 22 ga. cold rolled steel welded housing

OPTICAL

- Frosted white acrylic lens
- Frosted acrylic lens

FINISH

- Baked white powder coated finish / welded and painted after fabrication / minimum reflectance 90%

ELECTRICAL

- High efficiency drivers coupled with long-life LEDs
- Service life greater than 50,000 hours (L70)
- Universal voltage 120V through 277V (347V / 480V available)
- Power Factor (PF) ≥ 0.9
- Total Harmonic Distortion (THD) $\leq 20\%$

LISTING

- UL USA and Canada listed / suitable for damp locations

WARRANTY

- 5-year limited warranty



Los Angeles Lighting Mfg. Co.
Headquarters
10141 Olney Street
El Monte, CA 91731
Made in the USA

Contact Us
T: 626-454-8300
F: 626-454-8399
www.lalighting.com



Due to continued product improvements and enhancements, Los Angeles Lighting Manufacturing Company reserves the right to alter specifications, dimensions, data, and/or materials without notice. Please visit our website to view the most current information.

MADE IN THE U.S.A.

Revised 07-11-19

WARNING

ORDERING INFORMATION EXAMPLE: SAW100-2-2L-FRWA-DRDM-UNV-1/840

SERIES	LED LUMEN PACKAGE	EFFICACY	NOMINAL LENGTH	COLOR	OPTICAL	ELECTRICAL	DRIVER	VOLTAGE	# OF LED ROW	CRI / CCT
SAW100			2L				DRDM	UNV	1	
SAW100 Stationary Asymmetrical Strip LED Luminaire	1 Nom. 1000 Lumens 2 Nom. 2000 Lumens 3 Nom. 3000 Lumens 4 Nom. 4000 Lumens *Additional Lumen Packages Available	(Blank) Standard HE High Efficacy (Only 1000 / 2000 / 3000 lumens Systems)	2L 2'	BLK Black BZ Bronze *Leave Blank for Standard White See CUSTOM COLORS for Options	FRA Frosted Acrylic FRWA Frosted White Acrylic	WLC(LED RU) EnOcean Wireless Control See SENSOR OPTIONS for Options *Leave Blank if Not Specified Additional Electrical Options	DRDM 0-10V Dimming Driver See DRIVER OPTIONS for Options	UNV 120V-277V See DRIVER OPTIONS for Options	1 One LED Row	830 80+CRI / 3000K Color Temp. 835 80+CRI / 3500K Color Temp. 840 80+CRI / 4000K Color Temp. 850 80+CRI / 5000K Color Temp. *Additional Color Temp. Available

SYSTEM DATA

THESE ARE THE MOST POPULAR LUMEN PACKAGES. PLEASE CONSULT FACTORY FOR ADDITIONAL SYSTEM DATA.

LED LUMEN PACKAGE	NORMAL AMBIENT TEMPERATURE PRODUCT CODE	DELIVERED LUMENS	SYSTEM WATTS	LUMINAIRE EFFICACY	AMBIENT TEMP.	FLUORESCENT EQUIVALENT	IES FILES
1000 Lumens (Nominal)	SAW100-1-2L-FRWA-DRDM-UNV-1/840	914 lm	7.9 W	116.0 lm/W	-20°C / 35°C	1-F17T8	*
2000 Lumens (Nominal)	SAW100-2-2L-FRWA-DRDM-UNV-1/840	1747 lm	15.8 W	110.6 lm/W	-20°C / 35°C	2-F17T8, 1-F24T5HO	LA-T3467
3000 Lumens (Nominal)	SAW100-3-2L-FRWA-DRDM-UNV-1/840	2498 lm	26.1 W	95.6 lm/W	-20°C / 35°C	3-F17T8	*
4000 Lumens (Nominal)	SAW100-4-2L-FRWA-DRDM-UNV-1/840	3378 lm	26.5 W	127.6 lm/W	-20°C / 35°C	4-F17T8, 2-F24T5HO	*

LED LUMEN PACKAGE	NORMAL AMBIENT TEMPERATURE (HIGH EFFICACY) PRODUCT CODE	DELIVERED LUMENS	SYSTEM WATTS	LUMINAIRE EFFICACY	AMBIENT TEMP.	FLUORESCENT EQUIVALENT	IES FILES
1000 Lumens (Nominal)	SAW100-1HE-2L-FRWA-DRDM-UNV-1/840	918 lm	6.4 W	144.5 lm/W	-20°C / 35°C	1-F17T8	*
2000 Lumens (Nominal)	SAW100-2HE-2L-FRWA-DRDM-UNV-1/840	1631 lm	11.7 W	140.1 lm/W	-20°C / 35°C	2-F17T8, 1-F24T5HO	*
3000 Lumens (Nominal)	SAW100-3HE-2L-FRWA-DRDM-UNV-1/840	2464 lm	18.4 W	134.3 lm/W	-20°C / 35°C	3-F17T8	*

NOTE:
System data is based on 120V input voltage. Actual performance may differ as a result of end-user environment and application.

This fixture has been tested and listed in accordance with UL Standards. L.A. Lighting certifies that it will operate safely when installed properly, and within an ambient temperature range noted in the system data table.

Additional lumen packages and color temperatures available.

PERFORMANCE DATA

[VIEW PHOTOMETRICS](#)



Los Angeles Lighting Mfg. Co.
Headquarters
10141 Olney Street
El Monte, CA 91731
Made in the USA

Contact Us
T: 626-454-8300
F: 626-454-8399
www.lalighting.com



Due to continued product improvements and enhancements, Los Angeles Lighting Manufacturing Company reserves the right to alter specifications, dimensions, data, and/or materials without notice. Please visit our website to view the most current information.

MADE IN THE U.S.A.

Revised 07-11-19

WARNING

SENSOR OPTIONS



CONTROLS AND SENSORS

WLC(LED RU) - EnOcean® LED Relay Zone Controller

- Supports a single LED fixture or multiple daisy chained LED fixtures
- Module installed inside lighting fixture

ESRPU-W-EO - EnOcean® Rocker Switch – Single – Surface Mount

- Wireless single rocker switch with mounting plate
- No batteries needed

EDRPU-W-EO - EnOcean® Rocker Switch – Double – Surface Mount

- Wireless double rocker switch with mounting plate
- No batteries needed

S3054-N300 - EnOcean® Navigan NWC 300U – Commissioning Tool

- Navigan Wireless Commissioner is used to configure EnOcean controllers & sensors
- It can be used to define link tables, change parameters/settings, and to edit & store projects
- Configuration settings can be saved and cloned to enable quick configuration
- Connectivity is through the NWC 300U USB Stick

EOSWU-W-EO - EnOcean® Occupancy Sensor – Wall Mount

- Wireless wall mounted occupancy sensor
- Solar powered - no batteries needed (coin battery operated in low light conditions)
- PIR motion sensor with both wide angle (50') and long range (100') options
- Mounting height: 6-8 feet

EOSCU-W-EO - EnOcean® Occupancy Sensor – Ceiling Mount

- Wireless ceiling mounted occupancy sensor
- Solar powered - no batteries needed (coin battery operated in low light conditions)
- PIR motion sensor with 360 degree viewing angle lens (34' diameter)
- Mounting height: 7-10 feet

ELLSU-W-EO - EnOcean® Light Level Sensor – Ceiling Mount

- Light Level sensor that measures and reports the level of available natural light
- Solar powered - no batteries needed (coin battery operated in low light conditions)
- Enables implementation of daylight harvesting control systems
- Mounting position: At the ceiling, close to ambient light source

DRIVER OPTIONS

PLEASE CONSULT FACTORY TO SEE IF YOUR SELECTED DRIVER OPTION WORKS WITH THIS FIXTURE.

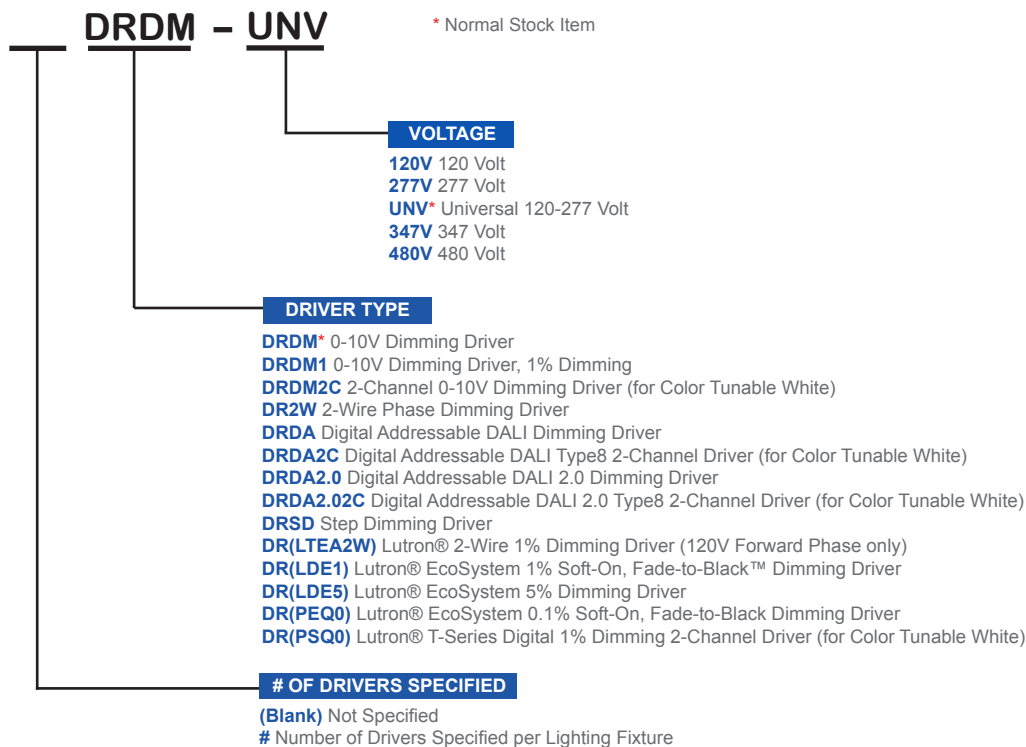

CUSTOM COLORS

- BLK - Matte Black**
- CS - Camaro Silver**
- BZ - Statuary Bronze**

Variety of RAL colors & Axalta/DuPont colors available upon request.



Los Angeles Lighting Mfg. Co.
 Headquarters
 10141 Olney Street
 El Monte, CA 91731
 Made in the USA

Contact Us
 T: 626-454-8300
 F: 626-454-8399
 www.lalighting.com



Due to continued product improvements and enhancements, Los Angeles Lighting Manufacturing Company reserves the right to alter specifications, dimensions, data, and/or materials without notice. Please visit our website to view the most current information.

MADE IN THE U.S.A.

Revised 07-11-19

WARNING

PHOTOMETRIC DATA - SAW100_2FT

SAW100-2-2L-FRWA-DRDM-1/840

TEST NO.=LA-T3467
 LED TYPE=48 LED MODULE
 NO. OF MODULE=1
 SYSTEM WATT (W)=15.8
 CRI ≥ 80
 L70(Hrs.) ≥ 50,000
 PHOTOMETRY TYPE=C

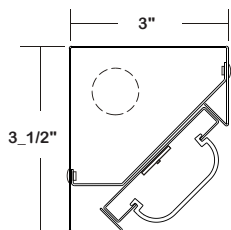
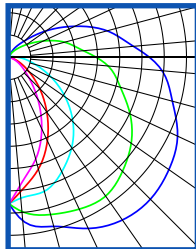

CANDLEPOWER

ANGLE	END	45	90	135	CROSS
0	404	404	404	404	404
5	454	428	390	372	355
15	483	449	383	318	289
25	522	462	347	251	214
35	548	467	302	181	137
45	553	444	249	118	75
55	539	412	188	65	41
65	514	369	127	31	18
75	467	318	74	8	2
85	424	275	39	0	0
90	388	241	24	0	0
95	345	207	15	0	0
105	281	160	8	0	0
115	203	107	4	0	0
125	129	63	2	0	0
135	69	35	1	0	0
145	38	18	0	0	0
155	16	6	0	0	0
165	2	0	0	0	0
175	0	0	0	0	0
180	0	0	0	0	0

ZONAL LUMEN SUMMARY

DEGREES	LUMENS	% LAMP	% FIXTURE
0-30	312	15	18
0-40	515	24	29
0-60	947	44	54
0-90	1451	68	83
90-120	246	12	14
90-150	295	14	17
90-180	296	14	17
0-180	1747	82	100

Luminaire Output = 1747.1 lumens
 Luminaire Efficacy = 110.6 lm/W
 Luminaire Efficiency = 81.57 %

SPACING CRITERION

ALONG	ACROSS
1.95	1.19

