



# ARCHITECTURAL LED

## SAW 100 (4FT) SERIES (2' AND 8' AVAILABLE)

STATIONARY ASYMMETRICAL STRIP LUMINAIRE

DATE	
JOB	

WWW.LALIGHTING.COM  
626-454-8300

### SURFACE / CEILING / WALL MOUNTED LED LUMINAIRE

### DIMENSIONS

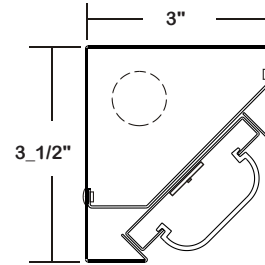

- 3/16" K.O.    ⌀ 7/8" K.O.    ⌀ 2" K.O.

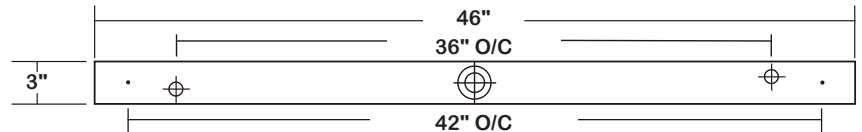

### APPLICATIONS

- Architectural, Office, Retail, Museum, Bowling Alley, Commercial

### FEATURES

- 0-10V dimming driver standard (See DRIVER OPTIONS for other dimming types)
- Supports California Title 24 compliance

### OPTIONS

- Full customization available upon request
- Additional lumen packages and color temperatures available
- Wireless control options available (See SENSOR OPTIONS for wireless controls)
- Emergency battery pack available (See BATTERY PACK OPTIONS for battery pack options)
- Custom colors available (See CUSTOM COLORS for color options)
- Tunable white available (2700K-6500K)

### SPECIFICATIONS

#### CONSTRUCTION

- 22 ga. cold rolled steel welded housing

#### OPTICAL

- Frosted white acrylic lens
- Frosted acrylic lens

#### FINISH

- Baked white powder coated finish / welded and painted after fabrication / minimum reflectance 90%

#### ELECTRICAL

- High efficiency drivers coupled with long-life LEDs
- Service life greater than 50,000 hours (L70)
- Universal voltage 120V through 277V (347V / 480V available)
- Power Factor (PF) ≥ 0.9
- Total Harmonic Distortion (THD) ≤ 20%

#### LISTING

- UL USA and Canada listed / suitable for damp locations

#### WARRANTY

- 5-year limited warranty



**Los Angeles Lighting Mfg. Co.**  
Headquarters  
10141 Olney Street  
El Monte, CA 91731  
Made in the USA

Contact Us  
T: 626-454-8300  
F: 626-454-8399  
www.lalighting.com



Due to continued product improvements and enhancements, Los Angeles Lighting Manufacturing Company reserves the right to alter specifications, dimensions, data, and/or materials without notice. Please visit our website to view the most current information.

**MADE IN THE U.S.A.**

Revised 07-11-19

**WARNING**

ORDERING INFORMATION

EXAMPLE: SAW100-4-4L-FRWA-DRDM-UNV-1/840

SERIES	LED LUMEN PACKAGE	EFFICACY	NOMINAL LENGTH	COLOR	OPTICAL	ELECTRICAL	DRIVER	VOLTAGE	# OF LED ROW	CRI / CCT
SAW100			4L				DRDM	UNV	1	
SAW100 Stationary Asymmetrical Strip LED Luminaire	2 Nom. 2000 Lumens 4 Nom. 4000 Lumens 6 Nom. 6000 Lumens 8 Nom. 8000 Lumens  *Additional Lumen Packages Available	(Blank) Standard  HE High Efficacy (Only 2000 / 4000 / 6000 lumens Systems)	4L 4'	BLK Black  BZ Bronze  *Leave Blank for Standard White  See CUSTOM COLORS for Options	FRA Frosted Acrylic  FRWA Frosted White Acrylic	BPLSL1.5 Emergency Battery Pack, Slim Casing, Nom. 1500 lm  See BATTERY PACK OPTIONS for Options  WLC(LEDRU) EnOcean Wireless Control  See SENSOR OPTIONS for Options  *Leave Blank if Not Specified  Additional Electrical Options	DRDM 0-10V Dimming Driver  See DRIVER OPTIONS for Options	UNV 120V-277V  See DRIVER OPTIONS for Options	1 One LED Row	830 80+CRI / 3000K Color Temp.  835 80+CRI / 3500K Color Temp.  840 80+CRI / 4000K Color Temp.  850 80+CRI / 5000K Color Temp.  *Additional Color Temp. Available

SYSTEM DATA

THESE ARE THE MOST POPULAR LUMEN PACKAGES. PLEASE CONSULT FACTORY FOR ADDITIONAL SYSTEM DATA.

LED LUMEN PACKAGE	NORMAL AMBIENT TEMPERATURE PRODUCT CODE	DELIVERED LUMENS	SYSTEM WATTS	LUMINAIRE EFFICACY	AMBIENT TEMP.	FLUORESCENT EQUIVALENT	IES FILES
2000 Lumens (Nominal)	SAW100-2-4L-FRWA-DRDM-UNV-1/840	1836 lm	15.8 W	116.4 lm/W	-20°C / 35°C	1-F32T8	*
4000 Lumens (Nominal)	SAW100-4-4L-FRWA-DRDM-UNV-1/840	3506 lm	31.2 W	112.4 lm/W	-20°C / 35°C	2-F32T8, 1-F54T5HO	<a href="#">LA-T3468</a>
6000 Lumens (Nominal)	SAW100-6-4L-FRWA-DRDM-UNV-1/840	5012 lm	52.4 W	95.7 lm/W	-20°C / 35°C	3-F32T8	*
8000 Lumens (Nominal)	SAW100-8-4L-FRWA-DRDM-UNV-1/840	6778 lm	52.9 W	128.0 lm/W	-20°C / 35°C	4-F32T8, 2-F54T5HO	*

LED LUMEN PACKAGE	NORMAL AMBIENT TEMPERATURE (HIGH EFFICACY) PRODUCT CODE	DELIVERED LUMENS	SYSTEM WATTS	LUMINAIRE EFFICACY	AMBIENT TEMP.	FLUORESCENT EQUIVALENT	IES FILES
2000 Lumens (Nominal)	SAW100-2HE-4L-FRWA-DRDM-UNV-1/840	1841 lm	12.6 W	146.3 lm/W	-20°C / 35°C	1-F32T8	*
4000 Lumens (Nominal)	SAW100-4HE-4L-FRWA-DRDM-UNV-1/840	3274 lm	23.2 W	141.3 lm/W	-20°C / 35°C	2-F32T8, 1-F54T5HO	*
6000 Lumens (Nominal)	SAW100-6HE-4L-FRWA-DRDM-UNV-1/840	4946 lm	36.8 W	134.3 lm/W	-20°C / 35°C	3-F32T8	*

NOTE:

System data is based on 120V input voltage. Actual performance may differ as a result of end-user environment and application.

This fixture has been tested and listed in accordance with UL Standards. L.A. Lighting certifies that it will operate safely when installed properly, and within an ambient temperature range noted in the system data table.

Additional lumen packages and color temperatures available.

PERFORMANCE DATA

VIEW PHOTOMETRICS



Los Angeles Lighting Mfg. Co.  
Headquarters  
10141 Olney Street  
El Monte, CA 91731  
Made in the USA

Contact Us  
T: 626-454-8300  
F: 626-454-8399  
www.lalighting.com



Due to continued product improvements and enhancements, Los Angeles Lighting Manufacturing Company reserves the right to alter specifications, dimensions, data, and/or materials without notice. Please visit our website to view the most current information.

MADE IN THE U.S.A.

Revised 07-11-19

WARNING

**SENSOR OPTIONS**



- WLC(LED RU) - EnOcean® LED Relay Zone Controller**
- Supports a single LED fixture or multiple daisy chained LED fixtures
  - Module installed inside lighting fixture
- ESRPU-W-EO - EnOcean® Rocker Switch – Single – Surface Mount**
- Wireless single rocker switch with mounting plate
  - No batteries needed
- EDRPU-W-EO - EnOcean® Rocker Switch – Double – Surface Mount**
- Wireless double rocker switch with mounting plate
  - No batteries needed
- S3054-N300 - EnOcean® Navigan NWC 300U – Commissioning Tool**
- Navigan Wireless Commissioner is used to configure EnOcean controllers & sensors
  - It can be used to define link tables, change parameters/settings, and to edit & store projects
  - Configuration settings can be saved and cloned to enable quick configuration
  - Connectivity is through the NWC 300U USB Stick

- EOSWU-W-EO - EnOcean® Occupancy Sensor – Wall Mount**
- Wireless wall mounted occupancy sensor
  - Solar powered - no batteries needed (coin battery operated in low light conditions)
  - PIR motion sensor with both wide angle (50') and long range (100') options
  - Mounting height: 6-8 feet

- EOSCU-W-EO - EnOcean® Occupancy Sensor – Ceiling Mount**
- Wireless ceiling mounted occupancy sensor
  - Solar powered - no batteries needed (coin battery operated in low light conditions)
  - PIR motion sensor with 360 degree viewing angle lens (34' diameter)
  - Mounting height: 7-10 feet

- ELLSU-W-EO - EnOcean® Light Level Sensor – Ceiling Mount**
- Light Level sensor that measures and reports the level of available natural light
  - Solar powered - no batteries needed (coin battery operated in low light conditions)
  - Enables implementation of daylight harvesting control systems
  - Mounting position: At the ceiling, close to ambient light source

**DRIVER OPTIONS**

PLEASE CONSULT FACTORY TO SEE IF YOUR SELECTED DRIVER OPTION WORKS WITH THIS FIXTURE.

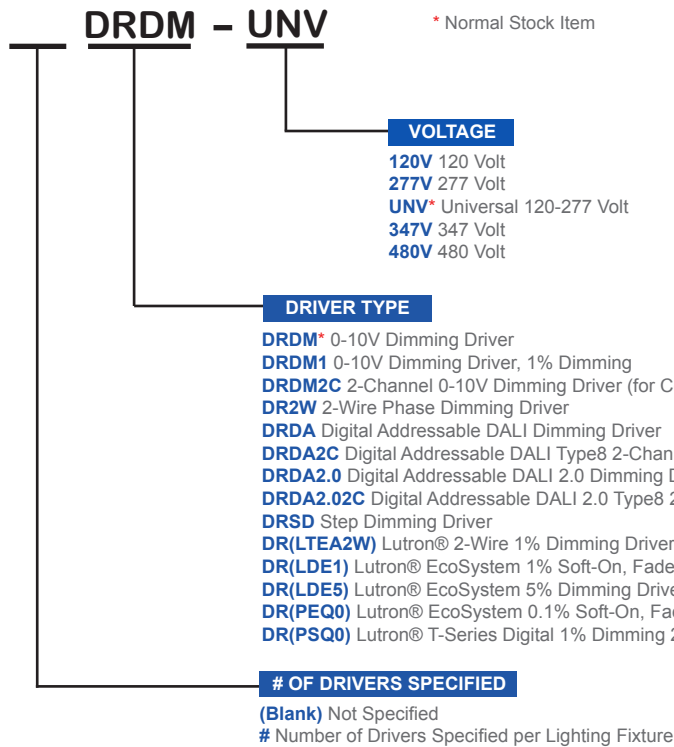

**BATTERY PACK OPTIONS**

PLEASE CONSULT FACTORY TO SEE IF YOUR SELECTED BATTERY PACK OPTION WORKS WITH THIS FIXTURE.

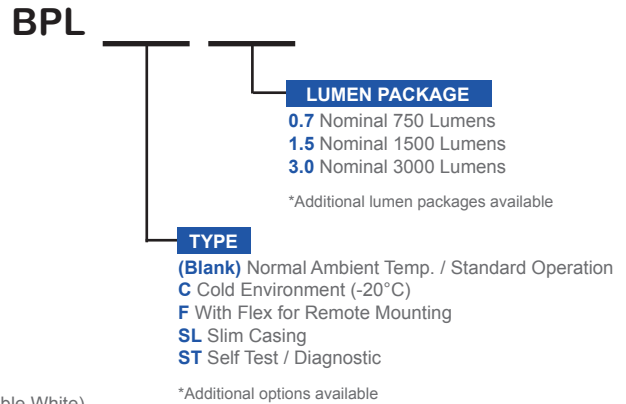

**CUSTOM COLORS**

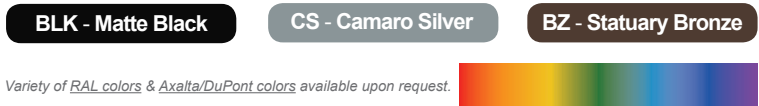

**Los Angeles Lighting Mfg. Co.**  
 Headquarters  
 10141 Olney Street  
 El Monte, CA 91731  
 Made in the USA

Contact Us  
 T: 626-454-8300  
 F: 626-454-8399  
 www.lalighting.com



Due to continued product improvements and enhancements, Los Angeles Lighting Manufacturing Company reserves the right to alter specifications, dimensions, data, and/or materials without notice. Please visit our website to view the most current information.

**MADE IN THE U.S.A.**

Revised 07-11-19  
**WARNING**

**PHOTOMETRIC DATA - SAW100\_4FT**

**SAW100-4-4L-FRWA-DRDM-1/840**

TEST NO.=LA-T3468  
 LED TYPE=48 LED MODULE  
 NO. OF MODULE=2  
 SYSTEM WATT (W)=31.2  
 CRI ≥ 80  
 L70(Hrs.) ≥ 50,000  
 PHOTOMETRY TYPE=C

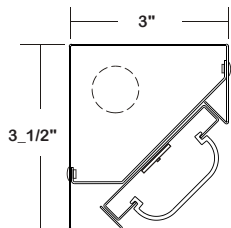
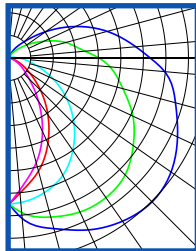

**CANDLEPOWER**

ANGLE	END	45	90	135	CROSS
0	797	797	797	797	797
5	885	850	791	736	718
15	965	899	758	633	584
25	1035	926	702	504	431
35	1086	927	609	366	272
45	1107	898	500	236	145
55	1080	828	382	129	80
65	1014	745	260	61	34
75	940	642	151	16	4
85	852	552	78	0	0
90	770	490	48	0	0
95	695	417	31	0	0
105	557	323	16	0	0
115	406	216	9	0	0
125	256	129	4	0	0
135	138	69	1	0	0
145	76	36	0	0	0
155	33	10	0	0	0
165	3	0	0	0	0
175	0	0	0	0	0
180	0	0	0	0	0

**ZONAL LUMEN SUMMARY**

DEGREES	LUMENS	% LAMP	% FIXTURE
0-30	625	15	18
0-40	1030	24	29
0-60	1898	44	54
0-90	2910	68	83
90-120	495	12	14
90-150	593	14	17
90-180	596	14	17
0-180	3506	82	100

Luminaire Output = 3506.2 lumens  
 Luminaire Efficacy = 112.4 lm/W  
 Luminaire Efficiency = 81.84 %

**SPACING CRITERION**

ALONG	ACROSS
1.97	1.21

