



ARCHITECTURAL LED

SAW 100 (8FT) SERIES (2' AND 4' AVAILABLE)

STATIONARY ASYMMETRICAL STRIP LUMINAIRE

| | |
|------|--|
| DATE | |
| JOB | |

WWW.LALIGHTING.COM
626-454-8300

SURFACE / CEILING / WALL MOUNTED LED LUMINAIRE

DIMENSIONS

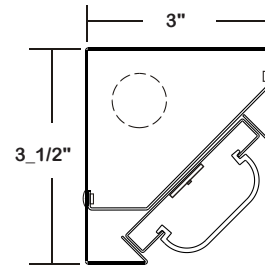

- 3/16" K.O.
- ϕ 7/8" K.O.
- ϕ 2" K.O.

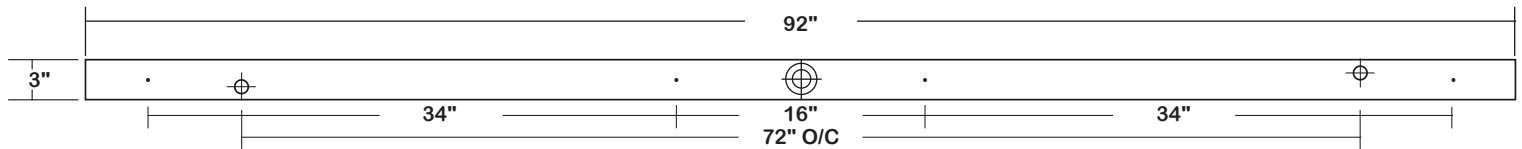

APPLICATIONS

- Architectural, Office, Retail, Museum, Bowling Alley, Commercial

FEATURES

- 0-10V dimming driver standard (See [DRIVER OPTIONS](#) for other dimming types)
- Supports California Title 24 compliance

OPTIONS

- Full customization available upon request
- Additional lumen packages and color temperatures available
- Wireless control options available (See [SENSOR OPTIONS](#) for wireless controls)
- Emergency battery pack available (See [BATTERY PACK OPTIONS](#) for battery pack options)
- Custom colors available (See [CUSTOM COLORS](#) for color options)
- Tunable white available (2700K-6500K)

SPECIFICATIONS

CONSTRUCTION

- 22 ga. cold rolled steel welded housing

OPTICAL

- Frosted white acrylic lens (2 per fixture)
- Frosted acrylic lens (2 per fixture)

FINISH

- Baked white powder coated finish / welded and painted after fabrication / minimum reflectance 90%

ELECTRICAL

- High efficiency drivers coupled with long-life LEDs
- Service life greater than 50,000 hours (L70)
- Universal voltage 120V through 277V (347V / 480V available)
- Power Factor (PF) \geq 0.9
- Total Harmonic Distortion (THD) \leq 20%

LISTING

- UL USA and Canada listed / suitable for damp locations

WARRANTY

- 5-year limited warranty



Los Angeles Lighting Mfg. Co.
Headquarters
10141 Olney Street
El Monte, CA 91731
Made in the USA

Contact Us
T: 626-454-8300
F: 626-454-8399
www.lalighting.com



Due to continued product improvements and enhancements, Los Angeles Lighting Manufacturing Company reserves the right to alter specifications, dimensions, data, and/or materials without notice. Please visit our website to view the most current information.

MADE IN THE U.S.A.

Revised 07-11-19

WARNING

ORDERING INFORMATION EXAMPLE: SAW100-8-8L-FRWA-DRDM-UNV-1/840

| SERIES | LED LUMEN PACKAGE | EFFICACY | NOMINAL LENGTH | COLOR | OPTICAL | ELECTRICAL | DRIVER | VOLTAGE | # OF LED ROW | CRI / CCT |
|--|---|--|-----------------|--|---|---|--|--|----------------------|---|
| SAW100 | | | 8L | | | | DRDM | UNV | 1 | |
| SAW100 Stationary Asymmetrical Strip LED Luminaire | 4 Nom. 4000 Lumens 8 Nom. 8000 Lumens 12 Nom. 12000 Lumens 16 Nom. 16000 Lumens *Additional Lumen Packages Available | (Blank) Standard HE High Efficacy (Only 4000 / 8000 / 12000 lumens Systems) | 8L 8' | BLK Black BZ Bronze *Leave Blank for Standard White See CUSTOM COLORS for Options | FRA Frosted Acrylic FRWA Frosted White Acrylic | BPLSL1.5 Emergency Battery Pack, Slim Casing, Nom. 1500 lm See BATTERY PACK OPTIONS for Options WLC(LEDPU) EnOcean Wireless Control See SENSOR OPTIONS for Options *Leave Blank if Not Specified Additional Electrical Options | DRDM 0-10V Dimming Driver See DRIVER OPTIONS for Options | UNV 120V-277V See DRIVER OPTIONS for Options | 1 One LED Row | 830 80+CRI / 3000K Color Temp. 835 80+CRI / 3500K Color Temp. 840 80+CRI / 4000K Color Temp. 850 80+CRI / 5000K Color Temp. *Additional Color Temp. Available |

SYSTEM DATA

THESE ARE THE MOST POPULAR LUMEN PACKAGES. PLEASE CONSULT FACTORY FOR ADDITIONAL SYSTEM DATA.

| LED LUMEN PACKAGE | NORMAL AMBIENT TEMPERATURE PRODUCT CODE | DELIVERED LUMENS | SYSTEM WATTS | LUMINAIRE EFFICACY | AMBIENT TEMP. | FLUORESCENT / HID EQUIVALENT | IES FILES |
|------------------------|---|------------------|--------------|--------------------|---------------|------------------------------|--------------------------|
| 4000 Lumens (Nominal) | SAW100-4-8L-FRWA-DRDM-UNV-1/840 | 3382 lm | 28.7 W | 117.8 lm/W | -20°C / 35°C | 2-F32T8 | * |
| 8000 Lumens (Nominal) | SAW100-8-8L-FRWA-DRDM-UNV-1/840 | 6757 lm | 61.4 W | 110.1 lm/W | -20°C / 35°C | 4-F32T8, 2-F54T5HO | LA-T3469 |
| 12000 Lumens (Nominal) | SAW100-12-8L-FRWA-DRDM-UNV-1/840 | 10038 lm | 104.6 W | 96.0 lm/W | -20°C / 35°C | 6-F32T8 | * |
| 16000 Lumens (Nominal) | SAW100-16-8L-FRWA-DRDM-UNV-1/840 | 13285 lm | 103.3 W | 128.6 lm/W | -20°C / 35°C | 8-F32T8, 4-F54T5HO | * |

| LED LUMEN PACKAGE | NORMAL AMBIENT TEMPERATURE (HIGH EFFICACY) PRODUCT CODE | DELIVERED LUMENS | SYSTEM WATTS | LUMINAIRE EFFICACY | AMBIENT TEMP. | FLUORESCENT EQUIVALENT | IES FILES |
|------------------------|---|------------------|--------------|--------------------|---------------|------------------------|-----------|
| 4000 Lumens (Nominal) | SAW100-4HE-8L-FRWA-DRDM-UNV-1/840 | 3319 lm | 22.5 W | 147.7 lm/W | -20°C / 35°C | 2-F32T8 | * |
| 8000 Lumens (Nominal) | SAW100-8HE-8L-FRWA-DRDM-UNV-1/840 | 6557 lm | 46.4 W | 141.5 lm/W | -20°C / 35°C | 4-F32T8, 2-F54T5HO | * |
| 12000 Lumens (Nominal) | SAW100-12HE-8L-FRWA-DRDM-UNV-1/840 | 9905 lm | 73.7 W | 134.5 lm/W | -20°C / 35°C | 6-F32T8 | * |

NOTE:
System data is based on 120V input voltage. Actual performance may differ as a result of end-user environment and application.

This fixture has been tested and listed in accordance with UL Standards. L.A. Lighting certifies that it will operate safely when installed properly, and within an ambient temperature range noted in the system data table.

Additional lumen packages and color temperatures available.

PERFORMANCE DATA

[VIEW PHOTOMETRICS](#)



Los Angeles Lighting Mfg. Co.
Headquarters
10141 Olney Street
El Monte, CA 91731
Made in the USA

Contact Us
T: 626-454-8300
F: 626-454-8399
www.lalighting.com



Due to continued product improvements and enhancements, Los Angeles Lighting Manufacturing Company reserves the right to alter specifications, dimensions, data, and/or materials without notice. Please visit our website to view the most current information.

MADE IN THE U.S.A.

Revised 07-11-19
WARNING

SENSOR OPTIONS



- WLC(LED RU) - EnOcean® LED Relay Zone Controller**
- Supports a single LED fixture or multiple daisy chained LED fixtures
 - Module installed inside lighting fixture
- ESRPU-W-EO - EnOcean® Rocker Switch – Single – Surface Mount**
- Wireless single rocker switch with mounting plate
 - No batteries needed
- EDRPU-W-EO - EnOcean® Rocker Switch – Double – Surface Mount**
- Wireless double rocker switch with mounting plate
 - No batteries needed
- S3054-N300 - EnOcean® Navigan NWC 300U – Commissioning Tool**
- Navigan Wireless Commissioner is used to configure EnOcean controllers & sensors
 - It can be used to define link tables, change parameters/settings, and to edit & store projects
 - Configuration settings can be saved and cloned to enable quick configuration
 - Connectivity is through the NWC 300U USB Stick

- EOSWU-W-EO - EnOcean® Occupancy Sensor – Wall Mount**
- Wireless wall mounted occupancy sensor
 - Solar powered - no batteries needed (coin battery operated in low light conditions)
 - PIR motion sensor with both wide angle (50') and long range (100') options
 - Mounting height: 6-8 feet

- EOSCU-W-EO - EnOcean® Occupancy Sensor – Ceiling Mount**
- Wireless ceiling mounted occupancy sensor
 - Solar powered - no batteries needed (coin battery operated in low light conditions)
 - PIR motion sensor with 360 degree viewing angle lens (34' diameter)
 - Mounting height: 7-10 feet

- ELLSU-W-EO - EnOcean® Light Level Sensor – Ceiling Mount**
- Light Level sensor that measures and reports the level of available natural light
 - Solar powered - no batteries needed (coin battery operated in low light conditions)
 - Enables implementation of daylight harvesting control systems
 - Mounting position: At the ceiling, close to ambient light source

DRIVER OPTIONS

PLEASE CONSULT FACTORY TO SEE IF YOUR SELECTED DRIVER OPTION WORKS WITH THIS FIXTURE.

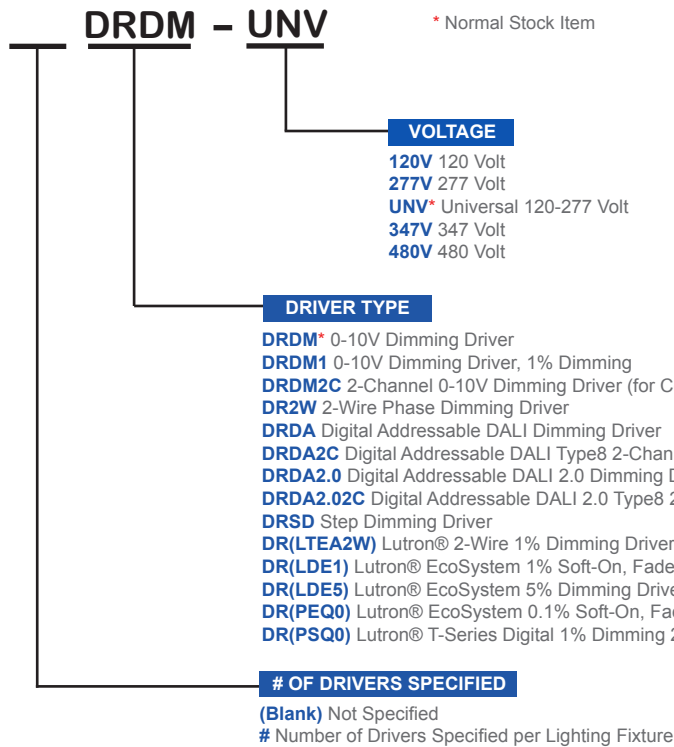

BATTERY PACK OPTIONS

PLEASE CONSULT FACTORY TO SEE IF YOUR SELECTED BATTERY PACK OPTION WORKS WITH THIS FIXTURE.

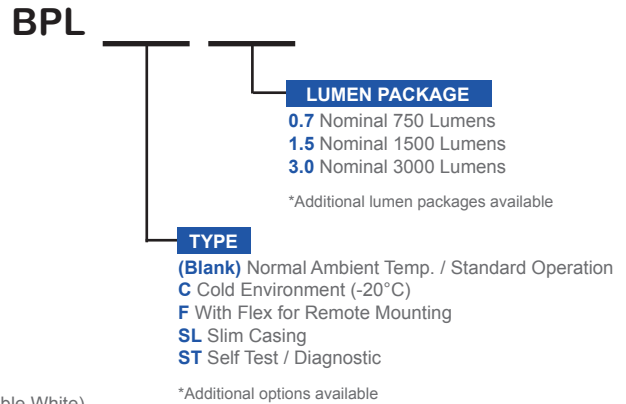

CUSTOM COLORS

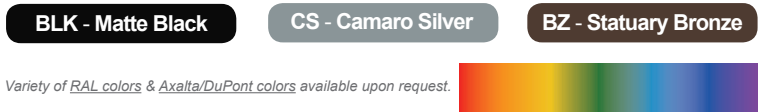

Los Angeles Lighting Mfg. Co.
 Headquarters
 10141 Olney Street
 El Monte, CA 91731
 Made in the USA

Contact Us
 T: 626-454-8300
 F: 626-454-8399
 www.lalighting.com



Due to continued product improvements and enhancements, Los Angeles Lighting Manufacturing Company reserves the right to alter specifications, dimensions, data, and/or materials without notice. Please visit our website to view the most current information.

MADE IN THE U.S.A.

Revised 07-11-19
WARNING

PHOTOMETRIC DATA - SAW100_8FT

SAW100-8-8L-FRWA-DRDM-1/840

TEST NO.=LA-T3469
 LED TYPE=48 LED MODULE
 NO. OF MODULE=4
 SYSTEM WATT (W)=61.4
 CRI ≥ 80
 L70(Hrs.) ≥ 50,000
 PHOTOMETRY TYPE=C

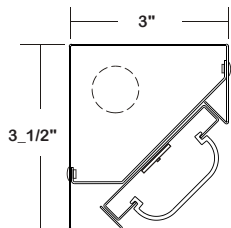
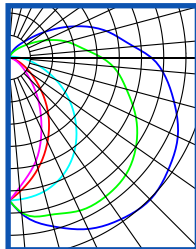

CANDLEPOWER

| ANGLE | END | 45 | 90 | 135 | CROSS |
|-------|------|------|------|------|-------|
| 0 | 1493 | 1493 | 1493 | 1493 | 1493 |
| 5 | 1650 | 1633 | 1484 | 1394 | 1346 |
| 15 | 1828 | 1698 | 1441 | 1185 | 1099 |
| 25 | 1974 | 1761 | 1342 | 950 | 792 |
| 35 | 2053 | 1764 | 1187 | 705 | 516 |
| 45 | 2088 | 1724 | 983 | 455 | 286 |
| 55 | 2029 | 1615 | 760 | 256 | 152 |
| 65 | 1941 | 1456 | 526 | 118 | 65 |
| 75 | 1780 | 1264 | 310 | 31 | 7 |
| 85 | 1602 | 1088 | 161 | 1 | 0 |
| 90 | 1481 | 963 | 100 | 0 | 0 |
| 95 | 1305 | 820 | 64 | 0 | 0 |
| 105 | 1056 | 629 | 36 | 0 | 0 |
| 115 | 772 | 425 | 17 | 0 | 0 |
| 125 | 481 | 244 | 8 | 0 | 0 |
| 135 | 257 | 137 | 2 | 0 | 0 |
| 145 | 143 | 69 | 0 | 0 | 0 |
| 155 | 61 | 20 | 0 | 0 | 0 |
| 165 | 6 | 1 | 0 | 0 | 0 |
| 175 | 0 | 0 | 0 | 0 | 0 |
| 180 | 0 | 0 | 0 | 0 | 0 |

ZONAL LUMEN SUMMARY

| DEGREES | LUMENS | % LAMP | % FIXTURE |
|---------|--------|--------|-----------|
| 0-30 | 1182 | 14 | 18 |
| 0-40 | 1958 | 24 | 30 |
| 0-60 | 3635 | 44 | 54 |
| 0-90 | 5608 | 68 | 83 |
| 90-120 | 958 | 12 | 14 |
| 90-150 | 1143 | 14 | 17 |
| 90-180 | 1149 | 14 | 17 |
| 0-180 | 6757 | 82 | 100 |

Luminaire Output = 6756.8 lumens
 Luminaire Efficacy = 110.0 lm/W
 Luminaire Efficiency = 81.96 %

SPACING CRITERION

| ALONG | ACROSS |
|-------|--------|
| 1.98 | 1.25 |

