



# WALL BRACKET

LED

## BSQ100 (2FT) SERIES (4FT AVAILABLE)

SQUARE WALL BRACKET LUMINAIRE

JOB	
TYPE	
DATE	

WWW.LALIGHTING.COM  
626-454-8300

### CORNER / WALL MOUNTED LED LUMINAIRE



### DIMENSIONS

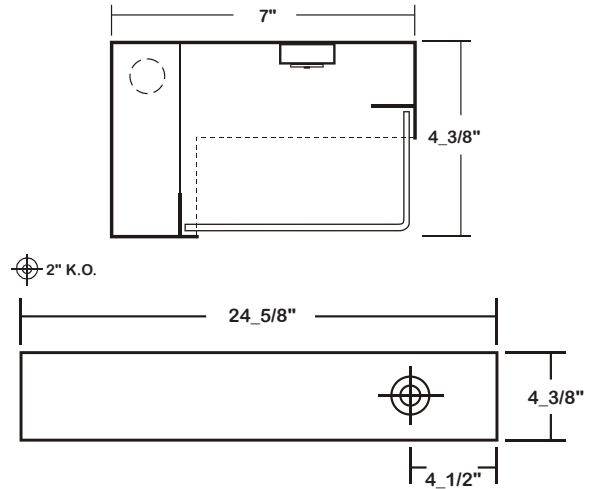

### APPLICATIONS

- Commercial, Corner, Under Cabinet, Corridor, Health Care

### FEATURES

- Corner / wall mounted LED luminaire
- 0-10V dimming driver standard ([See DRIVER OPTIONS for other dimming types](#))
- Suitable for damp locations
- Supports California Title 24 compliance

### OPTIONS

- Full customization available upon request
- Additional lumen packages and color temperatures available
- Wireless control options available ([See SENSOR OPTIONS for wireless controls](#))
- Emergency battery pack available ([See BATTERY PACK OPTIONS for battery pack options](#))
- Custom colors available ([See CUSTOM COLORS For standard and custom options](#))
- Tunable white available (2700K-6500K)
- Switch available

### SPECIFICATIONS

#### CONSTRUCTION

- 22 ga. cold rolled steel welded housing

#### FINISH

- Baked white powder coated finish / welded and painted after fabrication / minimum reflectance 90%

#### OPTICAL

- High Impact Clear Prismatic Acrylic, Min. 0.125 OA Thickness, Female Prisms 3/16 Square Base

#### ELECTRICAL

- High efficiency drivers coupled with long-life LEDs
- Service life tested at 50,000 hours (L70)
- Universal voltage 120V through 277V (347V / 480V available)
- Power Factor (PF) ≥ 0.9
- Total Harmonic Distortion (THD) ≤ 20%

#### LISTING

- UL USA and Canada classified / suitable for damp locations

#### WARRANTY

- 5-year limited warranty



**Los Angeles Lighting Mfg. Co.**  
Headquarters Contact Us  
10141 Olney Street T: 626-454-8300  
El Monte, CA 91731 F: 626-454-8399  
Made in the USA www.lalighting.com



BAA Compliant



Due to continued product improvements and enhancements, Los Angeles Lighting Manufacturing Company reserves the right to alter specifications, dimensions, data, and/or materials without notice. Please visit our website to view the most current information.



MADE IN THE U.S.A.

Revised 01/30/20

WARNING

**ORDERING INFORMATION** EXAMPLE: BSQ100-2-2L-DRP3-BPL1.5-DRDM-UNV-1/840

SERIES	LED LUMEN PACKAGE	EFFICACY	NOMINAL LENGTH	OPTICAL	ELECTRICAL	DRIVER	VOLTAGE	# OF LED ROW	CRI / CCT
<b>BSQ100</b>			<b>2L</b>	<b>DRP3</b>		<b>DRDM</b>	<b>UNV</b>	<b>1</b>	
<b>BSQ100</b> Square Wall Bracket LED Luminaire	<b>2</b> Nom. 2000 Lumens <b>3</b> Nom. 3000 Lumens <b>4</b> Nom. 4000 Lumens <b>*Additional Lumen Packages Available</b>	<b>(Blank)</b> Standard <b>HE</b> High Efficacy (2000 / 3000 / lumens Systems)	<b>2L</b> 2'	<b>DRP3</b> High Impact Clear Prismatic Acrylic, Min. 0.125 OA Thickness, Female Prisms 3/16 Square Base	<b>BPL1.5</b> Emergency Battery Pack Nom. 1500 lm  *Leave Blank if Not Specified <u>Additional Electrical Options</u>  <u>See BATTERY PACK OPTIONS for</u>	<b>DRDM</b> 0-10V Dimming Driver  <u>Additional Driver Options</u>	<b>UNV</b> 120V-277V  *Additional Voltages Available	<b>1</b> One LED Row	<b>835</b> 80+CRI / 3500K Color Temp.  <b>840</b> 80+CRI / 4000K Color Temp.  <b>850</b> 80+CRI / 5000K Color Temp. *Additional Color Temp. Available  <b>8TW</b> Tunable White 827 to 865

**SYSTEM DATA**

LED LUMEN PACKAGE	NORMAL AMBIENT TEMPERATURE PRODUCT CODE	DELIVERED LUMENS	SYSTEM WATTS	LUMINAIRE EFFICACY	AMBIENT TEMP.	FLUORESCENT EQUIVALENT	IES FILES
2000 Lumens (Nominal)	BSQ100-2-2L-DRP3-DRDM-UNV-1/840	1642 lm	17.4 W	94.3 lm/W	-20°C / 35°C	2-F17T8, 1-F24T5HO	<a href="#">LA-T2883</a>
3000 Lumens (Nominal)	BSQ100-3-2L-DRP3-DRDM-UNV-1/840	2454 lm	26.2 W	93.6 lm/W	-20°C / 35°C	3-F17T8	*
4000 Lumens (Nominal)	BSQ100-4-2L-DRP3-DRDM-UNV-1/840	3288 lm	34.4 W	95.7 lm/W	-20°C / 35°C	4-F17T8, 2-F24T5HO	*

LED LUMEN PACKAGE	NORMAL AMBIENT TEMPERATURE (HIGH EFFICACY) PRODUCT CODE	DELIVERED LUMENS	SYSTEM WATTS	LUMINAIRE EFFICACY	AMBIENT TEMP.	FLUORESCENT EQUIVALENT	IES FILES
2000 Lumens (Nominal)	BSQ100-2HE-2L-DRP3-DRDM-UNV-1/840	*	*	*	*	2-F17T8, 1-F24T5HO	*
3000 Lumens (Nominal)	BSQ100-3HE-2L-DRP3-DRDM-UNV-1/840	*	*	*	*	3-F17T8	*

**NOTE:**  
System data above is based on 120V input voltage.  
Actual performance may differ as a result of end-user environment and application.  
This fixture has been tested and listed in accordance with UL Standards. L.A. Lighting certifies that it will operate safely when installed properly, and within an ambient temperature range from -20°C to 40°C.

Additional lumen packages and color temperatures available.

**CUSTOM COLORS**

- BLK - Matte Black
- CS - Camaro Silver
- BZ - Statuary Bronze

Variety of RAL colors



**Los Angeles Lighting Mfg. Co.**  
Headquarters Contact Us  
10141 Olney Street T: 626-454-8300  
El Monte, CA 91731 F: 626-454-8399  
Made in the USA www.lalighting.com



**BAA Compliant**



Due to continued product improvements and enhancements, Los Angeles Lighting Manufacturing Company reserves the right to alter specifications, dimensions, data, and/or materials without notice. Please visit our website to view the most current information.



**MADE IN THE U.S.A.**

Revised 01/30/20

**WARNING**

**SENSOR OPTIONS**



- WLC(LED RU) - EnOcean® LED Relay Zone Controller**
  - Supports a single LED fixture or multiple daisy chained LED fixtures
  - Module installed inside lighting fixture
- ESRPU-W-EO - EnOcean® Rocker Switch – Single – Surface Mount**
  - Wireless single rocker switch with mounting plate
  - No batteries needed
- EDRPU-W-EO - EnOcean® Rocker Switch – Double – Surface Mount**
  - Wireless double rocker switch with mounting plate
  - No batteries needed
- S3054-N300 - EnOcean® Navigan NWC 300U – Commissioning Tool**
  - Navigan Wireless Commissioner is used to configure EnOcean controllers & sensors
  - It can be used to define link tables, change parameters/settings, and to edit & store projects
  - Configuration settings can be saved and cloned to enable quick configuration
  - Connectivity is through the NWC 300U USB Stick

- EOSWU-W-EO - EnOcean® Occupancy Sensor – Wall Mount**
  - Wireless wall mounted occupancy sensor
  - Solar powered - no batteries needed (coin battery operated in low light conditions)
  - PIR motion sensor with both wide angle (50') and long range (100') options
  - Mounting height: 6-8 feet

- EOSCU-W-EO - EnOcean® Occupancy Sensor – Ceiling Mount**
  - Wireless ceiling mounted occupancy sensor
  - Solar powered - no batteries needed (coin battery operated in low light conditions)
  - PIR motion sensor with 360 degree viewing angle lens (34' diameter)
  - Mounting height: 7-10 feet

- ELLSU-W-EO - EnOcean® Light Level Sensor – Ceiling Mount**
  - Light Level sensor that measures and reports the level of available natural light
  - Solar powered - no batteries needed (coin battery operated in low light conditions)
  - Enables implementation of daylight harvesting control systems
  - Mounting position: At the ceiling, close to ambient light source

**DRIVER OPTIONS**

PLEASE CONSULT FACTORY TO SEE IF YOUR SELECTED DRIVER OPTION WORKS WITH THIS FIXTURE.

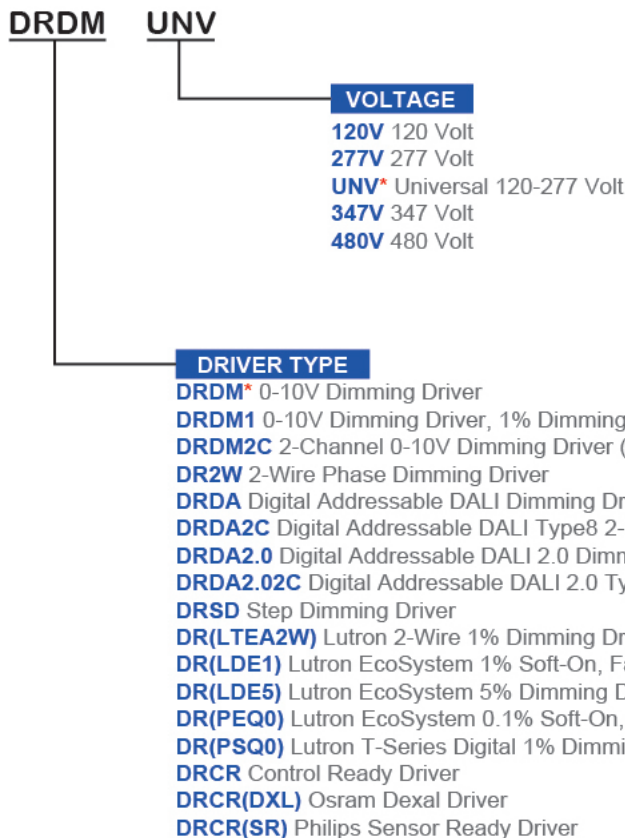

**BATTERY PACK OPTIONS**

PLEASE CONSULT FACTORY TO SEE IF YOUR SELECTED BATTERY PACK OPTION WORKS WITH THIS FIXTURE.

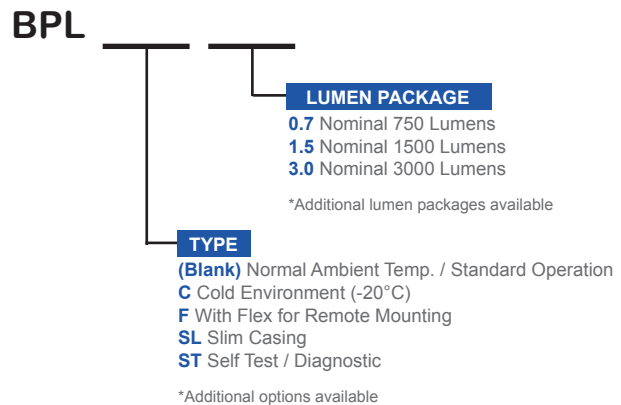

**Los Angeles Lighting Mfg. Co.**  
 Headquarters    Contact Us  
 10141 Olney Street    T: 626-454-8300  
 El Monte, CA 91731    F: 626-454-8399  
 Made in the USA    www.lalighting.com



**BAA Compliant**



Due to continued product improvements and enhancements, Los Angeles Lighting Manufacturing Company reserves the right to alter specifications, dimensions, data, and/or materials without notice. Please visit our website to view the most current information.



**MADE IN THE U.S.A.**

Revised 01/30/20

**WARNING**