



BAYLIGHTER®

EBY350

SERIES 2FT, 4FT



ENCLOSED HIGH BAY LUMINAIRE

ORDERING INFO SYSTEM DATA DRIVER OPTIONS SENSOR OPTIONS PHOTOMETRIC DATA

INTERACTIVE BUTTONS

JOB	
TYPE	
DATE	

LALIGHTING.COM

626-454-8300

**SURFACE / SUSPENSION / PENDANT MOUNTED
HIGH BAY LED LUMINAIRE**



APPLICATIONS

- Commercial, Industrial, Warehouse

FEATURES

- **High (HT)** Ambient temperature version available for extreme temperature ranges
- 0-10V dimming driver standard
- Supports California Title 24 compliance
- Safety cables attached to door frame and LED gear tray

OPTIONS

- Customization available upon request
- (Wireless) Controls and sensors
- Emergency battery pack
- 11 gauge wire guard available
- Cable suspension systems and pendant mounting adapter available
- Hub and fixture stabilizer

SPECIFICATIONS

CONSTRUCTION

- 22 gauge cold-rolled steel housing with louvered vents for heat removal
- 20 gauge cold-rolled steel door frame secured by T-hinges and positive spring loaded latches
- One-way polyurethane gasket standard

FINISH

- Baked white polyester finish (powder coated finish available) / minimum reflectance 86%

OPTICAL

- Clear prismatic acrylic lens standard

ELECTRICAL

- High efficiency drivers coupled with long-life LEDs
- Service life tested at 50,000 hours (L70)
- Universal voltage 120V through 277V (347V / 480V available)
- Power Factor (PF) ≥ 0.9
- Total Harmonic Distortion (THD) ≤ 20%

LISTING

- UL USA and Canada listed / suitable for damp locations

WARRANTY

- 5-year limited warranty, 10-year limited warranty available



Los Angeles Lighting Mfg. Co.
 Contact Us
 T: 626-454-8300 10141 Olney Street
 F: 626-454-8399 El Monte, CA 91731
 www.lalighting.com Made in the USA



Due to continued product improvements and enhancements, Los Angeles Lighting Manufacturing Company reserves the right to alter specifications, dimensions, data, and/or materials without notice. Please visit our website to view the most current information.

© 2022 LOS ANGELES LIGHTING MANUFACTURING CO. ALL RIGHTS RESERVED.

Revised 11/24/20



ORDERING INFORMATION

EXAMPLE: EBY350-8-2L-PA2-BPL1.5-DRDM-UNV-2/850HT

BACK TO TOP

SERIES	LED LUMEN PACKAGE	EFFICACY	NOMINAL LENGTH	OPTICAL / DOOR FRAME	MECHANICAL	ELECTRICAL	DRIVER	VOLTAGE	# OF LED ROW	CRI / CCT	AMBIENT TEMP.
EBY350							DRDM	UNV			
EBY350 • Enclosed High Bay LED Luminaire	2-foot lengths 8 Nom. 8000lm • Avail. in (HT) 12 Nom. 12000lm • Avail. in (HT) 16 Nom. 16000lm • Avail. in (HT) 4-foot lengths 24 Nom. 24000lm • Avail. in (HT) 32 Nom. 32000lm • Avail. only in (HT) 36 Nom. 32000lm • Avail. only in (HT) *Additional Lumen Packages Available	HE • High Efficacy 2-foot only • 12000lm 4-foot only • 24000lm *HE cannot be combine with HT systems	2L • 2-foot 4L • 4-foot	PA • Clear Prismatic Acrylic PA2 • Clear Prismatic Acrylic Nom. 0.125 FPA2 • Frosted Prismatic Acrylic Nom. 0.125 XX • No Door & Lens Assembly	HUB • Aluminum Die Cast Hub (Safety Cable Set Included) SMA • Pendant Mounting Adapter (Safety Cable Set Included) STA • Fixture Stabilizer *Leave Blank if Not Specified	BPL1.5 • Emergency Battery Pack, Constant Nom. 1500 lm MSxx • Motion Sensor *Leave Blank if Not Specified	DRDM • 0-10V Dimming Driver	UNV • 120V-277V	2 • 2 LED Rows • 8000lm 2' • 8000lm 2' HT • 12000lm 2' HT • 16000lm 2' HT • 24000lm 4' HT • 32000lm 4' HT 4 • 4 LED Rows • 24000lm 4' • 24000lm 4' HE • 36000lm 4' HT	830 • 80+CRI / 3000K Color Temp. 835 • 80+CRI / 4000K Color Temp. 840 • 80+CRI / 4000K Color Temp. 850 • 80+CRI / 4000K Color Temp. *Additional Color Temp. Available	HT • High Ambient Temp. *HT cannot be combine with HE systems

MECHANICAL OPTIONS | ELECTRICAL OPTIONS | DRIVERS OPTIONS | SENSOR OPTIONS

INTERACTIVE BUTTONS

CUSTOM COLORS

BLK - Matte Black

CS - Camaro Silver

BZ - Statuary Bronze

Variety of RAL colors available upon request.



DIMENSIONS

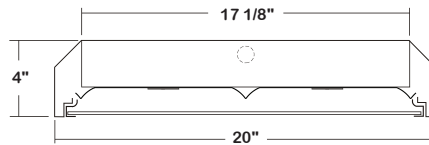

- ⊕ ACCESS PLATE
- ⊕ 2" K.O.
- ⊕ 7/8" OFFSET K.O.
- ◆ 11/16" STEM MTG. K.O.
- V-HOOK
- 3/16" K.O.

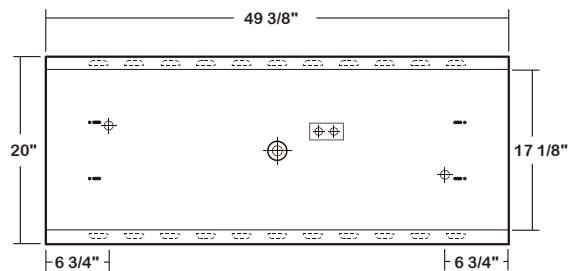
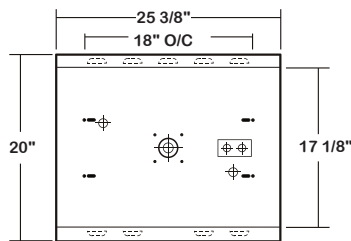

NOTE:

Actual performance may differ as a result of end-user environment and application.

HT: High Ambient Operating Maximum 55°C (48000 lumens, No Lens)

Normal: This fixture has been tested and listed in accordance with UL Standards. L.A. Lighting certifies that it will operate safely when installed properly, and within an ambient temperature range from -20°C to 35°C.

Additional lumen packages and color temperatures available.



Los Angeles Lighting Mfg. Co.
Contact Us
T: 626-454-8300
F: 626-454-8399
www.lalighting.com
10141 Olney Street
El Monte, CA 91731
Made in the USA



Due to continued product improvements and enhancements, Los Angeles Lighting Manufacturing Company reserves the right to alter specifications, dimensions, data, and/or materials without notice. Please visit our website to view the most current information.

© 2022 LOS ANGELES LIGHTING MANUFACTURING CO. ALL RIGHTS RESERVED.

Revised 11/24/20



SYSTEM DATA THESE ARE THE MOST POPULAR LUMEN PACKAGES. PLEASE CONSULT FACTORY FOR ADDITIONAL SYSTEM DATA.

[BACK TO TOP](#)

2' - LED LUMEN PACKAGE	NORMAL AMBIENT TEMPERATURE PRODUCT CODE	DELIVERED LUMENS	SYSTEM WATTS	LUMINAIRE EFFICACY	AMBIENT TEMP.	FLUORESCENT EQUIVALENT	IES FILES
8000 Lumens (Nominal)	EBY350-8-2L-PA-DRDM-UNV-2/850	6888	53.8	128.1 lm/W	-20°C / 35°C (-4°F / 95°F)	4-F32T8, 2-F54T5HO 175W MH	*
8000 Lumens (Nominal)	EBY350-8-2L-XX-DRDM-UNV-2/850	8101	53.8	150.6 lm/W	-20°C / 35°C (-4°F / 95°F)	4-F32T8, 2-F54T5HO 175W MH	*
12000 Lumens (Nominal)	EBY350-12-2L-PA-DRDM-UNV-2/850	9921	104.6	94.8 lm/W	-20°C / 35°C (-4°F / 95°F)	6-F32T8, 3-F54T5HO 250W MH	*
12000 Lumens (Nominal)	EBY350-12-2L-XX-DRDM-UNV-2/850	11636	104.6	111.2 lm/W	-20°C / 35°C (-4°F / 95°F)	6-F32T8, 3-F54T5HO 250W MH	*
2' - LED LUMEN PACKAGE	NORMAL AMBIENT TEMPERATURE (HIGH EFFICACY) PRODUCT CODE	DELIVERED LUMENS	SYSTEM WATTS	LUMINAIRE EFFICACY	AMBIENT TEMP.	FLUORESCENT EQUIVALENT	IES FILES
8000 Lumens (Nominal)	EBY350-8HE-2L-PA-DRDM-UNV-2/850	7089	51.8	136.7 lm/W	-20°C / 35°C (-4°F / 95°F)	4-F32T8, 2-F54T5HO 175W MH	*
8000 Lumens (Nominal)	EBY350-8HE-2L-XX-DRDM-UNV-2/850	8314	51.8	160.4 lm/W	-20°C / 35°C (-4°F / 95°F)	4-F32T8, 2-F54T5HO 175W MH	*
12000 Lumens (Nominal)	EBY350-12HE-2L-PA-DRDM-UNV-2/850	9921	104.6	94.8 lm/W	-20°C / 35°C (-4°F / 95°F)	6-F32T8, 3-F54T5HO 250W MH	*
12000 Lumens (Nominal)	EBY350-12HE-2L-XX-DRDM-UNV-2/850	11636	104.6	111.2 lm/W	-20°C / 35°C (-4°F / 95°F)	6-F32T8, 3-F54T5HO 250W MH	*
2' - LED LUMEN PACKAGE	HIGH AMBIENT TEMPERATURE PRODUCT CODE	DELIVERED LUMENS	SYSTEM WATTS	LUMINAIRE EFFICACY	AMBIENT TEMP.	FLUORESCENT EQUIVALENT	IES FILES
16000 Lumens (Nominal)	EBY350-16-2L-PA-DRDM-UNV-2/850HT	13774	107.6	128.0 lm/W	-30°C / 50°C (-22°F / 122°F)	8-F32T8, 4-F54T5HO 400W MH	*
16000 Lumens (Nominal)	EBY350-16-2L-XX-DRDM-UNV-2/850HT	16203	107.6	100.6 lm/W	-30°C / 50°C (-22°F / 122°F)	8-F32T8, 4-F54T5HO 400W MH	*
4' - LED LUMEN PACKAGE	NORMAL AMBIENT TEMPERATURE PRODUCT CODE	DELIVERED LUMENS	SYSTEM WATTS	LUMINAIRE EFFICACY	AMBIENT TEMP.	FLUORESCENT EQUIVALENT	IES FILES
24000 Lumens (Nominal)	EBY350-24-4L-FPA2-DRDM-UNV-4/850	19641	160.90	122.07 lm/W	-20°C / 35°C (-4°F / 95°F)	6-F54T5HO 400W MH	*
24000 Lumens (Nominal)	EBY350-24-4L-PA-DRDM-UNV-4/850	19907	160.90	123.72 lm/W	-20°C / 35°C (-4°F / 95°F)	6-F54T5HO 400W MH	*
24000 Lumens (Nominal)	EBY350-24-4L-XX-DRDM-UNV-4/850	24045	160.90	194.44 lm/W	-20°C / 35°C (-4°F / 95°F)	6-F54T5HO 400W MH	*
4' - LED LUMEN PACKAGE	NORMAL AMBIENT TEMPERATURE (HIGH EFFICACY) PRODUCT CODE	DELIVERED LUMENS	SYSTEM WATTS	LUMINAIRE EFFICACY	AMBIENT TEMP.	FLUORESCENT EQUIVALENT	IES FILES
24000 Lumens (Nominal)	EBY350-24HE-4L-FPA2-DRDM-UNV-4/850	19501	141.47	137.85 lm/W	-20°C / 35°C (-4°F / 95°F)	6-F54T5HO, 400W MH	*
24000 Lumens (Nominal)	EBY350-24HE-4L-PA-DRDM-UNV-4/850	19764	141.47	139.71 lm/W	-20°C / 35°C (-4°F / 95°F)	6-F54T5HO, 400W MH	*
24000 Lumens (Nominal)	EBY350-24HE-4L-XX-DRDM-UNV-4/850	23873	141.47	168.76 lm/W	-20°C / 35°C (-4°F / 95°F)	4-F54T5HO 400W MH	*
4' - LED LUMEN PACKAGE	HIGH AMBIENT TEMPERATURE PRODUCT CODE	DELIVERED LUMENS	SYSTEM WATTS	LUMINAIRE EFFICACY	AMBIENT TEMP.	FLUORESCENT EQUIVALENT	IES FILES
24000 Lumens (Nominal)	EBY350-24-4L-FPA2-DRDM-UNV-2/850HT	19900	149.60	133.04 lm/W	-30°C / 50°C (-22°F / 122°F)	6-F54T5HO, 400W MH	*
24000 Lumens (Nominal)	EBY350-24-4L-PA-DRDM-UNV-2/850HT	20244	149.60	135.32 lm/W	-30°C / 50°C (-22°F / 122°F)	6-F54T5HO, 400W MH	LA-T3584
24000 Lumens (Nominal)	EBY350-24-4L-XX-DRDM-UNV-2/850HT	23654	149.60	158.11 lm/W	-30°C / 50°C (-22°F / 122°F)	4-F54T5HO 400W MH	*
32000 Lumens (Nominal)	EBY350-32-4L-FPA2-DRDM-UNV-2/850HT	26554	197.30	134.59 lm/W	-30°C / 50°C (-22°F / 122°F)	8-F54T5HO	*
32000 Lumens (Nominal)	EBY350-32-4L-PA-DRDM-UNV-2/850HT	27016	197.30	136.93 lm/W	-30°C / 50°C (-22°F / 122°F)	8-F54T5HO	*
32000 Lumens (Nominal)	EBY350-32-4L-XX-DRDM-UNV-2/850HT	31563	197.30	159.97 lm/W	-30°C / 50°C (-22°F / 122°F)	8-F54T5HO	*
36000 Lumens (Nominal)	EBY350-36-4L-FPA2-DRDM-UNV-4/850HT	29226	216.14	135.22 lm/W	-30°C / 50°C (-22°F / 122°F)	6-F54T5HO, 400W MH	LA-T3585
36000 Lumens (Nominal)	EBY350-36-4L-PA-DRDM-UNV-4/850HT	29620	216.14	137.04 lm/W	-30°C / 50°C (-22°F / 122°F)	6-F54T5HO, 400W MH	LA-T3256
36000 Lumens (Nominal)	EBY350-36-4L-XX-DRDM-UNV-4/850HT	35778	216.14	165.54 lm/W	-30°C / 50°C (-22°F / 122°F)	4-F54T5HO 400W MH	*



Los Angeles Lighting Mfg. Co.
 Contact Us
 T: 626-454-8300
 F: 626-454-8399
 www.lalighting.com

10141 Olney Street
 El Monte, CA 91731
 Made in the USA



Due to continued product improvements and enhancements, Los Angeles Lighting Manufacturing Company reserves the right to alter specifications, dimensions, data, and/or materials without notice. Please visit our website to view the most current information.

© 2022 LOS ANGELES LIGHTING MANUFACTURING CO. ALL RIGHTS RESERVED.

Revised 11/24/20



DRIVER OPTIONS

PLEASE CONSULT FACTORY TO SEE IF YOUR SELECTED DRIVER OPTION WORKS WITH THIS FIXTURE.

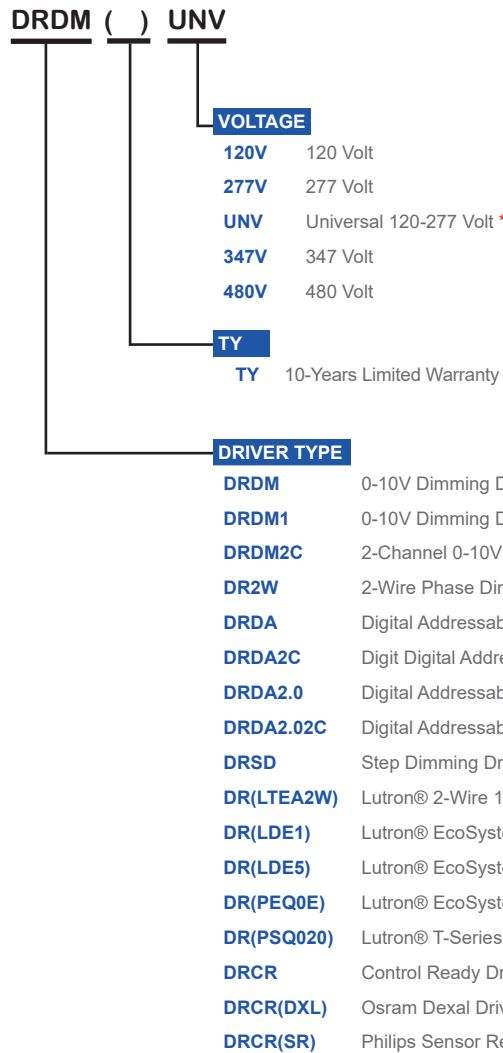

BATTERY PACK OPTIONS

[BACK TO TOP](#)

PLEASE CONSULT FACTORY TO SEE IF YOUR SELECTED BATTERY PACK OPTION WORKS WITH THIS FIXTURE.

LED EMERGENCY BATTERY PACKS
(Operate for 90 minutes unless otherwise specified)

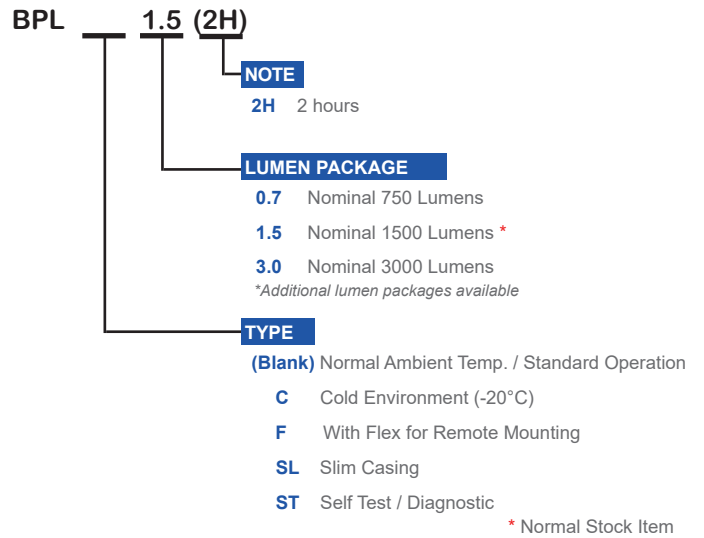

GASKET

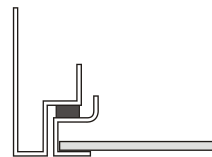
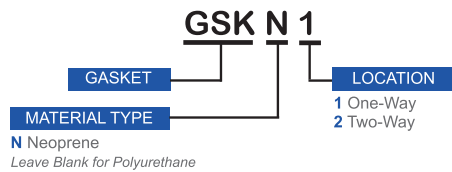

GSKN1 One-Way Neoprene Gasket

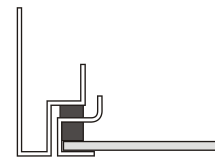

GSKN2 Two-Way Neoprene Gasket



Los Angeles Lighting Mfg. Co.
 Contact Us
 T: 626-454-8300 10141 Olney Street
 F: 626-454-8399 El Monte, CA 91731
 www.lalighting.com Made in the USA



Due to continued product improvements and enhancements, Los Angeles Lighting Manufacturing Company reserves the right to alter specifications, dimensions, data, and/or materials without notice. Please visit our website to view the most current information.

© 2022 LOS ANGELES LIGHTING MANUFACTURING CO. ALL RIGHTS RESERVED.

Revised 11/24/20



SENSOR OPTIONS

[BACK TO TOP](#)

DRY AND DAMP LOCATIONS - HIGH / LOW AISLE MOUNTING APPLICATIONS - END MOUNT

MS - Motion Sensor

- Turns light ON/OFF based on motion detection
- Fixture mounting height 8-45'
- Universal Voltage (120V-277V)
- 480V available

MSSD - Motion Sensor – Step Dimming

- Step-dims light to desired preset level (based on motion detection)
- Used in conjunction with 0-10V Ballast/Driver
- Fixture mounting height 8-45'
- Universal Voltage (120V-277V)

MSPC - Motion Sensor & Photocell

- Holds lights OFF when sufficient daylight is present regardless of motion detection
- Fixture mounting height 8-45'
- Universal Voltage (120V-277V)

MSPCD(ADC) - Motion Sensor & PhotoCell Dimming (Auto Dim Control)

- Variably dims output to desired preset footcandle level through photocell ON/OFF with motion detection
- Used in conjunction with 0-10V Ballast/Driver
- Fixture mounting height 8-45'
- Universal Voltage (120V-277V)

MSPCD(ANL) - Motion Sensor & Photocell Dimming (Auto Night Light)

- Variably dims output to desired footcandles through photocell
- Low setting when unoccupied (full on with motion)
- For 24 hour use
- Used in conjunction with 0-10V Ballast/Driver
- Fixture mounting height 8-45'
- Universal Voltage (120V-277V)

MSPCDR - Motion Sensor & Photocell Dimming (Setup with Remote Control)

- Field adjustable dimming sensor capabilities:
 - Step Dim (HIGH/LOW output)
 - Auto Dim Control (dim to desired footcandles, ON/OFF with motion)
 - Auto Night Light (dim to desired footcandles, LOW without motion)
- Used in conjunction with 0-10V dimming Ballast/Driver
- Holds lights OFF when sufficient daylight is present regardless of motion detection
- Adjustable ramp up and fade down time
- Fixture mounting height 8-40'
- Universal Voltage (120V-277V)
- Remote setup and adjustment with handheld wireless tool (sold separately)

PCS - Photocell Sensor

- Turns light ON/OFF based on light levels
- Fixture mounting height 8-45'
- Universal Voltage (120V-277V)

PCD - Photocell Dimming

- Dims output to desired footcandles through photocell
- Used in conjunction with 0-10V Ballast/Driver
- Fixture mounting height 8-45'
- Universal Voltage (120V-277V)

ACCESSORIES

[BACK TO TOP](#)

V6

- 6" Leg Height V-Hook
- Two (2) per fixture

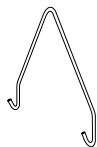

WG11-EBY350

- 11 ga. Wire Guard
- Chrome epoxy powder coated finish

SMA

- Pendant Mounting Adapter
- 20 ga. die formed galvanized steel construction
- Die cast aluminum hub for 3/4" pipe pre-installed
- Designed for single point pendant mount applications

Note: Must request pre-punched holes from factory.

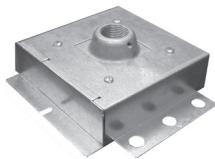

Cable Suspension System

- See [Mechanical Options](#) for additional Cable Suspension Systems

YTCS10

- Y-Toggle-End / Cable Suspension System

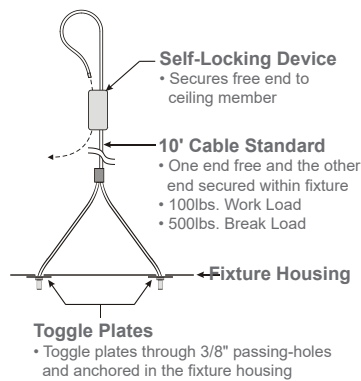

V6CS10

- V-Hook / Cable Suspension System
- Cable set with V6 hooks

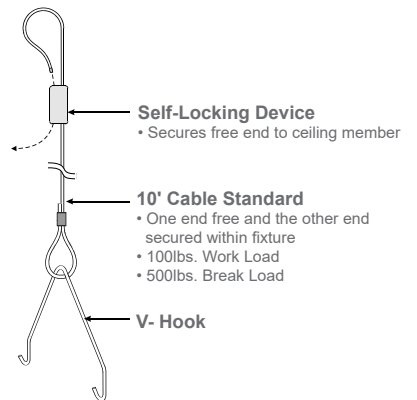

Ceiling Spacers

- Minimum one (1) of each per fixture
- Must drill own holes

Note: Ceiling spacers only required when 32000 / 36000 lumen system is specified.

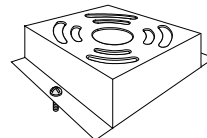

FIS-7

- Feed-In spacer mounts to junction box, spaces fixture 1 1/2" from ceiling

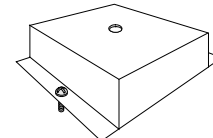

CS-3

- Closed spacer, spaces fixture 1 1/2" from ceiling



Los Angeles Lighting Mfg. Co.
 Contact Us
 T: 626-454-8300 10141 Olney Street
 F: 626-454-8399 El Monte, CA 91731
 www.lalighting.com Made in the USA



Due to continued product improvements and enhancements, Los Angeles Lighting Manufacturing Company reserves the right to alter specifications, dimensions, data, and/or materials without notice. Please visit our website to view the most current information.

© 2022 LOS ANGELES LIGHTING MANUFACTURING CO. ALL RIGHTS RESERVED.

Revised 11/24/20



PHOTOMETRIC DATA - EBY350 SERIES

EBY350-24-4L-PA-DRDM-UNV-2/850HT

TEST NO. = LA-T3584
 LED TYPE = 144 LED MODULE
 NO. OF MODULE = 4
 SYSTEM WATT (W) = 149.6
 CRI ≥ 80
 L70(Hrs.) ≥ 50,000
 PHOTOMETRY TYPE = C

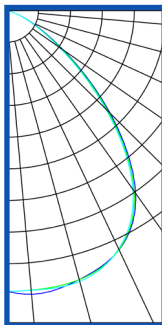
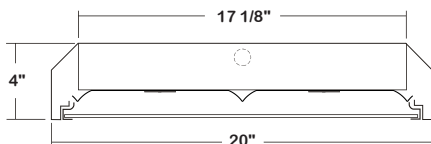

CANDLEPOWER

ANGLE	END	45	CROSS
0	9967	9967	9967
5	10111	9962	9968
15	9886	9888	9957
25	9372	9368	9338
35	7920	7835	7754
45	5168	5071	4949
55	2450	2367	2269
65	926	556	868
75	257	257	254
85	38	28	33
90	2	2	1
95	0	0	0
105	0	0	0
115	0	0	0
125	0	0	0
135	0	0	0
145	0	0	0
155	0	0	0
165	0	0	0
175	0	0	0
180	0	0	0

ZONAL LUMEN SUMMARY

DEGREES	LUMENS	% LAMP	% FIXTURE
0-30	8095	33.6	40.0
0-40	13018	54.1	64.3
0-60	19061	83.2	94.1
0-90	20247	84	100.0
90-120	0.0	0.0	0.0
90-150	0.0	0.0	0.0
90-180	0.0	0.0	0.0
0-180	20247	84.1	100.0

Luminaire Output = 20247.49 lumens
 Luminaire Efficacy = 135.34 lm/W
 Luminaire Efficiency = 84.14%

SPACING CRITERION

ALONG	ACROSS
1.2	1.25

EBY350-32-4L-PA-DRDM-UNV-2/850HT

TEST NO. = LA-T3585
 LED TYPE = 144 LED MODULE
 NO. OF MODULE = 4
 SYSTEM WATT (W) = 197.3
 CRI ≥ 80
 L70(Hrs.) ≥ 50,000
 PHOTOMETRY TYPE = C

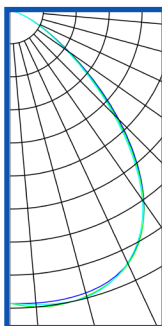
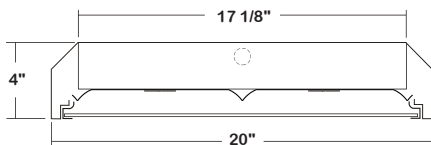

CANDLEPOWER

ANGLE	END	45	CROSS
0	13145	13145	13145
5	13175	13351	13239
15	13116	13265	13302
25	12513	12544	12496
35	10502	10477	10370
45	6913	6749	6574
55	3252	6151	6052
65	1220	1192	1141
75	347	342	332
85	54	52	51
90	1	2	2
95	0	0	0
105	0	0	0
115	0	0	0
125	0	0	0
135	0	0	0
145	0	0	0
155	0	0	0
165	0	0	0
175	0	0	0
180	0	0	0

ZONAL LUMEN SUMMARY

DEGREES	LUMENS	% LAMP	% FIXTURE
0-30	10816	33.6	40.0
0-40	17385	54.1	64.3
0-60	25437	79.2	94.2
0-90	27018	84.1	100.0
90-120	0.5	0.0	0.0
90-150	0.5	0.0	0.0
90-180	0.5	0.0	0.0
0-180	27018	84.2	100.0

Luminaire Output = 21844 lumens
 Luminaire Efficacy = 143.5 lm/W
 Luminaire Efficiency = 84.1%

SPACING CRITERION

ALONG	ACROSS
1.25	1.25

[BACK TO TOP](#)



Los Angeles Lighting Mfg. Co.
 Contact Us
 T: 626-454-8300 10141 Olney Street
 F: 626-454-8399 El Monte, CA 91731
 www.lalighting.com Made in the USA



Due to continued product improvements and enhancements, Los Angeles Lighting Manufacturing Company reserves the right to alter specifications, dimensions, data, and/or materials without notice. Please visit our website to view the most current information.

© 2022 LOS ANGELES LIGHTING MANUFACTURING CO. ALL RIGHTS RESERVED.

Revised 11/24/20

