



ARCHITECTURAL

ANG050

SERIES 2FT, 4FT, 8FT
ARCHITECTURAL MINIATURE ANGLED



JOB	
TYPE	
DATE	

WWW.LALIGHTING.COM

TEL: 626-454-8300

DIMENSIONS

CROSS SECTION

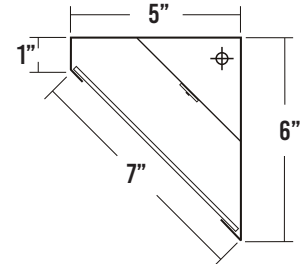

2' BACKPLATE

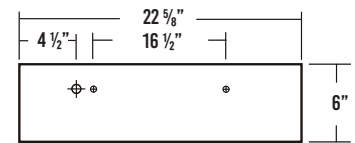

4' BACKPLATE

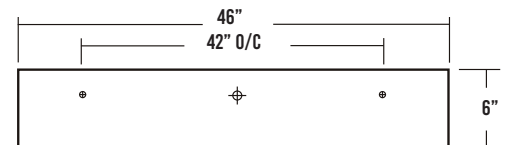

8' BACKPLATE

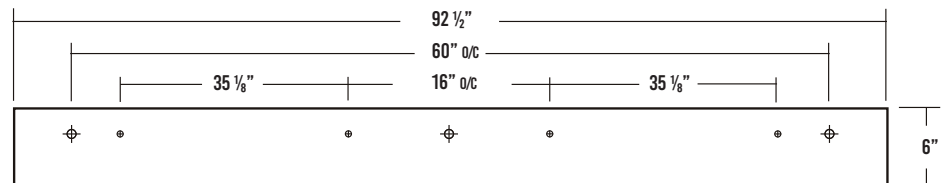

SPECIFICATIONS

CONSTRUCTION

- 20 gauge cold-rolled steel welded housing
- Frameless lift-and-shift lens

FINISH

- Baked white powder-coated finish
- Painted after fabrication
- Minimum reflectance 90%

OPTICAL

- Flat frosted white acrylic

ELECTRICAL

- High-efficiency drivers coupled with long-life LEDs
- Service life tested at 50,000 hours (L70)
- Universal voltage 120V through 277V (347V / 480V available)
- Power Factor (PF) ≥ 0.9
- Total Harmonic Distortion (THD) $\leq 20\%$

LISTING

- UL USA and Canada listed / suitable for damp locations

WARRANTY

- 5-Year limited warranty standard. 10-Year limited warranty also available

APPLICATIONS

Architectural, Retail, Corridor, Dormitory, Extended Care Facilities, Commercial

FEATURES

- 0-10V Dimming driver standard
- Suitable for damp locations
- Supports California Title 24 compliance

OPTIONS CONTACT CUSTOMER SERVICE FOR ADDITIONAL OPTIONS

- Controls
- Variety of lenses
- Custom housing colors
- Emergency battery pack
- Tunable white (2700K-6500K)
- Customization available upon request

CUSTOM COLORS

BLK - Matte Black

CS - Camaro Silver

BZ - Bronze



Variety of RAL colors available upon request.



Los Angeles Lighting Mfg. Co.
Contact Us
T: 626-454-8300
F: 626-454-8399
www.lalighting.com
10141 Olney Street
El Monte, CA 91731
Made in the USA



Due to continued product improvements and enhancements, Los Angeles Lighting Manufacturing Company reserves the right to alter specifications, dimensions, data, and/or materials without notice. Please visit our website to view the most current information.

© 2022 LOS ANGELES LIGHTING MANUFACTURING CO. ALL RIGHTS RESERVED.

Revised: 6/10/2024



ORDERING INFORMATION **ADDITIONAL OPTIONS AVAILABLE. VISIT WWW.LALIGHTING.COM/RESOURCES FOR MORE INFORMATION**

EXAMPLE: ANG050-4-4L-FFWA-BPL1.5-DRDM-UNV-1/840

SERIES	NOMINAL LED LUMENS	NOMINAL LENGTH	COLOR	OPTICAL	CONTROLS	ELECTRICAL	DRIVER	VOLTAGE	# OF LED ROWS	CRI / CCT
ANG050									1	
ANG050 • Architectural Miniature Angled LED Luminaire	1 - 1000lm 2 - 2000lm 3 - 3000lm 4 - 4000lm High Efficacy 1HE - 1000lm 2HE - 2000lm 3HE - 3000lm	2L • 2'	(Blank) • Standard White BLK • Matte Black BZ • Bronze CS • Camaro Silver	FFWA • Flat Frosted White Acrylic FPA • Frosted Prismatic Acrylic PA • Clear Prismatic Acrylic	WLC(xx) • Wireless Control	BPL1.5 • Emergency Battery Pack 1500 lm *Leave blank if not specified	DRDM • 0-10V Dimming Driver	UNV • 120V-277V	1 • 1 LED Row	827 • 80+CRI / 2700K 830 • 80+CRI / 3000K 835 • 80+CRI / 3500K 840 • 80+CRI / 4000K 850 • 80+CRI / 5000K 865 • 80+CRI / 6500K 8TW • 80+CRI Tunable White 2700K-6500K Requires DRDM2C driver 90CRI Also available Contact customer service for additional CRI/CCT packages.
	2 - 2000lm 4 - 4000lm 6 - 6000lm 8 - 8000lm High Efficacy 2HE - 2000lm 4HE - 4000lm 6HE - 6000lm	4L • 4'								
	4 - 4000lm 8 - 8000lm 12 - 12000lm 16 - 16000lm High Efficacy 4HE - 4000lm 8HE - 8000lm 12HE - 12000lm	8L • 8'								
<p><i>Standard options for ANG050 shown above. For additional options, including lumen packages, controls, lenses, switches, finishes, and more, visit www.lalighting.com/resources or contact customer service.</i></p>										

OPTICAL OPTIONS **ADDITIONAL LENSES AVAILABLE. VISIT WWW.LALIGHTING.COM/RESOURCES FOR MORE INFORMATION**

STANDARD LENSES FOR ANG050

FFWA	Frosted Flat White Acrylic, No Thickness Specified
FPA	Frosted Prismatic Acrylic, No Thickness Specified, Female Prisms 3/16 Square Base
PA	Clear Prismatic Acrylic, No Thickness Specified, Female Prisms 3/16 Square Base



Los Angeles Lighting Mfg. Co.
 Contact Us
 T: 626-454-8300 10141 Olney Street
 F: 626-454-8399 El Monte, CA 91731
www.lalighting.com Made in the USA



Due to continued product improvements and enhancements, Los Angeles Lighting Manufacturing Company reserves the right to alter specifications, dimensions, data, and/or materials without notice. Please visit our website to view the most current information.

© 2022 LOS ANGELES LIGHTING MANUFACTURING CO. ALL RIGHTS RESERVED.

Revised: 6/10/2024



SYSTEM DATA

ADDITIONAL LUMEN PACKAGES AVAILABLE. CONTACT CUSTOMER SERVICE FOR MORE INFORMATION

2' - LED LUMEN PACKAGE	NORMAL AMBIENT TEMPERATURE PRODUCT CODE	DELIVERED LUMENS	SYSTEM WATTS	LUMINAIRE EFFICACY	AMBIENT TEMP.	FLUORESCENT EQUIVALENT	IES FILES
1000 Lumens (Nominal)	ANG050-1-2L-FFWA-DRDM-UNV-1/840	996	7.6	132.8 lm/W	-20°C / 35°C (-4°F / 95°F)	1-F17T8	*
2000 Lumens (Nominal)	ANG050-2-2L-FFWA-DRDM-UNV-1/840	1635	12.7	128.4 lm/W	-20°C / 35°C (-4°F / 95°F)	2-F17T8 1-F24T5HO	*
3000 Lumens (Nominal)	ANG050-3-2L-FFWA-DRDM-UNV-1/840	2567	20.9	122.9 lm/W	-20°C / 35°C (-4°F / 95°F)	3-F17T8	*
4000 Lumens (Nominal)	ANG050-4-2L-FFWA-DRDM-UNV-1/840	3171	26.5	119.5 lm/W	-20°C / 35°C (-4°F / 95°F)	4-F17T8 2-F24T5HO	*
2' - LED LUMEN PACKAGE	NORMAL AMBIENT TEMPERATURE (HIGH EFFICACY) PRODUCT CODE	DELIVERED LUMENS	SYSTEM WATTS	LUMINAIRE EFFICACY	AMBIENT TEMP.	FLUORESCENT EQUIVALENT	IES FILES
1000 Lumens (Nominal)	ANG050-1HE-2L-FFWA-DRDM-UNV-1/840	1012	7.4	136.4 lm/W	-20°C / 35°C (-4°F / 95°F)	1-F17T8	*
2000 Lumens (Nominal)	ANG050-2HE-2L-FFWA-DRDM-UNV-1/840	1667	12.5	133.7 lm/W	-20°C / 35°C (-4°F / 95°F)	2-F17T8 1-F24T5HO	*
3000 Lumens (Nominal)	ANG050-3HE-2L-FFWA-DRDM-UNV-1/840	2635	20.2	130.2 lm/W	-20°C / 35°C (-4°F / 95°F)	3-F17T8	*
4' - LED LUMEN PACKAGE	NORMAL AMBIENT TEMPERATURE PRODUCT CODE	DELIVERED LUMENS	SYSTEM WATTS	LUMINAIRE EFFICACY	AMBIENT TEMP.	FLUORESCENT EQUIVALENT	IES FILES
2000 Lumens (Nominal)	ANG050-2-4L-FFWA-DRDM-UNV-1/840	1689	12.4	135.8 lm/W	-20°C / 35°C (-4°F / 95°F)	1-F32T8	*
4000 Lumens (Nominal)	ANG050-4-4L-FFWA-DRDM-UNV-1/840	3315	25.5	130.1 lm/W	-20°C / 35°C (-4°F / 95°F)	2-F32T8 1-F54T5HO	*
6000 Lumens (Nominal)	ANG050-6-4L-FFWA-DRDM-UNV-1/840	4893	39.0	125.5 lm/W	-20°C / 35°C (-4°F / 95°F)	3-F32T8	*
8000 Lumens (Nominal)	ANG050-8-4L-FFWA-DRDM-UNV-1/840	6425	53.1	121.1 lm/W	-20°C / 35°C (-4°F / 95°F)	4-F32T8 2-F54T5HO	*
4' - LED LUMEN PACKAGE	NORMAL AMBIENT TEMPERATURE (HIGH EFFICACY) PRODUCT CODE	DELIVERED LUMENS	SYSTEM WATTS	LUMINAIRE EFFICACY	AMBIENT TEMP.	FLUORESCENT EQUIVALENT	IES FILES
2000 Lumens (Nominal)	ANG050-2HE-4L-FFWA-DRDM-UNV-1/840	1716	12.3	139.6 lm/W	-20°C / 35°C (-4°F / 95°F)	1-F32T8	*
4000 Lumens (Nominal)	ANG050-4HE-4L-FFWA-DRDM-UNV-1/840	3377	24.9	135.7 lm/W	-20°C / 35°C (-4°F / 95°F)	2-F32T8 1-F54T5HO	*
6000 Lumens (Nominal)	ANG050-6HE-4L-FFWA-DRDM-UNV-1/840	5014	37.8	132.8 lm/W	-20°C / 35°C (-4°F / 95°F)	3-F32T8	*
8' - LED LUMEN PACKAGE	NORMAL AMBIENT TEMPERATURE PRODUCT CODE	DELIVERED LUMENS	SYSTEM WATTS	LUMINAIRE EFFICACY	AMBIENT TEMP.	FLUORESCENT EQUIVALENT	IES FILES
4000 Lumens (Nominal)	ANG050-4-8L-FFWA-DRDM-UNV-1/840	3392	24.9	136.3 lm/W	-20°C / 35°C (-4°F / 95°F)	2-F32T8 1-F54T5HO	*
8000 Lumens (Nominal)	ANG050-8-8L-FFWA-DRDM-UNV-1/840	6658	50.9	130.7 lm/W	-20°C / 35°C (-4°F / 95°F)	4-F32T8 2-F54T5HO	*
12000 Lumens (Nominal)	ANG050-12-8L-FFWA-DRDM-UNV-1/840	9829	78.0	126.0 lm/W	-20°C / 35°C (-4°F / 95°F)	6-F32T8 3-F54T5HO	*
16000 Lumens (Nominal)	ANG050-16-8L-FFWA-DRDM-UNV-1/840	12896	106.1	121.5 lm/W	-20°C / 35°C (-4°F / 95°F)	8-F32T8 4-F54T5HO	*
8' - LED LUMEN PACKAGE	NORMAL AMBIENT TEMPERATURE (HIGH EFFICACY) PRODUCT CODE	DELIVERED LUMENS	SYSTEM WATTS	LUMINAIRE EFFICACY	AMBIENT TEMP.	FLUORESCENT EQUIVALENT	IES FILES
4000 Lumens (Nominal)	ANG050-4HE-8L-FFWA-DRDM-UNV-1/840	3447	24.6	140.2 lm/W	-20°C / 35°C (-4°F / 95°F)	2-F32T8 1-F54T5HO	*
8000 Lumens (Nominal)	ANG050-8HE-8L-FFWA-DRDM-UNV-1/840	6452	47.2	136.8 lm/W	-20°C / 35°C (-4°F / 95°F)	4-F32T8 2-F54T5HO	*
12000 Lumens (Nominal)	ANG050-12HE-12L-FFWA-DRDM-UNV-1/840	9746	72.8	133.8 lm/W	-20°C / 35°C (-4°F / 95°F)	6-F32T8 3-F54T5HO	*

NOTE:

System data as of 4/18/25 (K-Boards).
 Luminaire efficiency: 2ft: 78.2%, 4ft: 79.2%, 8ft: 79.6%
 Subject to change without notice.

System data is based on 120V input voltage. Actual performance may differ as a result of end-user environment and application. This fixture has been tested and listed in accordance with UL Standards. L.A. Lighting certifies that it will operate safely when installed properly, and within an ambient temperature range noted in the system data table.

Additional lumen packages and color temperatures available.



Los Angeles Lighting Mfg. Co.
 Contact Us
 T: 626-454-8300 10141 Olney Street
 F: 626-454-8399 El Monte, CA 91731
 www.lalighting.com Made in the USA



Due to continued product improvements and enhancements, Los Angeles Lighting Manufacturing Company reserves the right to alter specifications, dimensions, data, and/or materials without notice. Please visit our website to view the most current information.

© 2022 LOS ANGELES LIGHTING MANUFACTURING CO. ALL RIGHTS RESERVED.

Revised: 6/10/2024

