



RECESSED FLUO FPA320

® RECESSED FLANGED PARABOLIC LUMINAIRE

JOB	
TYPE	
DATE	

WWW.LALIGHTING.COM

TEL: 626-454-8300

RECESSED FLANGED PARABOLIC TROFFER



Overall dimensions including flange: 26" x 50"
Required ceiling opening: 24 1/2" x 48 1/2"

DIMENSIONS

S12 CROSS SECTION

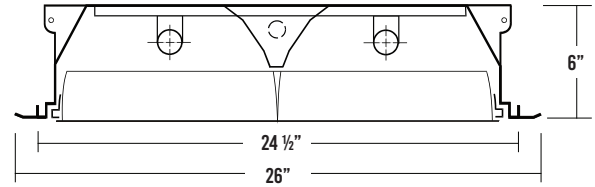

2 lamp rows shown. 4 rows also available.

S18 CROSS SECTION

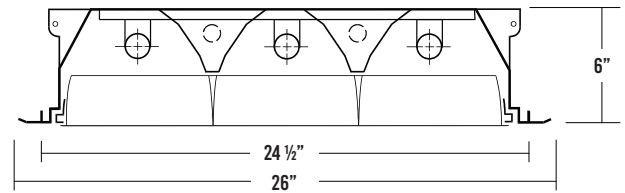

BACKPLATE

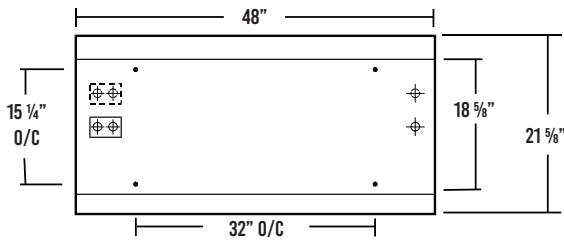

⊕ 7/8" K.O. ⊕ ACCESS PLATE • 3/8" K.O.

S12 LOUVER CONFIGURATION (2 LOUVER ROWS, 12 CELLS)

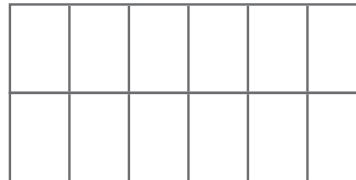

S18 LOUVER CONFIGURATION (3 LOUVER ROWS, 18 CELLS)

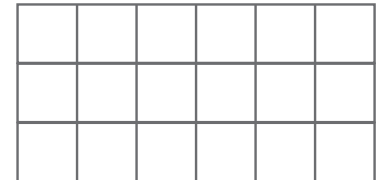

SPECIFICATIONS

CONSTRUCTION

- 22 gauge cold-rolled steel housing
- One piece welded trim flange
- Semi-specular, low iridescent aluminum louvers
- Louvers secured to housing with T-hinges and latches

FINISH

- Baked white polyester finish
- Minimum reflectance 86%
- Trim flange painted after fabrication

OPTICAL

- Nominal 3" deep aluminum parabolic louvers

LISTING

- UL USA and Canada Listed. Compatible with UL Fire-Rated Ceiling Assemblies.

WARRANTY

- 5-Year limited warranty standard. 10-Year limited warranty also available

APPLICATIONS

- Classrooms, Offices, Retail

FEATURES

- Recessed flanged luminaire for hard ceilings

OPTIONS CONTACT CUSTOMER SERVICE FOR ADDITIONAL OPTIONS

- Emergency battery packs
- 20 gauge housing
- Sensors and controls
- White louvers
- Customization available upon request



Los Angeles Lighting Mfg. Co.

Contact Us
T: 626-454-8300
F: 626-454-8399
www.lalighting.com
10141 Olney Street
El Monte, CA 91731
Made in the USA



Due to continued product improvements and enhancements, Los Angeles Lighting Manufacturing Company reserves the right to alter specifications, dimensions, data, and/or materials without notice. Please visit our website to view the most current information.

© 2023 LOS ANGELES LIGHTING MANUFACTURING CO. ALL RIGHTS RESERVED.

Revised: 07/24/23



ORDERING INFORMATION

ADDITIONAL OPTIONS AVAILABLE. VISIT WWW.LALIGHTING.COM/RESOURCES FOR MORE INFORMATION

FLUORESCENT PRODUCT PART # NOMENCLATURE

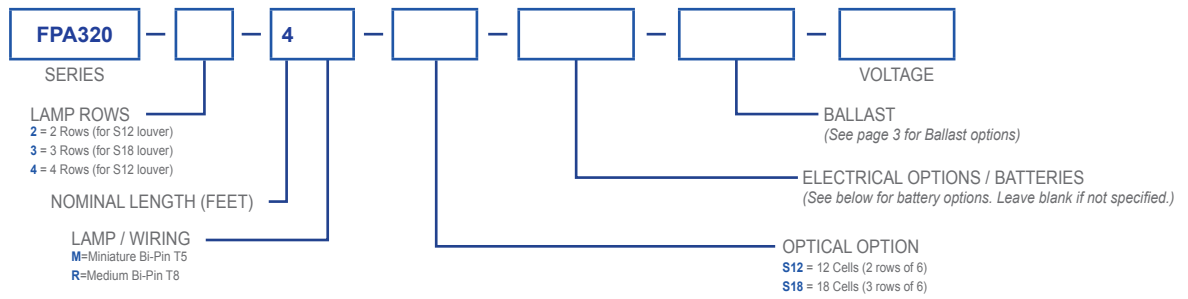

BATTERY PACK OPTIONS

FLUORESCENT EMERGENCY BATTERY PACKS (Minimum 90-minute operation)

BATTERY PACK REFERENCE CHART

To determine the suffix used when ordering (either BP1, BP5, or BP5B), first find your lamp type, length, and number of lamps required in emergency mode, then select your desired lumen output.

Lamp Type	Length	# Of Lamps in EM Mode	Emergency Output	
			500lm	1400lm
F28T5	4ft	1		BP5
F54T5HO (49W)	4ft	1		BP5
F54T5HO	4ft	1		BP5
F54T5HO	4ft	2		BP5B
F32T8 (25W)	4ft	1	BP1	BP5
F32T8 (28W)	4ft	1	BP1	BP5
F32T8 (28W)	4ft	2		BP5B
F32T8 (30W)	4ft	1	BP1	BP5
F32T8	4ft	1	BP1	BP5
F32T8	4ft	2		BP5B

MOUNTING OPTIONS

FPA320 MOUNTING OPTIONS

SWING-OUT JACK

- Spring-loaded adjustable mounting bracket for mounting in drywall or plaster type ceiling
- Four (4) per set; 1 set required per fixture

Catalog No. **SOJ**

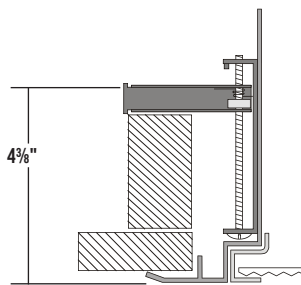

HANGER YOKE

- 1/4"-20 x 2 1/2" machine screws secure hanger yoke to fixture through knockouts in top of housing
- Two hanger yokes required for each 4' fixture.
- Hanger yoke dimensions 5 1/8"H x 24 1/2" W

Catalog No. **HS-24 1/2**

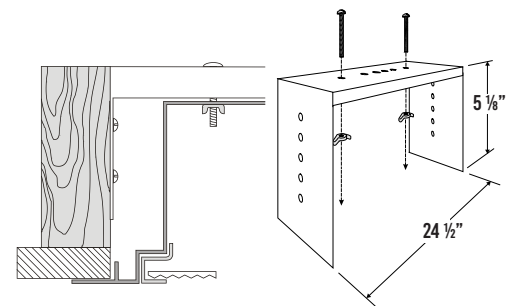

Los Angeles Lighting Mfg. Co.
 Contact Us
 T: 626-454-8300 10141 Olney Street
 F: 626-454-8399 El Monte, CA 91731
www.lalighting.com Made in the USA



Due to continued product improvements and enhancements, Los Angeles Lighting Manufacturing Company reserves the right to alter specifications, dimensions, data, and/or materials without notice. Please visit our website to view the most current information.

© 2023 LOS ANGELES LIGHTING MANUFACTURING CO. ALL RIGHTS RESERVED.

Revised: 07/24/23



MADE IN THE USA
BAA Compliant

BALLAST OPTIONS

FLUORESCENT BALLAST OPTIONS

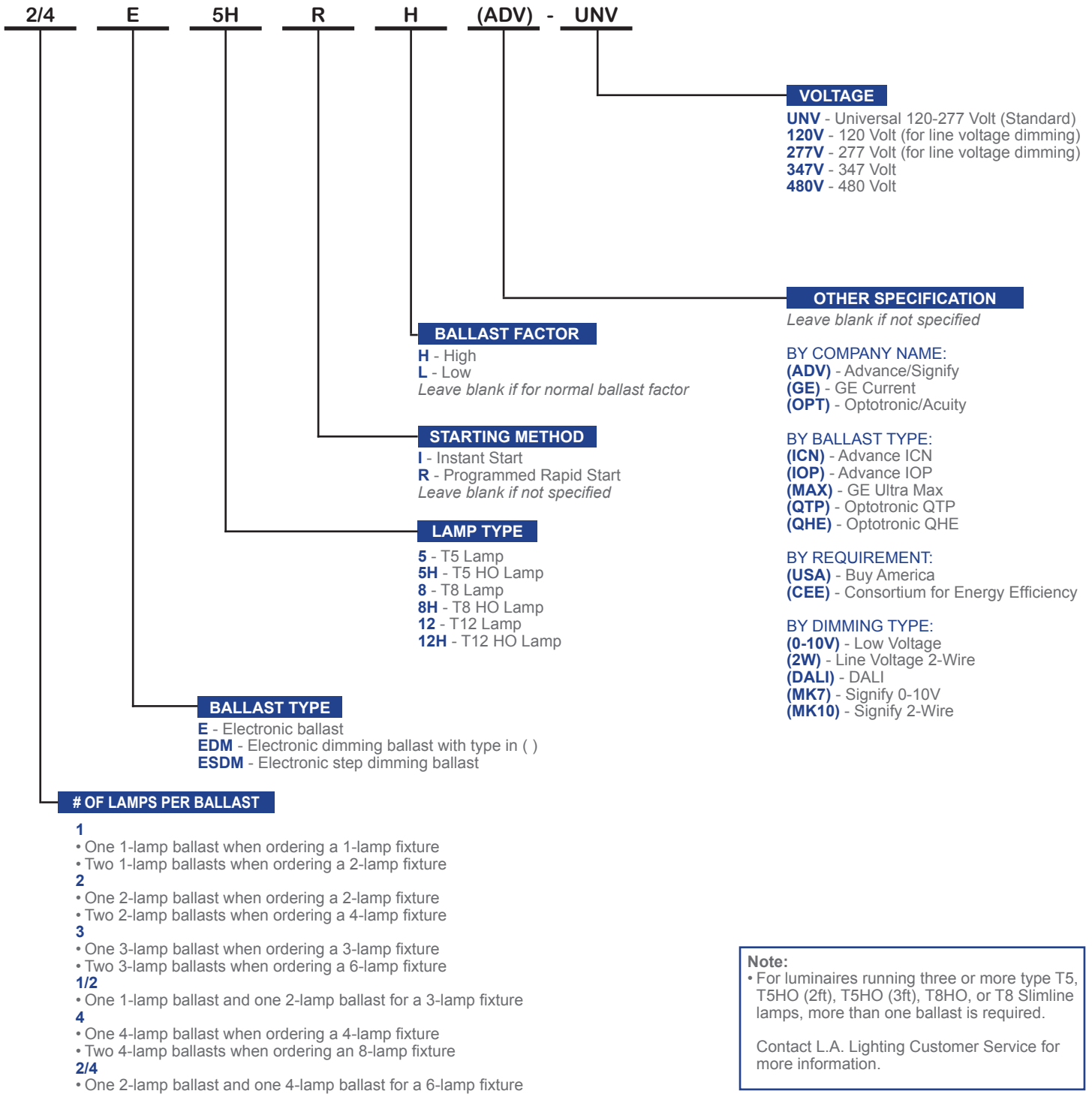

Los Angeles Lighting Mfg. Co.
 Contact Us
 T: 626-454-8300 10141 Olney Street
 F: 626-454-8399 El Monte, CA 91731
 www.lalighting.com Made in the USA



Due to continued product improvements and enhancements, Los Angeles Lighting Manufacturing Company reserves the right to alter specifications, dimensions, data, and/or materials without notice. Please visit our website to view the most current information.

© 2023 LOS ANGELES LIGHTING MANUFACTURING CO. ALL RIGHTS RESERVED.

Revised: 07/24/23



MADE IN THE USA
BAA Compliant