



# WRAPAROUND

## WSE251

SERIES 4FT, 8FT  
SENSOR CONTROLLED WRAPAROUND LUMINAIRE



JOB	
TYPE	
DATE	

### DIMENSIONS



#### CROSS SECTION

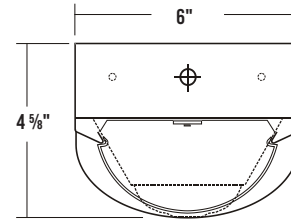

Note: On 8' luminaires, sensor is mounted in center.

#### 4' BACKPLATE

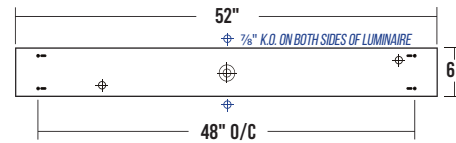

#### 8' BACKPLATE

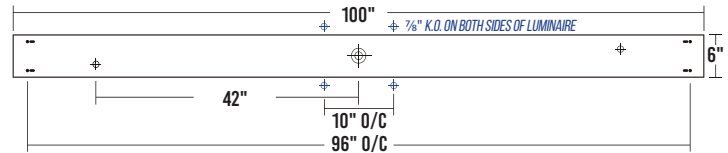

-- V-HOOK HOLE    ⊕ 7/8" OFFSET K.O.    ⊕ 2" K.O.

### SPECIFICATIONS

#### CONSTRUCTION

- Aluminum housing with riveted end plates
- Side knockouts for 1/2" conduit
- Neoprene gasketing on end caps

#### FINISH

- Pre-painted
- Baked white polyester finish
- Minimum reflectance 86%

#### OPTICAL

- Snap-on frosted acrylic radial lens

#### ELECTRICAL

- High efficiency drivers coupled with long-life LEDs
- Service life greater than 50,000 hours (L70)
- Universal voltage 120V through 277V (347V / 480V available)

#### LISTING

- UL USA and Canada listed / suitable for damp locations

#### WARRANTY

- 5-Year limited warranty standard. 10-Year limited warranty also available

### APPLICATIONS

- Stairwells, Parking Structures, Passageways, Workrooms, Restrooms

### FEATURES

- Integrated sensor
- 0-10V dimming driver standard
- Supports California Title 24 compliance
- Suitable for damp locations

### OPTIONS CONTACT CUSTOMER SERVICE FOR ADDITIONAL OPTIONS

- Wireless controls
- Emergency battery pack
- Color tunable white (2700K-6500K)
- Customization available upon request



**Los Angeles Lighting Mfg. Co.**  
 Contact Us  
 T: 626-454-8300  
 F: 626-454-8399  
 www.lalighting.com  
 10141 Olney Street  
 El Monte, CA 91731  
 Made in the USA



Due to continued product improvements and enhancements, Los Angeles Lighting Manufacturing Company reserves the right to alter specifications, dimensions, data, and/or materials without notice. Please visit our website to view the most current information.

© 2023 LOS ANGELES LIGHTING MANUFACTURING CO. ALL RIGHTS RESERVED.

Revised: 09/05/23



ORDERING INFORMATION

ADDITIONAL OPTIONS AVAILABLE. VISIT [WWW.LALIGHTING.COM/RESOURCES](http://WWW.LALIGHTING.COM/RESOURCES) FOR MORE INFORMATION

EXAMPLE: WSE251-4-4L-BPL1.5-DRDM-UNV-1/840

SERIES	NOMINAL LED LUMENS	NOMINAL LENGTH	ELECTRICAL	SENSOR CONFIGURATION	DRIVER	VOLTAGE	# OF LED ROWS	CRI / CCT
<b>WSE251</b>					<b>DRDM</b>	<b>UNV</b>	<b>1</b>	
<b>WSE251</b> • Sensor Controlled Wraparound LED Luminaire	2 - 2000lm 4 - 4000lm 6 - 6000lm 8 - 8000lm 12 - 12000lm 16 - 16000lm  <b>High Efficacy</b> 2HE - 2000lm 4HE - 4000lm 6HE - 6000lm	<b>4L</b> • 4'	<b>BPL1.5</b> • 1500 lm emergency battery pack  *Leave blank if not specified	<b>MS(xx)</b> Motion Sensor (See below for lens and configuration options)  *Leave blank if not specified	<b>DRDM</b> • 0-10V Dimming Driver	<b>UNV</b> • 120V - 277V	<b>1</b> • One LED Row	<b>827</b> • 80+ CRI / 2700K  <b>835</b> • 80+ CRI / 3500K  <b>840</b> • 80+ CRI / 4000K  <b>850</b> • 80+ CRI / 5000K  <b>865</b> • 80+ CRI / 6500K  <b>8TW</b> • 80+ CRI Tunable White 2700K-6500K  90 CRI also available.
	4 - 4000lm 8 - 8000lm 12 - 12000lm 16 - 16000lm 24 - 24000lm  <b>High Efficacy</b> 4HE - 4000lm 8HE - 8000lm 12HE - 12000lm	<b>8L</b> • 8'	Standard options for WSE250 shown above. For additional options, including lumen packages, controls, lenses, switches, finishes, and more, visit <a href="http://www.lalighting.com/resources">www.lalighting.com/resources</a> or contact customer service.		Contact customer service for additional CRI/CCT packages.			

SENSOR CONFIGURATION

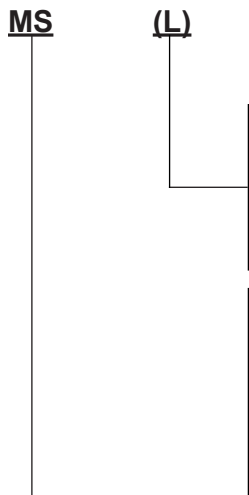

	LENS	SHAPE	MOUNTING HEIGHT		COVERAGE
(L)	STANDARD	ROUND	8 - 20 ft	2.4 - 6.0m	2x HEIGHT
(H)	HIGH BAY	CONE	15 - 30 ft	4.5 - 9.0m	3x HEIGHT
(LW)	WIDE	CONE	8 - 10 ft	2.4 - 3.0m	6x HEIGHT

- MS - PIR Motion Sensor – On/Off**  
• Turns luminaire on/off in response to motion
  - MSSD - PIR Motion Sensor – High/Low**  
• Increases/decreases illumination in response to motion
  - MSSDO - PIR Motion Sensor – High/Low/Off**  
• Turns luminaire on/off and increases/decreases illumination in response to motion
  - MSPC - PIR Motion Sensor with Photocell – On/Off**  
• Holds luminaire OFF when sufficient light is present, regardless of motion  
• When ambient light levels are low, turns light on/off in response to motion
  - MSPCSD - PIR Motion Sensor with Photocell – On/Off**  
• Holds luminaire OFF when sufficient ambient light is present, regardless of motion  
• When ambient light levels are low, increases/decreases illumination in response to motion
  - MSPCSDO - PIR Motion Sensor with Photocell – High/Low/Off**  
• Holds luminaire OFF when sufficient ambient light is present, regardless of motion  
• When ambient light levels are low, turns luminaire on/off and increases/decreases illumination in response to motion
- NOTE:**  
For additional sensor and wireless controls options, visit [www.lalighting.com/resources](http://www.lalighting.com/resources)



Los Angeles Lighting Mfg. Co.  
 Contact Us  
 T: 626-454-8300 10141 Olney Street  
 F: 626-454-8399 El Monte, CA 91731  
[www.lalighting.com](http://www.lalighting.com) Made in the USA



Due to continued product improvements and enhancements, Los Angeles Lighting Manufacturing Company reserves the right to alter specifications, dimensions, data, and/or materials without notice. Please visit our website to view the most current information.

© 2023 LOS ANGELES LIGHTING MANUFACTURING CO. ALL RIGHTS RESERVED.

Revised: 09/05/23



MADE IN THE USA  
BAA Compliant

SYSTEM DATA

ADDITIONAL LUMEN PACKAGES AVAILABLE. CONTACT CUSTOMER SERVICE FOR MORE INFORMATION

4' - LED LUMEN PACKAGE	NORMAL AMBIENT TEMPERATURE PRODUCT CODE	DELIVERED LUMENS	SYSTEM WATTS	LUMINAIRE EFFICACY	AMBIENT TEMP.	FLUORESCENT EQUIVALENT	IES FILES
2000 Lumens (Nominal)	WSE251-2-4L-MS(xx)-DRDM-UNV-1/840	1849	13.4	137.9 lm/W	-20°C / 35°C (-4°F / 95°F)	1-F17T8	*
4000 Lumens (Nominal)	WSE251-4-4L-MS(xx)-DRDM-UNV-1/840	3631	26.7	136.0 lm/W	-20°C / 35°C (-4°F / 95°F)	1-F54T5HO, 2-F32T8	*
6000 Lumens (Nominal)	WSE251-6-4L-MS(xx)-DRDM-UNV-1/840	5612	43.7	128.5 lm/W	-20°C / 35°C (-4°F / 95°F)	3-F32T8	<a href="#">LA-T3776b</a>
8000 Lumens (Nominal)	WSE251-8-4L-MS(xx)-DRDM-UNV-1/840	7304	51.1	142.8 lm/W	-20°C / 35°C (-4°F / 95°F)	2-F54T5HO, 4-F32T8	*
12000 Lumens (Nominal)	WSE251-12-4L-MS(xx)-DRDM-UNV-1/840	10692	74.9	142.7 lm/W	-20°C / 35°C (-4°F / 95°F)	3-F54T5HO, 6-F32T8	*
16000 Lumens (Nominal)	WSE251-16-4L-MS(xx)-DRDM-UNV-1/840	14434	97.9	147.4 lm/W	-20°C / 35°C (-4°F / 95°F)	4-F54T5HO	*
4' - LED LUMEN PACKAGE	NORMAL AMBIENT TEMPERATURE (HIGH EFFICACY) PRODUCT CODE	DELIVERED LUMENS	SYSTEM WATTS	LUMINAIRE EFFICACY	AMBIENT TEMP.	FLUORESCENT EQUIVALENT	IES FILES
2000 Lumens (Nominal)	WSE251-2HE-4L-MS(xx)-DRDM-UNV-1/840	1999	13.5	147.6 lm/W	-20°C / 35°C (-4°F / 95°F)	1-F17T8	*
4000 Lumens (Nominal)	WSE251-4HE-4L-MS(xx)-DRDM-UNV-1/840	3554	23.5	151.6 lm/W	-20°C / 35°C (-4°F / 95°F)	1-F54T5HO, 2-F32T8	*
6000 Lumens (Nominal)	WSE251-6HE-4L-MS(xx)-DRDM-UNV-1/840	5370	36.4	147.5 lm/W	-20°C / 35°C (-4°F / 95°F)	3-F17T8	*

8' - LED LUMEN PACKAGE	NORMAL AMBIENT TEMPERATURE PRODUCT CODE	DELIVERED LUMENS	SYSTEM WATTS	LUMINAIRE EFFICACY	AMBIENT TEMP.	FLUORESCENT EQUIVALENT	IES FILES
4000 Lumens (Nominal)	WSE251-4-8L-MS(xx)-DRDM-UNV-1/840	3491	25.8	135.5 lm/W	-20°C / 35°C (-4°F / 95°F)	2-F32T8	*
8000 Lumens (Nominal)	WSE251-8-8L-MS(xx)-DRDM-UNV-1/840	6855	52.7	130.1 lm/W	-20°C / 35°C (-4°F / 95°F)	2-F54T5HO, 4-F32T8	<a href="#">LA-T3713</a>
12000 Lumens (Nominal)	WSE251-12-8L-MS(xx)-DRDM-UNV-1/840	10365	81.9	126.5 lm/W	-20°C / 35°C (-4°F / 95°F)	6-F32T8	*
16000 Lumens (Nominal)	WSE251-16-8L-MS(xx)-DRDM-UNV-1/840	13556	99.2	136.6 lm/W	-20°C / 35°C (-4°F / 95°F)	4-F54T5HO, 8-F32T8	*
24000 Lumens (Nominal)	WSE251-24-8L-MS(xx)-DRDM-UNV-1/840	20110	149.2	134.9 lm/W	-20°C / 35°C (-4°F / 95°F)	6-F54T5HO, 12-F32T8	*
8' - LED LUMEN PACKAGE	NORMAL AMBIENT TEMPERATURE (HIGH EFFICACY) PRODUCT CODE	DELIVERED LUMENS	SYSTEM WATTS	LUMINAIRE EFFICACY	AMBIENT TEMP.	FLUORESCENT EQUIVALENT	IES FILES
4000 Lumens (Nominal)	WSE251-4HE-8L-MS(xx)-DRDM-UNV-1/840	3396	22.7	149.4 lm/W	-20°C / 35°C (-4°F / 95°F)	2-F32T8	*
8000 Lumens (Nominal)	WSE251-8HE-8L-MS(xx)-DRDM-UNV-1/840	6710	45.3	148.2 lm/W	-20°C / 35°C (-4°F / 95°F)	2-F54T5HO, 4-F32T8	*
12000 Lumens (Nominal)	WSE251-12HE-8L-MS(xx)-DRDM-UNV-1/840	10136	71.1	142.5 lm/W	-20°C / 35°C (-4°F / 95°F)	6-F32T8	*

**NOTE:**  
System data as of 8/18/23. Subject to change without notice.

System data is based on 120V input voltage. Actual performance may differ as a result of end-user environment and application. This fixture has been tested and listed in accordance with UL Standards. L.A. Lighting certifies that it will operate safely when installed properly, and within an ambient temperature range noted in the system data table.

Additional lumen packages and color temperatures available.



**Los Angeles Lighting Mfg. Co.**  
 Contact Us  
 T: 626-454-8300  
 F: 626-454-8399  
 www.lalighting.com  
 10141 Olney Street  
 El Monte, CA 91731  
 Made in the USA



Due to continued product improvements and enhancements, Los Angeles Lighting Manufacturing Company reserves the right to alter specifications, dimensions, data, and/or materials without notice. Please visit our website to view the most current information.

© 2023 LOS ANGELES LIGHTING MANUFACTURING CO. ALL RIGHTS RESERVED.

Revised: 09/05/23



PHOTOMETRIC DATA

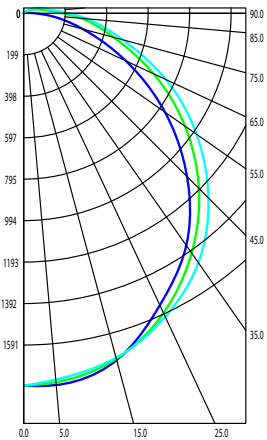

**WSE251-6-4L-MS(xx)-DRDM-UNV-1/840**  
 TEST NO. = LA-T3776b  
 NO. OF LED ROWS = 1  
 SYSTEM WATT (W) = 43.7  
 CRI ≥ 80  
 L70(Hrs.) ≥ 50,000  
 PHOTOMETRY TYPE = C



ZONAL LUMEN SUMMARY			
DEGREES	LUMENS	% LAMP	% FIXTURE
0-30	1388	22	25
0-40	2271	36	41
0-60	4024	63	72
0-90	5375	85	96
90-120	225	4	4
90-150	237	4	4
90-180	237	4	4
0-180	5612	88	100.0

SPACING CRITERION	
ALONG	ACROSS
1.20	1.27

Luminaire Output = 5612.1 lumens  
 Luminaire Efficacy = 128.5 lm/W  
 Luminaire Efficiency = 88.2%

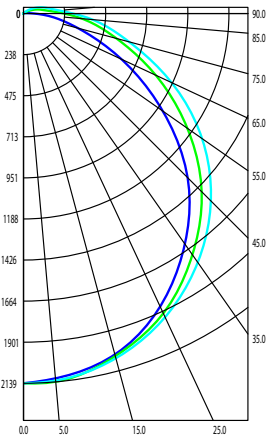

**WSE251-8-8L-MS(xx)-DRDM-UNV-1/840**  
 TEST NO. = LA-T3713  
 NO. OF LED ROWS = 1  
 SYSTEM WATT (W) = 52.7  
 CRI ≥ 80  
 L70(Hrs.) ≥ 50,000  
 PHOTOMETRY TYPE = C



ZONAL LUMEN SUMMARY			
DEGREES	LUMENS	% LAMP	% FIXTURE
0-30	1669	20	24
0-40	2736	34	40
0-60	4880	60	71
0-90	6543	80	96
90-120	294	4	4
90-150	312	4	5
90-180	312	4	5
0-180	6855	84	100.0

SPACING CRITERION	
ALONG	ACROSS
1.21	1.29

Luminaire Output = 6854. lumens  
 Luminaire Efficacy = 130.1 lm/W  
 Luminaire Efficiency = 83.9%



**Los Angeles Lighting Mfg. Co.**  
 Contact Us  
 T: 626-454-8300  
 F: 626-454-8399  
 www.lalighting.com  
 10141 Olney Street  
 El Monte, CA 91731  
 Made in the USA



Due to continued product improvements and enhancements, Los Angeles Lighting Manufacturing Company reserves the right to alter specifications, dimensions, data, and/or materials without notice. Please visit our website to view the most current information.

© 2023 LOS ANGELES LIGHTING MANUFACTURING CO. ALL RIGHTS RESERVED.

Revised: 09/05/23



MADE IN THE USA  
 BAA Compliant