



RECESSED GDH400

SERIES 1' X 4', 2' X 2', 2' X 4', 4' X 4'
6" DEEP HOUSING RECESSED GRID LED LUMINAIRE



JOB	
TYPE	
DATE	

LALIGHTING.COM 626-454-8300

T- BAR RECESSED MOUNTED

DIMENSIONS

GDH410 1' WIDE MODELS

⌀ 7/8" K.O. ⓧ ACCESS PLATE

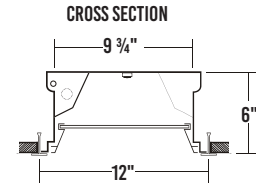
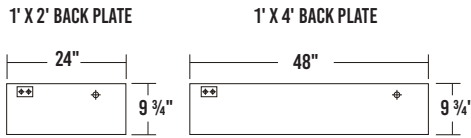

GDH420 2' WIDE MODELS

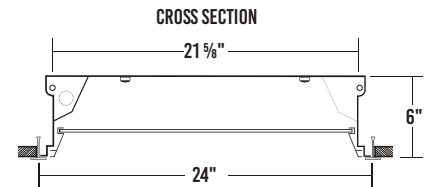
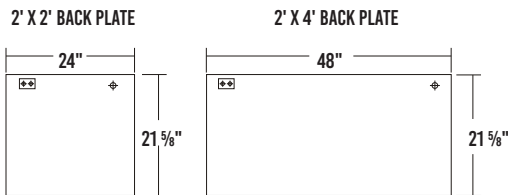

GDH440 4' WIDE MODELS

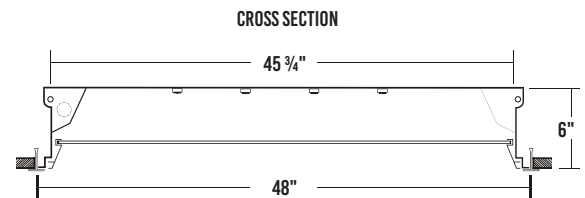
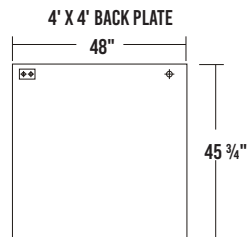

SPECIFICATIONS

CONSTRUCTION

- 22 ga. cold rolled steel housing (20 ga. housing available as specified)
- Heavy wall 2" deep aluminum extrusion secured by T-hinges and positive spring loaded latches
- One way polyurethane gasket
- 2 gussets installed in each corner for maximum strength and true miter alignment
- Tamper proof screws available

FINISH

- Baked white polyester finish
- Minimum reflectance 86%
- Door frame: painted after fabrication

OPTICAL

- Clear prismatic acrylic lens

ELECTRICAL

- High efficiency drivers coupled with long-life LEDs
- Service life greater than 50,000 hours (L70)
- Universal voltage 120V ~ 277V (347V / 480V available)
- Power Factor (PF) ≥ 0.9
- Total Harmonic Distortion (THD) ≤ 20%

LISTING

- UL USA and Canada listed / suitable for wet location

WARRANTY

- 5-year limited warranty
- 10-year limited warranty available

APPLICATIONS

- Commercial
- Office

FEATURES

- 0-10V dimming driver standard
- Supports California Title 24 compliance
- Suitable for damp locations

OPTIONS CONTACT CUSTOMER SERVICE FOR ADDITIONAL OPTIONS

- Controls
- Lenses
- 20 ga. housing
- Painted after fabrication
- Tunable white (2700K – 6500K)
- Emergency battery pack
- Customization available upon request

CUSTOM COLORS

BLK - Matte Black

CS - Camaro Silver

BZ - Statuary Bronze

Variety of RAL colors available upon request.



Los Angeles Lighting Mfg. Co.
Headquarters
10141 Olney Street
El Monte, CA 91731
Made in the USA

Contact Us
T: 626-454-8300
F: 626-454-8399
www.lalighting.com



Due to continued product improvements and enhancements, Los Angeles Lighting Manufacturing Company reserves the right to alter specifications, dimensions, data, and/or materials without notice. Please visit our website to view the most current information.

©2021 LOS ANGELES LIGHTING MANUFACTURING CO. ALL RIGHTS RESERVED.

Revised 01/22/24



ORDERING INFORMATION

ADDITIONAL OPTIONS AVAILABLE. VISIT WWW.LALIGHTING.COM/RESOURCES FOR MORE INFORMATION

EXAMPLE: GDH420-12-4L-BPL1.5-DRDM-UNV-2/840

SERIES	NOMINAL LED LUMENS	NOMINAL LENGTH	DOOR FRAME	OPTICAL	CONTROLS	ELECTRICAL	DRIVER	VOLTAGE	# OF ROWS	CRI / CCT
							DRDM			
GDH410 1'x2' 6" Deep Housing Grid LED Luminaire	1'x2' 2 - 2000lm 4 - 4000lm 6 - 6000lm 8 - 8000lm	2L • 1' x 2'	R2W • White Enamel R2B • Black Enamel	PA • Clear Prismatic Acrylic FPA2 • Flat Prismatic Acrylic	WLC(xx) • Wireless Control *Leave blank if not specified	BPL1.5 • Emergency Battery Pack • 1500 lm *Leave blank if not specified	DRDM • 0-10V Dimming Driver	UNV • 120V-277V 120V • 120 Volt 277V • 277 Volt	1 • One LED Rows 2 • Two LED Rows 4 • Four LED Rows	830 • 80+CRI / 3000K Color Temp. 835 • 80+CRI / 3500K Color Temp. 840 • 80+CRI / 4000K Color Temp. 850 • 80+CRI / 5000K Color Temp. *8TW • Tunable White • 827 to 865
GDH410 1'x4' 6" Deep Housing Grid LED Luminaire	1'x4' 2 - 2000lm 4 - 4000lm 6 - 6000lm 8 - 8000lm	4L • 1' x 4'	R2N • Natural Anodized Aluminum	FFA • Flat Frosted Acrylic				347V • 347 Volt 480V • 480 Volt		
GDH420 2'x2' 6" Deep Housing Grid LED Luminaire	2'x2' 2 - 2000lm 3 - 3000lm 4 - 4000lm 6 - 6000lm	2L • 2' x 2'								
GDH420 2'x4' 6" Deep Housing Grid LED Luminaire	2'x4' 4 - 4000lm 6 - 6000lm 8 - 8000lm 12 - 12000lm 16 - 16000lm	4L • 2' x 4'								
GDH440 4'x4' 6" Deep Housing Grid LED Luminaire	4'x4' 6 - 6000lm 8 - 8000lm 12 - 12000lm 16 - 16000lm 24 - 24000lm	4L • 4' x 4'		PA8 • Clear Prismatic Acrylic, Nom. 0.187 FFWA2 • Flat Frosted White Acrylic						
<i>Contact factory for additional options</i>										

OPTICAL OPTIONS

STANDARD LENSES FOR GDH400 SERIES

FPA2	Frosted Prismatic Acrylic, Nom. 0.125 OA Thickness
FFA	Flat Frosted Acrylic, No Thickness Specified
PA8	Clear Prismatic Acrylic, Nom. 0.187 OA Thickness, Female Prisms 3/16 Square Base, Pattern 12
FFWA2	Flat Frosted White Acrylic, Nom. 0.125 OA Thickness

DOOR FRAME

CROSS SECTION

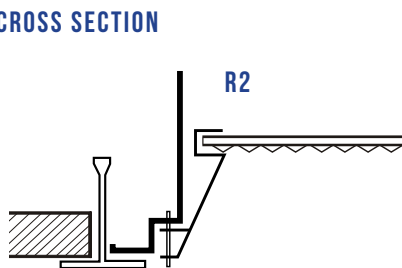

- R2**
- W**
- FINISHES**
- W** White Enamel
- B** Black Enamel
- N** Natural Anodized Aluminum
- STYLES**
- R2** 2" Regressed Aluminum



Los Angeles Lighting Mfg. Co.
 Headquarters
 10141 Olney Street
 El Monte, CA 91731
 Made in the USA

Contact Us
 T: 626-454-8300
 F: 626-454-8399
www.lalighting.com



Due to continued product improvements and enhancements, Los Angeles Lighting Manufacturing Company reserves the right to alter specifications, dimensions, data, and/or materials without notice. Please visit our website to view the most current information.

©2021 LOS ANGELES LIGHTING MANUFACTURING CO. ALL RIGHTS RESERVED.

Revised 01/22/24



MADE IN THE USA
 BAA Compliant

PHOTOMETRIC DATA

GDH410-4-4L-R2W-PA-DRDM-UNV-2/840

TEST NO. = LA-T3724
 LED TYPE = 48 LED MODULE
 NO. OF MODULE = 1
 SYSTEM WATT (W) = 26.7
 CRI ≥ 80
 L70(Hrs.) ≥ 50,000
 PHOTOMETRY TYPE = C

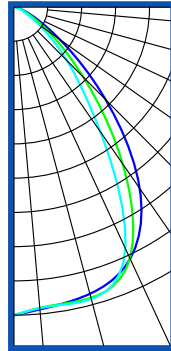
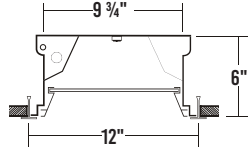

CANDELA DISTRIBUTION

0.00	0.00	45.00	90.00
0.00	1734.12	1734.12	0.00
5.00	1708.33	1700.78	5.00
15.00	1671.08	1701.33	15.00
25.00	1563.41	1499.38	25.00
35.00	1247.17	856.62	35.00
45.00	738.10	29.11	45.00
55.00	320.37	74.75	55.00
65.00	114.98	0.67	65.00
75.00	35.36	49	75.00
85.00	8.87	9	85.00
90.00	0.27	0.29	0.27

SPACING CRITERION

ALONG	ACROSS
1.19	1.07

ZONAL LUMEN SUMMARY

DEGREES	LUMENS	% LAMP	% FIXTURE
0-30	1357	33.20	48.1
0-40	2026	49.60	71.8
0-60	2688	65.81	95.33
0-90	2820	69.03	100
90-120	0.08	0.00	0.00
90-150	0.08	0.00	0.00
90-180	0.08	0.00	0.00
0-180	2820	69.03	100.0

Luminaire Output = 2820.68 lumens
 Luminaire Efficacy = 105.62 lm/W
 Luminaire Efficiency = 69.03%

GDH420-4-2L-R2W-PA-DRDM-UNV-2/840

TEST NO. = LA-T3725
 LED TYPE = 48 LED MODULE
 NO. OF MODULE = 2
 SYSTEM WATT (W) = 26.7
 CRI ≥ 80
 L70(Hrs.) ≥ 50,000
 PHOTOMETRY TYPE = C

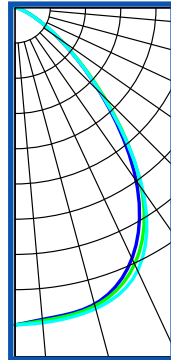
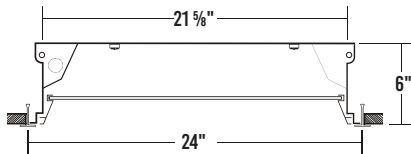

CANDELA DISTRIBUTION

0.00	0.00	45.00	90.00
0.00	1698.87	1698.87	1698.87
5.00	1675.67	1682.75	1693.64
15.00	1643.81	1653.61	1668.55
25.00	1482.06	1515.85	1553.60
35.00	1131.57	1181.48	1194.50
45.00	648.10	672.80	656.33
55.00	286.34	292.13	291.89
65.00	104.99	104.89	101.68
75.00	31.84	31.85	28.07
85.00	9.23	8.47	8.05
90.00	0.30	0.26	0.24

SPACING CRITERION

ALONG	ACROSS
1.14	1.09

ZONAL LUMEN SUMMARY

DEGREES	LUMENS	% LAMP	% FIXTURE
0-30	1332.01	32.60	44.62
0-40	2068.42	50.62	69.28
0-60	2842.23	69.56	95.20
0-90	2985.33	73.06	100.00
90-120	0.07	0.00	0.00
90-150	0.07	0.00	0.00
90-180	0.07	0.00	0.00
0-180	2985.40	73.06	100.0

Luminaire Output = 2985.40 lumens
 Luminaire Efficacy = 111.78 lm/W
 Luminaire Efficiency = 73.06%

GDH420-8-4L-R2W-PA-DRDM-UNV-2/840

TEST NO. = LA-T3726
 LED TYPE = 48 LED MODULE
 NO. OF MODULE = 4
 SYSTEM WATT (W) = 52.6
 CRI ≥ 80
 L70(Hrs.) ≥ 50,000
 PHOTOMETRY TYPE = C

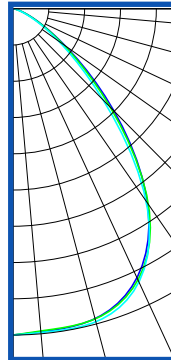
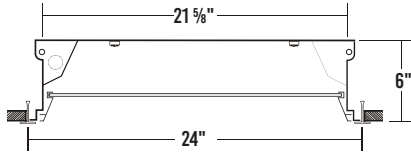

CANDELA DISTRIBUTION

0.00	0.00	45.00	90.00
0.00	3513.99	3513.99	3513.99
5.00	3492.11	3483.91	3500.18
15.00	3455.71	3458.45	3490.17
25.00	3196.63	3221.85	3246.85
35.00	2555.14	2572.69	2528.45
45.00	1555.77	1500.55	1391.55
55.00	693.19	664.79	609.70
65.00	251.72	239.19	215.80
75.00	74.34	68.20	59.47
85.00	15.06	16.15	16.89
90.00	0.38	0.67	0.48

SPACING CRITERION

ALONG	ACROSS
1.20	1.20

ZONAL LUMEN SUMMARY

DEGREES	LUMENS	% LAMP	% FIXTURE
0-30	2806.95	34.34	43.35
0-40	4413.41	54.00	68.16
0-60	6155.52	75.32	95.06
0-90	6474.99	79.22	100.00
90-120	0.15	0.00	0.00
90-150	0.15	0.00	0.00
90-180	0.15	0.00	0.00
0-180	6475.14	79.23	100.0

Luminaire Output = 6475.14 lumens
 Luminaire Efficacy = 122.93 lm/W
 Luminaire Efficiency = 79.23%

GDH440-16-4L-R2W-PA8-DRDM-UNV-4/840

TEST NO. = LA-T3727
 LED TYPE = 48 LED MODULE
 NO. OF MODULE = 8
 SYSTEM WATT (W) = 102.3
 CRI ≥ 80
 L70(Hrs.) ≥ 50,000
 PHOTOMETRY TYPE = C

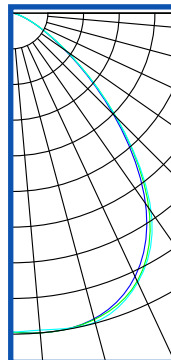
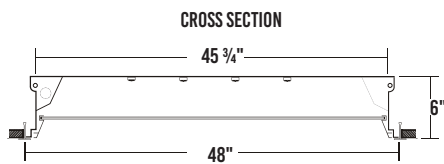

CANDELA DISTRIBUTION

0.00	0.00	45.00	90.00
0.00	6914.50	6914.50	6914.50
5.00	6953.51	6955.93	6894.48
15.00	6856.27	6873.75	6933.78
25.00	6298.51	6410.57	6438.46
35.00	5036.53	5165.40	5250.87
45.00	3103.84	3187.25	3184.06
55.00	1401.59	1445.52	1452.09
65.00	509.47	523.49	521.29
75.00	143.55	150.48	146.00
85.00	28.99	28.75	27.12
90.00	0.91	1.07	0.81

SPACING CRITERION

ALONG	ACROSS
1.20	1.20

ZONAL LUMEN SUMMARY

DEGREES	LUMENS	% LAMP	% FIXTURE
0-30	5571.29	34.08	42.06
0-40	8809.38	53.89	66.51
0-60	12549.45	76.77	94.75
0-90	13244.70	81.03	100.00
90-120	0.26	0.00	0.00
90-150	0.26	0.00	0.00
90-180	0.26	0.00	0.00
0-180	13244.96	81.03	100.0

Luminaire Output = 13244.96 lumens
 Luminaire Efficacy = 129.38 lm/W
 Luminaire Efficiency = 81.03%



Los Angeles Lighting Mfg. Co.
 Headquarters
 10141 Olney Street
 El Monte, CA 91731
 Made in the USA
 Contact Us
 T: 626-454-8300
 F: 626-454-8399
 www.lalighting.com



Due to continued product improvements and enhancements, Los Angeles Lighting Manufacturing Company reserves the right to alter specifications, dimensions, data, and/or materials without notice. Please visit our website to view the most current information.

©2021 LOS ANGELES LIGHTING MANUFACTURING CO. ALL RIGHTS RESERVED.

Revised 01/22/24



SYSTEM DATA

ADDITIONAL LUMEN PACKAGES AVAILABLE. CONTACT CUSTOMER SERVICE FOR MORE INFORMATION

GDH410 1' X 4' SYSTEM DATA

Nominal LED Lumen Package	Normal Ambient Temperature Product Code	Delivered Lumens	System Watts	Luminaire Efficacy	Ambient Temp.	Fluorescent / HID Equivalent	IES Files
2000 Lumens	GDH410-2-4L-R2W-PA-DRDM-UNV-1/840	1436.51 lm	13.41 W	107.09 lm/W	-20°C / 35°C	2-F17T8, 1-F24T5HO	*
4000 Lumens	GDH410-4-4L-R2W-PA-DRDM-UNV-1/840	2820.57 lm	26.71 W	105.62 lm/W	-20°C / 35°C	4-F17T8, 2-F24T5HO	LA-T3724
6000 Lumens	GDH410-6-4L-R2W-PA-DRDM-UNV-1/840	4392.38 lm	43.67 W	100.57 lm/W	-20°C / 35°C	6-F17T8, 3-F24T5HO	*
8000 Lumens	GDH410-8-4L-R2W-PA-DRDM-UNV-1/840	5717.06 lm	51.14 W	111.80 lm/W	-20°C / 35°C	8-F32T8, 4-F54T5HO	*
12000 Lumens	GDH410-12-4L-R2W-PA-DRDM-UNV-1/840	8305.69 lm	74.92 W	110.87 lm/W	-20°C / 35°C	6-F32T8,3-F54T5HO	*
Nominal LED Lumen Package	Normal Ambient Temperature (High Efficacy) Product Code	Delivered Lumens	System Watts	Luminaire Efficacy	Ambient Temp.	Fluorescent / HID Equivalent	IES Files
2000 Lumens	GDH410-2HE-4L-R2W-PA-DRDM-UNV-1/840	1553.18 lm	13.5 W	114.6 lm/W	-20°C / 35°C	2-F17T8, 1-F24T5HO	*
4000 Lumens	GDH410-4HE-4L-R2W-PA-DRDM-UNV-1/840	2761.20 lm	23.4 W	117.7 lm/W	-20°C / 35°C	4-F17T8, 2-F24T5HO	*
6000 Lumens	GDH410-6HE-4L-R2W-PA-DRDM-UNV-1/840	4440.01 lm	38.4 W	115.6 lm/W	-20°C / 35°C	6-F17T8, 3-F24T5HO	*
8000 Lumens	GDH410-8HE-4L-R2W-PA-DRDM-UNV-1/840	5717.06 lm	50.8 W	112.4 lm/W	-20°C / 35°C	8-F32T8, 4-F54T5HO	*

GDH420 2' X 2' SYSTEM DATA

Nominal LED Lumen Package	Normal Ambient Temperature Product Code	Delivered Lumens	System Watts	Luminaire Efficacy	Ambient Temp.	Fluorescent / HID Equivalent	IES Files
2000 Lumens	GDH420-2-2L-R2W-PA-DRDM-UNV-2/840	1520.38 lm	13.4 W	113.34 lm/W	-20°C / 35°C	2-F17T8, 1-F24T5HO	*
4000 Lumens	GDH420-4-2L-R2W-PA-DRDM-UNV-2/840	2985.23 lm	26.71 W	111.78 lm/W	-20°C / 35°C	4-F17T8, 2-F24T5HO	LA-T3725
6000 Lumens	GDH420-6-2L-R2W-PA-DRDM-UNV-2/840	4648.81 lm	43.67 W	106.44 lm/W	-20°C / 35°C	6-F17T8, 3-F24T5HO	*
8000 Lumens	GDH420-8-2L-R2W-PA-DRDM-UNV-2/840	6050.83 lm	51.14 W	118.33 lm/W	-20°C / 35°C	8-F32T8, 4-F54T5HO	*
12000 Lumens	GDH420-8-2L-R2W-PA-DRDM-UNV-2/840	8790.58 lm	74.92 W	117.34 lm/W	-20°C / 35°C	6-F32T8,3-F54T5HO	*
Nominal LED Lumen Package	Normal Ambient Temperature (High Efficacy) Product Code	Delivered Lumens	System Watts	Luminaire Efficacy	Ambient Temp.	Fluorescent / HID Equivalent	IES Files
2000 Lumens	GDH420-2HE-2L-R2W-PA-DRDM-UNV-2/840	1643.85 lm	13.54 W	121.37 lm/W	-20°C / 35°C	2-F17T8, 1-F24T5HO	*
4000 Lumens	GDH420-4HE-2L-R2W-PA-DRDM-UNV-2/840	2922.40 lm	23.45 W	124.61 lm/W	-20°C / 35°C	4-F17T8, 2-F24T5HO	*
6000 Lumens	GDH420-6HE-2L-R2W-PA-DRDM-UNV-2/840	4699.22 lm	38.40 W	122.38 lm/W	-20°C / 35°C	6-F17T8, 3-F24T5HO	*
8000 Lumens	GDH420-8HE-2L-R2W-PA-DRDM-UNV-2/840	6050.83 lm	50.85 W	119.00 lm/W	-20°C / 35°C	8-F32T8, 4-F54T5HO	*

GDH420 2' X 4' SYSTEM DATA

Nominal LED Lumen Package	Normal Ambient Temperature Product Code	Delivered Lumens	System Watts	Luminaire Efficacy	Ambient Temp.	Fluorescent / HID Equivalent	IES Files
2000 Lumens	GDH420-2-4L-R2W-PA-DRDM-UNV-2/840	1650.36 lm	13.17 W	125.31 lm/W	-20°C / 35°C	2-F17T8, 1-F24T5HO	*
4000 Lumens	GDH420-4-4L-R2W-PA-DRDM-UNV-2/840	3297.55 lm	25.76 W	127.99 lm/W	-20°C / 35°C	4-F17T8, 2-F24T5HO	*
6000 Lumens	GDH420-6-4L-R2W-PA-DRDM-UNV-2/840	4905.92 lm	38.95 W	125.94 lm/W	-20°C / 35°C	6-F17T8, 3-F24T5HO	*
8000 Lumens	GDH420-8-4L-R2W-PA-DRDM-UNV-2/840	6475.47 lm	52.67 W	122.93 lm/W	-20°C / 35°C	8-F32T8, 4-F54T5HO	LA-T3726
12000 Lumens	GDH420-12-4L-R2W-PA-DRDM-UNV-2/840	9791.24 lm	81.92 W	119.52 lm/W	-20°C / 35°C	6-F32T8,3-F54T5HO	*
Nominal LED Lumen Package	Normal Ambient Temperature (High Efficacy) Product Code	Delivered Lumens	System Watts	Luminaire Efficacy	Ambient Temp.	Fluorescent / HID Equivalent	IES Files
2000 Lumens	GDH420-2HE-4L-R2W-PA-DRDM-UNV-2/840	1750.19 lm	12.80 W	136.68 lm/W	-20°C / 35°C	2-F17T8, 1-F24T5HO	*
4000 Lumens	GDH420-4HE-4L-R2W-PA-DRDM-UNV-2/840	3208.02 lm	22.74 W	141.09 lm/W	-20°C / 35°C	4-F17T8, 2-F24T5HO	*
6000 Lumens	GDH420-6HE-4L-R2W-PA-DRDM-UNV-2/840	4972.47 lm	35.44 W	140.31 lm/W	-20°C / 35°C	6-F17T8, 3-F24T5HO	*
8000 Lumens	GDH420-8HE-4L-R2W-PA-DRDM-UNV-2/840	6338.40 lm	45.29 W	139.96 lm/W	-20°C / 35°C	8-F32T8, 4-F54T5HO	*

GDH440 4' X 4' SYSTEM DATA

Nominal LED Lumen Package	Normal Ambient Temperature Product Code	Delivered Lumens	System Watts	Luminaire Efficacy	Ambient Temp.	Fluorescent / HID Equivalent	IES Files
6000 Lumens	GDH440-6-4L-R2W-PA-DRDM-UNV-4/840	5070.05 lm	37.91 W	133.75 lm/W	-20°C / 35°C	6-F17T8, 3-F24T5HO	*
8000 Lumens	GDH440-8-4L-R2W-PA-DRDM-UNV-4/840	6744.94 lm	50.06 W	134.74 lm/W	-20°C / 35°C	8-F32T8, 4-F54T5HO	*
12000 Lumens	GDH440-12-4L-R2W-PA-DRDM-UNV-4/840	10034.76 lm	75.59 W	132.75 lm/W	-20°C / 35°C	6-F32T8,3-F54T5HO	*
16000 Lumens	GDH440-16-4L-R2W-PA-DRDM-UNV-4/840	13245.16 lm	102.37 W	129.38 lm/W	-20°C / 35°C	4-F54T5HO	LA-T3727
24000 Lumens	GDH440-24-4L-R2W-PA-DRDM-UNV-4/840	19726.75 lm	160.90 W	122.60 lm/W	-20°C / 35°C	6-F54T5HO	*
Nominal LED Lumen Package	Normal Ambient Temperature (High Efficacy) Product Code	Delivered Lumens	System Watts	Luminaire Efficacy	Ambient Temp.	Fluorescent / HID Equivalent	IES Files
6000 Lumens	GDH440-6HE-4L-R2W-PA-DRDM-UNV-4/840	5081.39 lm	33.91 W	149.86 lm/W	-20°C / 35°C	6-F17T8, 3-F24T5HO	*
8000 Lumens	GDH440-8HE-4L-R2W-PA-DRDM-UNV-4/840	6561.81 lm	44.80 W	146.48 lm/W	-20°C / 35°C	8-F32T8, 4-F54T5HO	*
12000 Lumens	GDH440-12HE-4L-R2W-PA-DRDM-UNV-4/840	9815.97 lm	66.63 W	147.32 lm/W	-20°C / 35°C	6-F32T8,3-F54T5HO	*
16000 Lumens	GDH440-16HE-4L-R2W-PA-DRDM-UNV-4/840	12964.80 lm	89.55 W	144.78 lm/W	-20°C / 35°C	4-F54T5HO	*
24000 Lumens	GDH440-24HE-4L-R2W-PA-DRDM-UNV-4/840	19585.76 lm	141.47 W	138.45 lm/W	-20°C / 35°C	6-F54T5HO	*



Los Angeles Lighting Mfg. Co.
 Headquarters
 10141 Olney Street
 El Monte, CA 91731
 Made in the USA

Contact Us
 T: 626-454-8300
 F: 626-454-8399
 www.lalighting.com



Due to continued product improvements and enhancements, Los Angeles Lighting Manufacturing Company reserves the right to alter specifications, dimensions, data, and/or materials without notice. Please visit our website to view the most current information.

©2021 LOS ANGELES LIGHTING MANUFACTURING CO. ALL RIGHTS RESERVED.

Revised 01/22/24



MADE IN THE USA
 BAA Compliant

CONTROL OPTIONS



enocean

WLC(LED RU) - EnOcean® LED Relay Zone Controller

- Supports a single LED fixture or multiple daisy chained LED fixtures
- Module installed inside lighting fixture

ESRPU-W-EO - EnOcean® Rocker Switch – Single – Surface Mount

- Wireless single rocker switch with mounting plate
- No batteries needed

EDRPU-W-EO - EnOcean® Rocker Switch – Double – Surface Mount

- Wireless double rocker switch with mounting plate
- No batteries needed

S3054-N300 - EnOcean® Navigan NWC 300U – Commissioning Tool

- Navigan Wireless Commissioner is used to configure EnOcean controllers & sensors
- It can be used to define link tables, change parameters/settings, & to edit & store projects
- Configuration settings can be saved & cloned to enable quick configuration
- Connectivity is through the NWC 300U USB Stick

EOSWU-W-EO - EnOcean® Occupancy Sensor – Wall Mount

- Wireless wall mounted occupancy sensor
- Solar powered - no batteries needed (coin battery operated in low light conditions)
- PIR motion sensor with both wide angle (50ft) and long range (100ft) options
- Mounting height: 6-8ft

EOSCU-W-EO - EnOcean® Occupancy Sensor – Ceiling Mount

- Wireless ceiling mounted occupancy sensor
- Solar powered - no batteries needed (coin battery operated in low light conditions)
- PIR motion sensor with 360° viewing angle lens (34' diameter)
- Mounting height: 7-10ft

ELLSU-W-EO - EnOcean® Light Level Sensor – Ceiling Mount

- Light Level sensor that measures and reports the level of available natural light
- Solar powered - no batteries needed (coin battery operated in low light conditions)
- Enables implementation of daylight harvesting control systems
- Mounting position: At the ceiling, close to ambient light source

DRIVER OPTIONS

PLEASE CONSULT FACTORY TO SEE IF YOUR SELECTED DRIVER OPTION WORKS WITH THIS FIXTURE

BATTERY PACK OPTIONS

PLEASE CONSULT FACTORY TO SEE IF YOUR SELECTED BATTERY OPTION WORKS WITH THIS FIXTURE

LED EMERGENCY BATTERY PACKS
(Operates for 90 minutes unless otherwise specified)

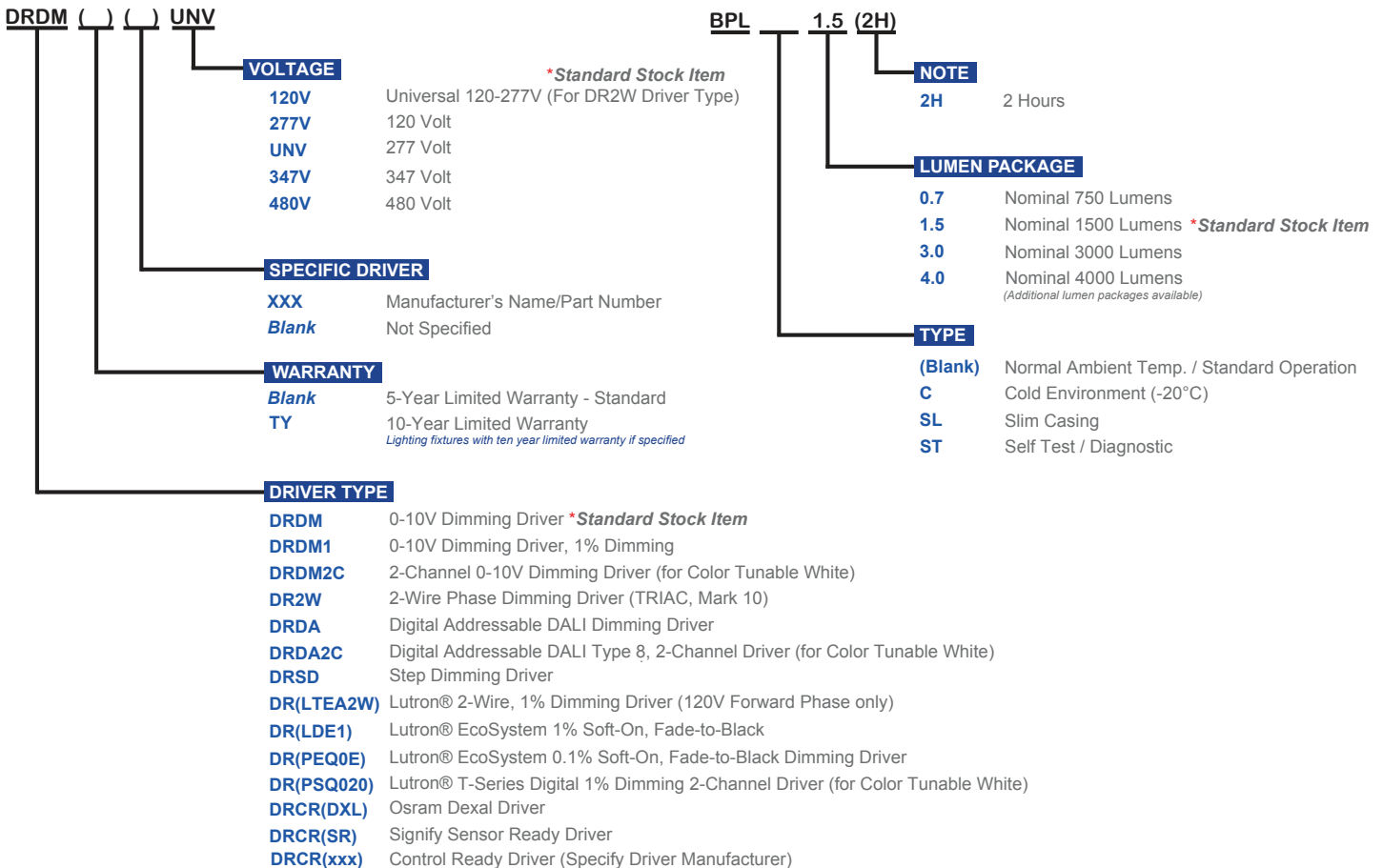

Los Angeles Lighting Mfg. Co.
 Headquarters
 10141 Olney Street
 El Monte, CA 91731
 Made in the USA
 Contact Us
 T: 626-454-8300
 F: 626-454-8399
 www.lalighting.com



Due to continued product improvements and enhancements, Los Angeles Lighting Manufacturing Company reserves the right to alter specifications, dimensions, data, and/or materials without notice. Please visit our website to view the most current information.

©2021 LOS ANGELES LIGHTING MANUFACTURING CO. ALL RIGHTS RESERVED.

Revised 01/22/24



MADE IN THE USA
BAA Compliant