



RECESSED GPA320 2X4

PARABOLIC GRID LUMINAIRE



JOB	
TYPE	
DATE	

RECESSED PARABOLIC TROFFER FOR T-BAR CEILINGS

DIMENSIONS

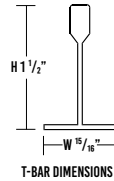

S12
CROSS SECTION

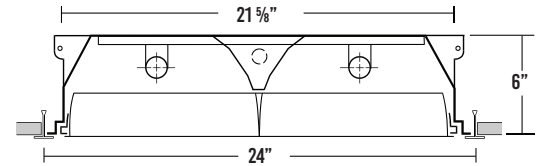

2 lamp rows shown. 4 rows also available.

S18
CROSS SECTION

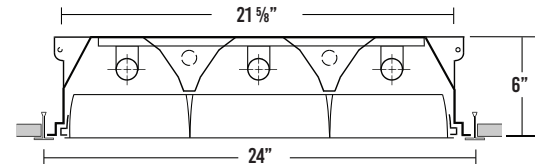

S12
LOUVER CONFIGURATION
(2 LOUVER ROWS, 12 CELLS)

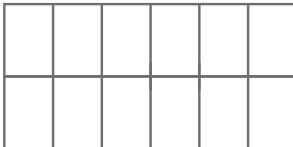

S18
LOUVER CONFIGURATION
(3 LOUVER ROWS, 18 CELLS)

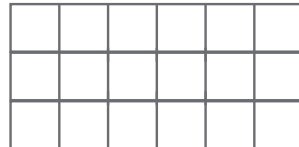

BACKPLATE

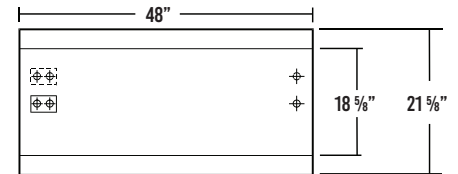

⊕ 7/8" OFFSET K.O. ⊕ ACCESS PLATE

SPECIFICATIONS

CONSTRUCTION

- 22 gauge cold-rolled steel housing
- Semi-specular, low iridescent aluminum louvers
- Louvers secured to housing with T-hinges and latches

FINISH

- Baked white polyester finish
- Minimum reflectance 86%

OPTICAL

- Nominal 3" deep aluminum parabolic louvers

LISTING

- UL USA and Canada Listed. Compatible with UL Fire-Rated Ceiling Assemblies.

WARRANTY

- 5-Year limited warranty standard. 10-Year limited warranty also available

APPLICATIONS

- Classrooms, Offices, Retail

FEATURES

- Recessed grid-mounted luminaire for T-bar ceilings
- Operates LED Tubes with internal drivers

OPTIONS CONTACT CUSTOMER SERVICE FOR ADDITIONAL OPTIONS

- 20 gauge housing
- White louvers
- Customization available upon request



Los Angeles Lighting Mfg. Co.
 Contact Us
 T: 626-454-8300
 F: 626-454-8399
 www.lalighting.com
 10141 Olney Street
 El Monte, CA 91731
 Made in the USA



Due to continued product improvements and enhancements, Los Angeles Lighting Manufacturing Company reserves the right to alter specifications, dimensions, data, and/or materials without notice. Please visit our website to view the most current information.

© 2024 LOS ANGELES LIGHTING MANUFACTURING CO. ALL RIGHTS RESERVED.

Revised: 03/11/24



ORDERING GUIDE

EXAMPLE: GPA320-4-LI-S12-TS2-LED8I-UNV							
SERIES	LAMPS	NOMINAL LENGTH	LAMP WIRING	LOUVER CONFIGURATION	ELECTRICAL	LUMINAIRE TYPE	VOLTAGE
GPA320		4L			TS2	LED	UNV
GPA320 • Recessed Parabolic Troffer for T-Bar Ceilings	2 • 2 Lamps (for S12 louver) 3 • 3 Lamps (for S18 louver) 4 • 4 Lamps (for S12 louver)	4L • 4'	I • Both Ends Powered, Shunted Sockets R • Single End Powered, Non-shunted Sockets	S12 • Semi-Specular Low Iridescent Aluminum (2 Rows of 6 Cells) S18 • Semi-Specular Low Iridescent Aluminum (3 Rows of 6 Cells)	TS2 • Safety Switch *Leave blank if not specified	LED8I • T8 LED Tube (Both Ends Powered) LED8R • T8 LED Tube (Single End Powered) LED5I • T5 LED Tube (Both Ends Powered) LED5R • T5 LED Tube (Single End Powered)	UNV

LAMP WIRING

I - Internally Driven LED tube

- Both ends powered
- Shunted sockets



R - Internally Driven LED tube

- Single end powered
- Non-shunted sockets



OPTIONS

ELECTRICAL

TS2 - Safety Switch

- Allows an individual luminaire to be switched on/off during re-lamping or maintenance.



Los Angeles Lighting Mfg. Co.
 Contact Us
 T: 626-454-8300 10141 Olney Street
 F: 626-454-8399 El Monte, CA 91731
 www.lalighting.com Made in the USA



Due to continued product improvements and enhancements, Los Angeles Lighting Manufacturing Company reserves the right to alter specifications, dimensions, data, and/or materials without notice. Please visit our website to view the most current information.

© 2024 LOS ANGELES LIGHTING MANUFACTURING CO. ALL RIGHTS RESERVED.

Revised: 03/11/24



MADE IN THE USA
 BAA Compliant