



RECESSED GDH410

12" WIDE REGRESSED LENS LUMINAIRE



JOB	
TYPE	
DATE	

Recessed Troffer for T-Bar Ceilings



COMPATIBLE T-BAR GRIDS	
WIDTH	HEIGHT
15/16"	1 1/2"

CROSS SECTION

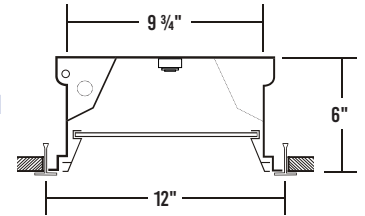

4' BACKPLATE

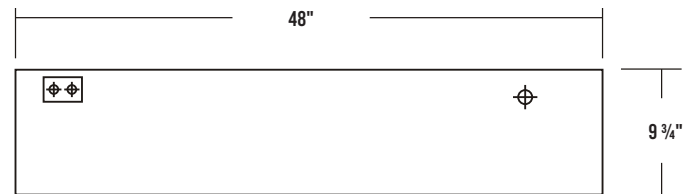

7/8" OFFSET K.O.

ACCESS PLATE

SPECIFICATIONS

Construction

- 22 gauge cold-rolled steel housing
- 2" deep regressed extruded aluminum door frame, secured by T-hinge and spring-loaded latches
- One way polyurethane gasket
- 2 gussets installed in each corner for maximum strength and true miter alignment

Finish

- Baked white polyester finish
- Minimum reflectance 86%
- Door frame painted after fabrication

Optical

- Clear prismatic acrylic lens

Electrical

- High-efficiency drivers coupled with long-life LEDs
- Service life greater than 50,000 hours (L70)
- Universal voltage 120V through 277V (347V / 480V available)
- Power Factor (PF) ≥ 0.9
- Total Harmonic Distortion (THD) $\leq 20\%$

Listing

- UL USA and Canada listed / suitable for wet location

Warranty

- 5-Year limited warranty standard. 10-Year limited warranty also available

APPLICATIONS

- Commercial, Office

FEATURES

- 0-10V dimming driver standard
- Supports California Title 24 compliance
- Suitable for damp locations

OPTIONS

- Sensors and controls
- Range of lumen packages and color temperatures
- Various lenses
- 20 gauge housing
- Painted after fabrication
- Tunable white (2700K – 6500K)
- Emergency battery pack
- Customization available upon request



Los Angeles Lighting Mfg. Co.
Contact Us
T: 626-454-8300 10141 Olney Street
F: 626-454-8399 El Monte, CA 91731
www.lalighting.com Made in the USA



Due to continued product improvements and enhancements, Los Angeles Lighting Manufacturing Company reserves the right to alter specifications, dimensions, data, and/or materials without notice. Please visit our website to view the most current information.

© 2025 LOS ANGELES LIGHTING MANUFACTURING CO. ALL RIGHTS RESERVED

Revised: 05/30/25



SYSTEM DATA: Additional Lumen Packages Available. Contact Customer Service for More Information

Normal Ambient Temperature	4" - LED LUMEN PACKAGE	NORMAL AMBIENT TEMPERATURE PRODUCT CODE	DELIVERED LUMENS	SYSTEM WATTS	LUMINAIRE EFFICACY	AMBIENT TEMP.	FLUORESCENT EQUIVALENT	IES FILES
	2000 Lumens (Nominal)	GDH410-2-4L-R2W-PA-DRDM-UNV-1/840	1472	12.4	118.3 lm/W	-20°C / 35°C (-4°F / 95°F)	1x F32T8	*
	4000 Lumens (Nominal)	GDH410-4-4L-R2W-PA-DRDM-UNV-1/840	2889	25.5	113.4 lm/W	-20°C / 35°C (-4°F / 95°F)	1x F54T5HO 2x F32T8	*
	6000 Lumens (Nominal)	GDH410-6-4L-R2W-PA-DRDM-UNV-1/840	4265	39.0	109.4 lm/W	-20°C / 35°C (-4°F / 95°F)	3x F32T8	*
	8000 Lumens (Nominal)	GDH410-8-4L-R2W-PA-DRDM-UNV-1/840	5600	53.1	105.5 lm/W	-20°C / 35°C (-4°F / 95°F)	2x F54T5HO 4x F32T8	*
	12000 Lumens (Nominal)	GDH410-12-4L-R2W-PA-DRDM-UNV-1/840	8529	78.0	109.3 lm/W	-20°C / 35°C (-4°F / 95°F)	3x F54T5HO 6x F32T8	*
Normal Ambient Temp High Efficacy	4" - LED LUMEN PACKAGE	NORMAL AMBIENT TEMPERATURE (HIGH EFFICACY) PRODUCT CODE	DELIVERED LUMENS	SYSTEM WATTS	LUMINAIRE EFFICACY	AMBIENT TEMP.	FLUORESCENT EQUIVALENT	IES FILES
	2000 Lumens (Nominal)	GDH410-2HE-4L-R2W-PA-DRDM-UNV-1/840	1496	12.3	121.7 lm/W	-20°C / 35°C (-4°F / 95°F)	1x F32T8	*
	4000 Lumens (Nominal)	GDH410-4HE-4L-R2W-PA-DRDM-UNV-1/840	2943	24.9	118.3 lm/W	-20°C / 35°C (-4°F / 95°F)	1x F54T5HO 2x F32T8	*
	6000 Lumens (Nominal)	GDH410-6HE-4L-R2W-PA-DRDM-UNV-1/840	4370	37.8	115.7 lm/W	-20°C / 35°C (-4°F / 95°F)	3x F32T8	*
	8000 Lumens (Nominal)	GDH410-8HE-4L-R2W-PA-DRDM-UNV-1/840	5777	50.9	113.4 lm/W	-20°C / 35°C (-4°F / 95°F)	2x F54T5HO 4x F32T8	*

NOTE:
System data as of 5/30/25 (K-Boards).
Luminaire efficiency: 69.0%
Subject to change without notice.

System data is based on 120V input voltage. Actual performance may differ as a result of end-user environment and application. This fixture has been tested and listed in accordance with UL Standards. L.A. Lighting certifies that it will operate safely when installed properly, and within an ambient temperature range noted in the system data table.

Additional lumen packages and color temperatures available.